

A SURVEY OF EXISTING DRAINAGE SYSTEM TO BE CARRIED OUT PRIOR TO THE COMMENCEMENT OF THE WORKS.
 THE DRAINAGE SYSTEM IS A COMBINED DRAINAGE SYSTEM,
 ALL NEW RAINWATER DRAIN RUNS TO DISCHARGE INTO EXISTING-COMBINED-RAINWATER-SYSTEM,-
 ALL NEW FOUL DRAIN RUNS TO DISCHARGE INTO EXISTING COMBINED SOIL SYSTEM,
 ALL 100mmDIAM SURFACE / RAINWATER WATER DRAIN RUNS UNDER STRUCTURE TO BE ENCASED IN 150mm LEAN CONCRETE WITH PRECAST CONC LINTOLS OVER,
 ALL DISUSED DRAIN RUNS,ASJ AND BIGTS TO BE REMOVED AND FILLED IN WITH SUITABLE MATERIAL.

Connect to existing Local Authority Drainage System.

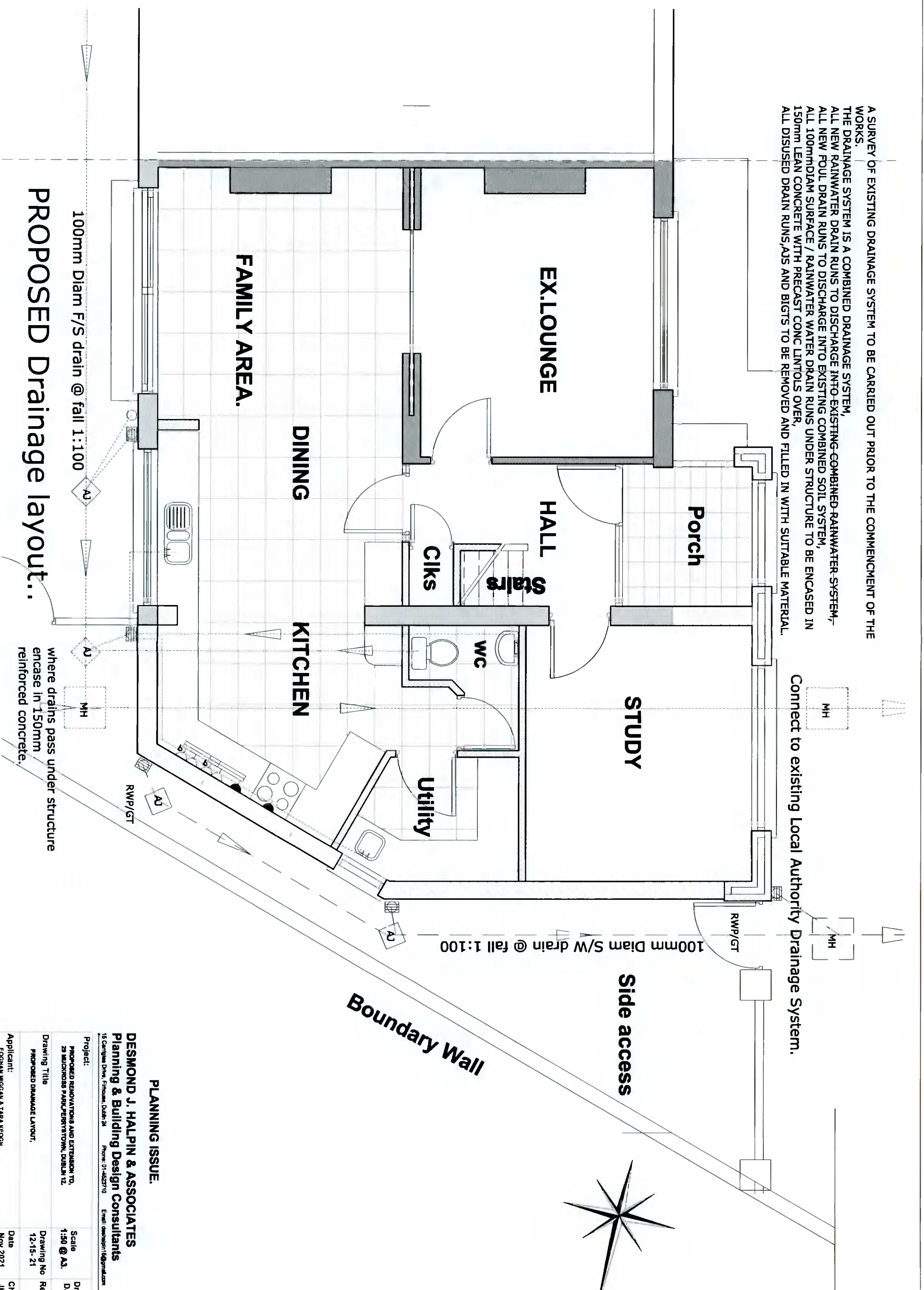

PROPOSED Drainage layout..

100mm Diam F/S drain @ fall 1:100

100mm Diam S/W drain @ fall 1:100

where drains pass under structure encase in 150mm reinforced concrete.

PLANNING ISSUE.

DESMOND J. HALPIN & ASSOCIATES
 Planning & Building Design Consultants

15 Curlew Drive, Fingrave, Dublin 24 Phone: 01-4627710 Email: desmondj@planning.com

Project:	PROPOSED RENOVATIONS AND EXTENSION TO, 25 MICKLEHOS PARK, PERRYSTOWN, DUBLIN 12.	Scale	1:50 @ A3.	Drawn	DJH
Drawing Title	PROPOSED DRAINAGE LAYOUT.	Drawing No	12-15- 21	Rev	
Applicant:	EUGHAN MCGAN & TARA KEOGH.	Date	Nov 2021.	Chk	JK