

Refer to engineers drawings for drainage details etc.
Refer to Architects Dwg No 001200 For Site Section

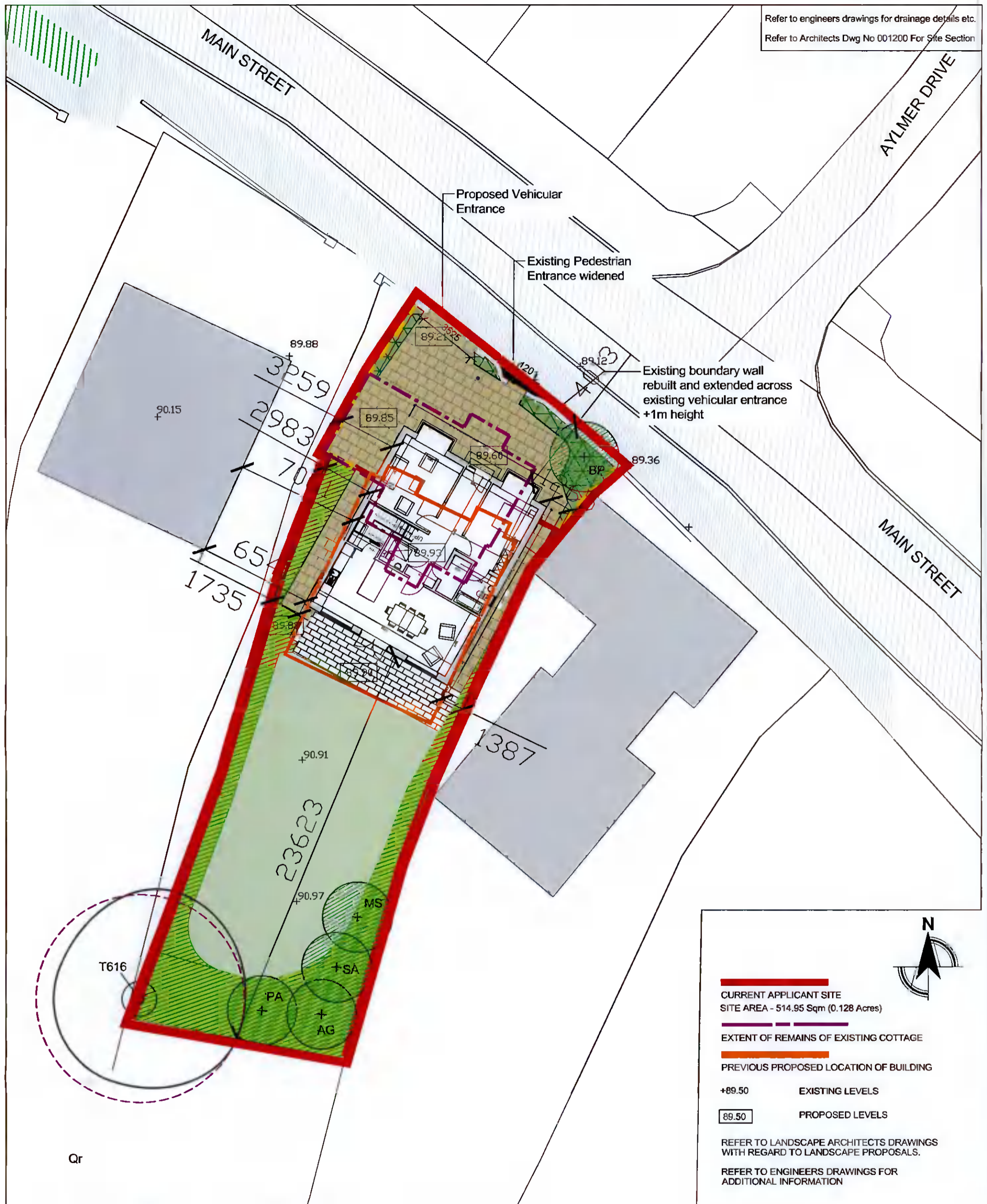

CURRENT APPLICANT SITE
SITE AREA - 514.95 Sqm (0.128 Acres)

EXTENT OF REMAINS OF EXISTING COTTAGE

PREVIOUS PROPOSED LOCATION OF BUILDING

+89.50 EXISTING LEVELS

89.50 PROPOSED LEVELS

REFER TO LANDSCAPE ARCHITECTS DRAWINGS WITH REGARD TO LANDSCAPE PROPOSALS.

REFER TO ENGINEERS DRAWINGS FOR ADDITIONAL INFORMATION



Rev.	Date:	Description:	By:
01	19.08.2021	PLANNING ISSUE	NN
02	22.11.2021	FI PLANNING ISSUE	NN

Drawing Status:	
Planning	
Client:	Cairn Homes Properties Ltd.
	7 Grand Canal, Grand Canal Street Lower, Dublin 2
Project:	Detached House - Main Street - Newcastle
Drawing:	Proposed Site Layout Plan
Date:	08/03/2021
Scale:	1:200@A3
Int. Job No.:	18001
Project No.:	OC21 - MOLA - 01 - XX - DR - A - PL - 01100 - P - 02
Originator:	
Zone:	
Level:	
Type:	
Discipl:	
Class:	
Sheet No.:	
Status:	
Rev.:	

MOLA
Architecture

2 Donnybrook Road
Donnybrook
Dublin D04 NN50
Ireland

Telephone +353 1 218 3900
www.mola.ie

Notes
Do not scale. Use figured dimensions only.
This drawing is to be read in conjunction with all relevant specifications and drawings.
All dimensions to be checked on site.
In the event of any discrepancies between drawings, the contractor is to inform the Architect immediately.

© COPYRIGHT This drawing or design may not be reproduced without permission