

Drawing : Revised Attic floor plan

EXISTING WORK
NEW WORK

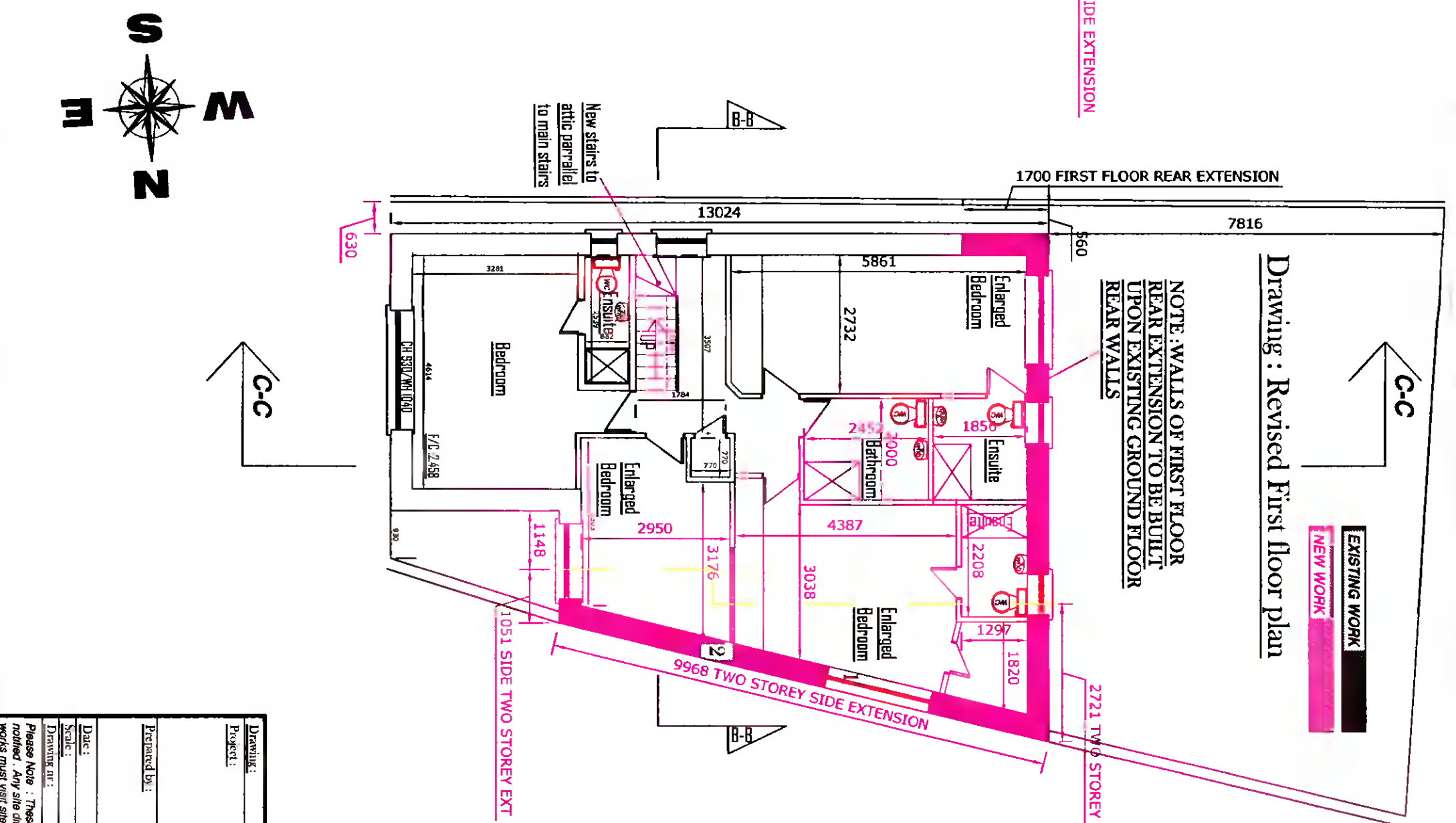

Drawing : Revised First floor plan

EXISTING WORK
NEW WORK

NOTE : WALLS OF FIRST FLOOR REAR EXTENSION TO BE BUILT UPON EXISTING GROUND FLOOR REAR WALLS

Drawing:	Revised Attic & First floor plans
Project:	We Declan Heery & Liz Magrath intend to apply for full planning permission for: 1. For a new first floor rear extension 2. For a two storey side extension 3. For removal of main existing pitched roof on dwelling, and replacement of same with a mixture of pitch and flat roof, placing 1 velux window in front and rear of new roof, placing 3 velux windows in side north face of new roof, placing 1 dormer structure with 3 obscure windows on side south face of new roof 4. All associated site works at 432A Orwell park green, Dublin 9w, D9W XCS9
Prepared by:	Michael Finnin (Bsc, MCHOB, MSCSI) C/O Boks Ltd, Lower Fingstown, Bohernabreena, Dublin 24 Ph: 087-2825326 Email: Michael.Finnin@3@gmail.com
Date:	23-11-2021
Drawing no.:	20
Scale:	1:100

Please Note : These drawings are for planning application purposes only and no works to commence until author is notified. Any site dimension discrepancy with drawings to be notified to author immediately. Any builder quoting for works must visit site and establish exact nature of works prior to preparing works quote.