

DETAIL A

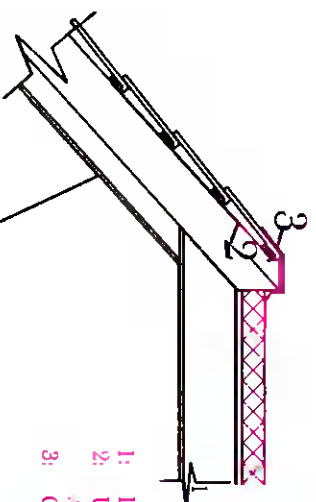

- 1: PARATONE WARM ROOF COVERING
- 2: UNDERLARK CODE 3 LEAD WORKED UNDER TILES AND OVER JUNCTION IN RIDGE
- 3: GREY ALUMINIUM COVER FLASHING

DRAWING : SECTION C-C

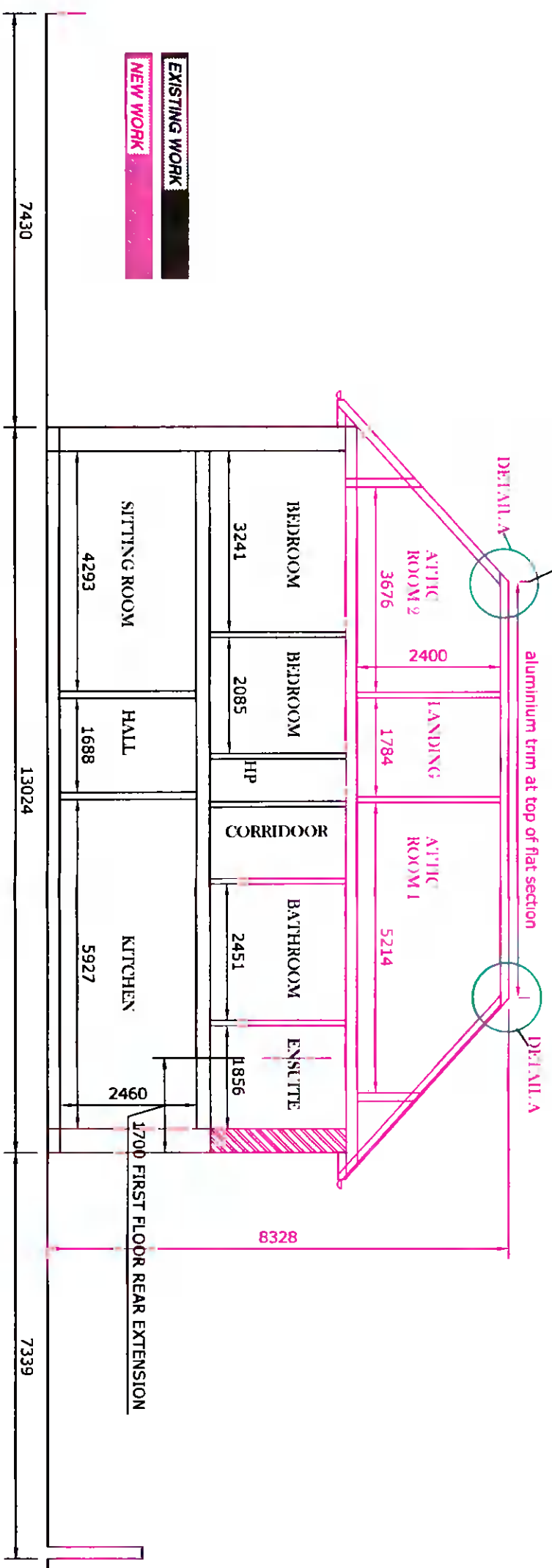

Drawing:	Section C-C
Project:	We Declan Heery & Liz McGrath intend to apply for full planning permission for: 1. For a new first floor rear extension 2. For a two storey side extension 3. For removal of main existing pitched roof on dwelling, and replacement of same with a mixture of pitch and flat roof, placing 1 velux window in front and rear of new roof, placing 3 velux windows in side north face of new roof, placing 1 dormer structure with 3 obscure windows on side south face of new roof 4. All associated site works at 432A Orwell park green, Dublin 6w, D6W XCS8
Prepared by:	Michael Finnan (Bsc, MCIQB, MSCSI) C/O Bdds Ltd, Lower Fiarstown, Bohernabreena, Dublin 24 Ph: 087-2825328 Email: Michael.Finnan043@gmail.com
Date:	23-11-2021
Scale:	1:100
Drawing no.:	21

Please Note: These drawings are for planning application purposes only and no works to commence until author is notified. Any site dimension discrepancy with drawings to be notified to author immediately. Any builder quoting for works must visit site and establish exact nature of works prior to preparing works quote.