

BLOCK	REVISION	DATE	BY	CHKD	DESCRIPTION
1	1	15/03/2023	JK	JK	ISSUED FOR PERMIT
1	2	15/03/2023	JK	JK	REVISIONS TO PERMIT
1	3	15/03/2023	JK	JK	REVISIONS TO PERMIT
1	4	15/03/2023	JK	JK	REVISIONS TO PERMIT
1	5	15/03/2023	JK	JK	REVISIONS TO PERMIT
1	6	15/03/2023	JK	JK	REVISIONS TO PERMIT
1	7	15/03/2023	JK	JK	REVISIONS TO PERMIT
1	8	15/03/2023	JK	JK	REVISIONS TO PERMIT
1	9	15/03/2023	JK	JK	REVISIONS TO PERMIT
1	10	15/03/2023	JK	JK	REVISIONS TO PERMIT
1	11	15/03/2023	JK	JK	REVISIONS TO PERMIT
1	12	15/03/2023	JK	JK	REVISIONS TO PERMIT
1	13	15/03/2023	JK	JK	REVISIONS TO PERMIT
1	14	15/03/2023	JK	JK	REVISIONS TO PERMIT
1	15	15/03/2023	JK	JK	REVISIONS TO PERMIT
1	16	15/03/2023	JK	JK	REVISIONS TO PERMIT
1	17	15/03/2023	JK	JK	REVISIONS TO PERMIT
1	18	15/03/2023	JK	JK	REVISIONS TO PERMIT
1	19	15/03/2023	JK	JK	REVISIONS TO PERMIT
1	20	15/03/2023	JK	JK	REVISIONS TO PERMIT
1	21	15/03/2023	JK	JK	REVISIONS TO PERMIT
1	22	15/03/2023	JK	JK	REVISIONS TO PERMIT
1	23	15/03/2023	JK	JK	REVISIONS TO PERMIT
1	24	15/03/2023	JK	JK	REVISIONS TO PERMIT
1	25	15/03/2023	JK	JK	REVISIONS TO PERMIT
1	26	15/03/2023	JK	JK	REVISIONS TO PERMIT
1	27	15/03/2023	JK	JK	REVISIONS TO PERMIT
1	28	15/03/2023	JK	JK	REVISIONS TO PERMIT
1	29	15/03/2023	JK	JK	REVISIONS TO PERMIT

**NOTES:**  
 1. THE DRAWING IS FOR INFORMATION ONLY AND DOES NOT CONSTITUTE A CONTRACT.  
 2. THE DRAWING IS FOR INFORMATION ONLY AND DOES NOT CONSTITUTE A CONTRACT.  
 3. THE DRAWING IS FOR INFORMATION ONLY AND DOES NOT CONSTITUTE A CONTRACT.

- ALTERATIONS DESCRIPTION:**
- A) Addition of existing Block B, College Lane, Greenogue, Rathcoole, Co. Dub. (existing area: 24,477 sqm) and 2,357 sqm existing ancillary facilities as per the site plan and the site plan submitted with the application for planning permission.
  - B) 1) (Unit B) to contain: 1) 1,500 sqm existing warehouse area, 2,357 sqm existing ancillary facilities area and
  - C) 2) Unit B to contain: 1) 1,500 sqm existing warehouse area, 2,357 sqm existing ancillary facilities area and
  - D) 3) Unit B to contain: 1) 1,500 sqm existing warehouse area, 2,357 sqm existing ancillary facilities area and
  - E) 4) Unit B to contain: 1) 1,500 sqm existing warehouse area, 2,357 sqm existing ancillary facilities area and
  - F) 5) Unit B to contain: 1) 1,500 sqm existing warehouse area, 2,357 sqm existing ancillary facilities area and
  - G) 6) Unit B to contain: 1) 1,500 sqm existing warehouse area, 2,357 sqm existing ancillary facilities area and
  - H) 7) Unit B to contain: 1) 1,500 sqm existing warehouse area, 2,357 sqm existing ancillary facilities area and
  - I) 8) Unit B to contain: 1) 1,500 sqm existing warehouse area, 2,357 sqm existing ancillary facilities area and
  - J) 9) Unit B to contain: 1) 1,500 sqm existing warehouse area, 2,357 sqm existing ancillary facilities area and
  - K) 10) Unit B to contain: 1) 1,500 sqm existing warehouse area, 2,357 sqm existing ancillary facilities area and
  - L) 11) Unit B to contain: 1) 1,500 sqm existing warehouse area, 2,357 sqm existing ancillary facilities area and
  - M) 12) Unit B to contain: 1) 1,500 sqm existing warehouse area, 2,357 sqm existing ancillary facilities area and
  - N) 13) Unit B to contain: 1) 1,500 sqm existing warehouse area, 2,357 sqm existing ancillary facilities area and
  - O) 14) Unit B to contain: 1) 1,500 sqm existing warehouse area, 2,357 sqm existing ancillary facilities area and
  - P) 15) Unit B to contain: 1) 1,500 sqm existing warehouse area, 2,357 sqm existing ancillary facilities area and
  - Q) 16) Unit B to contain: 1) 1,500 sqm existing warehouse area, 2,357 sqm existing ancillary facilities area and
  - R) 17) Unit B to contain: 1) 1,500 sqm existing warehouse area, 2,357 sqm existing ancillary facilities area and
  - S) 18) Unit B to contain: 1) 1,500 sqm existing warehouse area, 2,357 sqm existing ancillary facilities area and
  - T) 19) Unit B to contain: 1) 1,500 sqm existing warehouse area, 2,357 sqm existing ancillary facilities area and
  - U) 20) Unit B to contain: 1) 1,500 sqm existing warehouse area, 2,357 sqm existing ancillary facilities area and
  - V) 21) Unit B to contain: 1) 1,500 sqm existing warehouse area, 2,357 sqm existing ancillary facilities area and
  - W) 22) Unit B to contain: 1) 1,500 sqm existing warehouse area, 2,357 sqm existing ancillary facilities area and
  - X) 23) Unit B to contain: 1) 1,500 sqm existing warehouse area, 2,357 sqm existing ancillary facilities area and
  - Y) 24) Unit B to contain: 1) 1,500 sqm existing warehouse area, 2,357 sqm existing ancillary facilities area and
  - Z) 25) Unit B to contain: 1) 1,500 sqm existing warehouse area, 2,357 sqm existing ancillary facilities area and

**NOTE:** The starting condition is that of the independent application for planning permission for Block B.

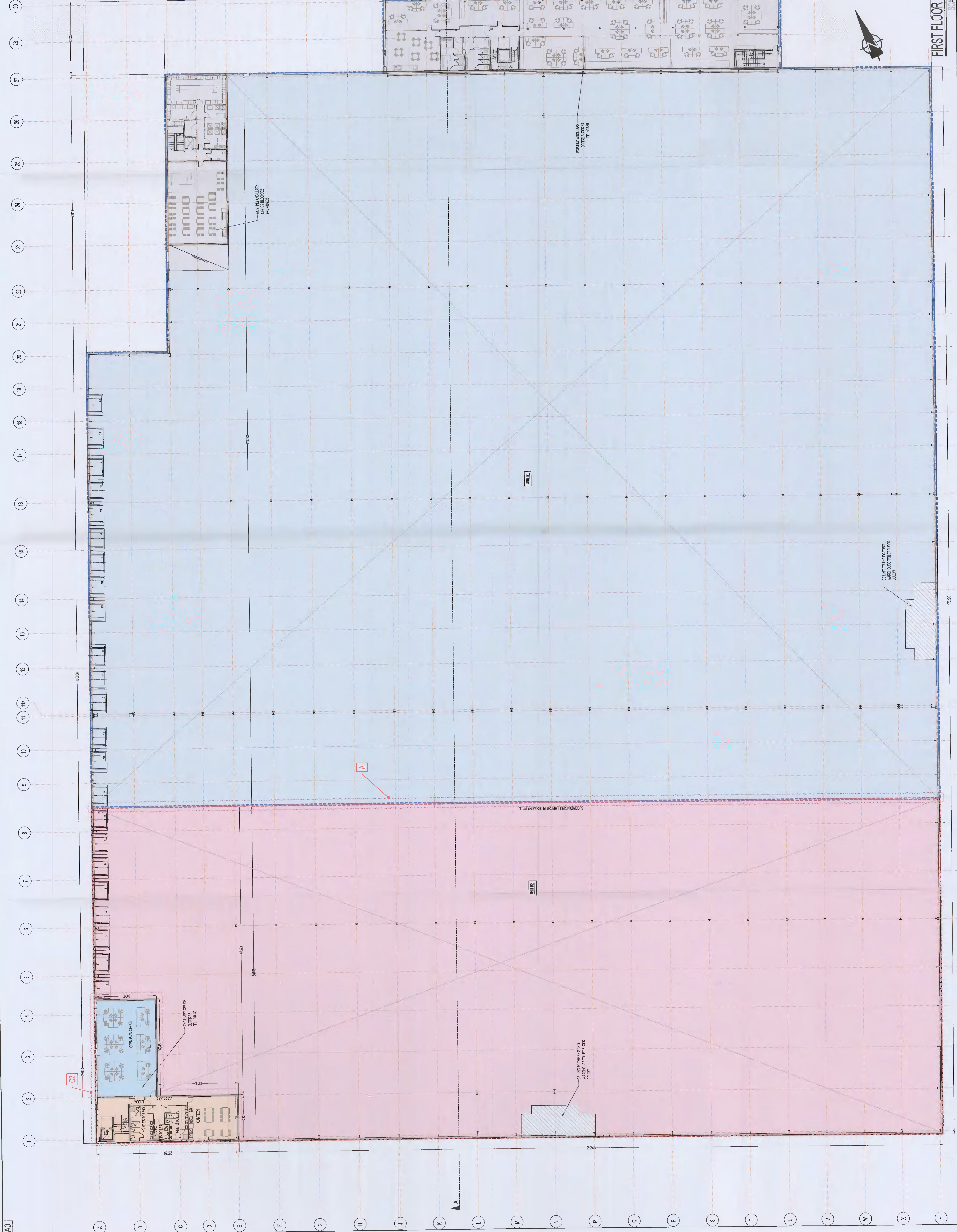

**PLANNING ALTERATIONS (2) BLOCK B**

DEVELOPMENT LANDS AT  
 COLLEGE LANE, GREENOGUE,  
 RATHCOOLE,  
 CO. DUBLIN

Block B SUBDIVISION  
 FIRST FLOOR PLAN

**KAVANAGH BURKE**  
 CONSULTING ENGINEERS

AERODROME PROPCO LIMITED

D1577 GA-A-002 P.18