

Location of
Site Notice

Willington Park



PL1	Issued For Planning	JW	JW	Nov' 2021
REV:	REVISION TITLE:	DRN:	CHD:	DATE:

APPLICANT:
Michael & Bernadette Confrey

APPLICANT:
Jason Walsh
Architectural & Engineering
12 ARD MOR CRESCENT
TALLAGHT
DUBLIN 24
PHONE: 085 8070 432
EMAIL: G.JL.SERVICES@GMAIL.COM

JOB TITLE:
Proposed Single Storey Rear Extension And Conversion
of Garage At
36 Wellington Park,
Templeogue,
Dublin 6W.

DRAWING TITLE:
Existing Site Layout

SCALE: 1:200	INITIALS: JW	DATE: 09.11.20
JOB No: DC-21	DRAWING No: DC-21-01	REV: PL1

THIS DRAWING IS ISSUED FOR PLANNING ONLY, AND IS NOT A CONSTRUCTION DRAWING

ALL BUILDING WORK TO BE CARRIED OUT IN ACCORDANCE WITH ENGINEERS DETAILS & CURRENT BUILDING REGULATIONS

CONTRACTORS MUST VERIFY ALL DIMENSIONS ON SITE BEFORE COMMENCING ANY WORK. NO WORKING DIMENSIONS TO BE SCALED. DIMENSIONS TO BLOCKWORK ONLY. THIS DRAWING AND DESIGN IS COPYRIGHT AND IS THE PROPERTY OF JASON WALSH.



Note
 As no Benchmark is indicated on the O.S. map the levels indicated relate to an assumed level of +100.00 in the centre of the roadway
 GFFL = Ground Floor Finished Level

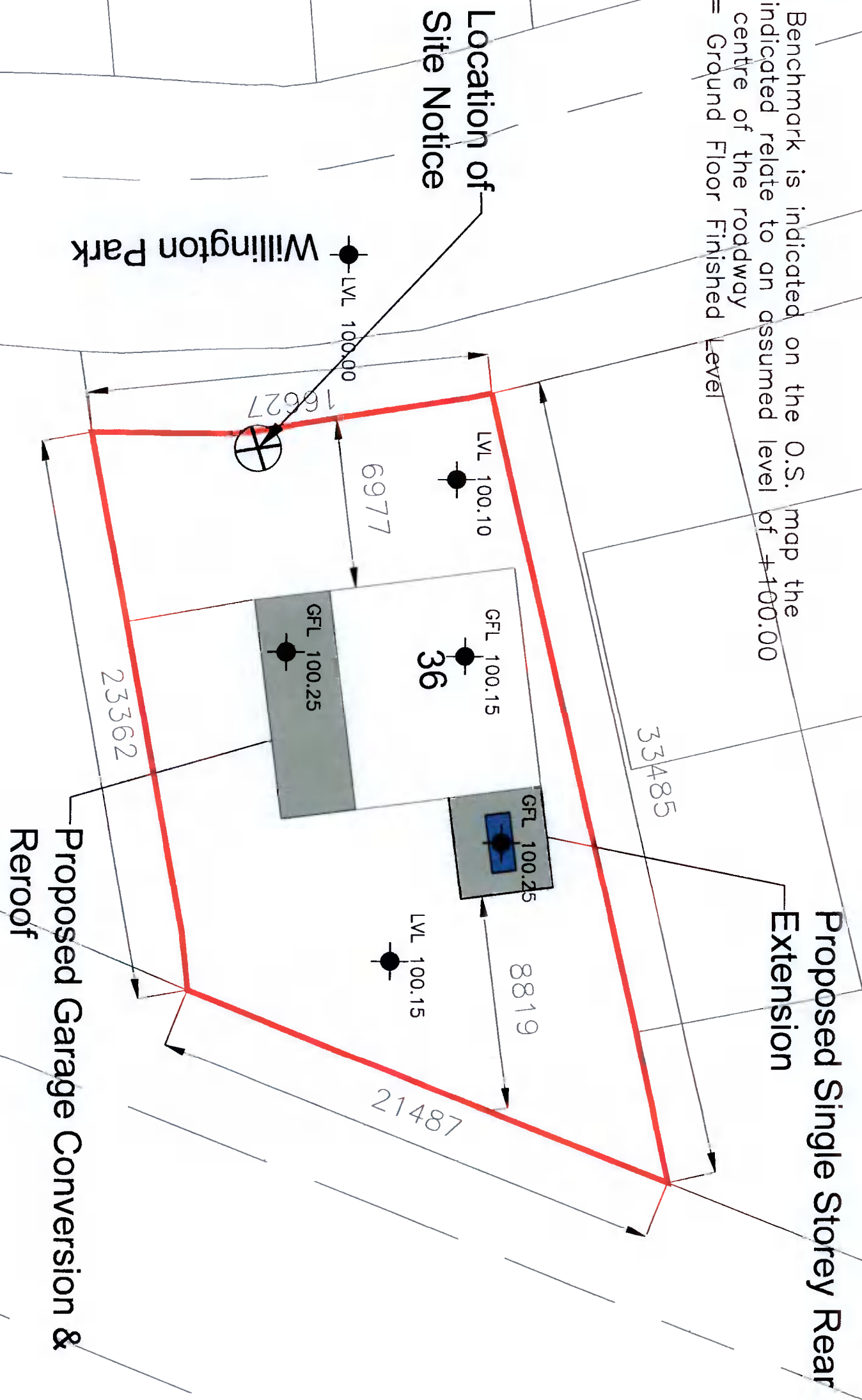

PL1	Issued For Planning	JW	JW	Nov' 2021
REV:	REVISION TITLE:	DRN:	CHD:	DATE:

APPLICANT:
Michael & Bernadette Confrey

Jason Walsh
 Architectural & Engineering
 12 ARD MOR CRESCENT
 TALLAGHT
 DUBLIN 24
 PHONE: 085 8070 432
 EMAIL: GJL.SERVICES@GMAIL.COM

JOB TITLE:
 Proposed Single Storey Rear Extension And Conversion of Garage At 36 Wellington Park, Templeogue, Dublin 6W.

DRAWING TITLE:
 Proposed Site Layout

SCALE: 1:200	INTDLS: JW	DATE: 09.11.20
JOB No: DC-21	DRAWING No: DC-21-05	REV: PL1

THIS DRAWING IS ISSUED FOR PLANNING ONLY, AND IS NOT A CONSTRUCTION DRAWING

ALL BUILDING WORK TO BE CARRIED OUT IN ACCORDANCE WITH ENGINEERS DETAILS & CURRENT BUILDING REGULATIONS

CONTRACTORS MUST VERIFY ALL DIMENSIONS ON SITE BEFORE COMMENCING ANY WORK. NO WORKING DIMENSIONS TO BE SCALED. DIMENSIONS TO BLOCKWORK ONLY. THIS DRAWING AND DESIGN IS COPYRIGHT AND IS THE PROPERTY OF JASON WALSH.