

Ordnance Survey Map

Scale 1:500

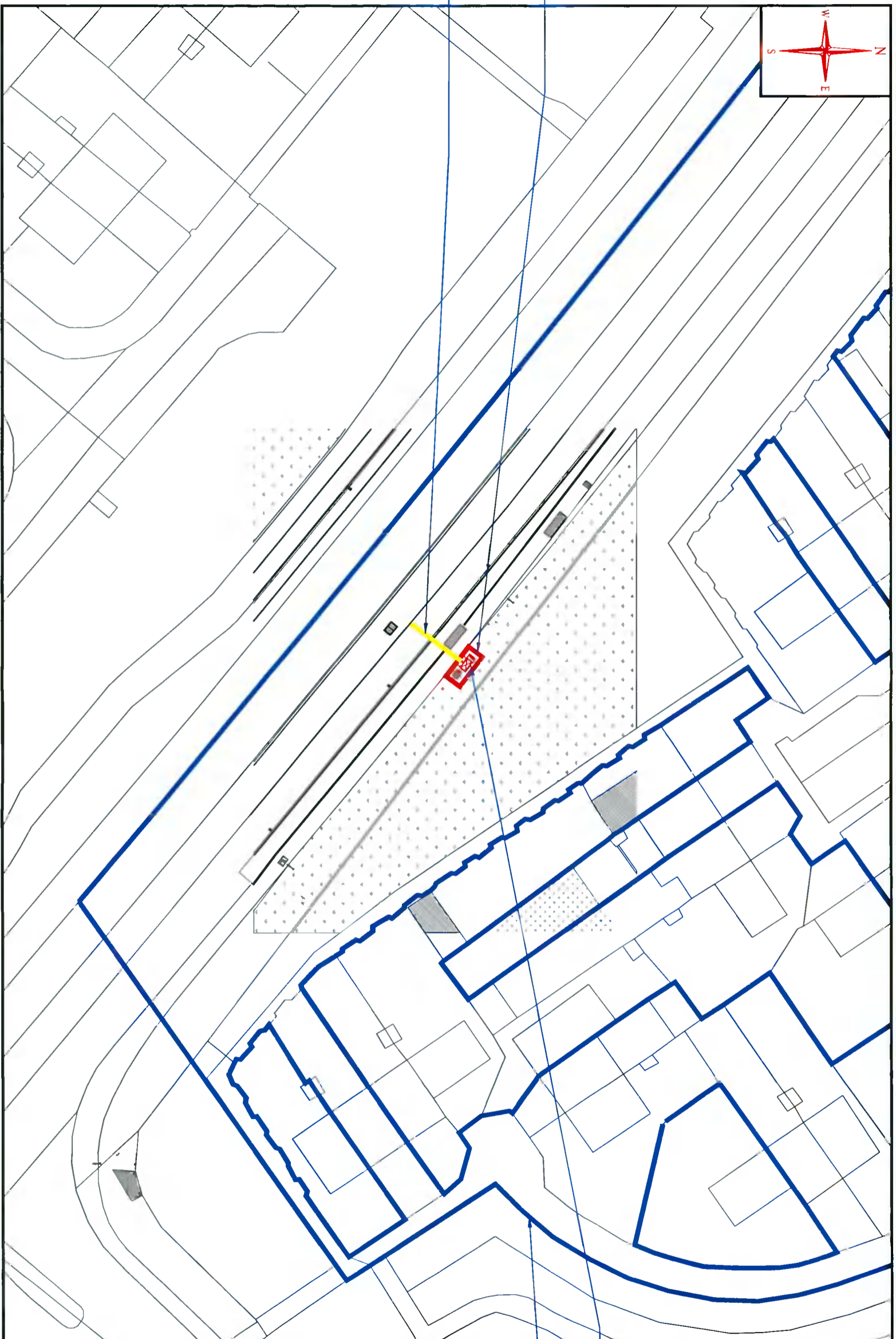

SITE BOUNDARY
OUTLINED IN RED

EXISTING ACCESS ROUTE
OUTLINED IN YELLOW

OWNERSHIP BOUNDARY
OUTLINED IN BLUE

PROPOSED COMPOUND

Site Code: DX049 Site Name: CHEEVERSTOWN ROAD.



VANTAGE
TOWERS

Notes:

1. Do not scale.
2. All dimensions are in mm otherwise specified.
3. Assume all site details are existing unless otherwise specified.

Grid	Notes	Date
A	PLANNING APPLICATION DRAWING	06/10/21
B	ADDRESS UPDATED	07/10/21
C		
D		
E		
F		
G		

General/Technical Details		Purpose	
Type:	RBS 6102	Site Code:	DX049
Dim:	1450x1300x700	Drawn:	GD
Colour:		Checked:	DS
Structure Details:	STEEL POLE	Approved:	IB
Height:	15.0m	Date:	06/10/21

Title		Revision	
Site Layout Plan 1:500	Project:	NOT FOR CONSTRUCTION	A
	PROPOSED VANTAGE TOWERS SITE AT (R136) CHEEVERSTOWN ROAD, KILMARTIN GREEN, JOBSTOWN CO. DUBLIN	- AWAITING PCH	
	Drawing No: DX049 / 002 / 04		

THE OWNERSHIP AND COPYRIGHT OF THIS DRAWING REMAINS WITH VANTAGE TOWERS AT ALL TIMES. THE DRAWING MAY NOT BE COPIED, DUPLICATED OR PASSED TO THIRD PARTIES WITHOUT THE WRITTEN PERMISSION OF VANTAGE TOWERS.

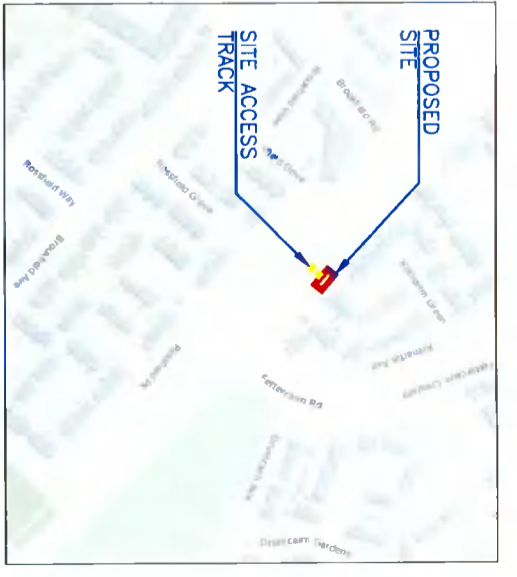
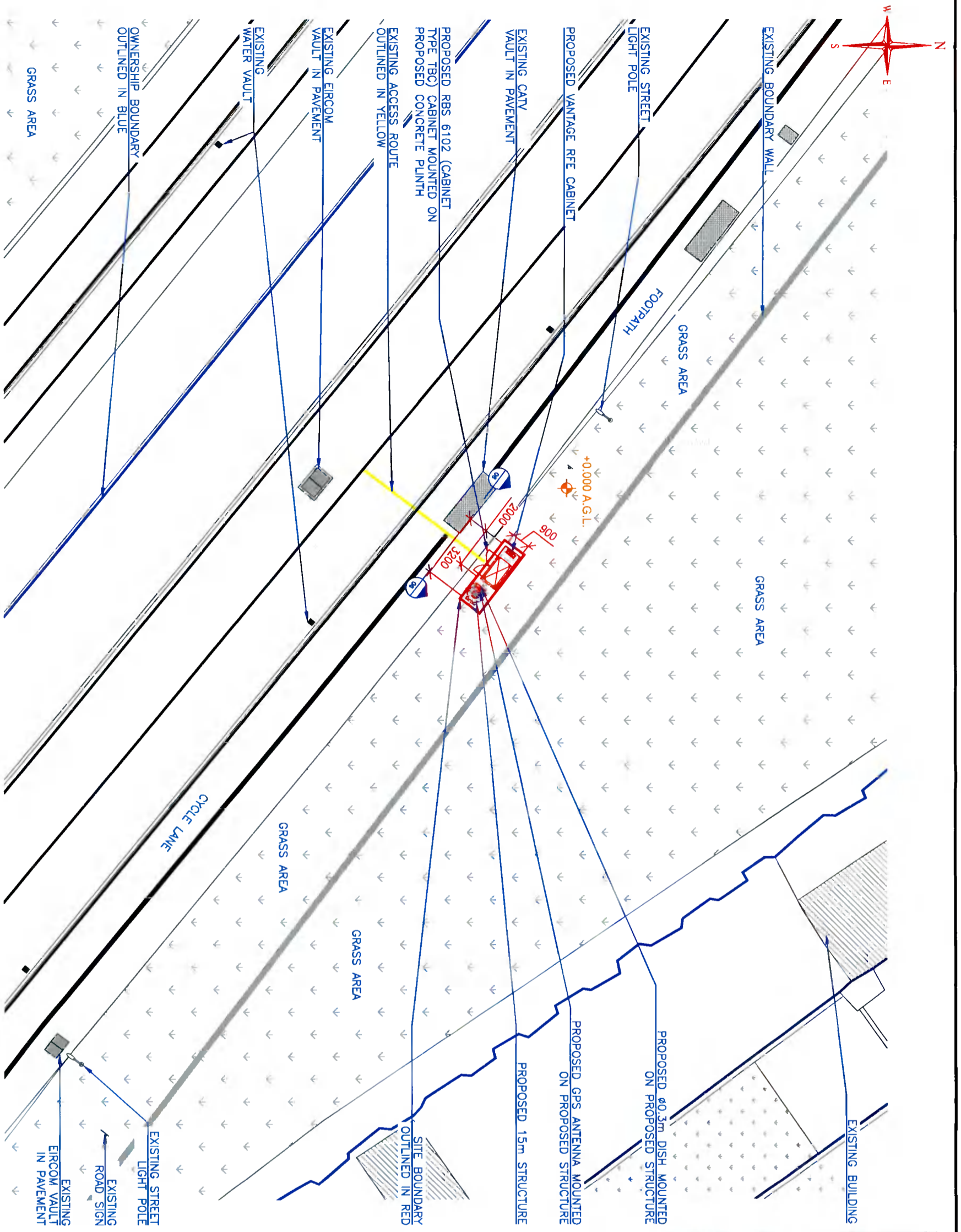

SITE LAYOUT PLAN
SCALE 1:200

VANTAGE TOWERS

Notes:	Revision	Description	Date
1. Do not scale.	A	PLANNING APPLICATION DRAWING	06/10/21
2. All dimensions are in mm otherwise specified.	B	ADDRESS UPDATED	07/10/21
3. Assume all site details otherwise specified.	C	PLANNING APPLICATION DRAWING	06/10/21

Structure Details	Structure Details	Structure Details	Structure Details
Type: RBS 6102	Colour: 1450x1300x700	Structure Details	Structure Details
Height: 15.0m	Type: STEEL POLE	Scale: As Shown	Scale: As Shown

Project	Client	Design	Check	Approved
DX049	GD	GD	DS	IB

Title	Project	Drawing No.	Revision
Site Layout Plan	PROPOSED VANTAGE TOWERS SITE AT (R136) CHEEVERSTOWN ROAD, KILMARTIN GREEN, JOBSTOWN CO. DUBLIN	DX049 / 002 / 05	A

THE OWNERSHIP AND COPYRIGHT OF THIS DRAWING REMAINS WITH VANTAGE TOWERS AT ALL TIMES. THE DRAWING MAY NOT BE COPIED, DUPLICATED OR PASSED TO THIRD PARTIES WITHOUT THE WRITTEN PERMISSION OF VANTAGE TOWERS.

