



NOTES:

1. ALL PROPOSED SERVICES TO BE 2.0m MIN CLEAR OF EXISTING WATERMAIN AS REQUIRED BY IRISH WATER.
2. ALL WATER SERVICING AFTER THE WATER METER SERVICING BUILDING TO BE PRIVATELY OWNED AND MAINTAINED

LEGEND:

- PROPOSED 125mm OD PE 100 SDR 11 (100mm ID) WATERMAIN, INTERNAL WATERMAIN & CONNECTIONS TO M&E LAYOUTS & DETAILS
- PROPOSED WATER METER
- PROPOSED SLUICE VALVE
- EXISTING WATERMAIN AS SPECIFIED
- EXISTING FIRE HYDRANT
- EXTENT OF SURFACE WATER SEWER & WATERMAIN WAYLEAVE
- OUTLINE OF PROPOSED BUILDINGS
- EXTENT OF DEVELOPMENT
- INDICATIVE BOUNDARY BETWEEN DUN LAOGHAIRE RATHDOWN AND SOUTH DUBLIN COUNTY COUNCILS

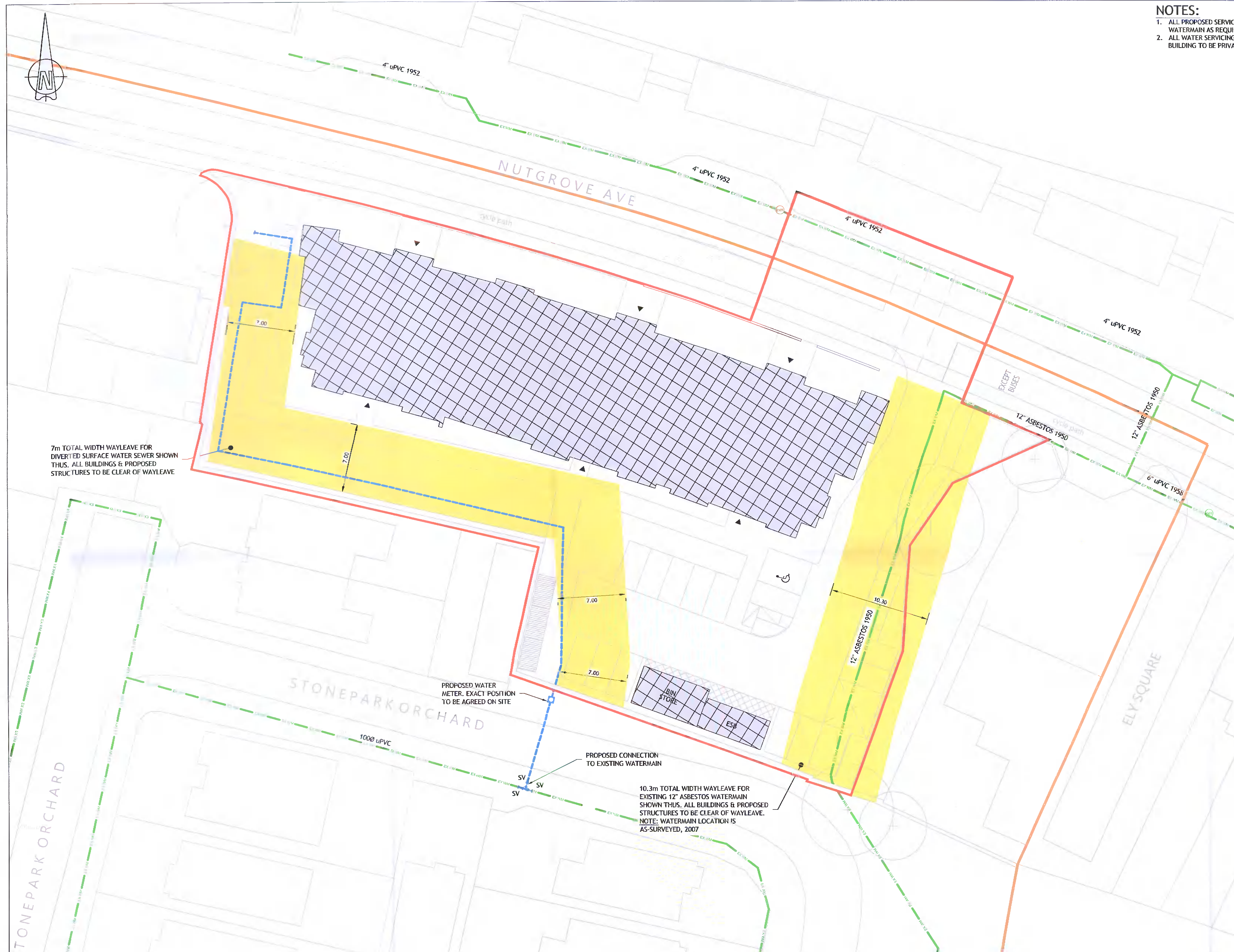

7m TOTAL WIDTH WAYLEAVE FOR DIVERTED SURFACE WATER SEWER SHOWN THUS, ALL BUILDINGS & PROPOSED STRUCTURES TO BE CLEAR OF WAYLEAVE

PROPOSED WATER METER, EXACT POSITION TO BE AGREED ON SITE

PROPOSED CONNECTION TO EXISTING WATERMAIN

10.3m TOTAL WIDTH WAYLEAVE FOR EXISTING 12" ASBESTOS WATERMAIN SHOWN THUS, ALL BUILDINGS & PROPOSED STRUCTURES TO BE CLEAR OF WAYLEAVE. NOTE: WATERMAIN LOCATION IS AS-SURVEYED, 2007

PROPRIETARY PRODUCT NAMES, MANUFACTURER'S NAMES, SUPPLIER'S NAMES, NATIONAL STANDARDS

WHERE A SPECIFICATION OR A DESCRIPTION OF A PRODUCT OR ELEMENT OF WORK INCLUDES A SPECIFIC MAKE OR SOURCE SUCH AS A PRODUCT NAME OR MANUFACTURER'S NAME OR A SUPPLIER'S NAME, OR A NATIONAL STANDARD, THE SPECIFICATION OR DESCRIPTION SHALL BE PRECEDED BY THE WORDS "OR EQUIVALENT" NOTWITHSTANDING THAT THOSE EXACT WORDS MAY NOT IN FACT ACCOMPANY THE NAME OR STANDARD. THIS ALSO APPLIES WHERE THE NAME OR STANDARD IS ACCOMPANIED BY OTHER WORDS SUCH AS "OR EQUAL APPROVED" OR SUCH LIKE PHRASES.

MATERIALS IN CONTACT WITH POTABLE WATER

ALL MATERIALS, SUBSTANCES AND PRODUCTS IN CONTACT WITH POTABLE WATER SHALL COMPLY IN ALL RESPECTS WITH THE EUROPEAN COMMUNITIES (DRINKING WATER) (NO. 2) REGULATIONS, 2007 (S.I. NO. 276 OF 2007) AND SHALL BE INCLUDED IN THE LATEST "LIST OF APPROVED PRODUCTS AND PROCESSES" PUBLISHED BY THE DRINKING WATER INSPECTORATE FOR ENGLAND AND WALES. THE CONTRACTOR SHALL PRODUCE DOCUMENTARY EVIDENCE THAT THE SUBSTANCE OR PRODUCT HAS BEEN SPECIFICALLY APPROVED UNDER THE DWI SYSTEM, OR EQUIVALENT APPROVAL SYSTEM.

Ordnance Survey Ireland Licence No. EN 0003720
© Ordnance Survey Ireland/Government of Ireland

© PUNCH Consulting Engineers
This drawing and any design hereon is the copyright of the Consultants and must not be reproduced without their written consent.
All drawings remain the property of the Consultants.
Figured dimension only to be taken from this drawing.
Consultants to be informed immediately of any discrepancies before work proceeds.



Rev	Amendment	By	Date	Rev	Amendment	By	Date
C01	PLANNING ISSUE	IBS	2021/04/19				
C02	PLANNING F1 RESPONSE	DAP	2021/09/16				
C03	PLANNING CLARIFICATION RESPONSE	DAP	2021/11/18				

Client: SIRIO HOMES



Project: RESIDENTIAL DEVELOPMENT, NUTGROVE AVENUE, RATHFARNHAM, DUBLIN	
Title: PROPOSED WATERMAIN LAYOUT	
Drawn: IBS	Checked: IBS
Project No: 202252	Project Name: 202252-PUNCH-XX-XX-DR-C-0200
Scale: 1:200	Revision No: C03