

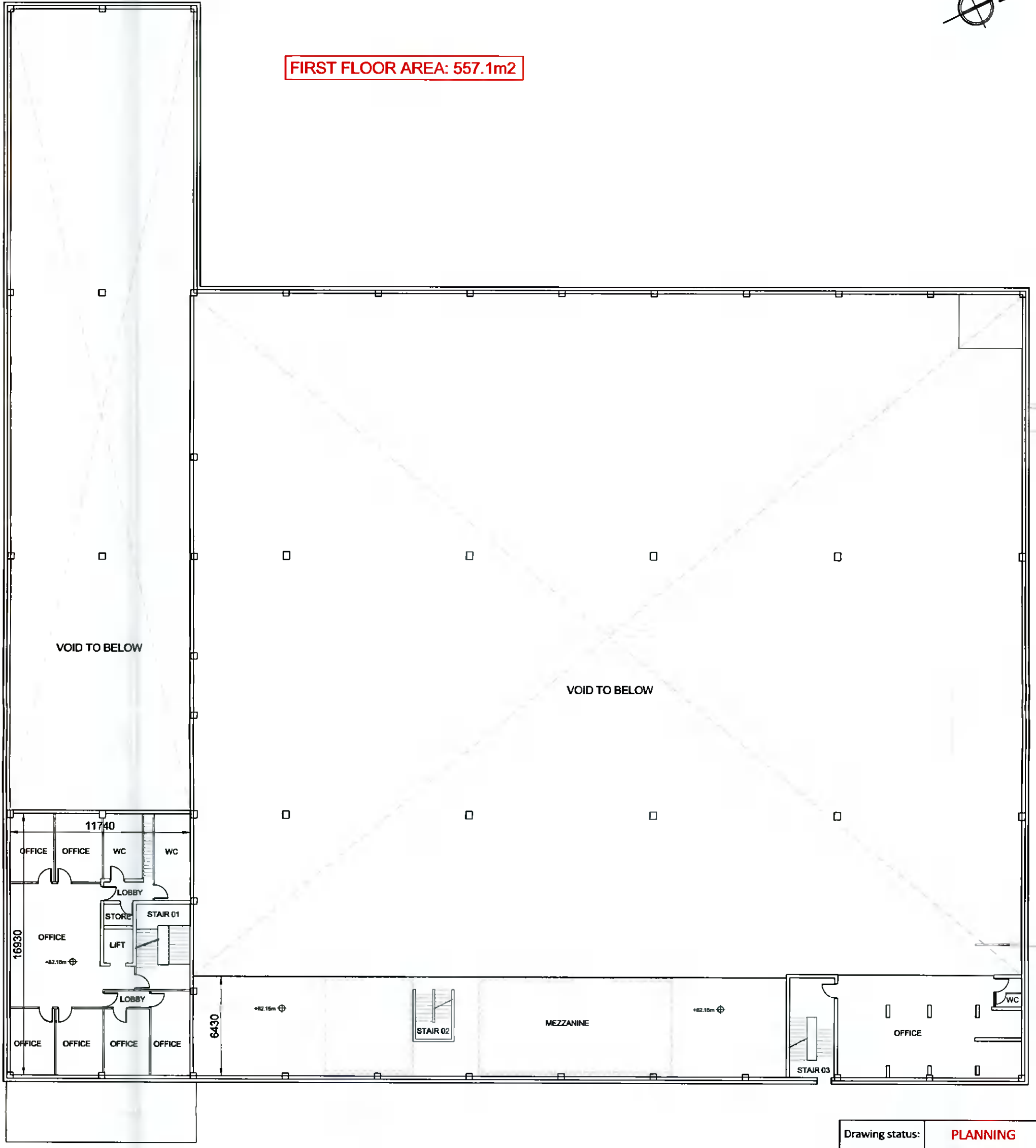

FIRST FLOOR AREA: 557.1m²



FIRST FLOOR PLAN
SCALE 1:250 @ A3

Drawing status:		PLANNING
F	-	-
E	-	-
D	-	-
C	-	-
B	-	-
A	-	-
Revision Suffix	Revision details	Date
Client Asia Market		
Job title Licence Drawings for Retail & Warehouse Premises at Merrywell Business Park, Ballymount, Dublin 12		
Drawing title First Floor Plan		
R. G. GREENE & ASSOCIATES Consulting Engineers Civil, Environmental & Structural		
<small>Caher House, Loughrea Co. Galway, H81 FF82</small>		<small>Tel 087 2588296 Email rgr@greene.ie</small>
dwg.	date	scale
R.G.	29/09/2021	1:250 @ A3
DRAWING No		1819-13
		drawn W.G.