

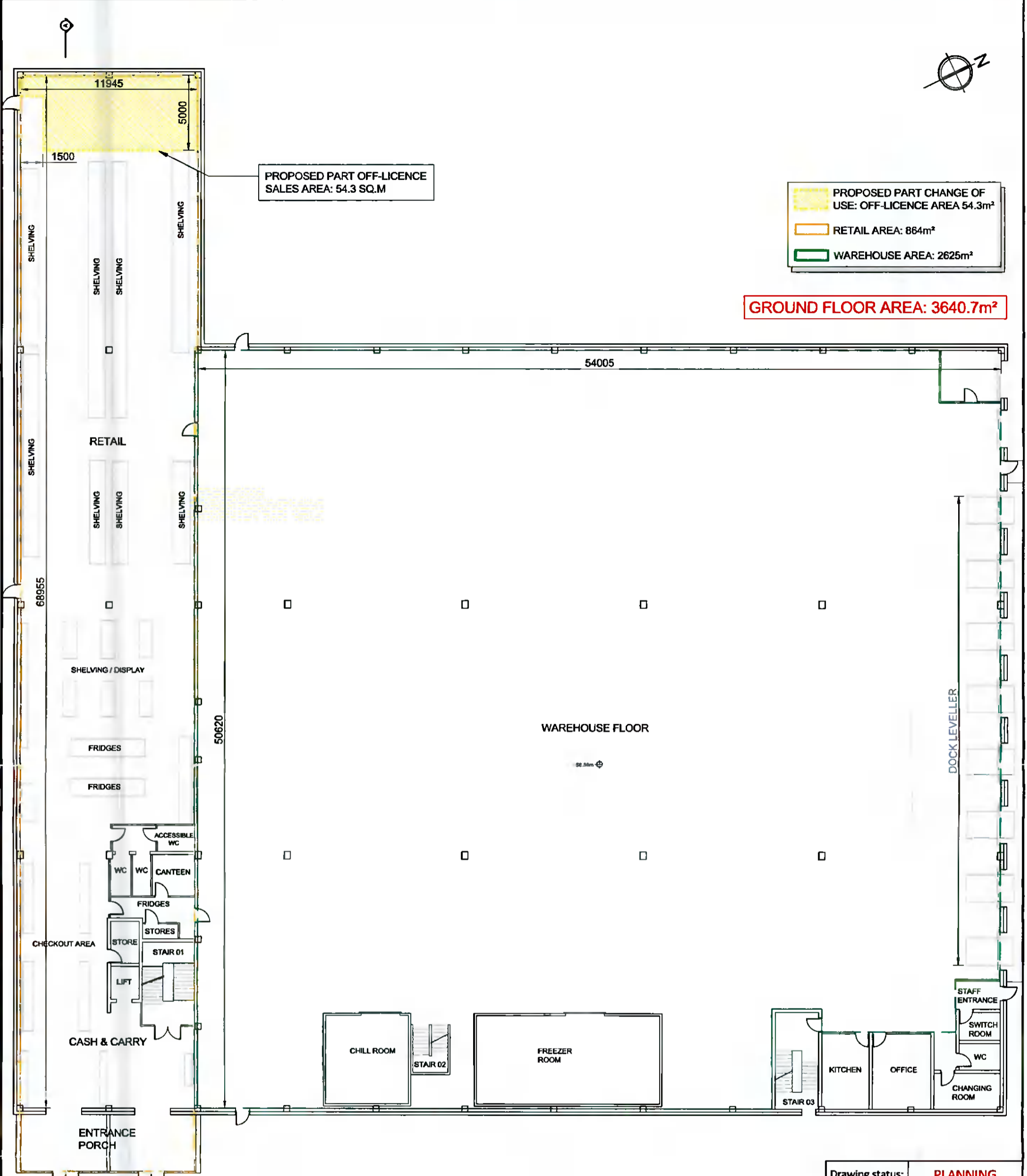

PROPOSED PART CHANGE OF USE: OFF-LICENCE AREA 54.3m²
 RETAIL AREA: 864m²
 WAREHOUSE AREA: 2625m²

GROUND FLOOR AREA: 3640.7m²

PROPOSED PART OFF-LICENCE SALES AREA: 54.3 SQ.M



GROUND FLOOR PLAN
SCALE 1:250 @ A3

Drawing status:		PLANNING
F	-	-
E	-	-
D	-	-
C	-	-
B	-	-
A	-	-
Revision Suffix	Revision details	Date
Client Asia Market		
Job title Licence Drawings for Retail & Warehouse Premises at Merrywell Business Park, Ballymount, Dublin 12		
Drawing title Ground Floor Plan		
R. G. GREENE & ASSOCIATES Consulting Engineers Civil, Environmental & Structural		
Cedar House, Loughrye Co. Galway, H81 FF82 Tel: 087 2562288 Email: rgr@greene.ie		
chd. R.G.	date 29/09/2021	scale 1:250 @ A3
DRAWING No		1819-12
		W.G.