

REVISIONS

THIS DRAWING IS COPYRIGHT
FIGURED DIMENSIONS TO BE USED IN ALL CASES

JOB
All Suits
Unit 18 Old Bawn Shopping Centre
Tallaght
Dublin, D24 P99F

CLIENT
Julian Judge

TITLE
SOUTH EAST FACING ELEVATION
Existing & Proposed

DATE NOVEMBER 2021
SCALE As indicated
CAD FILE REF 1928

DRN CB
CHECKED BNI
NUMBER 1928
REVISION
1928-PL-302

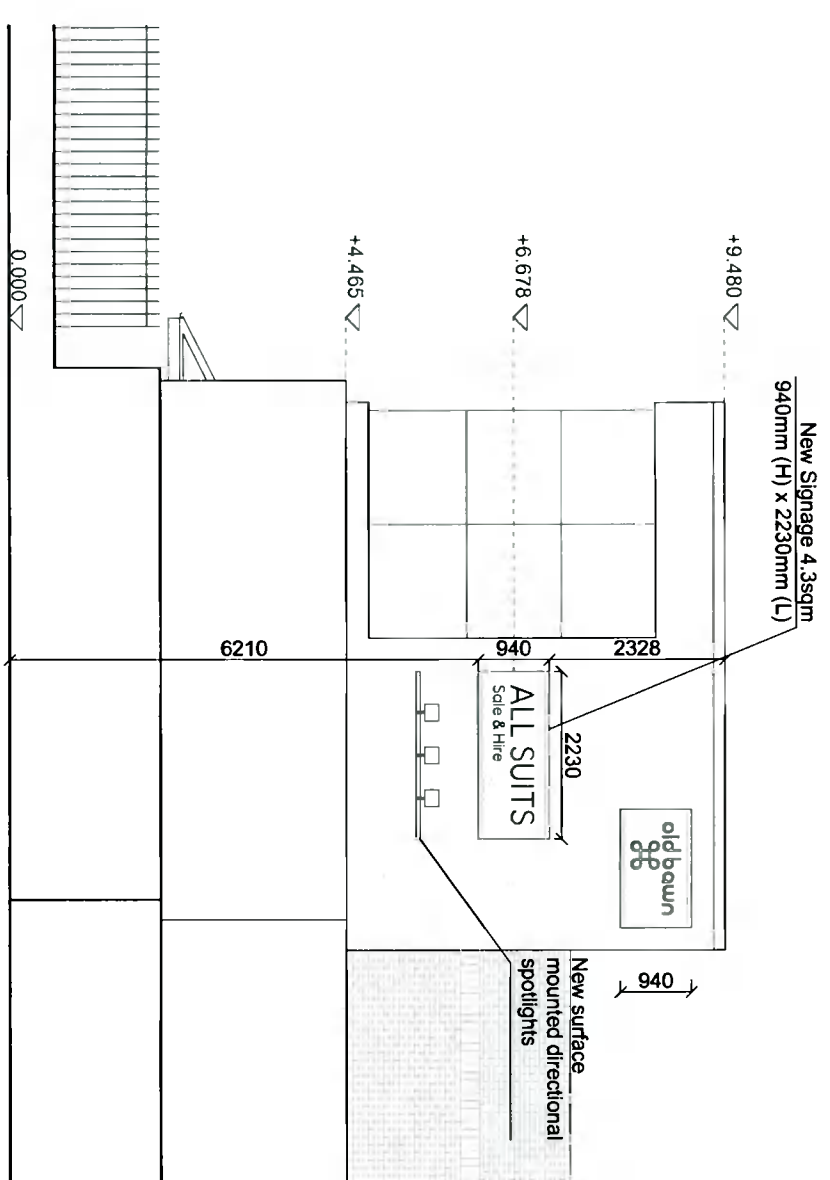
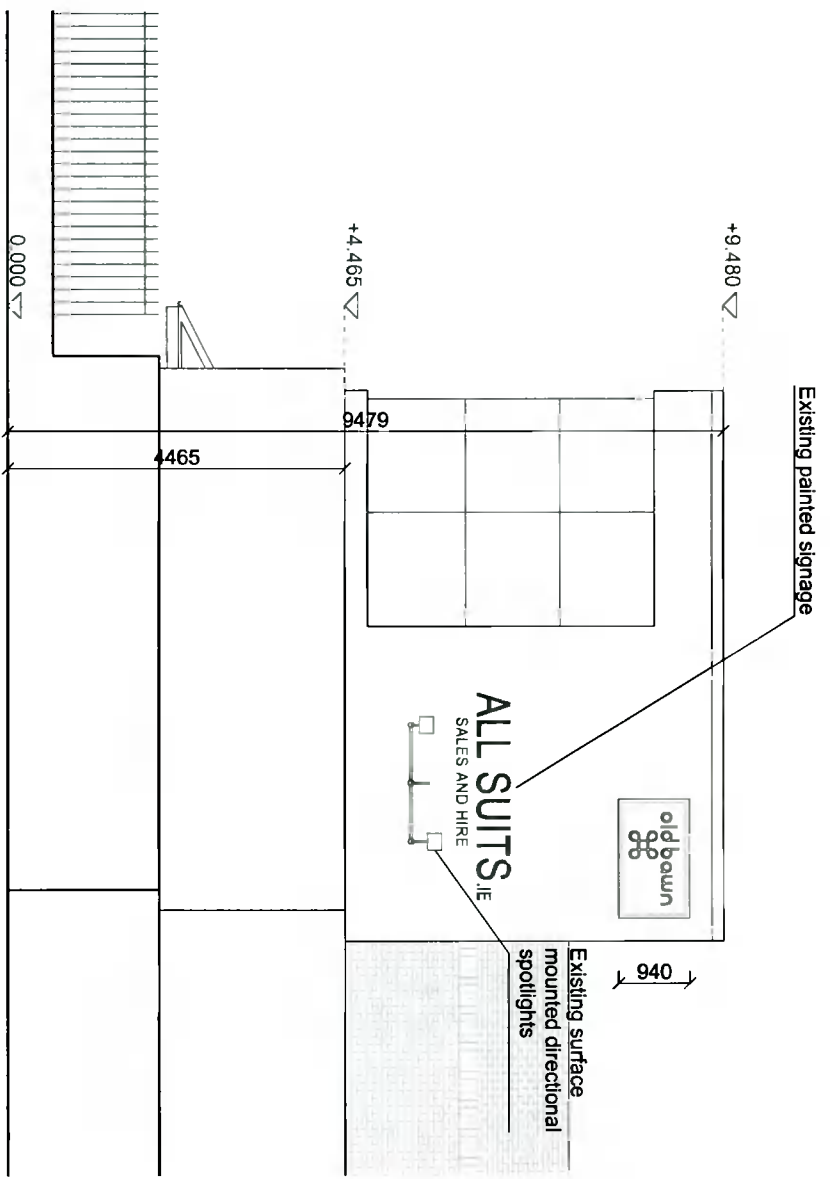

SOUTH EAST FACING ELEVATION,
Existing, 1:100

SOUTH EAST FACING ELEVATION,
Proposed, 1:100

ROBIN MANDAL
ARCHITECTS

THE COURTYARD, 40 MAIN STREET
BLACKROCK COUNTY DUBLIN
T (01) 2786164
F (01) 2636923
W www.mandarchitects.ie
E rma@mandarchitects.ie

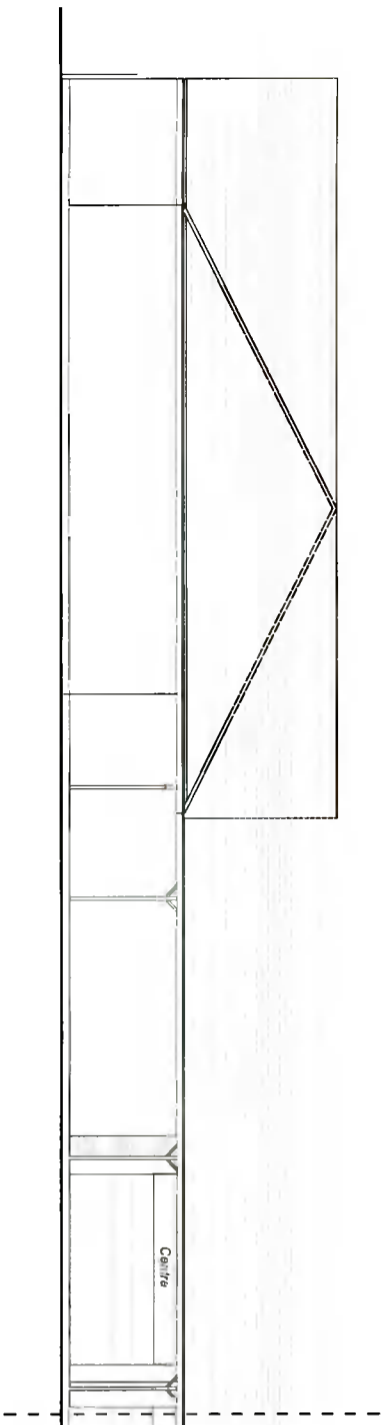

SOUTH WEST FACING ELEVATION
Existing Contiguous, 1:200

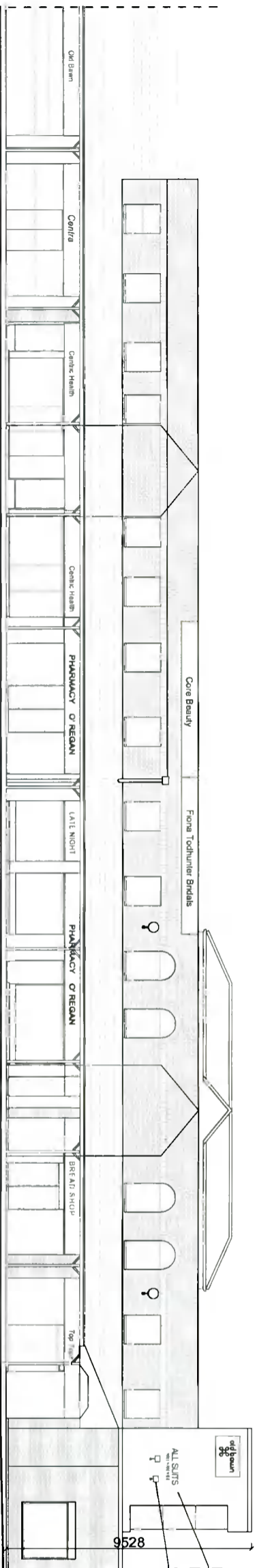

Existing painted signage
Existing surface mounted
directional spotlights

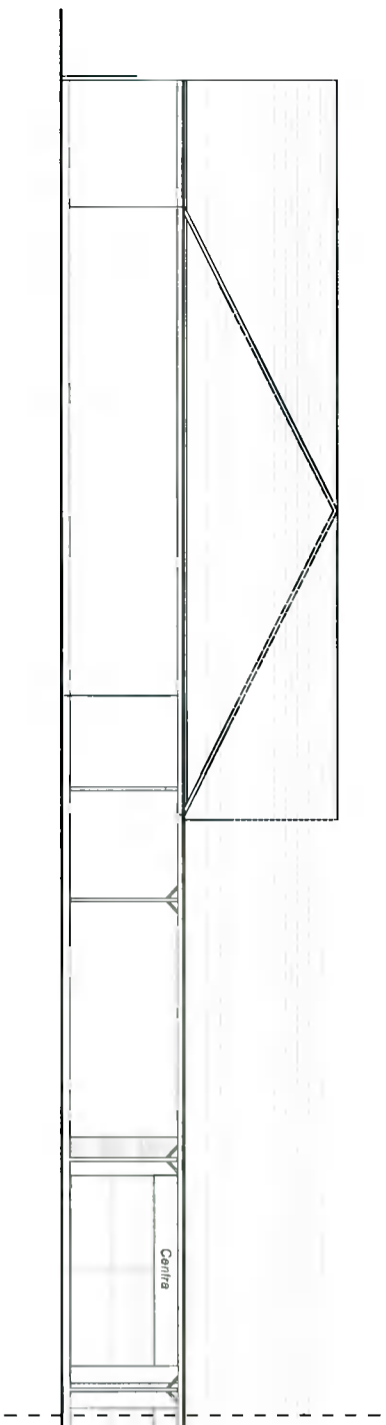

SOUTH WEST FACING ELEVATION
Proposed Contiguous, 1:200

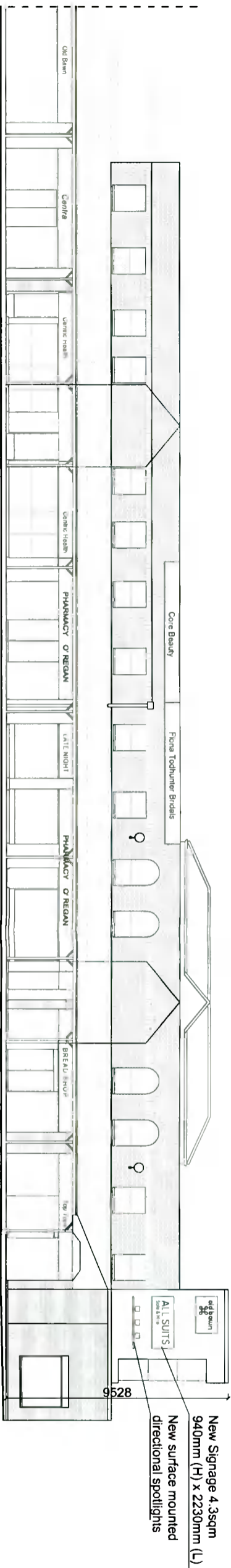

New Signage 4.3sqm
940mm (H) x 2230mm (L)
New surface mounted
directional spotlights

REVISIONS	
-----------	--

THIS DRAWING IS COPYRIGHT
DIMENSIONS TO BE USED IN ALL CASES

JOB

All Suits
Unit 18 Old Bawn Shopping Centre
Tallaght
Dublin D24 PPGF

CLIENT
Julian Judge

TITLE
SOUTH WEST FACING ELEVATION
Existing & Proposed Contiguous

DATE	NOVEMBER 2021	DRN	CB
SCALE	AS INDICATED	CHECKED	BM
CAD FILE REF	1928	NUMBER	REVISION
		1928-PL-303	

ROBIN MANDAL
ARCHITECTS

THE COURTYARD, 40 MAIN STREET
BLACKROCK COUNTY DUBLIN
T (01) 2796184
F (01) 2836923
W www.robinmandal.ie
E rma@robinmandal.ie