

AS PROPOSED

STEPHEN MASON
ARCHITECTURAL AND PLANNING SERVICES
2 CLONKEEVEY, CASTLERAHAN,
BALLYJAMESDUFF, CO DUBLIN
TEL: 087 748 4003



PLANNING APPLICATION DRAWING
ADDITIONAL INFORMATION
DRG NO 400 / 07 A
SCALE 1 TO 100
DATE JUNE 2021

PLANNING PERMISSION FOR RETENTION SOUGHT FOR: (1) THE REMOVAL OF THE GROUND FLOOR INTERNAL COURTYARD WITH CANOPY OVER AS PER PLANNING REF. SD013A/0047. WORKS TO INCLUDE: (A) EXTERNAL CANOPY ABOVE ROOF LEVEL REMOVED (B) NEW STORAGE ROOM CREATED AT FIRST FLOOR LEVEL (C) GROUND FLOOR AREA INCORPORATED INTO LOUNGE AREA WITHIN BUILDING (D) REDUCTION IN SIZE OF LOUNGE PUBLIC FLOOR AREA WITHIN BUILDING (E) INTERNAL WALLS FORMING SNUG DEMOLISHED COMPLETE. FLOOR AREA INCLUDED WITHIN LOUNGE AREA (3) KITCHEN EXTENSION WITHIN PART OF PREVIOUS LOUNGE PUBLIC FLOOR AREA (4) RELOCATION OF OFF LICENCE INTO PREVIOUS LOUNGE AREA (5) CHANGE OF USE OF PREVIOUS OFF LICENCE TO TAKEAWAY (6) NEW WINDOW TO OFF LICENCE WITHIN BUILDING ELEVATION FACING CAR PARK (7) REMOVE INTERNAL DOORS BETWEEN LOUNGE AREA AND ENTRANCE

REVISION A - 25-10-2021
DRAWING REVISED FOR ADDITIONAL INFORMATION SUBMISSION
- DRAINAGE ADDED
- NEW EXTERNAL DOOR FROM LOUNGE AREA TO OPEN SPACE REMOVED

ORDNANCE SURVEY PLAN REF
MAP SERIES: 1:1000
MAP SHEETS: 3325-05, 3327-01
ITM CENTRE POINT CO-ORDINATE
X,Y = 707966, 731577

PLANNING PERMISSION FOR RETENTION SOUGHT FOR: (1) THE REMOVAL OF THE GROUND FLOOR INTERNAL COURTYARD WITH CANOPY OVER AS PER PLANNING REF. SD013A/0047. WORKS TO INCLUDE: (A) EXTERNAL CANOPY ABOVE ROOF LEVEL REMOVED (B) NEW STORAGE ROOM CREATED AT FIRST FLOOR LEVEL (C) GROUND FLOOR AREA INCORPORATED INTO LOUNGE AREA WITHIN BUILDING (D) REDUCTION IN SIZE OF LOUNGE PUBLIC FLOOR AREA WITHIN BUILDING (E) INTERNAL WALLS FORMING SNUG DEMOLISHED COMPLETE. FLOOR AREA INCLUDED WITHIN LOUNGE AREA (3) KITCHEN EXTENSION WITHIN PART OF PREVIOUS LOUNGE AREA (4) RELOCATION OF OFF LICENCE INTO PREVIOUS LOUNGE AREA (5) CHANGE OF USE OF PREVIOUS OFF LICENCE TO TAKEAWAY (6) NEW WINDOW TO OFF LICENCE WITHIN BUILDING ELEVATION FACING CAR PARK (7) REMOVE INTERNAL DOORS BETWEEN LOUNGE AREA AND ENTRANCE

AS PROPOSED

SCHEDULE OF AREAS - AS EXISTING	
GROUND FLOOR	
LOUNGE	184 M2
BAR	70 M2
KITCHEN	84 M2
OFF LICENCE - NEW	47 M2
TAKEAWAY - EXG	36 M2
TAKEAWAY - NEW	60 M2
COMMON AREAS / TOILETS	144 M2
TOTAL GROUND FLOOR	625 M2
FIRST FLOOR	
FUNCTION ROOM	188 M2
STAFF AREA/STORAGE	55 M2
RESTAURANT	206 M2
COMMON AREAS / TOILETS	130 M2
TOTAL FIRST FLOOR	579 M2
SECOND FLOOR	
COMMON AREAS / TOILETS	24 M2
TOTAL SECOND FLOOR	24 M2
TOTAL FLOOR AREA	1228 M2

- (a) exg door removed and opening infilled
- (b) exg wall demolished
- (c) exg door removed part wall demolished part infill door opening to form new opening lintel support to suit
- (d) form new door opening within exg wall lintel support to suit
- exg existing door position
- existing wall / door to be demolished / removed
- form new opening within existing wall for access to kitchen extension
- (3) KITCHEN EXTENSION WITHIN PART OF PREVIOUS LOUNGE PUBLIC FLOOR AREA
- (2C) INTERNAL WALLS FORMING SNUG DEMOLISHED COMPLETE. FLOOR AREA INCLUDED WITHIN LOUNGE PUBLIC FLOOR AREA

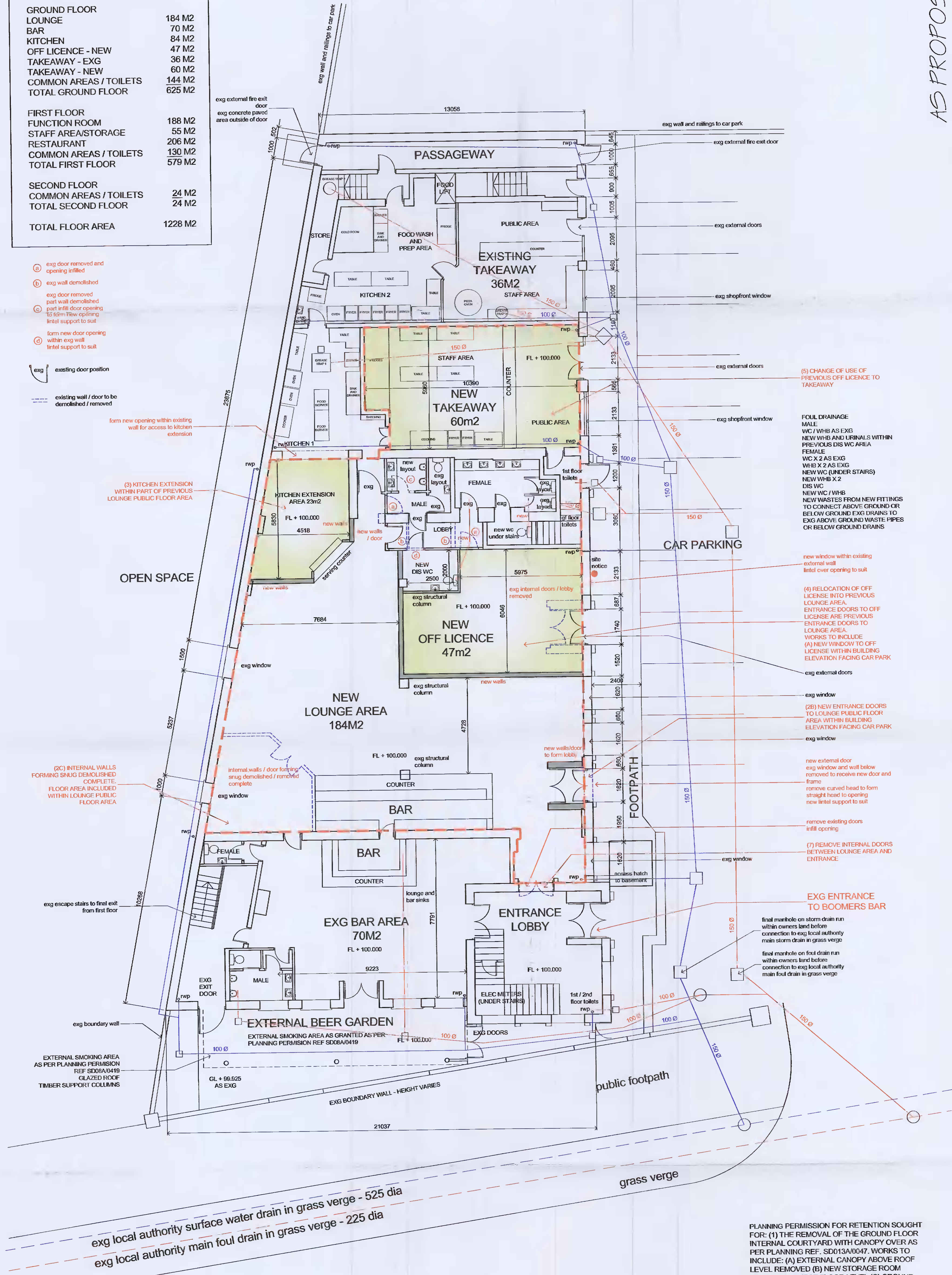

GROUND FLOOR PLAN AS PROPOSED

380M2

EXTENTS OF FLOOR AREA (360M2) FOR WHICH THIS PLANNING APPLICATION REFERS

FIRST FLOOR PLAN (2) AND SECOND FLOOR PLAN (2)
NO CHANGES
NOT AFFECTED BY THIS PLANNING APPLICATION



PLANNING PERMISSION FOR RETENTION SOUGHT FOR: (1) THE REMOVAL OF THE GROUND FLOOR INTERNAL COURTYARD WITH CANOPY OVER AS PER PLANNING REF. SD013A/0047. WORKS TO INCLUDE: (A) EXTERNAL CANOPY ABOVE ROOF LEVEL REMOVED (B) NEW STORAGE ROOM CREATED AT FIRST FLOOR LEVEL (C) GROUND FLOOR AREA INCORPORATED INTO LOUNGE AREA WITHIN BUILDING (D) REDUCTION IN SIZE OF LOUNGE PUBLIC FLOOR AREA WITHIN BUILDING (E) INTERNAL WALLS FORMING SNUG DEMOLISHED COMPLETE. FLOOR AREA INCLUDED WITHIN LOUNGE AREA (3) KITCHEN EXTENSION WITHIN PART OF PREVIOUS LOUNGE AREA (4) RELOCATION OF OFF LICENCE INTO PREVIOUS LOUNGE AREA (5) CHANGE OF USE OF PREVIOUS OFF LICENCE TO TAKEAWAY (6) NEW WINDOW TO OFF LICENCE WITHIN BUILDING ELEVATION FACING CAR PARK (7) REMOVE INTERNAL DOORS BETWEEN LOUNGE AREA AND ENTRANCE