

Do not scale from this drawing. All dimensions to be taken from Architect's drawings. Discrepancies to be referred to the Architect for clarification. The copyright of this drawing is vested in the Architect. This drawing may not be copied or reproduced without written consent.

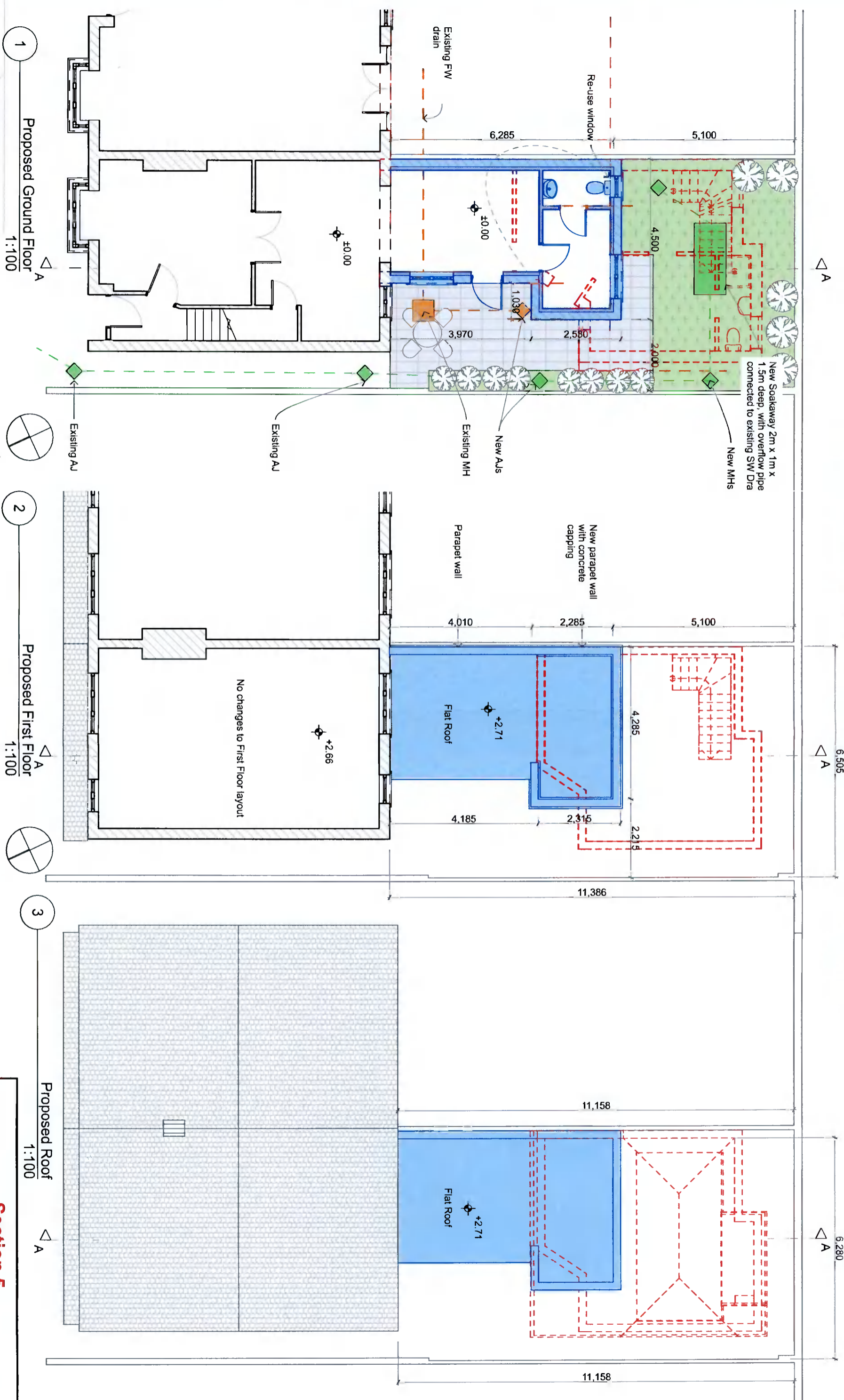

| FLOOR ID | Room Name | Floor Area |
|----------|-----------|------------|
|----------|-----------|------------|

Legend:

- Existing walls to be retained
- Existing walls to be demolished
- New walls to be constructed

Job title

**New Extension to Rear of 11 Sundale Parade, Jobstown, Dublin 24 for Joy Joseph**

Job no.

4783

Sheet no.

DEC06

Scale

as indicated @ A3

Issue

**03**

**PROPOSED FLOOR PLANS**

Drawn by

Piotr Alama, MRIAI

Checked by

Tony Mullen, FRIAI

Date

11/10/2021

**Section 5**

**TONY MULLEN Architects**

10 - 11 Marina Terrace,  
Dun Laoghaire, Co. Dublin

T: +353 1 284 42 42  
F: +353 1 284 42 43  
E: t.mullen@tonymullen.ie  
W: www.tonymullen.ie

