



- LEGEND:**
-  COLUMN 8M POLE MOUNTED ROAD LIGHT WITH 1M OUTREACH
MODEL: XSP1E - H - TYPE 3SH - 9AW 4000K
 -  COLUMN 6M POLE MOUNTED ROAD LIGHT WITH 1M OUTREACH
MODEL: CXSP1E - H - TYPE 3SH - 63W 4000K



- FOR SETTING OUT REFER TO ARCHITECT'S DRAWINGS.
- THIS DRAWING TO BE READ IN CONJUNCTION WITH ALL OTHER ARCHITECTURAL AND ENGINEERING DRAWINGS AND ALL OTHER RELEVANT DRAWINGS AND SPECIFICATIONS.
- DO NOT SCALE THIS DRAWING. USE FIGURED DIMENSIONS ONLY.
- NO PART OF THIS DOCUMENT MAY BE REPRODUCED OR TRANSMITTED IN ANY FORM OR STORED IN ANY RETRIEVAL SYSTEM OF ANY NATURE WITHOUT THE WRITTEN PERMISSION OF O'CONNOR SUTTON CROMIN AS COPYRIGHT HOLDER EXCEPT AS AGREED FOR USE ON THE PROJECT FOR WHICH THE DOCUMENT WAS ORIGINALLY ISSUED.

Rev No.	Date	Revision Note	Dwn by	Chkd by
PO1	13.08.21	For Planning	G.M.	T.J.
PO2	13.08.21	For Planning	G.M.	T.J.
PO3	12.10.21	UPDATED BACKGROUND FOR PLANNING	B.O.B.	T.D.

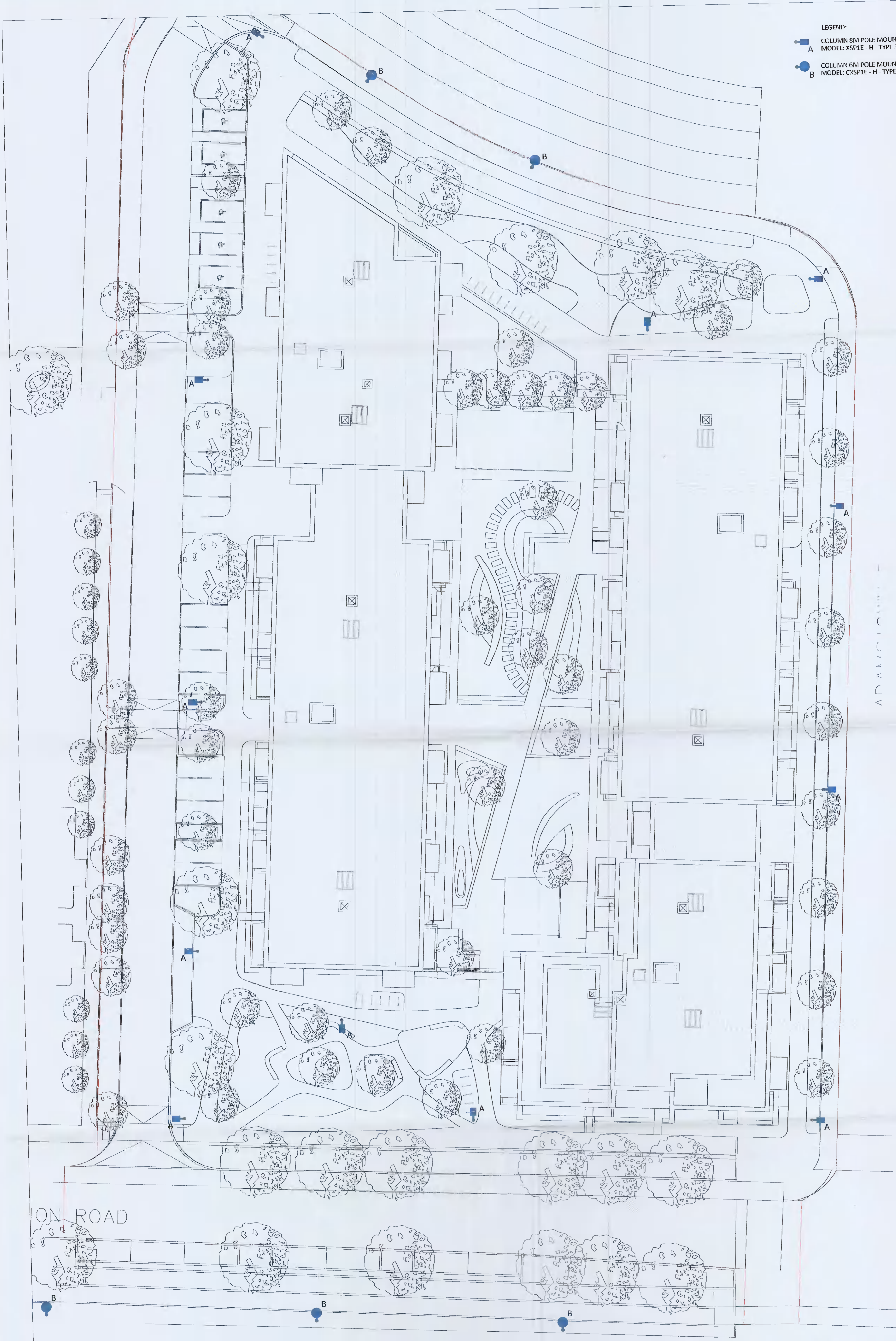

Head Office,
9 Prussia Street,
Dublin 7,
D07 KT57

TEL +353 (0)1 8682000

e: contactus@ocsc.ie
w: www.ocsc.ie

Dublin | London | Belfast | Galway | Cork | Birmingham



Client: QUINTAIN IRELAND LTD.
Project: ADAMSTOWN STATION
BLOCK G
Title: PUBLIC LIGHTING LAYOUT

Code	Originator	Zone	Level	Type	Role	Number	Status	Revision
H618	OCSC	XX	XX	SK	E	001	S4	P03

Date: 13.08.21 Scale: 1:200 @ A1 Dwn by: GM Chkd by: GM Aprvd by: TJ