

- LIST OF IRISH WATER STANDARD DETAILS BROUGHT INTO THE CONTRACT
- STD-W-04 GENERAL PIPE CONNECTIONS (SHEET 1 OF 7)
 - STD-W-05 GENERAL PIPE CONNECTIONS (SHEET 2 OF 7)
 - STD-W-06 GENERAL PIPE CONNECTIONS (SHEET 3 OF 7)
 - STD-W-07 GENERAL PIPE CONNECTIONS (SHEET 4 OF 7)
 - STD-W-08 GENERAL PIPE CONNECTIONS (SHEET 5 OF 7)
 - STD-W-09 GENERAL PIPE CONNECTIONS (SHEET 6 OF 7)
 - STD-W-10 GENERAL PIPE CONNECTIONS (SHEET 7 OF 7)
 - STD-W-11 TYPICAL SERVICE LAYOUT INDICATING SEPARATION DISTANCES
 - STD-W-12 RESTRICTIONS ON TREES / SHRUBS PLANTING ADJACENT TO MAINWORKS
 - STD-W-13 TRENCH BACKFILL & BEDDING
 - STD-W-14 SLURRY WALL FOR DUCTILE IRON (D.I.) PIPE ($\leq 350\text{mm}$ DIA.) (SHEET 1 OF 2)
 - STD-W-15 SLURRY WALL FOR POLYETHYLENE (P.E.) PIPE ($\leq 350\text{mm}$ DIA.) (SHEET 2 OF 2)
 - STD-W-16 ON-LINE HYDRANT FOR DUCTILE IRON (D.I.) PIPE (SHEET 1 OF 4)
 - STD-W-17 OFF-LINE HYDRANT FOR DUCTILE IRON (D.I.) PIPE (SHEET 2 OF 4)
 - STD-W-18 ON-LINE HYDRANT FOR POLYETHYLENE (P.E.) PIPE (SHEET 3 OF 4)
 - STD-W-19 OFF-LINE HYDRANT FOR POLYETHYLENE (P.E.) PIPE (SHEET 4 OF 4)
 - STD-W-20 ON-LINE AIR VALVE FOR DUCTILE IRON (D.I.) PIPE (SHEET 1 OF 4)
 - STD-W-21 OFF-LINE AIR VALVE FOR DUCTILE IRON (D.I.) PIPE (SHEET 2 OF 4)
 - STD-W-22 ON-LINE AIR VALVE FOR POLYETHYLENE (P.E.) PIPE (SHEET 3 OF 4)
 - STD-W-23 OFF-LINE AIR VALVE FOR POLYETHYLENE (P.E.) PIPE (SHEET 4 OF 4)
 - STD-W-24 PRESSURE REDUCING / STANDING VALVE (RM/P.S.V.) CHAMBER
 - STD-W-25 METER CHAMBER ($\leq 300\text{mm}$ DIA.)
 - STD-W-27 MARKER POSTS / PLATES
 - STD-W-28 WATER MAIN THRUST & SUPPORT BLOCKS
 - STD-W-30 SCOUR CHAMBER & HEAD WALL ARRANGEMENTS
 - STD-W-30A WOODEN HYDRANT
 - STD-W-31 TYPICAL DITCH / STREAM CROSSING FOR WATER MAIN

- LIST OF IRISH WATER WASTEWATER STANDARD DETAILS BROUGHT INTO THE CONTRACT
- STD-WW-02 TYPICAL LAYOUT FOR SEWER WITHIN NEW DEVELOPMENT
 - STD-WW-03 DRAIN AND SERVICE CONNECTION PIPEWORK
 - STD-WW-04 TYPICAL SERVICE/SEWER PIPE CONNECTION
 - STD-WW-05 TYPICAL SERVICE LAYOUT INDICATING SEPARATION DISTANCES
 - STD-WW-06 RESTRICTIONS ON TREES/SHRUBS PLANTING ADJACENT TO SEWERS
 - STD-WW-07 TRENCH BACKFILL & BEDDING
 - STD-WW-08 CONCRETE BED, MANHOLE & SURROUNDING TO WASTEWATER PIPES
 - STD-WW-09 BLOODWORM MANHOLE ($\leq 300\text{mm}$ DIA.)
 - STD-WW-10 PRE-CAST CONCRETE MANHOLE
 - STD-WW-11 IN-SITU CONCRETE MANHOLE
 - STD-WW-12 BACKDROP MANHOLE
 - STD-WW-13 FRAME SIZE INSPECTION CHAMBER

- NOTES
- ALL DRAWINGS TO BE CHECKED BY CONTRACTOR ON SITE AND ENGINEER INFORMED OF DISCREPANCIES BEFORE WORK COMMENCES
 - ALL LEVELS ARE IN METRES AND ARE RELATED TO ORDNANCE DATUM
 - ALL DIMENSIONS TO BE IN MILLIMETERS UNLESS NOTED OTHERWISE
 - CONTRACTOR SHALL SATISFY HIMSELF AS TO THE ACCURACY OF PAVEMENT LEVELS ON SITE PRIOR TO COMMENCEMENT OF WORKS ON SITE
 - ALL SURFACE WATER DRAINAGE WORKS TO BE IN ACCORDANCE WITH THE REQUIREMENTS OF THE LOCAL AUTHORITY'S CODE OF PRACTICE FOR DRAINAGE AND THE CDSOS
 - ALL SURFACE WATER SEWERS TO BE CLASS H CONCRETE TO EN1916 & IS 6 2004.
 - ALL FOUL DRAINAGE WORKS TO BE IN ACCORDANCE WITH IRISH WATER'S CODE OF PRACTICE FOR WASTEWATER SUPPLY AND WASTEWATER INFRASTRUCTURE STANDARD DETAILS.
 - FOUL SEWERS TO BE THERMOPLASTIC STRUCTURED WALL PIPES (COMPLYING WITH THE PROVISION OF IS EN 13476 AND WS 4-35-01 2000) AND COMPLY WITH THE REQUIREMENTS OF THE IRISH WATER CODE OF PRACTICE
 - WATERMAIN INSTALLATION AND ALL WATER SUPPLY WORKS TO BE IN ACCORDANCE WITH THE REQUIREMENTS OF IRISH WATER'S CODE OF PRACTICE FOR WATER SUPPLY AND WATER INFRASTRUCTURE STANDARD DETAILS
 - WATERMANS TO BE TYPE HPPE, PE-100, SDR-17 RATED AND SHALL CONFORM TO IS EN 12201 (PART 1, PART 2 & PART 3)
 - WATERMAIN SERVICE CONNECTION PIPES TO BE HDPE (PE-80) MATERIAL WITH SDR-17 RATING
 - ANCHOR BLOCKS TO BE POSITIONED AT DEAD ENDS, TEES, BENDS AND AT EACH SIDE OF HYDRANTS AND VALVES IN ACCORDANCE WITH THE REQUIREMENTS OF IRISH WATER STANDARD DETAIL STD-W-28 (WATER MAIN THRUST AND SUPPORT BLOCKS)
 - HYDRANT OUTLET TO BE 200mm BELOW GROUND LEVEL UNLESS REQUESTED OTHERWISE.
 - WHERE COVER TO PIPE IS LESS THAN 900mm IN GREEN AREAS AND 1200mm IN TRAFFICKED AREAS, ENCASE PIPE IN NEW 150mm CONCRETE WITH MOVEMENT JOINTS.

- LEGEND
- Proposed Surface Water Manhole
 - Proposed Surface Water Sewer
 - Proposed Surface Water Downpipe with Rooding Eye
 - Proposed Linear Surface Drain (ACC OSA)
 - Proposed Linear Surface Drain at Basement Slab Level (ACC OSA)
 - Existing Surface Water Sewer
 - Site Boundary
 - Proposed Building
 - Proposed Footpath
 - Proposed Roadway
 - Proposed Permeable Paving
 - Extent of Basement

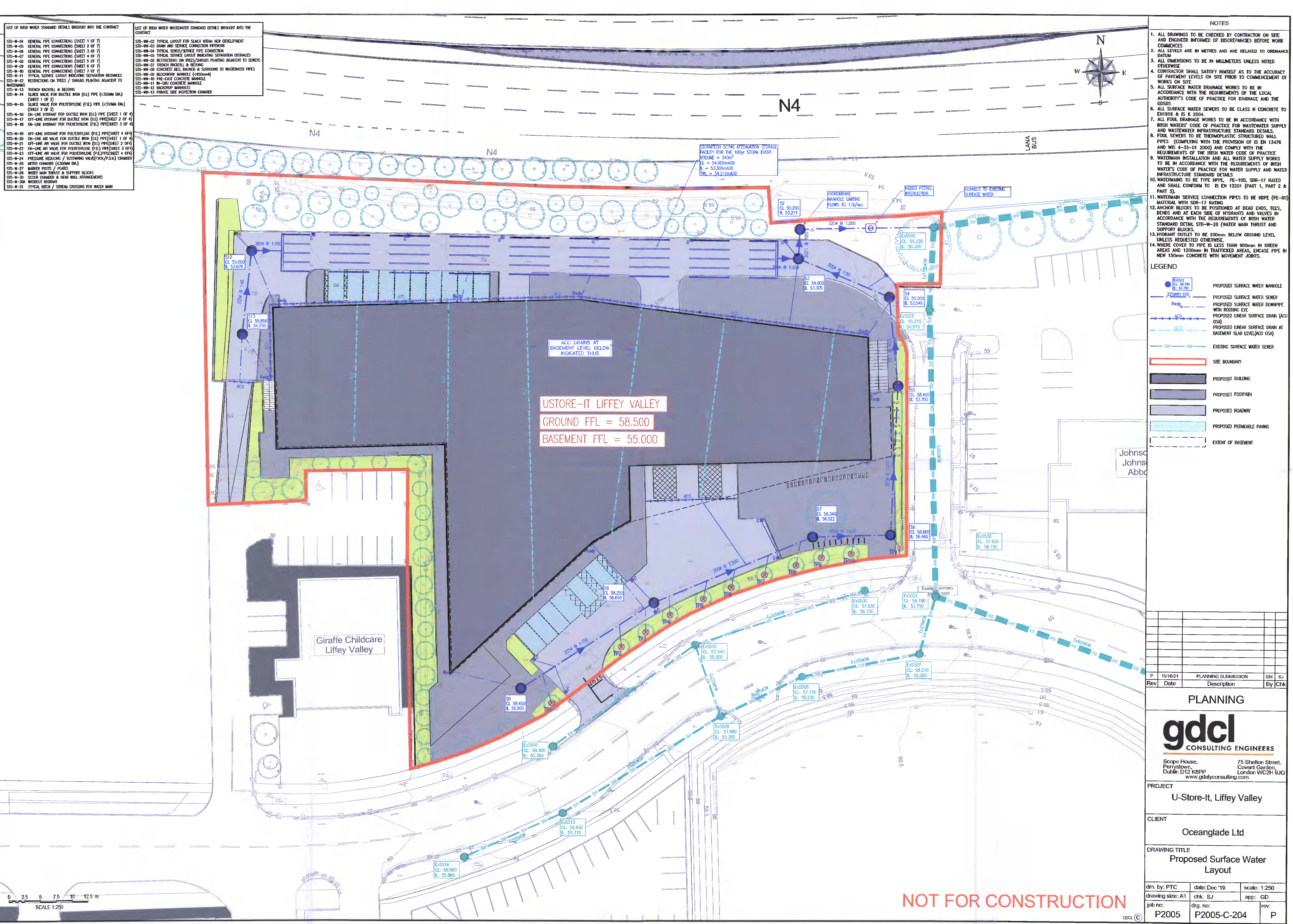

USTORE-IT LIFFEY VALLEY
 GROUND FFL = 58.500
 BASEMENT FFL = 55.000

NOT FOR CONSTRUCTION

Rev	Date	Description	SM	SJ	By	Chk
P	15/10/21	PLANNING SUBMISSION				

PLANNING

gdcl
CONSULTING ENGINEERS

Scope House, 75 Shelton Street, Covent Garden, London WC2H 9JQ
 Peryglstown, Dublin D12 K8PP
 www.gdatyconsulting.com

PROJECT
U-Store-It, Liffey Valley

CLIENT
Oceanglade Ltd

DRAWING TITLE
Proposed Surface Water Layout

dm. by: PTC	date: Dec '19	scale: 1:250
drawing size: A1	chk: SJ	app: GD
job no: P2005	drg. no: P2005-C-204	rev: P