

- LIST OF IRISH WATER WASTEWATER STANDARD DETAILS BROUGHT INTO THE CONTRACT
- STD-WW-02 TYPICAL LAYOUT FOR SEWER WITH NEW DEVELOPMENT
 - STD-WW-03 DRAIN AND SERVICE CONNECTION PIPEWORK
 - STD-WW-04 TYPICAL SEWER/SERVICE PIPE CONNECTION
 - STD-WW-05 TYPICAL SEWER LAYOUT INCLUDING SEPARATION DISTANCES
 - STD-WW-06 RESTRICTIONS ON TREES/SHRUBS PLANTING ADJACENT TO SEWERS
 - STD-WW-07 TRENCH SHORING & BEDDING
 - STD-WW-08 CONCRETE BED, HAUNCH & SURROUND TO WASTEWATER PIPES
 - STD-WW-09 BLOCKWORK MANHOLE (450mm)
 - STD-WW-10 PRE-CAST CONCRETE MANHOLE
 - STD-WW-11 IN-SITU CONCRETE MANHOLE
 - STD-WW-12 BACKSTOP MANHOLES
 - STD-WW-13 PRIVATE SITE INSPECTION CHAMBER

NOTES

1. ALL DRAWINGS TO BE CHECKED BY CONTRACTOR ON SITE AND ENGINEER INFORMED OF DISCREPANCIES BEFORE WORK COMMENCES
2. ALL LEVELS ARE IN METRES AND ARE RELATED TO ORDNANCE DATUM
3. ALL DIMENSIONS TO BE IN MILLIMETERS UNLESS NOTED OTHERWISE
4. CONTRACTOR SHALL SATISFY HIMSELF AS TO THE ACCURACY OF PAVEMENT LEVELS ON SITE PRIOR TO COMMENCEMENT OF WORKS ON SITE
5. ALL SURFACE WATER DRAINAGE WORKS TO BE IN ACCORDANCE WITH THE REQUIREMENTS OF THE LOCAL AUTHORITY'S CODE OF PRACTICE FOR DRAINAGE AND THE GDSIS
6. ALL SURFACE WATER SEWERS TO BE CLASS H CONCRETE TO EN1916 & IS 6 2004.
7. ALL FOUL DRAINAGE WORKS TO BE IN ACCORDANCE WITH IRISH WATER'S CODE OF PRACTICE FOR WASTEWATER SUPPLY AND WASTEWATER INFRASTRUCTURE STANDARD DETAILS.
8. FOUL SEWERS TO BE THERMOPLASTIC STRUCTURED WALL PIPES (COMPLYING WITH THE PROVISION OF IS EN 13476 AND WIS 4-35-01 2000) AND COMPLY WITH THE REQUIREMENTS OF THE IRISH WATER CODE OF PRACTICE
9. WATERMAIN INSTALLATION AND ALL WATER SUPPLY WORKS TO BE IN ACCORDANCE WITH THE REQUIREMENTS OF IRISH WATER'S CODE OF PRACTICE FOR WATER SUPPLY AND WATER INFRASTRUCTURE STANDARD DETAILS
10. WATERMANS TO BE TYPE HPPE, PE-100, SDR-17 RATED AND SHALL CONFORM TO IS EN 12201 (PART 1, PART 2 & PART 3).
11. WATERMAIN SERVICE CONNECTION PIPES TO BE HDPE (PE-80) MATERIAL WITH SDR-17 RATING
12. ANCHOR BLOCKS TO BE POSITIONED AT DEAD ENDS, TEES, BENDS AND AT EACH SIDE OF HYDRANTS AND VALVES IN ACCORDANCE WITH THE REQUIREMENTS OF IRISH WATER STANDARD DETAIL STD-W-28 (WATER MAIN THRUST AND SUPPORT BLOCKS).
13. HYDRANT OUTLET TO BE 200mm BELOW GROUND LEVEL UNLESS REQUESTED OTHERWISE.
14. WHERE COVER TO PIPE IS LESS THAN 900mm IN GREEN AREAS AND 1200mm IN TRAFFICKED AREAS, ENCASE PIPE IN NEW 150mm CONCRETE WITH MOVEMENT JOINTS.

- LEGEND
- E/F507 CL: 58.300 IL: 54.300 PROPOSED FOUL MANHOLE
 - 225 x 110 PROPOSED FOUL SEWER
 - F4 PROPOSED FOUL DOWNPIPE WITH RODDING EYE
 - F5 PROPOSED FOUL COLLECTOR DRAIN
 - FS EXISTING FOUL SEWER
 - SITE BOUNDARY
 - PROPOSED BUILDING
 - PROPOSED FOOTPATH
 - PROPOSED ROADWAY
 - EXTENT OF BASEMENT

U-STORE-IT LIFFEY VALLEY
 GROUND FFL = 58.500
 BASEMENT FFL = 55.000

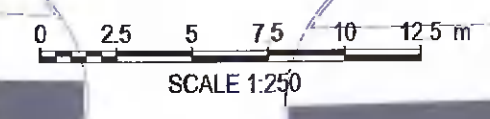
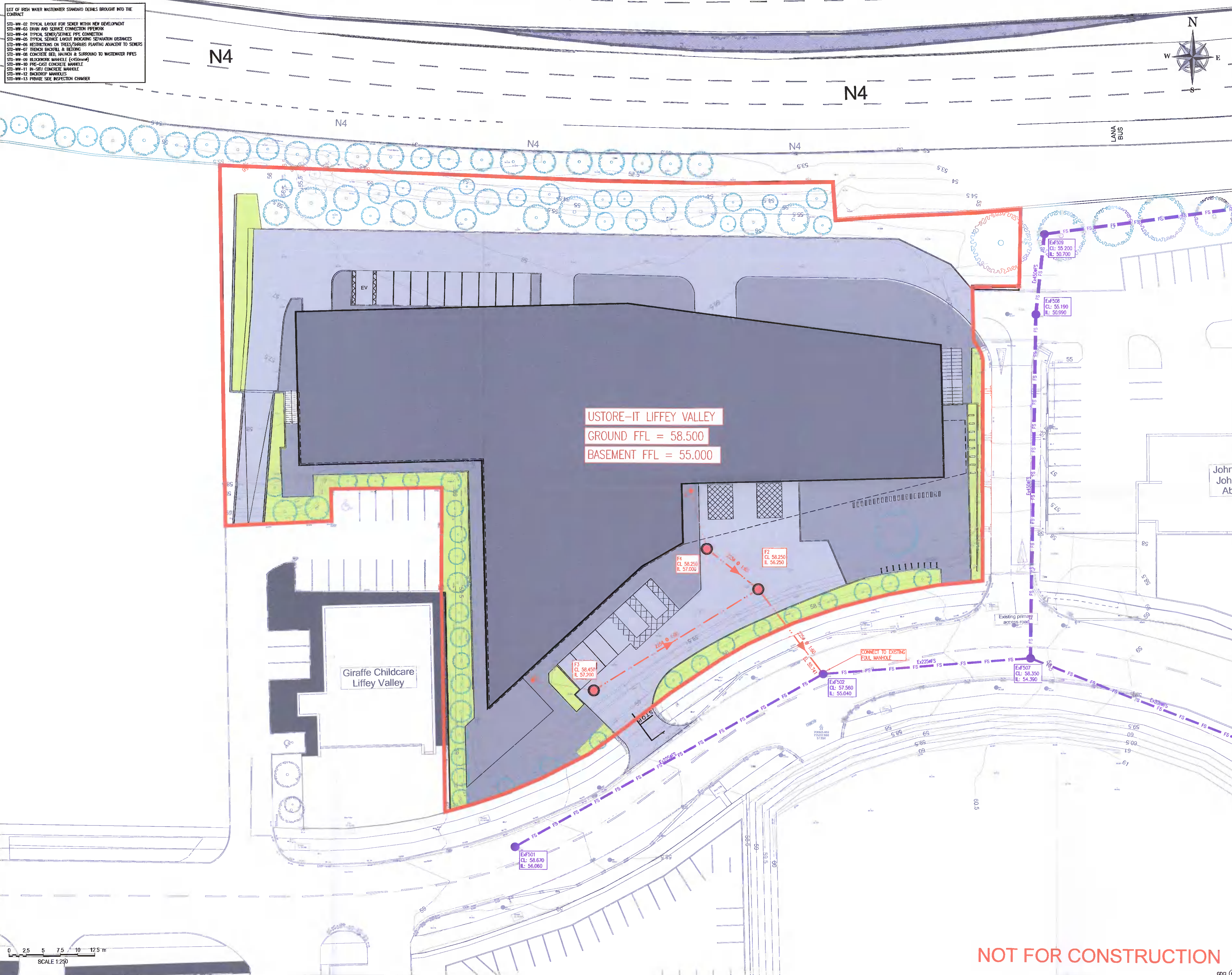

Rev	Date	Description	SM	SJ
P	15/10/21	PLANNING SUBMISSION	SM	SJ

PLANNING

gdcl
CONSULTING ENGINEERS

Scope House, 75 Shelton Street, Covent Garden, Dublin D12 K8PP London WC2H 8JQ www.gdalyc consulting.com

PROJECT
U-Store-It, Liffey Valley

CLIENT
Oceanglade Ltd

DRAWING TITLE
Proposed Foul Sewer Layout

drn. by: PTC	date: Dec '19	scale: 1:250
drawing size: A1	chk: SJ	app: CD
job no: P2005	drg. no: P2005-C-203	rev: P

NOT FOR CONSTRUCTION