

Drawing : Proposed Section B-B

- EXISTING WORK
- NEW WORK

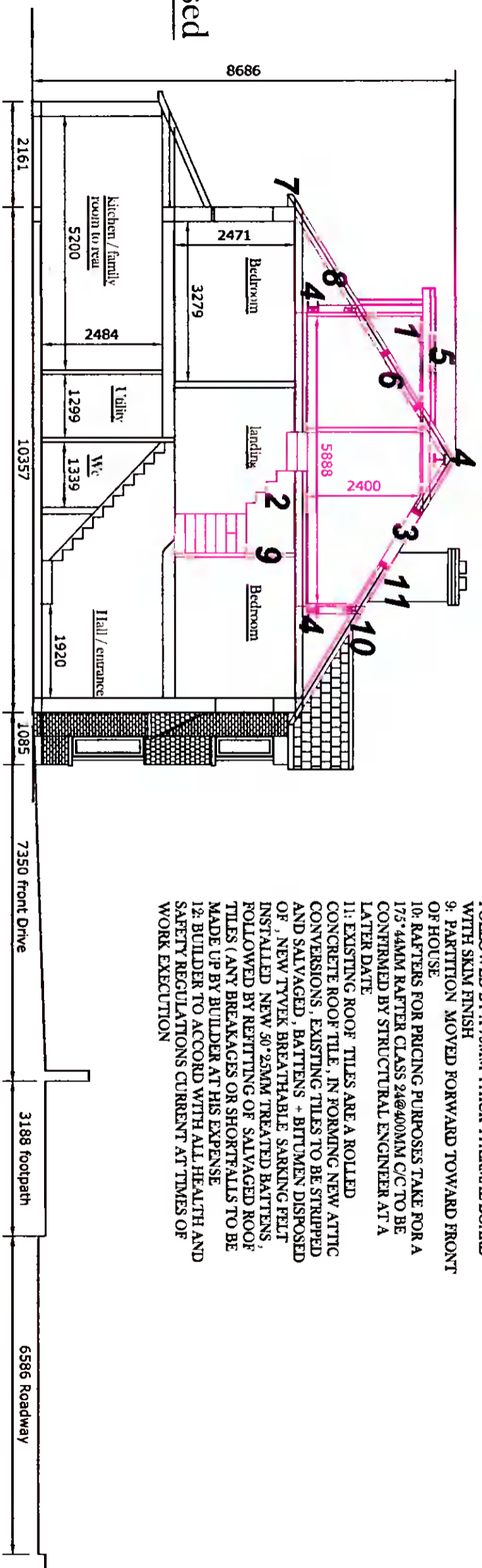

- 1: NEWLY FORMED DORMER WINDOW STRUCTURE TO REAR WALLS TO BE 20MM THICK EXTERNAL RENDER (PAINTED) ON EXPANDED METAL ON 18MM OSB ON 100MM EXTERNAL POLYSTYRENE INSULATION ON LIQUID VAPOUR CHECK ON 18MM OSB ON 150' 44MM STUD FRAME
- 2: NEW STAIRS TO ATTIC TO BE BUILDING REGULATORY COMPLIANT MINIMUM 800MM WIDE, 2100MM MINIMUM HEADROOM HEIGHT TO BE MAINTAINED ON STAIRS
- 3: NEW 660' 1400MM LONG VELUX SERVING ATTIC LANDING
- 4: STRUCTURAL STEEL BEAMS SPANNING FROM CABLE WALL TO PARTY WALL SUPPORTING ROOF & ATTIC FLOOR STRUCTURE TO LATER STRUCTURAL ENGINEERS DETAILS FOR PRICING PURPOSES TAKE FOR A 46KG BEAM AT THESE POINTS RESTING ON SOLID CONCRETE BEARING PADS IN WALLS
- 5: PARALON WARM ROOF (SPECIFICATION TO BE APPROVED BY MOY MATERIALS) PARALON CAP AND ASE SHEET ON LIGHT OSB ON 125MM PARATORCH LAID TO FALLS ON LIQUID VAPOUR CHECK ON 18MM OSB COVERING ON CEILING RAFTERS
- 6: 660' 1178MM VELUX
- 7: PVC FASCIA AND SOFFIT TO DORMER
- 8: EXISTING RAFTERS STRIPPED OUT , NEW 175' 44 CLASS 24 RAFTER INSTALLED @ 400C/C, 125MM POLYURETHANE INSULATION PLACED BETWEEN RAFTERS FROM WALL PLATE TO RIDGE, TO UNDERSIDE OF RAFTERS INTELLU AIR-TIGHTNESS MEMBRANE FROM WALL PLATE TO RIDGE
- 9: COUNTER BATTEN WITH 50' 50 BATTENS @ 400 C/C, FOLLOWED BY A 75MM THICK THERMAL BOARD WITH SKIM FINISH
- 10: PARTITION MOVED FORWARD TOWARD FRONT OF HOUSE
- 11: RAFTERS FOR PRICING PURPOSES TAKE FOR A 175' 44MM RAFTER CLASS 24@400MM C/C TO BE CONFIRMED BY STRUCTURAL ENGINEER AT A LATER DATE
- 12: EXISTING ROOF TILES ARE A ROLLED CONCRETE ROOF TILE, IN FORMING NEW ATTIC CONVERSIONS, EXISTING TILES TO BE STRIPPED AND SALVAGED. BATTENS + BITUMEN DISPOSED OF, NEW TYVEK BREATHABLE SARKING FELT INSTALLED NEW 50' 25MM TREATED BATTENS, FOLLOWED BY RETITING OF SALVAGED ROOF TILES (ANY BREAKAGES OR SHORTFALLS TO BE MADE UP BY BUILDER AT HIS EXPENSE
- 13: BUILDER TO ACCORD WITH ALL HEALTH AND SAFETY REGULATIONS CURRENT AT TIMES OF WORK EXECUTION

Drawing:	Proposed Section B-B
Project:	Carl Flynn aim applying for full planning permission, for conversion of attic to useable storage space, for placement of 3 new velux windows in roof to rear, and 1 dormer window and 1 velux window in roof to rear, for removal of hip section of main roof and building up gable back wall to form a dormer hip, for insertion of new window in gable wall at ridge level, at 4 Eden Grove, Rathfarnham, Dublin 18
Prepared by:	Michael Finnan (MCS:SI) C/O Bods Ltd, Lower Friarstown, Bohernabreena, Dublin 24 Ph: 087-2825326 Email: Michael.finnan045@gmail.com
Date:	13-10-2021
Scale:	1: 100
Drawing No.:	5

Please Note: Any site dimension discrepancy with these planning application drawings to be notified to author immediately.