

Red dashed line indicates extent of amendments to proposal from previous planning application SDZ21A/0007

H.J.L Drawing Number on previously lodged planning application (SDZ21A/0007)  
ADC-HJL-G-ZZ-DR-A-2010 Revision (P02)

ALL DIMENSIONS TO BE CHECKED ON-SITE  
NO DIMENSIONS TO BE SCALED FROM THIS DRAWING  
DRAWING IS TO BE READ IN CONJUNCTION WITH RELEVANT CONSULTANTS DRAWINGS

Legend:

Irish Transverse Mercator (ITM)  
MALIN HEAD LEVELLING DATUM  
OSI Licence No.: 60145077

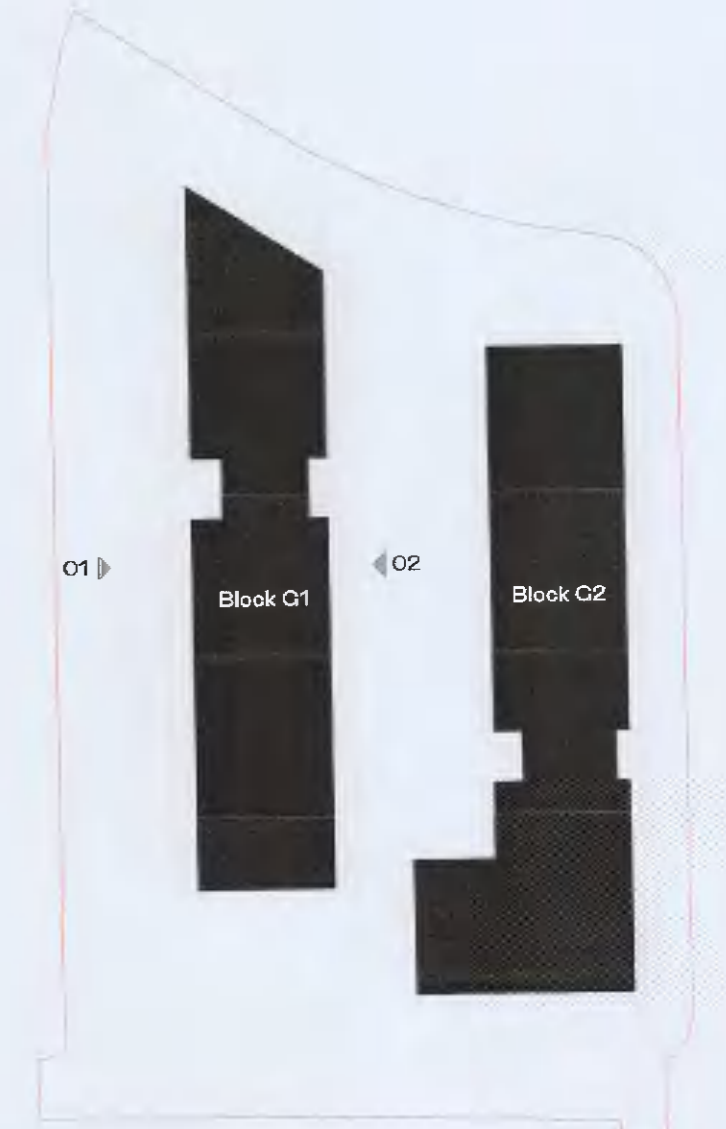

ELEVATION MATERIAL LEGEND

- BC 01 SELECTED BICYCLE STORE RAILING
- BL 01 BALCONY SYSTEM WITH PPC METAL RAILING
- BL 02 BALCONY SYSTEM WITH GLAZED BALUSTRADE
- BR 01 SELECTED LIGHT COLOURED BRICK
- BR 02 SELECTED DARK COLOURED BRICK
- BR 03 SELECTED GLAZED BRICK
- BR 04 SELECTED HIT AND MISS BRICK
- BR 05 SELECTED GLAZED HIT AND MISS BRICK
- CW 01 SELECTED CURTAIN WALL GLAZING SYSTEM
- DR 01 SELECTED GLAZED ENTRANCE DOOR AND SIGNAGE
- ES 01 ESB DOORS
- CL 01 SELECTED DOUBLE GLAZED WINDOW SYSTEM
- RE 01 EXTERNAL INSULATED RENDER FINISH
- RL 01 SELECTED RAILING SYSTEM
- RS 01 SELECTED METAL RAINSCREEN CLADDING

REV	DATE	DESCRIPTION	CHK	DRN
P03	11/02/2021	ISSUED FOR PLANNING APPROVAL	RJ	SH
P02	13/08/2021	ISSUED FOR FURTHER INFORMATION	DB	EA
P01	13/04/2021	ISSUED FOR PLANNING APPROVAL	RJ	EA

STATUS CODE DESCRIPTION  
**ISSUED FOR PLANNING APPROVAL**

CLIENT  
**QUINTAIN IRELAND LTD.**

PROJECT  
**ADAMSTOWN STATION BLOCK G**

DRAWING  
**BLOCK G1 - GENERAL ARRANGEMENT - EAST & WEST ELEVATIONS**

PROJECT NUMBER: 950749  
DATE: 13/08/21

SCALE@ A1: As indicated  
DRAWN/CHECKED: RL/DB

STATUS CODE: A1  
DRAWING NUMBER: ADC-HJL-G-ZZ-DR-A-2010  
REVISION: P03

**Henry J Lyons**

Architecture + Interiors  
henryjlyons.com  
+353 1 888 3333  
info@henryjlyons.com  
51-54 Pearse Street  
Dublin D02 KA66



1 GA - ELEVATION - WEST - G1  
1 : 200



2 GA - ELEVATION - EAST - G1  
1 : 200