

rc retaining wall, with french drain, to st. eng. details and specifications.

Reg. No. SID19/B/0486  
ABP 307604/20

**PATIO**

selected stone paving laid on blinding with 50mm thick 1:6 cement: sand and geotextile membrane on hardcore base.

100 mm Diam Surface Water Drain laid to falls of 1:100

100 mm Diam FOUL SEWER laid to falls of 1:100

**DINING AREA**

6000

double glazed thermally broken alum. / pvc windows and sliding screens ( to detail ) on presact concrete cills with dpc below and behind, 25mm insulation behind cills.

selected floor finish on 150mm concrete floor slab (c25/30) with 193mm extratherm XT/UF rigid insulation system on 100mm Extratherm XT/UF rigid insulation (u=0.15 ) on radon barrier on 50mm sand blinding on well compacted hardcore; provide radon sump in hardcore.

**UTILITY**

2266

timber staircase to detail

**Stairs**

**HP**

load bearing timber stud partitions constructed in 100mm x 44mm timber studs at 300mm c/c complete with double soyle and header timbers and bridging at 1/3 height, with 12.5mm plasterboard and plaster skim each pace.

**BEDROOM No. 1**

5724

3243

**ENTRANCE HALL**

14190

**KITCHEN**

Kitchen by nominated sub contractors to detail

wall construction :- 100mm solid block outer leaf, 120mm cavity with 80mm extratherm extrotherm/cw insulation, 100mm solid conc. block inner leaf, dry lined with 42.5mm extratherm xt / ti insulated plasterboard and skim finish throughout (u = 0.16)

**TOILET**

2060

1862

**ADDITIONAL INFORMATION 2020**

**DESMOND J. HALPIN & ASSOCIATES**  
Planning & Building Design Consultants

15 Gangea Drive, Friarouse, Dublin 24 Phone: 01 4537170 Email: desmondh@jhalpin.com

Project: PROPOSED EXTENSION AND RENOVATIONS TO 15 GANGEA DRIVE, FRIAROUSE, DUBLIN 24  
Drawing Title: PROPOSED GROUND FLOOR PLAN PART A

Scale	1:50 @ A3	Drawn	DJH
Drawing No	05A-20-19	Rev	
Date	APRIL 2020	Chk	JK

**PROPOSED GROUND FLOOR LAYOUT**

**ENTRANCE DRIVEWAY**

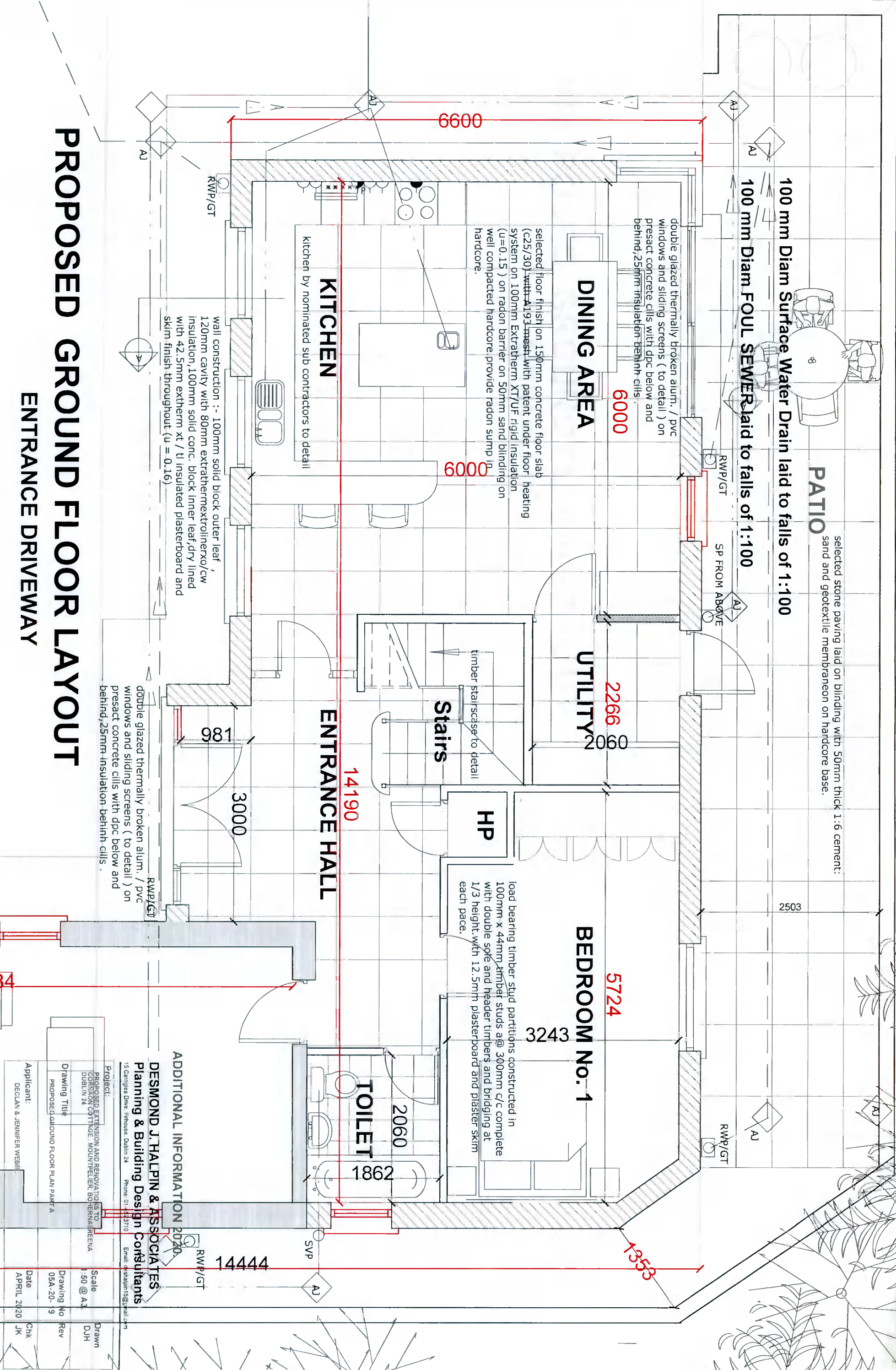

new conc /slate. roof tiles to match existing on 50mm x 25mm timber battens on Roofshields breather membrane on 44mm x 175mm C16 rafters, collars and ceiling joists @ 400mm c/c with 150mm rigid insulation between rafters with 100mm x 75mm timber wall plates on dpc strapped to new structure. 5lb lead flashing

selected t&g timber flooring on 225 mm x 44mm sc c16 timber joists at 400mm c/c supported on galv. street joists hangers and notched into 203mm x 203mm rjs. As necessary, high density insulation between joists, plaster and skim ceiling finish.

stud partitions around bath and showers to be tiled on 12.5 marine ply. provide marine ply floor to bathrooms with sk 2000 tanking under tiles

wall construction :- 100mm solid block outer leaf plastered , 120mm cavity with 80mm extrathermextrolinerxo/cw insulation, 100mm solid conc. block inner leaf, dry lined with 42.5mm extermin xt / ti insulated plasterboard and skim finish throughout (u = 0.16)

load bearing timber stud partitions constructed in 100mm x 44mm timber studs @ 300mm c/c complete with double sole and header timbers and bridging at 1/3 height, with 12.5mm plasterboard and plaster skim each pace.

form new dormer windows timber stud partitioning, faced in marine ply external sheeting, plastered and flashed, external quality plaster finish painted, timber stud partitioning with rigid high density insulation, plastered internally.

ADDITIONAL INFORMATION 2020.

# PROPOSED FIRST FLOOR PLAN .

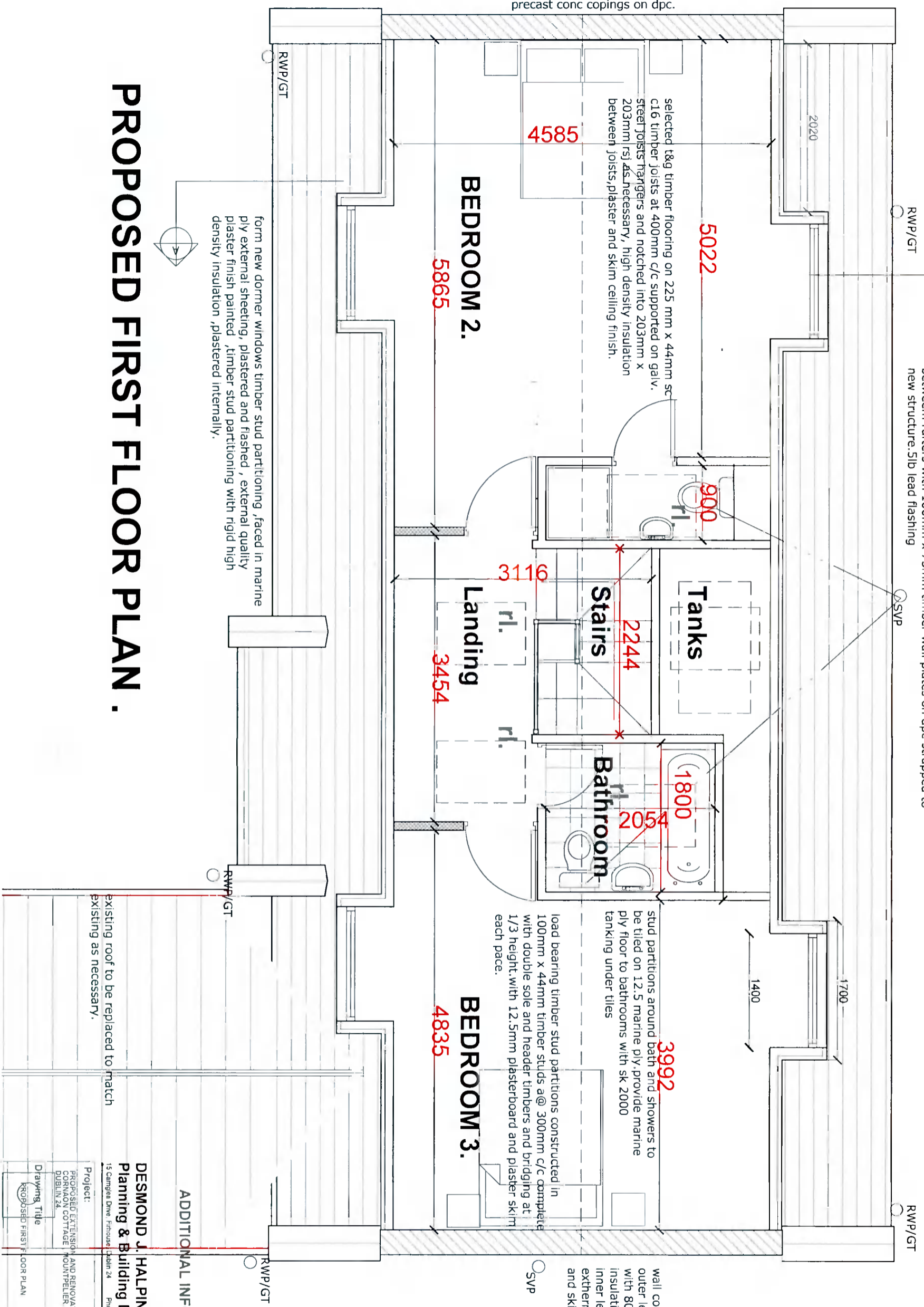

**DESMOND J. HALPIN & ASSOCIATES**  
 Planning & Building Design Consultants  
 15 Camogie Drive, Fintona, Dublin 24 Phone: 01-4523710 Email: deshalpin15@gmail.com

existing roof to be replaced to match existing as necessary.

Project:		Proposed Extension and Renovations to Cornado Cottage Mountpelleters Bomenabarrena, Dublin 24	
Drawing Title		Proposed First Floor Plan	
Scale	1:50 @ A3	Drawn	DJH
Drawing No	07A-20-19	Rev	
Date	APRIL 2020	Chk	JK
Applicant:	DECLAN & JENNIFER WEBB		