

Planning Pack Map

CENTRE COORDINATES:
ITM 709791,724062

PUBLISHED: 13/09/2021
ORDER NO.: 50219297_1

MAP SERIES: 1:2,500
3453-C
1:2,500
3453-D

COMPILED AND PUBLISHED BY:
Ordnance Survey Ireland,
Phoenix Park,
Dublin 8,
Ireland.

Unauthorised reproduction
infringes Ordnance Survey Ireland
and Government of Ireland
copyright.

RETENTION 2021

All rights reserved.
No part of this publication may
be copied, reproduced
or transmitted in any form
or by any means without the prior
written permission of
the copyright owners.

The representation on this map
of a road, track or footpath
is not evidence of the existence
of a right of way.

Ordnance Survey maps
never show legal property
boundaries, nor do they
show ownership of
physical features.

© Suirbhéireacht Ordnánais Éireann,
2021
© Ordnance Survey Ireland, 2021
www.osi.ie/copyright

LEGEND:
<http://www.osi.ie>;
search 'Large Scale Legend'

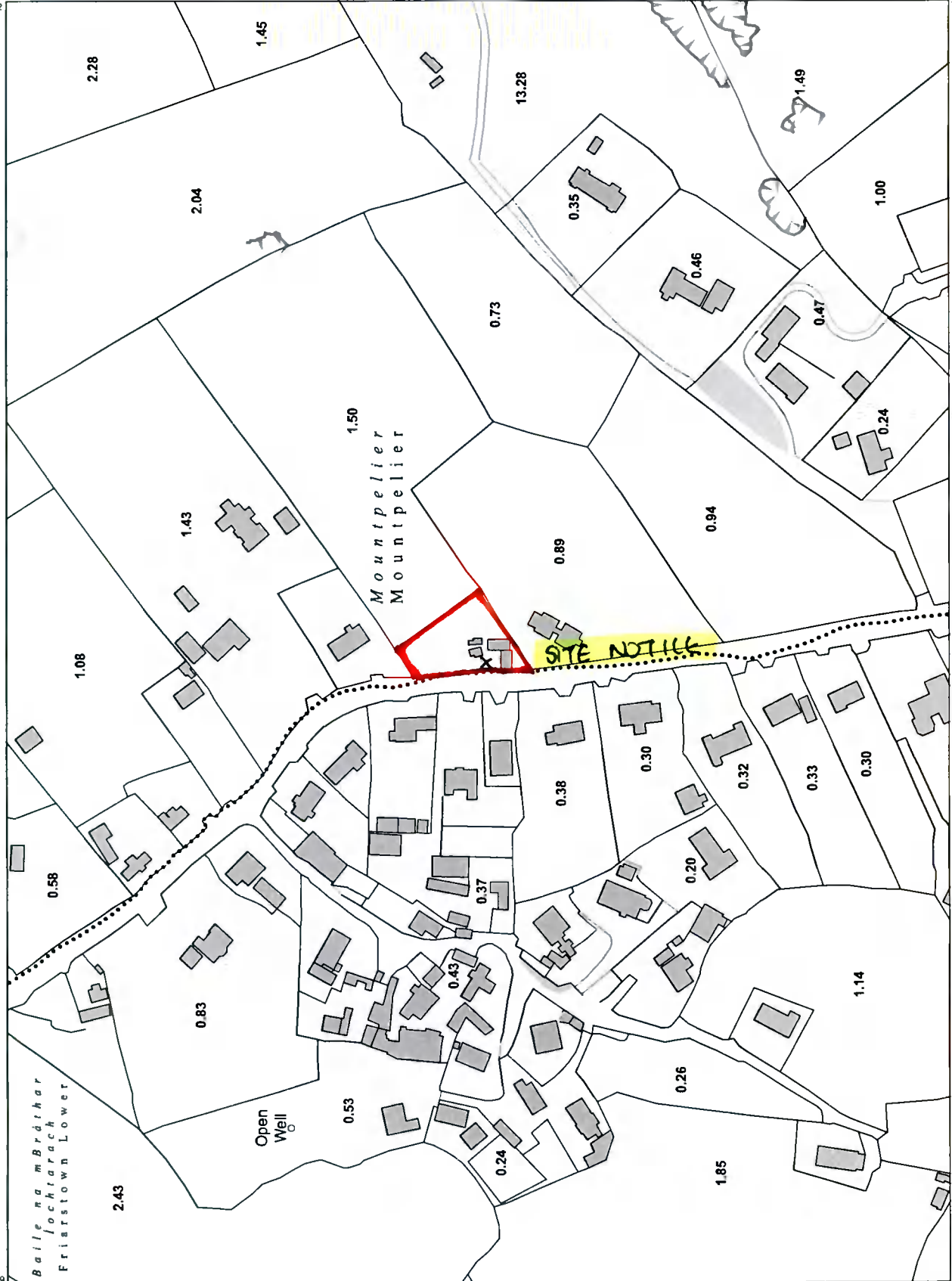

CAPTURE RESOLUTION:
The map objects are only accurate to the
resolution at which they were captured.
Output scale is not indicative of data capture scale
Further information is available at:
<http://www.osi.ie>; search 'Capture Resolution'

OUTPUT SCALE: 1:2,500

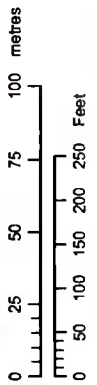

deg.no. ac. 20.19.

DESMOND J. HALPIN & ASSOCIATES

PLANNING & BUILDING CONSULTANTS

PROJECT MANAGERS

15 Carriglea Drive,
Firhouse,
Dublin 24

Phone: 01 4523710
Mobile: 087 9734595
Registered Company No: 111360
E-Mail: deshalpin15@gmail.com

RETENTION 2021

Client: Declan & Jennifer Webb.

**Location : Cornaon Cottage,
Mountpelier,
Bohernabrenna,
D.24.**

**Application : Retention of Planning
Permission.**

Development :

**Proposed retention of as built renovations and
extension to Cornaon Cottage.**

