

rc retaining wall, with french drain, to st. eng. details and specifications.

RETENTION 2021

selected stone paving laid on blinding with 50mm thick 1:6 cement sand and geotextile membrane on hardcore base.

100 mm Diam FOUL SEWER laid to falls of 1:100
100 mm Diam S/W drain laid to falls of 1:100

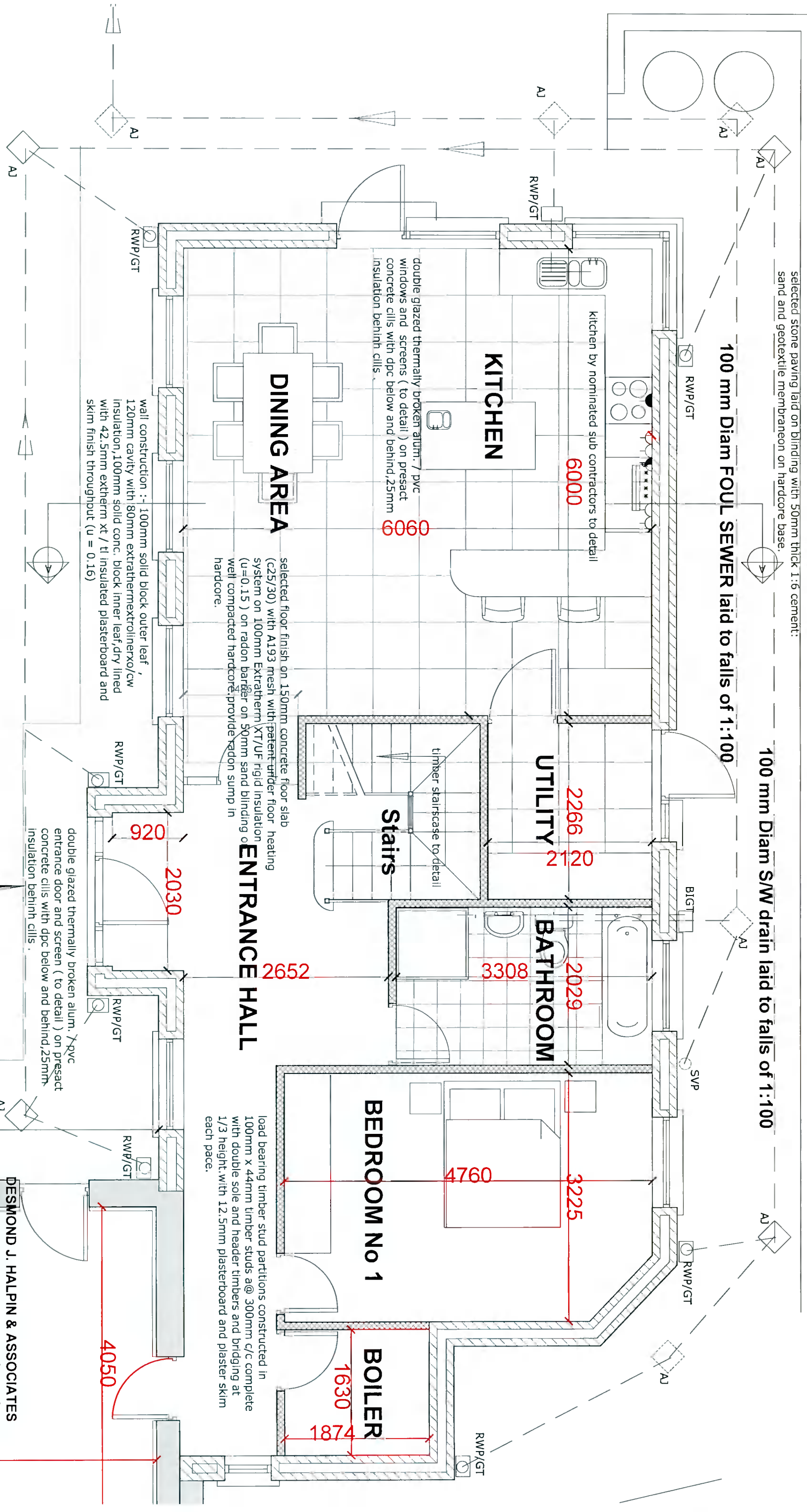

GROUND FLOOR PLAN .



DESMOND J. HALPIN & ASSOCIATES
 Planning & Building Design Consultants

15 Temple Drive, Fintona, Dublin 24 Phone: 01-4523710 Email: desmondj5@gmail.com

Project: RETENTION OF AS BUILT EXTENSION AND RENOVATIONS TO CORNWALL COTTAGE, MOUNTPELIER BOHERNABRENNIA DUBLIN 24

Drawing Title: PART GROUND FLOOR PLAN A

Scale: 1:50 @ A3.

Drawn: DJH

Rev: 03C-20-19

Applicant: DECIAN & JENNIFER WEBB.

CHK: UK

SEPT 2021