

# Planning Pack Map

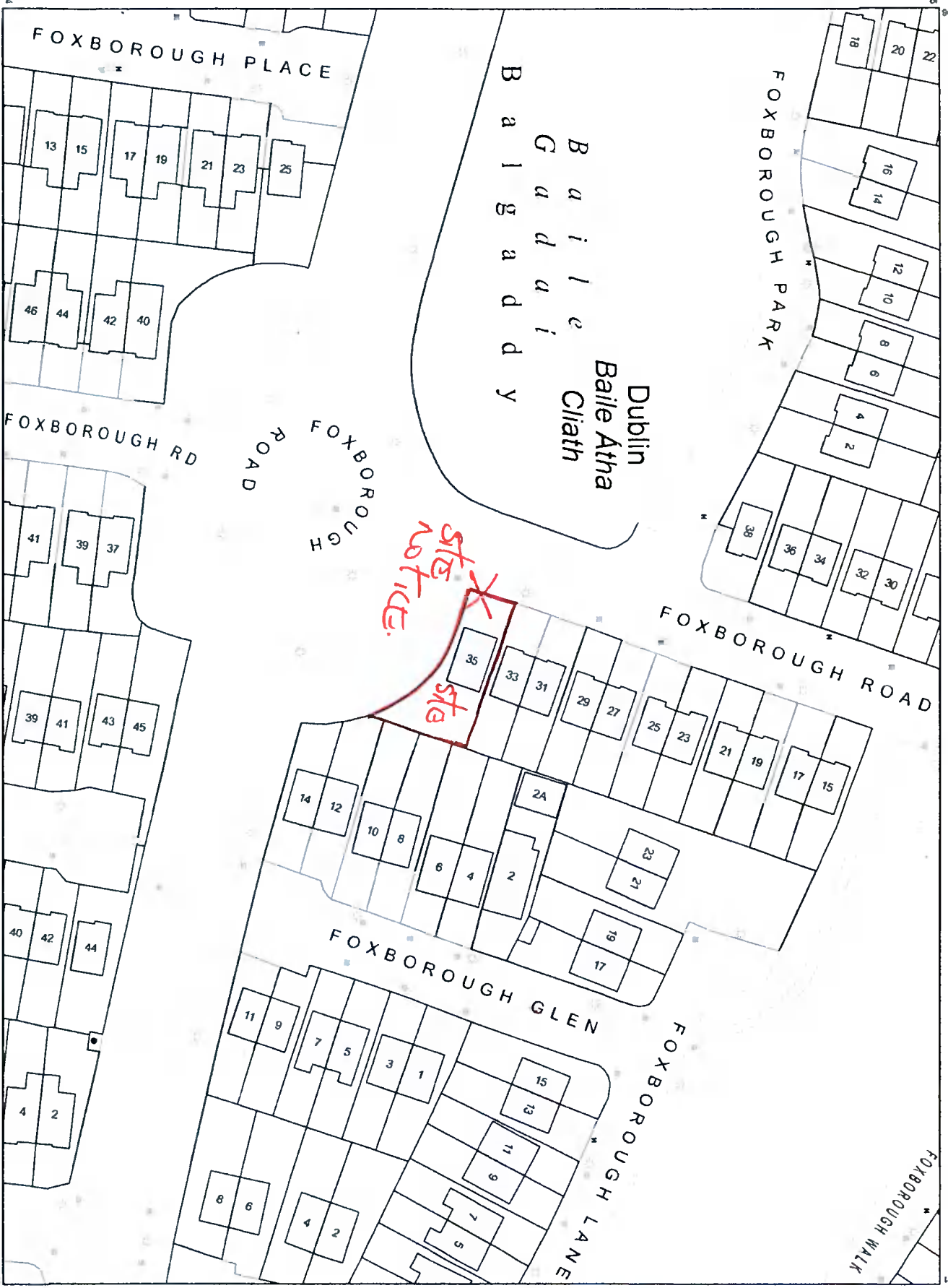

*Handwritten in red:*  
SITE  
SITE NOTICE

*Handwritten in blue:*  
425 Adair's  
Kilbally  
never complete.



**CENTRE COORDINATES:**  
ITM 704915,733340

**PUBLISHED:** 04/07/2021  
**ORDER NO.:** 50204466\_1

**MAP SERIES:** 1:1,000  
**MAP SHEETS:** 3261-12

**COMPILED AND PUBLISHED BY:**  
Ordnance Survey Ireland,  
Phoenix Park,  
Dublin 8,  
Ireland.

Unauthorised reproduction  
infringes Ordnance Survey Ireland  
and Government of Ireland  
copyright.

All rights reserved.  
No part of this publication may  
be copied, reproduced  
or transmitted in any form  
or by any means without the prior  
written permission of  
the copyright owners.

The representation on this map  
of a road, track or footpath  
is not evidence of the existence  
of a right of way.

Ordnance Survey maps  
never show legal property  
boundaries, nor do they  
show ownership of  
physical features.

© Suirbheiríocht Ordánais Éireann,  
2021  
© Ordnance Survey Ireland, 2021  
[www.osi.ie/copyright](http://www.osi.ie/copyright)

**LEGEND:**  
<http://www.osi.ie>  
search 'Large Scale Legend'

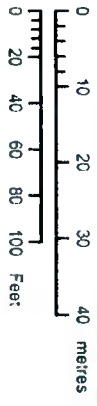

**OUTPUT SCALE:** 1:1,000

**CAPTURE RESOLUTION:**  
The map objects are only accurate to the  
resolution at which they were captured.  
Output scale is not indicative of 'real capture scale'  
Further information is available at:  
<http://www.osi.ie/search/Capture-Resolution>



# Site Location Map



National Mapping Agency

**CENTRE COORDINATES:**  
ITM 704915.733340

**PUBLISHED:** 04/07/2021  
**ORDER NO.:** 50204466\_1

**MAP SERIES:** 6 Inch Raster  
**MAP SHEETS:** DNO17  
6 Inch Raster KE011

*MS Aerials  
2 Maps  
Kittally  
near combs.*

**COMPILED AND PUBLISHED BY:**  
Ordnance Survey Ireland,  
Phoenix Park,  
Dublin 8,  
Ireland.

Unauthorised reproduction  
infringes Ordnance Survey Ireland  
and Government of Ireland  
copyright.

All rights reserved.  
No part of this publication may  
be copied, reproduced  
or transmitted in any form  
or by any means without the prior  
written permission of  
the copyright owners.

The representation on this map  
of a road, track or footpath  
is not evidence of the existence  
of a right of way.

Ordnance Survey maps  
never show legal property  
boundaries, nor do they  
show ownership of  
physical features.

© Surbhreacht Ordánáis Éireann,  
2021  
© Ordnance Survey Ireland, 2021  
[www.osi.ie/copyright](http://www.osi.ie/copyright)

**LEGEND:**  
<http://www.osi.ie>  
search 'Large Scale Legend'

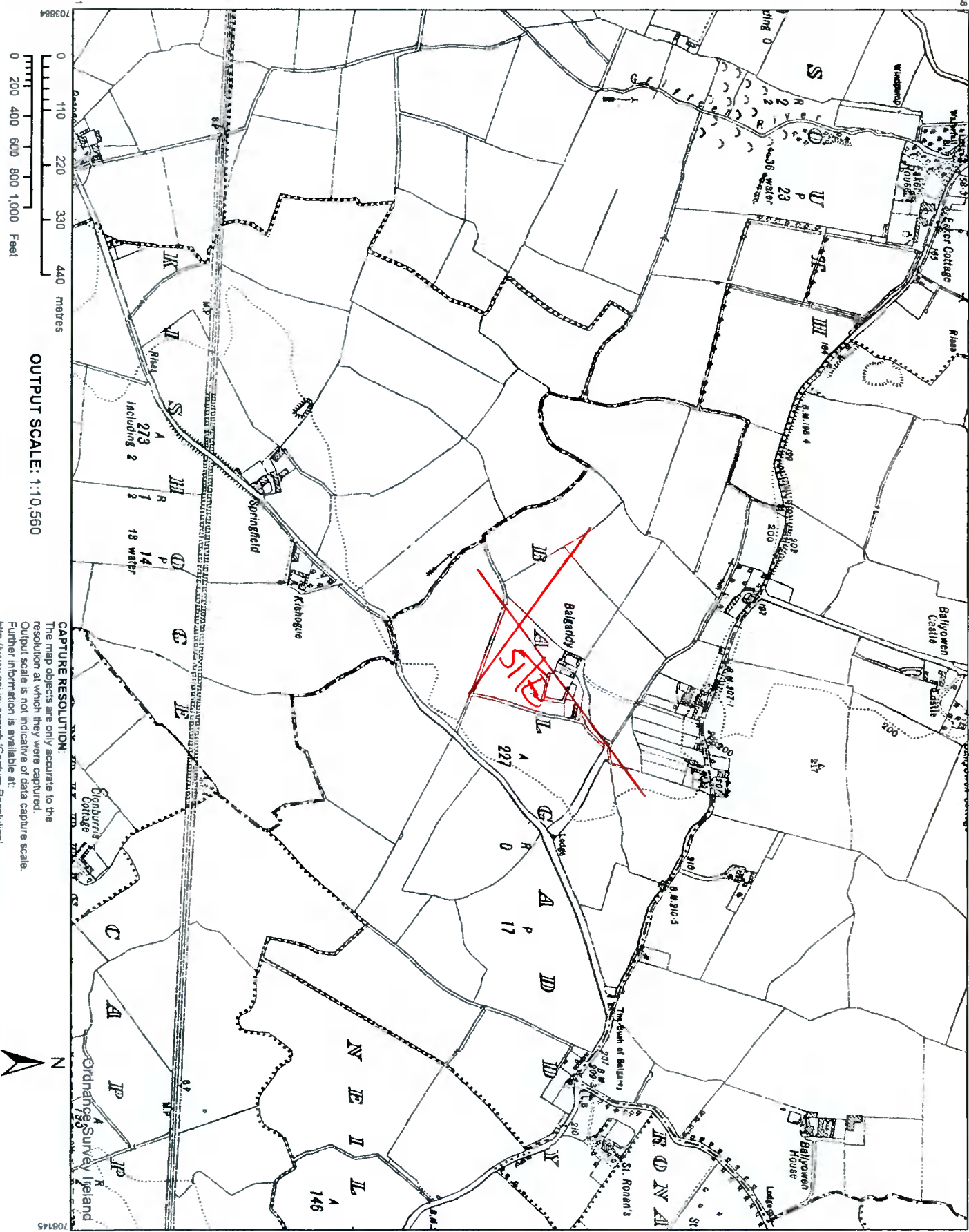

OUTPUT SCALE: 1:10,560

**CAPTURE RESOLUTION:**

The map objects are only accurate to the  
resolution at which they were captured.  
Output scale is not indicative of data capture scale.  
Further information is available at:  
[http://www.osi.ie/search/Capture Resolution](http://www.osi.ie/search/Capture%20Resolution)