

Existing Site Layout Plan
Scale: 1:200 @ A3

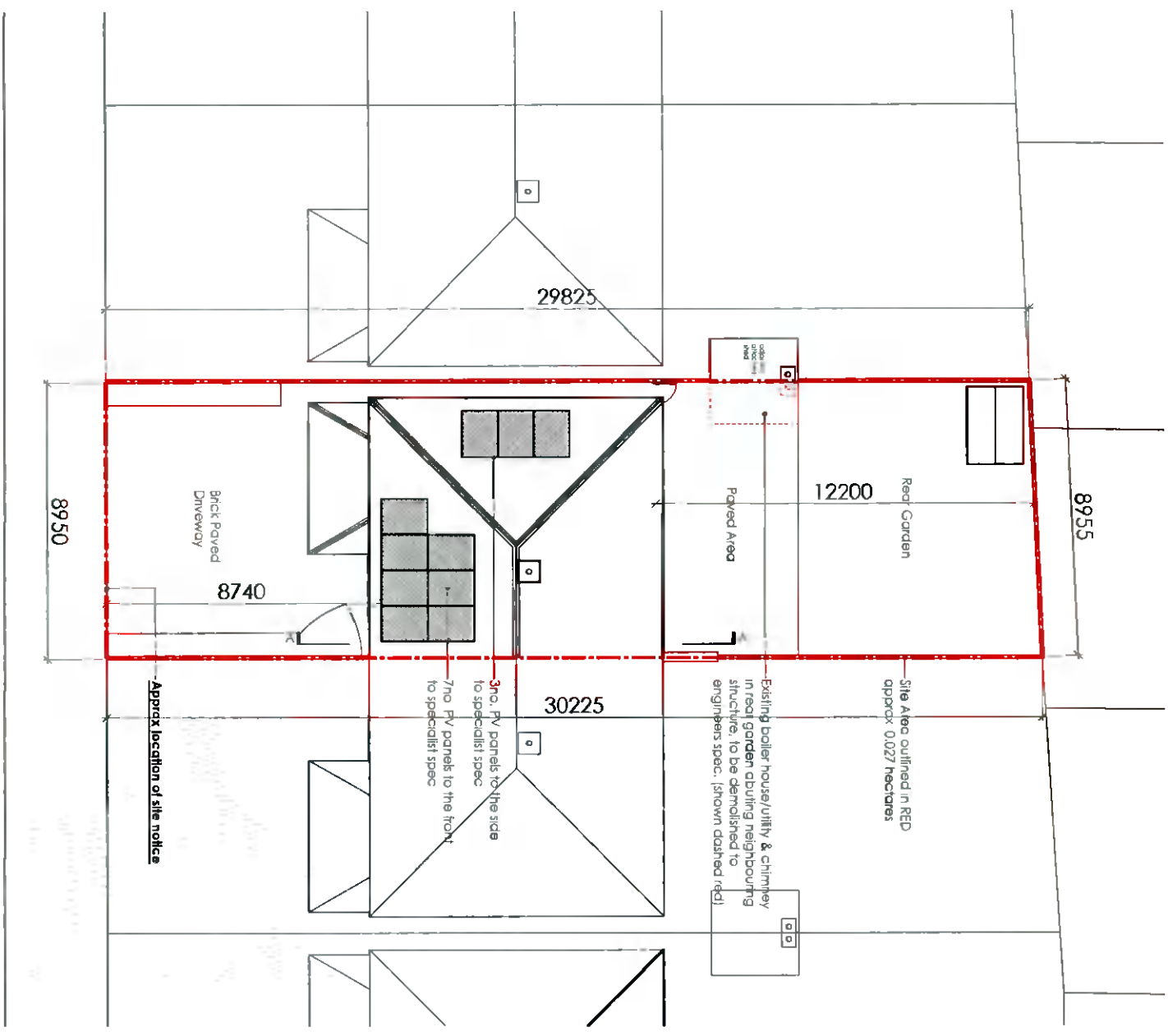

Proposed Site Layout Plan
Scale: 1:200 @ A3

SITE PLANS BASED ON OS MAP | LICENCE NO: 50221896 | 3392-11 | DN018, DN022 | X,Y= 712072.77,729477.3

Client	Christina & Aidan Meade 13 Glendown Court, Templeogue, Dublin 6W, D6W HN30
Revisions	



Chartered Institute of
Architectural Technologists

STATUS OF DRAWING
PLANNING DRAWING

notes

JOE FALLON DESIGN ARCHITECTURE	1st Floor, 6 Meath Street, Dúnghall, Dublin 14 1A Ryland Street, Buncloody, Enniscorthy, Co. Wexford	T: 01-81 43686 M: 087-2566808 P: 053-9977653
Project	Proposed Alterations @ 13 Glendown Court	
drawing	Site Layout Plan	dwg no. 21042-PP-02
job no. 21042	scale As Shown	date Oct 21
drawn by DOM		checked LK
UNDER THE BUILDING CONTROL ACT 2007 JOE FALLON IS A REGISTERED ARCHITECT UNDER THE REGISTERED ARCHITECTS ACT 1977		

A3

All work to be carried out in accordance with the current Building Regulations and Technical Guidance Documents. These documents take precedence over any dimensions / notes / specifications on these drawings. The contractor / client is to make a thorough inspection of the site and make themselves fully aware of any peculiarities pertaining there to. The contractor is entirely responsible for the proper setting out of works on site. Written dimensions are to be used in preference to scaling. **Contractor / client is to check all dimensions prior to planning stage / construction. Any discrepancies to be reported before work is in hand.** Contractor is deemed to have included for everything required to finish off project to a satisfactory condition though not specifically described on drawings. All work to be supervised and signed off by suitably qualified persons with up-to-date insurance and proper Health and Safety. All drainage works to comply with Local Authority Regulations. If in doubt contact Authority. All works must be carried out using proper materials that are fit for the use for which they are intended and for the conditions in which they are to be used. If in doubt, refer to the harmonised technical specifications. All materials and products to be fitted as per manufacturers instructions.