

S\_16 - S\_8

M:1:1000/100

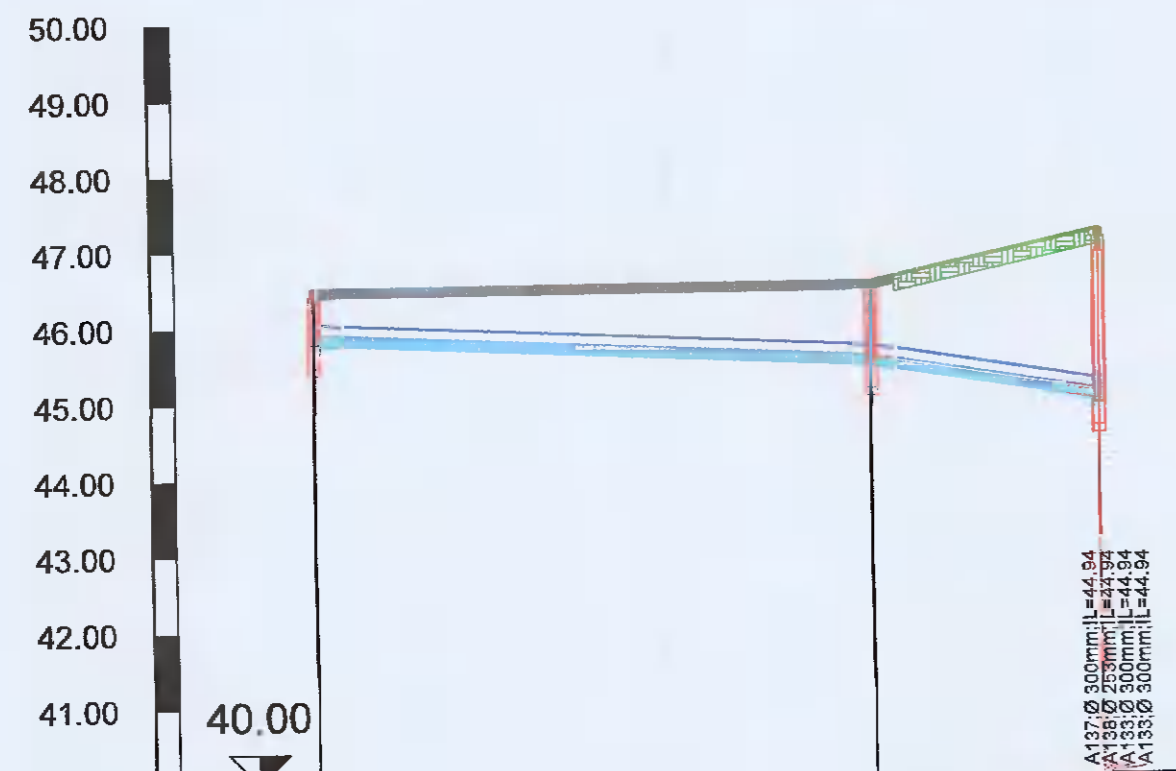

Manhole name	S_16	S_17	S_8
Section name	S364	S365	
Ground Level [m.O.D.]	46.50	46.50	47.15
Invert Level [m.O.D.]	45.78	45.42	44.54
Section Length [m]	73.48	29.97	
Pipe Diameter & Material	Ø 250mm PVC-U		
Length/Slope	1:200	1:62	1:34.5
Chainage	0+000.00	0+073.48	0+103.45
Flow [l/s]	21	21	
Velocity [m/s]	0.97	1.50	
Filling percent [%]	45.21	32.61	
Full pipe flow [l/s]	51	91	
Full pipe velocity [m/s]	1.01	1.83	

S\_14 - S\_8

M:1:1000/100

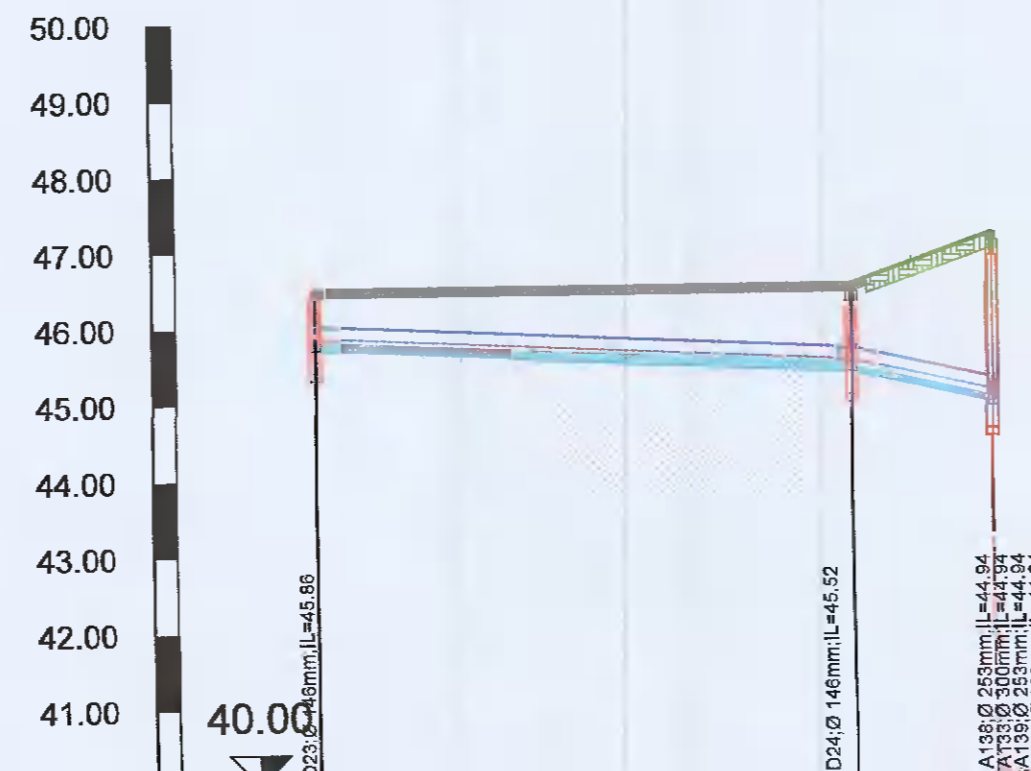

Manhole name	S_14	S_15	S_8
Section name	S361	S362	
Ground Level [m.O.D.]	46.50	46.50	47.15
Invert Level [m.O.D.]	45.71	45.38	44.54
Section Length [m]	70.76	18.54	
Pipe Diameter & Material	Ø 300mm PVC-U		
Length/Slope	1:200	1:44	1:85.5
Chainage	0+000.00	0+070.76	0+089.30
Flow [l/s]	15	15	
Velocity [m/s]	0.68	1.54	
Filling percent [%]	29.42	18.84	
Full pipe flow [l/s]	80	173	
Full pipe velocity [m/s]	1.13	2.43	

S\_13 - S\_11

M:1:1000/100

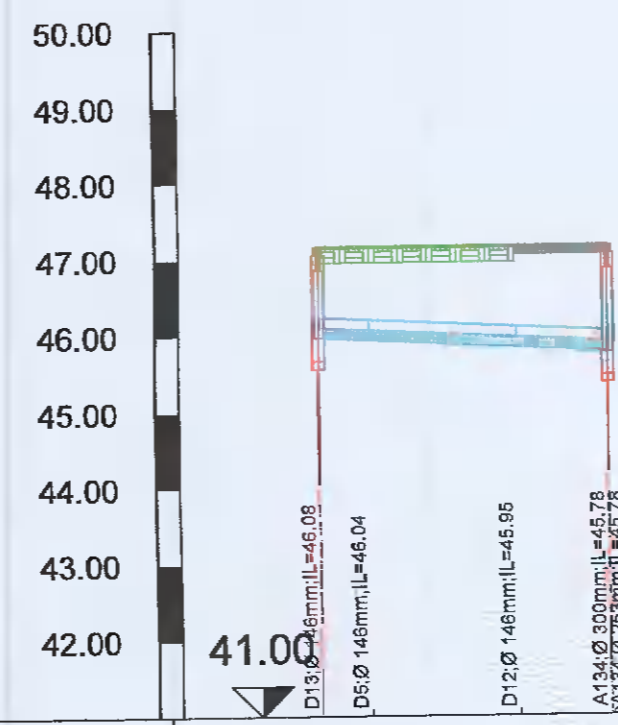

Manhole name	S_13	S_11
Section name	S366	
Ground Level [m.O.D.]	47.15	47.15
Invert Level [m.O.D.]	45.97	45.78
Section Length [m]	38.12	
Pipe Diameter & Material	Ø 250mm PVC-U	
Length/Slope	1:200	1:38.12
Chainage	0+000.00	0+038.12
Flow [l/s]	16	
Velocity [m/s]	0.90	
Filling percent [%]	38.42	
Full pipe flow [l/s]	51	
Full pipe velocity [m/s]	1.01	

S\_18 - S\_8

M:1:1000/100

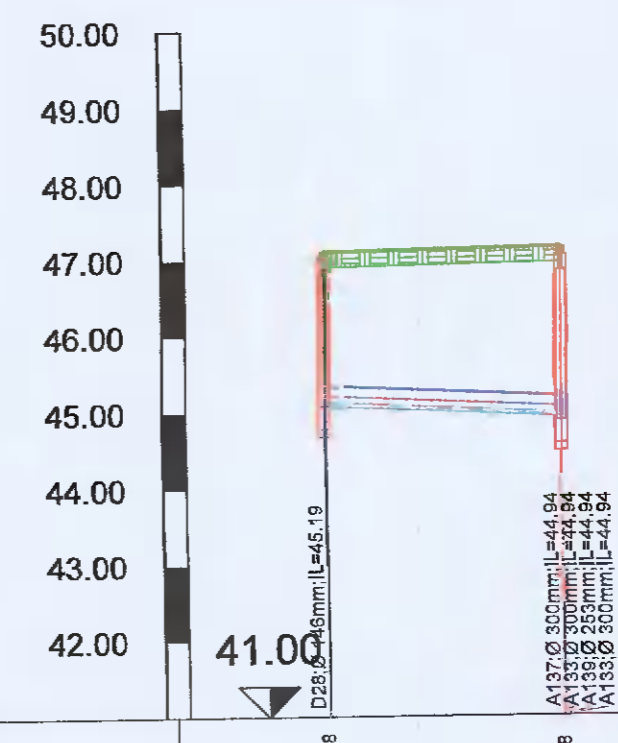

Manhole name	S_18	S_8
Section name	S363	
Ground Level [m.O.D.]	47.10	47.15
Invert Level [m.O.D.]	46.09	44.54
Section Length [m]	31.04	
Pipe Diameter & Material	Ø 250mm PVC-U	
Length/Slope	1:200	1:31.04
Chainage	0+000.00	0+031.04
Flow [l/s]	3	
Velocity [m/s]	0.58	
Filling percent [%]	16.56	
Full pipe flow [l/s]	51	
Full pipe velocity [m/s]	1.01	

- NOTES:
- DO NOT SCALE THIS DRAWING - IF IN DOUBT ASK.
  - ALL WORK ON THE SITE TO BE IN ACCORDANCE WITH THE SAFETY, HEALTH AND WELFARE AT WORK (CONSTRUCTION) REGULATIONS.
  - ALL DIMENSIONS ARE AS SHOWN.
  - ALL LEVELS ARE SHOWN IN m.O.D.
  - ALL DRAWINGS ARE TO BE READ IN CONJUNCTION WITH OTHER CIVIL, STRUCTURAL, MECHANICAL, ELECTRICAL, AND FABRICATORS DRAWINGS.
  - ALL CONSTRUCTION LEVELS AND CONTOURS ON THE INCLUDED DRAWINGS RELATE TO THE MAIN HEAD ORDNANCE DATUM.
  - DRAIN FROM CHEMICAL DELIVERY AREA TO BE ACID RESISTANT (PTFE OR EQUIVALENT), ACID RESISTANT SHUT-OFF VALVE TO BE NORMALLY-OPEN TO ALLOW UNCONTAMINATED SURFACE WATER DRAIN TO SITE INFILTRATION POND. SHUT-OFF VALVE TO BE CLOSED DURING CHEMICAL DELIVERY. DRAIN SECTION TO BE OVER-SIZED TO PROVIDE EMERGENCY STORAGE FOR DELIVERY TANKER SPILLAGES.
  - CHEMICAL DELIVERY AREA - SEE DETAIL IN DRAWING 11118-RHL-LP2-XX-DR-PL-0018
  - MODIFICATION TO EXISTING SURFACE WATER DRAINAGE SYSTEM AS NECESSARY WHERE CLASH OCCURS WITH PROPOSED DEVELOPMENT
  - ALL SURFACE WATER SECTIONS CHECKED FOR PERCENTAGE FILLING - ALL LESS THAN 90% FULL

LEGEND:

EXISTING STORM SEWER	
PROPOSED STORM SEWER	
EXISTING MANHOLE	
PROPOSED MANHOLE	
GULLY	
SITE BOUNDARY	
OWNERSHIP BOUNDARY	
PROPOSED SEWER	
PROPOSED WATER MAIN	
RIGHT OF WAY	
PROPOSED LINE DOSING LINE	
PROPOSED ACID DOSING LINE (OLD WTP)	
PROPOSED ACID DOSING LINE (NEW WTP)	

REV	DATE	DESCRIPTION	D	C	A
01	28/09/21	Updated following comments	EV	MG	JE

INLET\_1 - MH1

M:1:1000/100

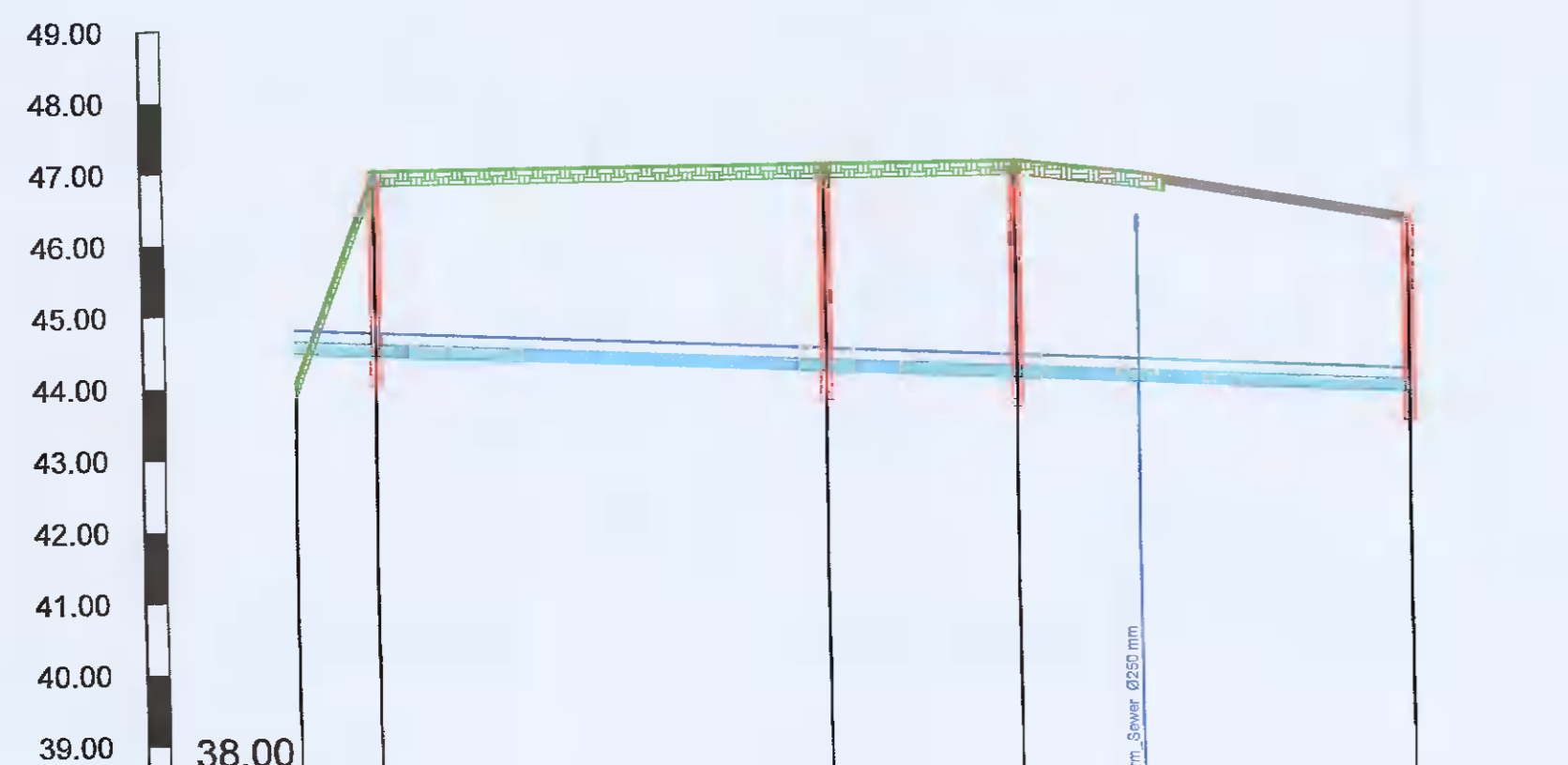

Manhole name	INLET_1	S_22	S_23	S_24	MH1
Section name	S336	S336	S334	S333	
Ground Level [m.O.D.]	44.05	47.00	47.00	45.14	45.14
Invert Level [m.O.D.]	44.48	44.43	44.11	43.89	43.78
Section Length [m]	11.27	63.30	28.76	55.19	
Pipe Diameter & Material	Ø 300mm PVC-U				
Length/Slope	1:200	1:11.27	1:42	1:80.81	
Chainage	0+000.00	0+011.27	0+074.58	0+139.71	0+195.61
Flow [l/s]	35	35	35	35	
Velocity [m/s]	1.09	1.09	1.09	1.09	
Filling percent [%]	46.20	46.20	46.20	46.20	
Full pipe flow [l/s]	80	80	80	80	
Full pipe velocity [m/s]	1.13	1.13	1.13	1.13	

S\_9 - S\_12

M:1:1000/100

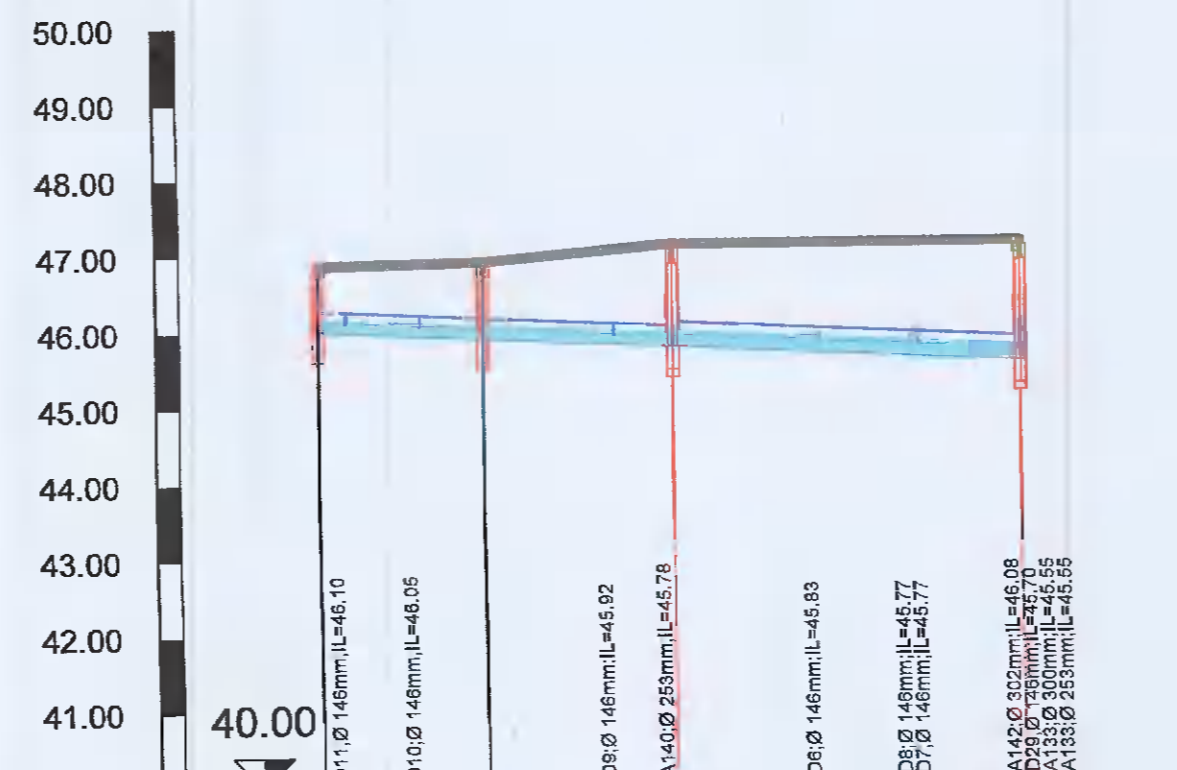

Manhole name	S_9	S_10	S_11	S_12
Section name	S342	S343	S344	
Ground Level [m.O.D.]	46.90	46.94	47.15	47.15
Invert Level [m.O.D.]	46.01	45.90	45.78	45.55
Section Length [m]	21.72	24.94	45.86	
Pipe Diameter & Material	Ø 250mm PVC-U			
Length/Slope	1:200	1:50	1:33	1:92.53
Chainage	0+000.00	0+21.72	0+046.66	0+092.53
Flow [l/s]	33	35	57	
Velocity [m/s]	1.06	1.07	1.20	
Filling percent [%]	56.83	62.92	63.11	
Full pipe flow [l/s]	51	51	80	
Full pipe velocity [m/s]	1.01	1.01	1.13	

S\_21 - OUTFALL\_1

M:1:1000/100

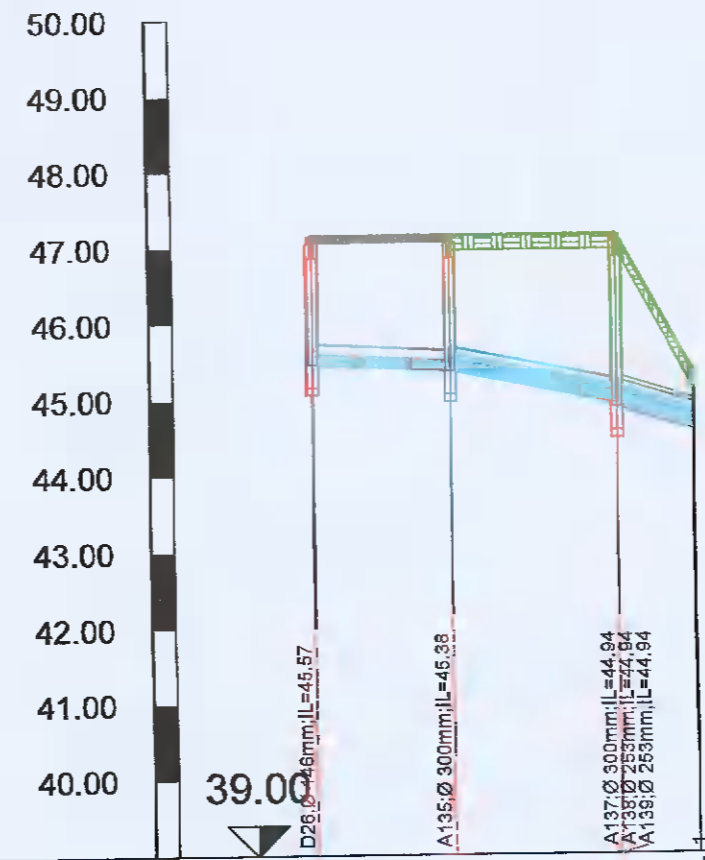

Manhole name	S_21	S_3	OUTFALL_1
Section name	S350	S340	S341
Ground Level [m.O.D.]	47.15	47.15	47.15
Invert Level [m.O.D.]	45.48	45.37	44.94
Section Length [m]	18.15	21.81	10.21
Pipe Diameter & Material	Ø 150mm PVC-U	Ø 300mm PVC-U	Ø 300mm CONCRETE
Length/Slope	1:200	1:50	1:21.82
Chainage	0+000.00	0+018.15	0+039.96
Flow [l/s]	14	139	171
Velocity [m/s]	0.88	2.45	3.01
Filling percent [%]	36.41	74.57	74.78
Full pipe flow [l/s]	51	162	198
Full pipe velocity [m/s]	1.01	2.28	2.81

Planning Drawings

COPYRIGHT RESERVED - THIS DRAWING IS NOT TO BE USED FOR A PURPOSE OTHER THAN THAT FOR WHICH IT HAS BEEN ISSUED BY GLAN AGUA LTD. NOR IS IT TO BE COPIED OR REPRODUCED IN ANY MANNER WITHOUT WRITTEN CONSENT.

CLIENT: **UISCE WATER** IRISH WATER  
 Colville House, 24-26 Talbot Street, Dublin 1. Tel: 1650 278 278 Web: www.water.ie

FINGAL COUNTY COUNCIL  
 County Hall, Main Street, Swords, County Dublin.

PROJECT: **LEIXLIP WATER TREATMENT PLANT UPGRADE**

**GLAN AGUA** MOTAENCIL GROUP  
 Glan Agua, Railway House, Station Road, Loughrea, Co. Galway, IRELAND  
 Tel: +353(0)909630301 Fax: +353(0)909630300  
 e-mail: info@glanagua.co.uk web: www.glanagua.co.uk

**RYAN HANLEY** CONSULTING ENGINEERS  
 1 Galway Business Park, Dangan, Galway, H91A3EP (Head Office).  
 Tel: (091) 591116 Email: info@ryanhaley.ie Web: www.ryanhaley.ie  
 DUBLIN - GALWAY - CASTLEBAR - CORK

TITLE: **PROPOSED AND EXISTING SURFACE WATER DRAINAGE PROFILES**

SCALE	DRAWN	CHECKED	APPROVED
1:100	EV	MG	JE
1:1000	DATE	DATE	DATE
	26/05/2021	28/05/2021	26/05/2021

DRAWING No.	STATUS	REVISION
11118-RHL-LP2-XX-DR-PL-0018	S2	0