

EXISTING ROAD

EXISTING ROAD

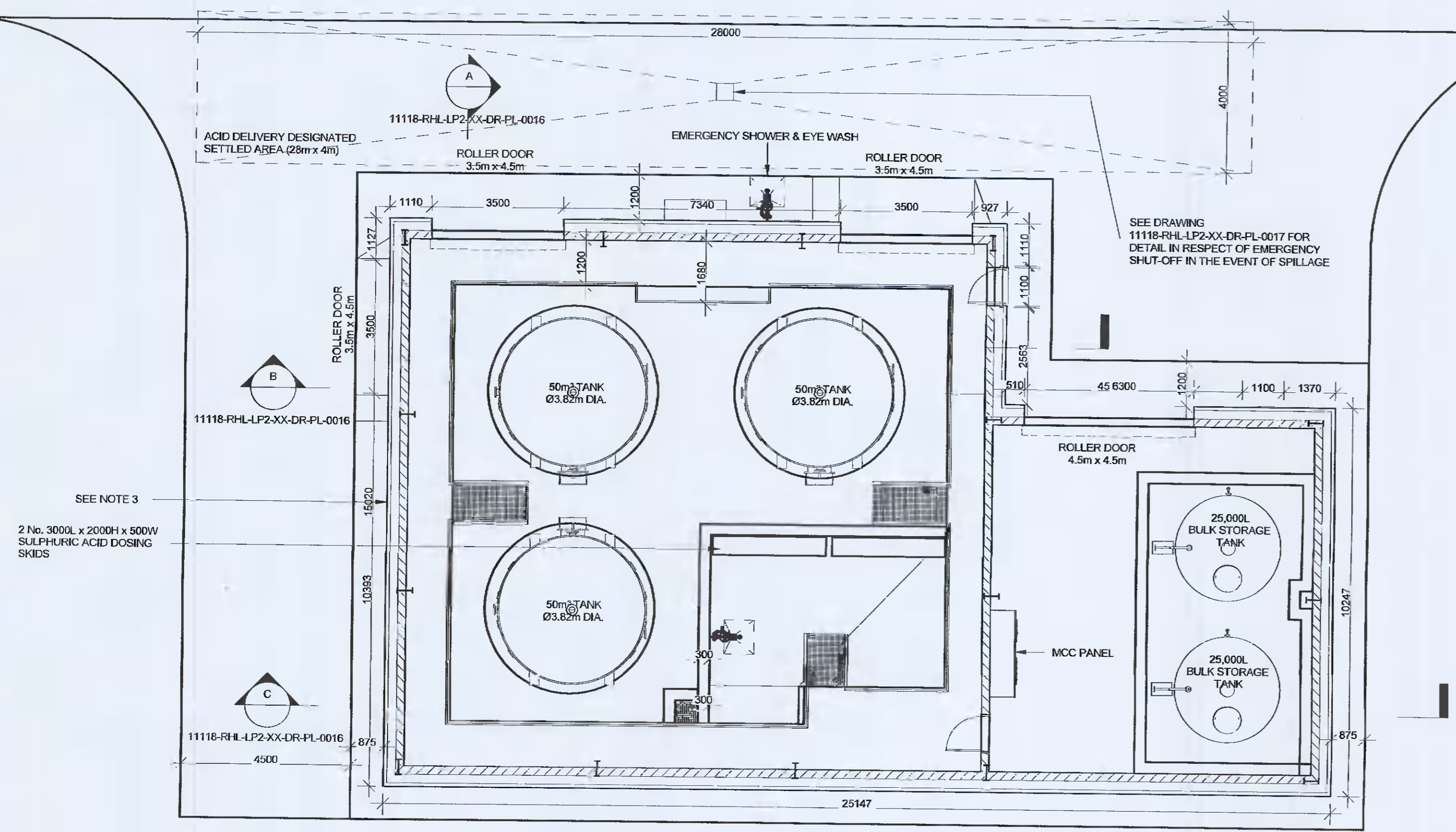

1 PLAN
1 : 100

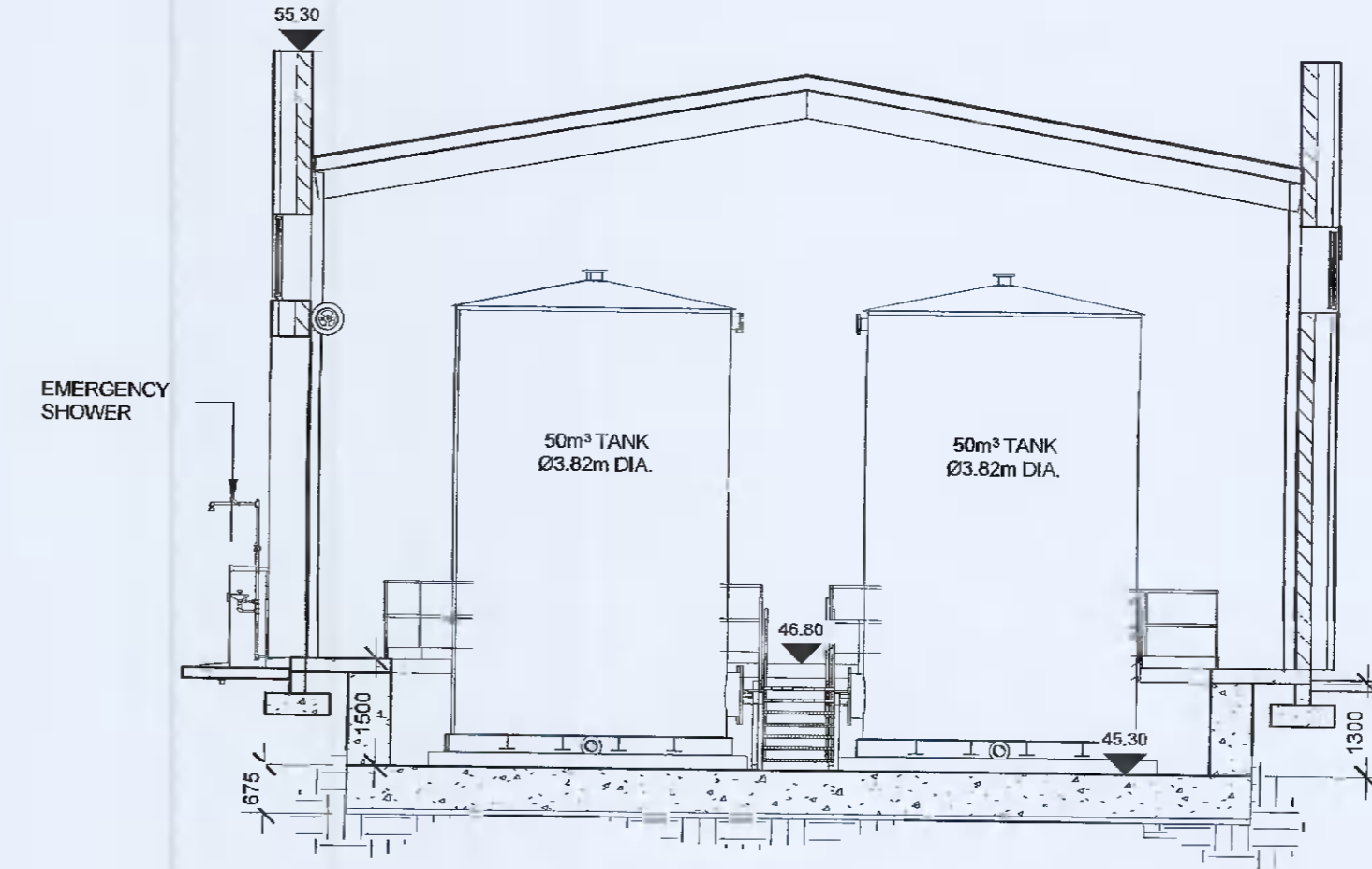

2 SECTION 2
1 : 100

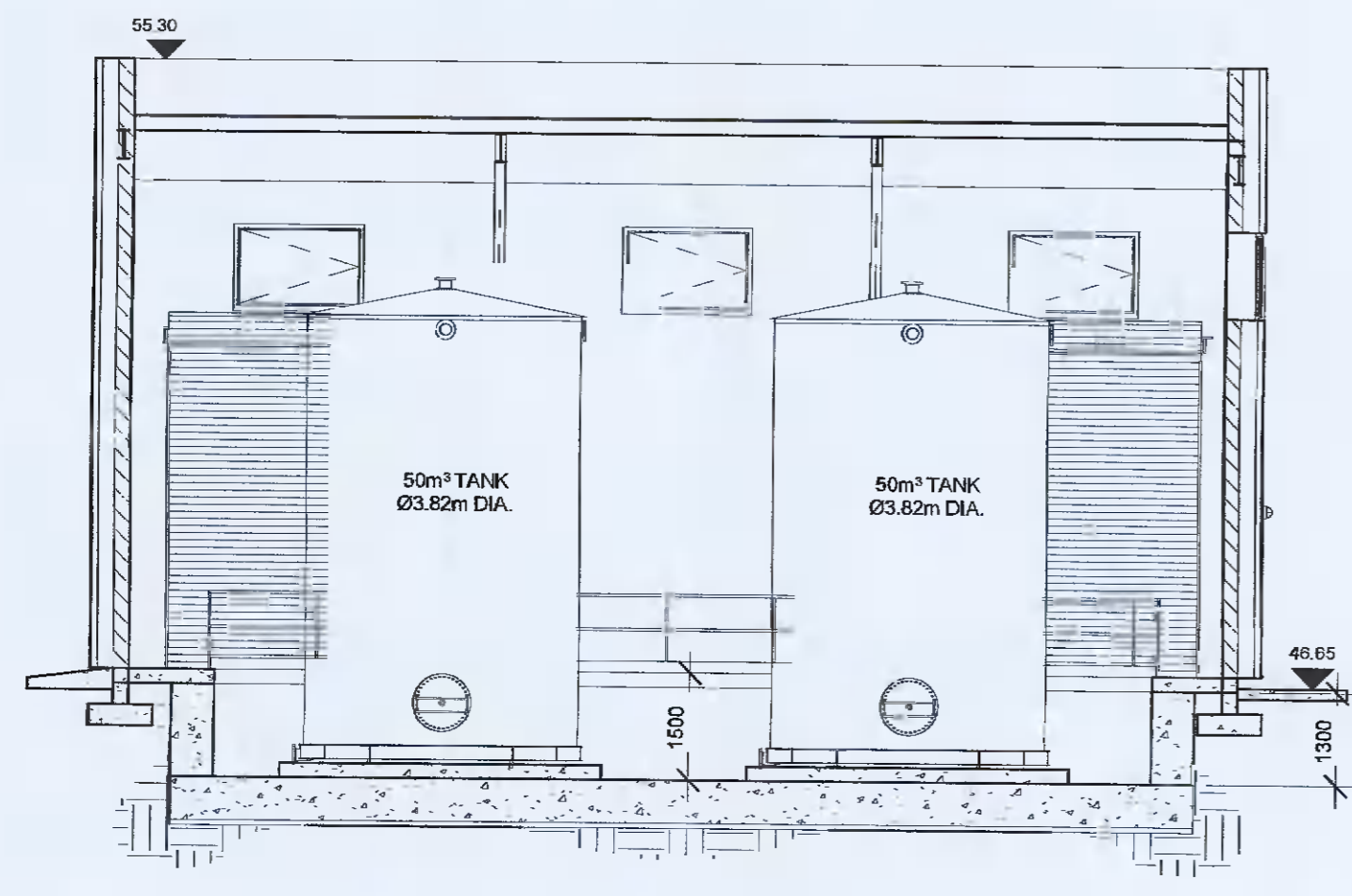

3 SECTION 3
1 : 100

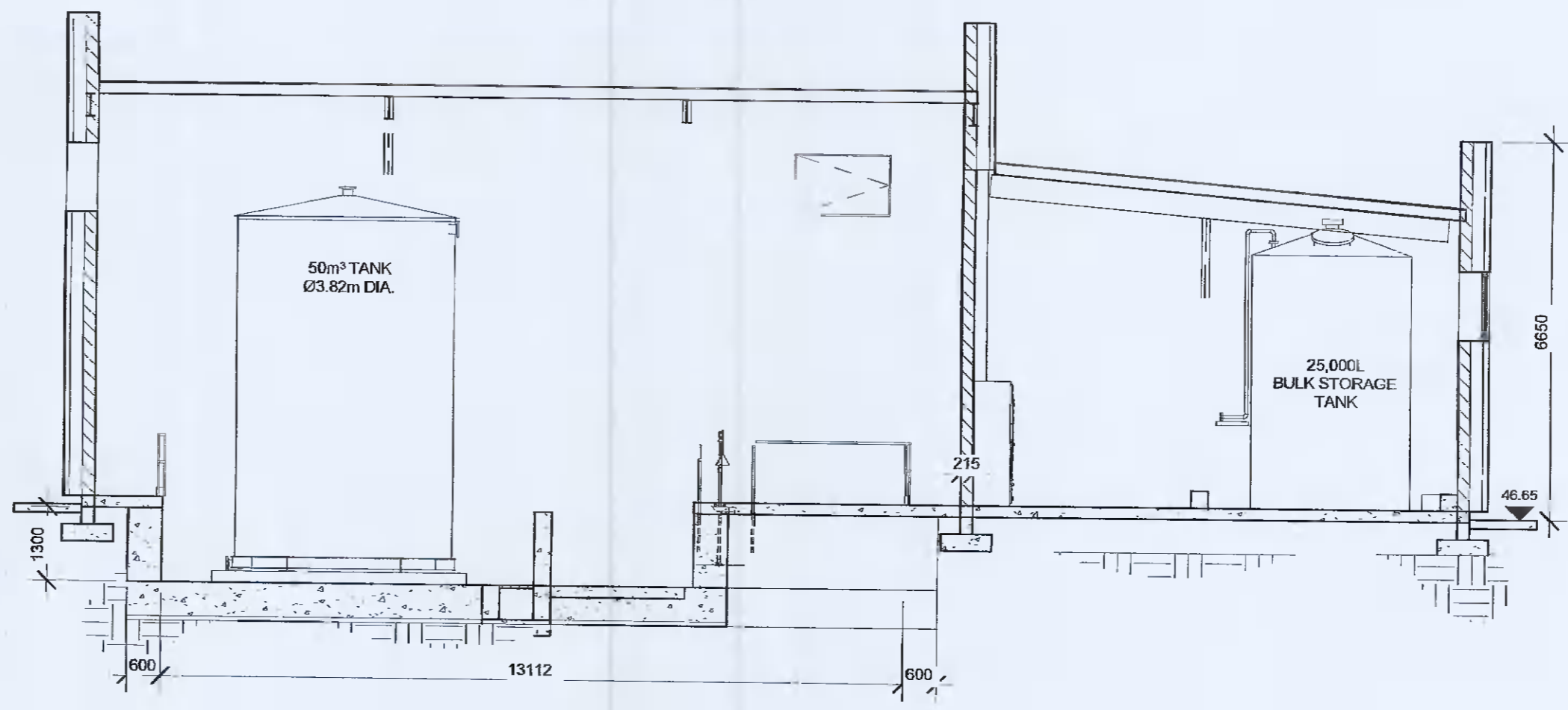

4 SECTION 4
1 : 100

- NOTES:
1. ALL DIMENSIONS ARE IN MILLIMETRES (mm) UNLESS OTHERWISE NOTED.
 2. ALL LEVELS ARE IN METRES (m) AND RELATE TO THE ORDINANCE SURVEY DATUM MALIN HEAD.
 3. BUILDING FINISH SHALL MATCH EXTERNAL FINISH OF ADJACENT WATER TREATMENT PLANT BUILDING - METAL CAPPING TO SELECTED FINISH AND COLOUR ON PROPRIETARY FIXING SYSTEM. METAL CLADDING PANELS TO SELECTED FINISH AND COLOUR BACKED WITH INSULATION AND METAL LINEAR SHEETS ON BLOCKWORK AND STEEL STRUCTURE.
 4. ALL SLOPES SHOWN ARE 1 IN 21

REV	DATE	DESCRIPTION	D	C	A
01	28/05/21	Updated following comments			

Copyright Reserved - THIS DRAWING IS NOT TO BE USED FOR A PURPOSE OTHER THAN THAT FOR WHICH IT HAS BEEN ISSUED BY GLAN AGUA LTD. NOR IS IT TO BE COPIED OR REPRODUCED IN ANY MANNER WITHOUT WRITTEN CONSENT.

CLIENT: **UISCE IRISH WATER**
 Colville House,
 25-26 Talbot Street,
 Dublin 1.
 Tel. 1890 278 278 Web. www.water.ie

FINGAL COUNTY COUNCIL,
 County Hall,
 Main Street,
 Swords,
 County Dublin.

PROJECT: **LEIXLIP WATER TREATMENT PLANT UPGRADE**

GLAN AGUA
 MOTAENGL GROUP
 Glan Agua, Station Road, Co. Galway, IRELAND
 Tel: +353(0)909630304
 Fax: +353(0)909630300
 e-mail: info@glanagua.com
 web: www.glanagua.com

RYAN HANLEY
 CONSULTING ENGINEERS
 1 Galway Business Park,
 Diangan, Galway,
 H81A3EF (Head Office),
 Tel: (091) 507116
 Email: info@ryanhaley.ie
 Web: www.ryanhaley.ie

TITLE: **PROPOSED ACID DOSING BUILDING PLAN & SECTIONS**

SCALE	DRAWN	CHECKED	APPROVED
1:100	EV	MG	JB
	DATE	DATE	DATE
	26/05/2021	26/05/2021	26/05/2021

DRAWING No.	STATUS	REVISION
11118-RHL-LP2-XX-DR-PL-0015	S2	01