

1
1 : 100
Ground floor plan - Demolition

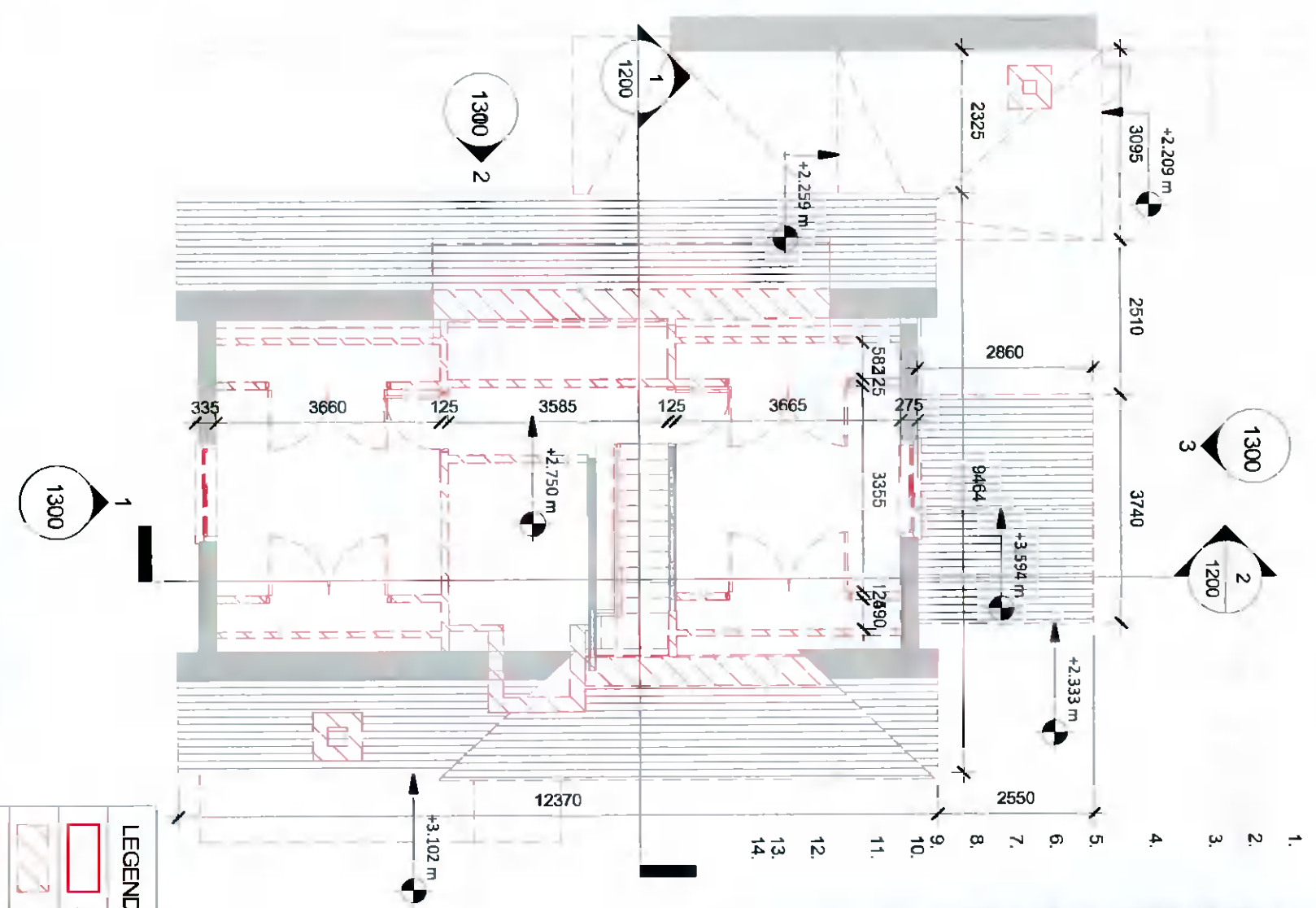

2
1 : 100
First floor plan - Demolition

DEMOLITION NOTES:

1. Existing single storey side and rear extensions to be demolished.
2. All windows, cills and internal and external doors to be removed.
3. Existing external walls in the north-east corner to be removed to facilitate new ground floor extension.
4. Create new openings in existing external walls for new windows and doors.
5. Existing fire place and chimney to be removed.
6. Existing ground floor suspended timber floor to be removed.
7. Majority of existing internal partitions to be removed.
8. Remove areas of existing roof to incorporate 1st floor area extensions.
9. Existing roof dormer to be removed. Create new openings in the existing roof for roof windows.
10. Knee wall in the existing roof structure to be modified to enlarge 1st floor rooms.
11. All existing mechanical and electrical services to be removed.
12. All existing finishes to be removed.
13. Existing garden shed, concrete pavements, east ramp and landing, driveways and timber fence at the east of the house to be removed.

LEGEND

	AREA SUBJECT TO APPLICATION
	EXTENT OF DEMOLITION
	ELEMENTS TO BE DEMOLISHED



All dimensions to be checked on site. Figured dimensions take preference over scaled dimensions. Any errors or discrepancies to be reported to the Architects. This drawing may not be edited or modified by the recipient.
Copyright and ownership of this drawing is vested in Rory O'Brien, whose prior written consent is required for its use, reproduction or for publication to any third party.

PROJECT:
**9 GARDEEVIN DRIVE, LUCAN, CO. DUBLIN
ALTERATIONS AND EXTENSION TO PRIVATE HOUSE**

DRAWING TITLE:
EXISTING LAYOUTS - DEMOLITION

PREPARED BY:
Rory O'Brien

REV B DATE 07/07/2021 SCALE @ A3 1 : 100

STAMP:
**PLANNING - FURTHER INFORMATION
REVISION A**