

Note : All dimensions to be checked on site prior to construction of the proposed works.

new 5lbs lead flashings & counter flashings.  
 new 5lbs lead valley.  
 new precast concrete coping stones with dpc's under.  
 new concrete ridge tiles bedded in weak mortar.  
 new selected roof tiles on 50x38 battens on breathable membrane in 125x38 rafters, collars & ceiling joists & 400 centres with 100 insulation between rafters & ceilings joists on 100x75 wallplate on dpc strapped to new structure with plasterboard & skim ceiling finish.  
 new flat roof structure with reflective paint on two layers of torch on membrane felt on base felt on treated 18mm plywood decking on furring pieces on 215x38 roof joists & 400 centers with 250 insulation between joists on 100x75 wallplate strapped to new structure with plasterboard & skim ceiling finish  
 new upvc soffit & fascia boards with vents in soffits.

new 215 concrete block structure with smooth concrete render finish externally with 85 insulated plasterboard & skim finish internally.

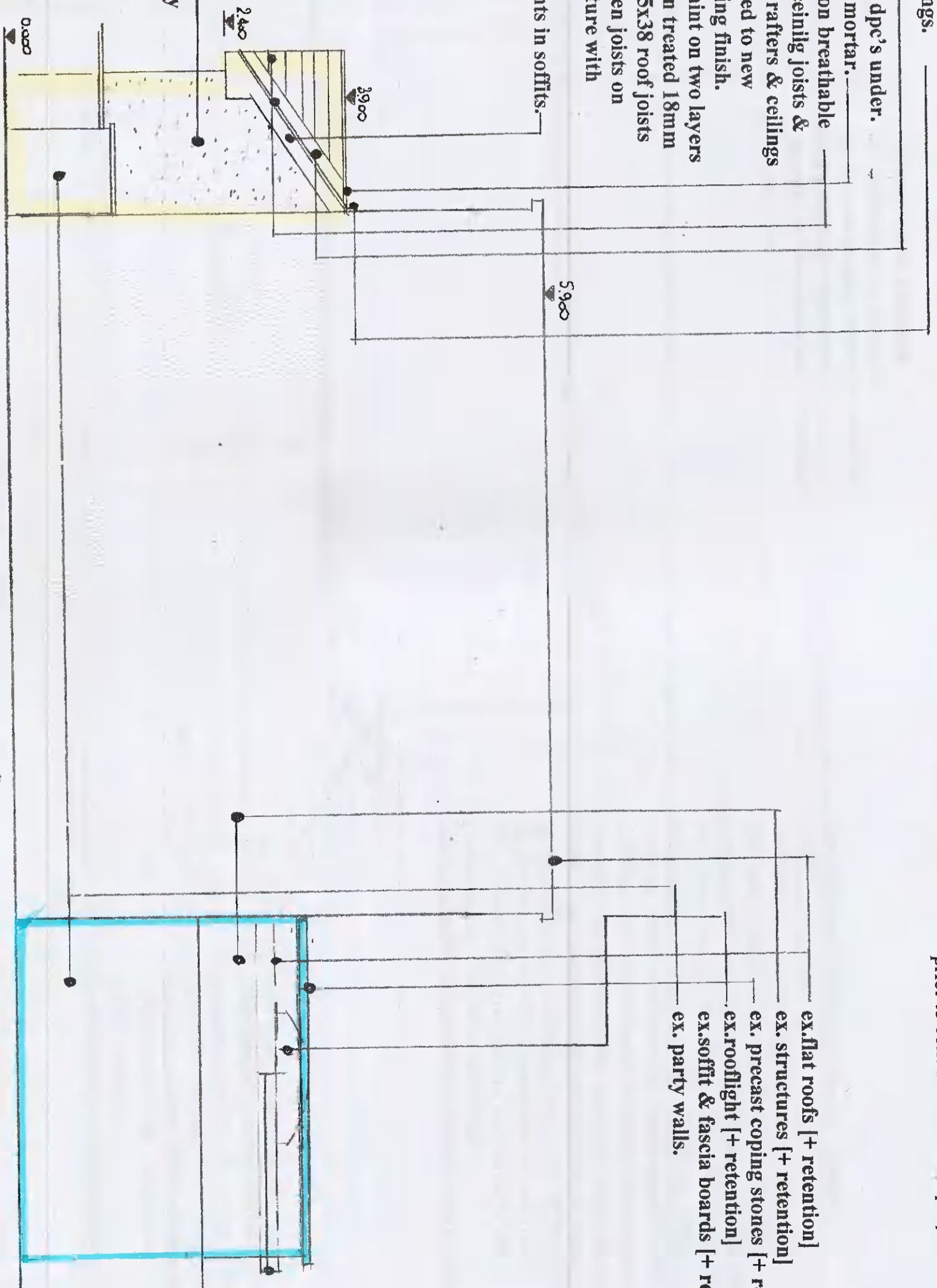

Proposed -----  
 Retention. \_\_\_\_\_

**Proposed Side Elevation [from no.2]**  
**Retention Side Elevation [from no.2] scale 1:50.**

Drawing No. 10.09.2021

**DESMOND J. HALPIN, & ASSOCIATES**  
 PLANNING & BUILDING DESIGN CONSULTANTS,  
 15, Carriglea Drive,  
 Firhouse,  
 Dublin, 24.  
 Registered Company No: 111360.  
 E-Mail: DesHALPIN15@GMail.com