

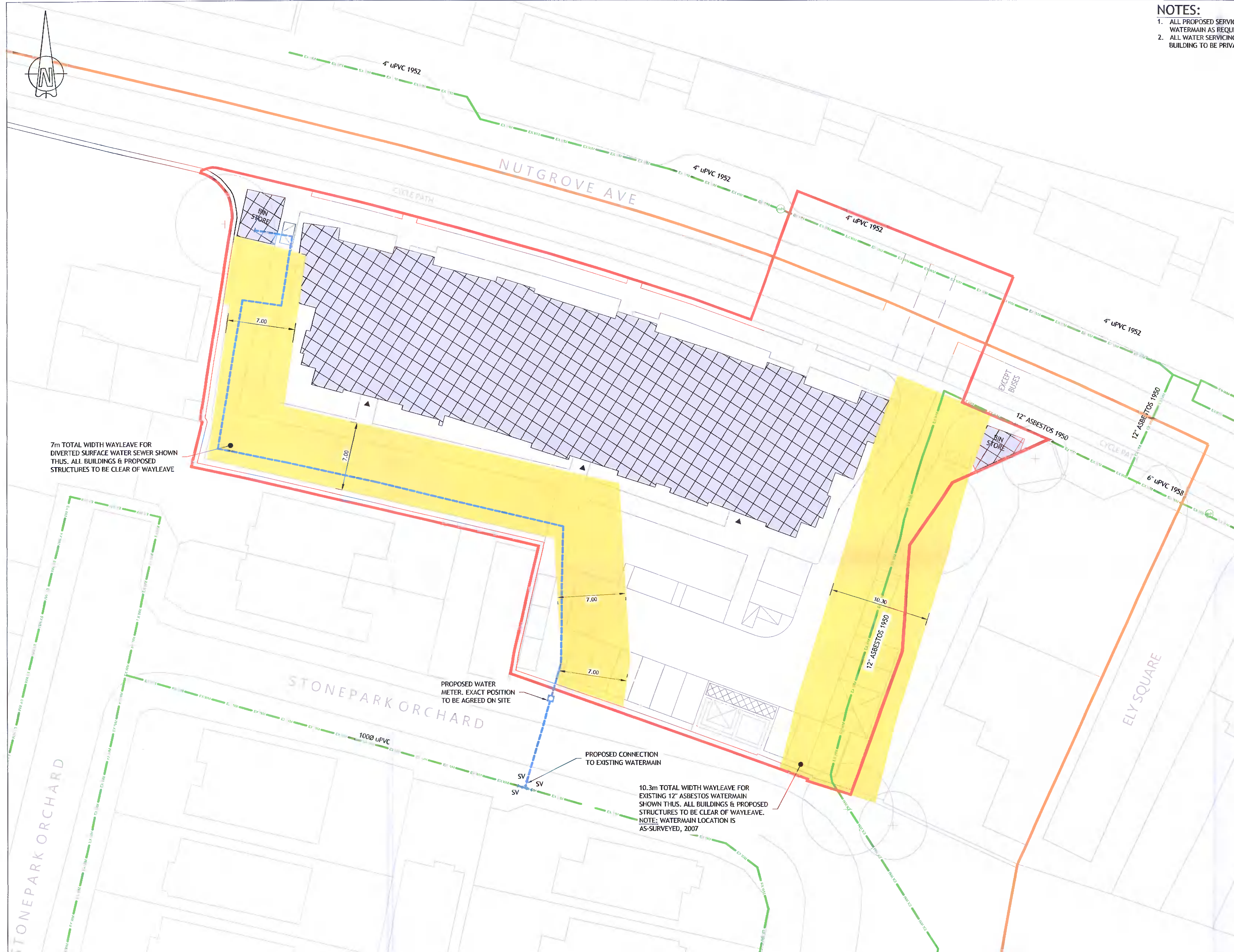

- NOTES:**
1. ALL PROPOSED SERVICES TO BE 2.0m MIN CLEAR OF EXISTING WATERMAIN AS REQUIRED BY IRISH WATER.
  2. ALL WATER SERVICING AFTER THE WATER METER SERVICING BUILDING TO BE PRIVATELY OWNED AND MAINTAINED

**LEGEND:**

- PROPOSED 125mm OD PE 100 SDR 11 (100mm ID) WATERMAIN, INTERNAL WATERMAIN & CONNECTIONS TO M&E LAYOUTS & DETAILS
- PROPOSED WATER METER
- PROPOSED SLUICE VALVE
- EXISTING WATERMAIN AS SPECIFIED
- EXISTING FIRE HYDRANT
- EXTENT OF SURFACE WATER SEWER & WATERMAIN WAYLEAVE
- OUTLINE OF PROPOSED BUILDINGS
- EXTENT OF DEVELOPMENT
- INDICATIVE BOUNDARY BETWEEN DUN LAOGHAIRE RATHDOWN AND SOUTH DUBLIN COUNTY COUNCILS



**PROPRIETARY PRODUCT NAMES, MANUFACTURER'S NAMES, SUPPLIER'S NAMES, NATIONAL STANDARDS**

WHERE A SPECIFICATION OR A DESCRIPTION OF A PRODUCT OR ELEMENT OF WORK INCLUDES A SPECIFIC MAKE OR SOURCE SUCH AS A PRODUCT NAME OR MANUFACTURER'S NAME OR A SUPPLIER'S NAME, OR A NATIONAL STANDARD, THE SPECIFICATION OR DESCRIPTION SHALL BE DEEMED TO BE ACCOMPANIED BY THE WORDS "OR EQUIVALENT" NOTWITHSTANDING THAT THOSE EXACT WORDS MAY NOT IN FACT ACCOMPANY THE NAME OR STANDARD. THIS ALSO APPLIES WHERE THE NAME OR STANDARD IS ACCOMPANIED BY OTHER WORDS SUCH AS "OR EQUAL APPROVED" OR SUCH LIKE PHRASES.

**MATERIALS IN CONTACT WITH POTABLE WATER**

ALL MATERIALS, SUBSTANCES AND PRODUCTS IN CONTACT WITH POTABLE WATER SHALL COMPLY IN ALL RESPECTS WITH THE EUROPEAN COMMUNITIES (DRINKING WATER) (NO. 2) REGULATIONS, 2007 (S.I. NO. 278 OF 2007) AND SHALL BE INCLUDED IN THE LATEST "LIST OF APPROVED PRODUCTS AND PROCESSES" PUBLISHED BY THE DRINKING WATER INSPECTORATE FOR ENGLAND AND WALES. THE CONTRACTOR SHALL PRODUCE DOCUMENTARY EVIDENCE THAT THE SUBSTANCE OR PRODUCT HAS BEEN SPECIFICALLY APPROVED UNDER THE DWI SYSTEM, OR EQUIVALENT APPROVAL SYSTEM.

Ordnance Survey Ireland Licence No. EN 0003720  
© Ordnance Survey Ireland/Government of Ireland

**© PUNCH Consulting Engineers**  
This drawing and any design herein is the copyright of the Consultants and must not be reproduced without their written consent. All drawings remain the property of the Consultants. Figured dimension only to be taken from this drawing. Consultants to be informed immediately of any discrepancies before work proceeds.



Rev	Amendment	By	Date	Rev	Amendment	By	Date	Client:
CO1	PLANNING ISSUE	IBS	2021/04/19					SIRIO HOMES
CO2	PLANNING F1 RESPONSE	DAP	2021/09/16					

**PUNCH**  
consulting engineers  
Dublin | Limerick | Cork | Galway | Glasgow  
Garnegie House Library Road,  
Rush Loughaire, Co. Dublin, A96 C7W7  
+353 1 271 2200 | punch@punch.ie

Project:	RESIDENTIAL DEVELOPMENT, NUTGROVE AVENUE, RATHFARNHAM, DUBLIN				
Title:	PROPOSED WATERMAIN LAYOUT				
Drawn:	IBS	Checked:	IBS	Approved:	PC
Date:	JANUARY 2021	Project No.:	202252-PUNCH-XX-XX-M2-C-0200	Revision:	MR
Scale:	1:200	Drawing Status:	AO	Revision No.:	CO2
Project No.:	202252	Revision:	202252-PUNCH-XX-XX-DR-C-0200		