

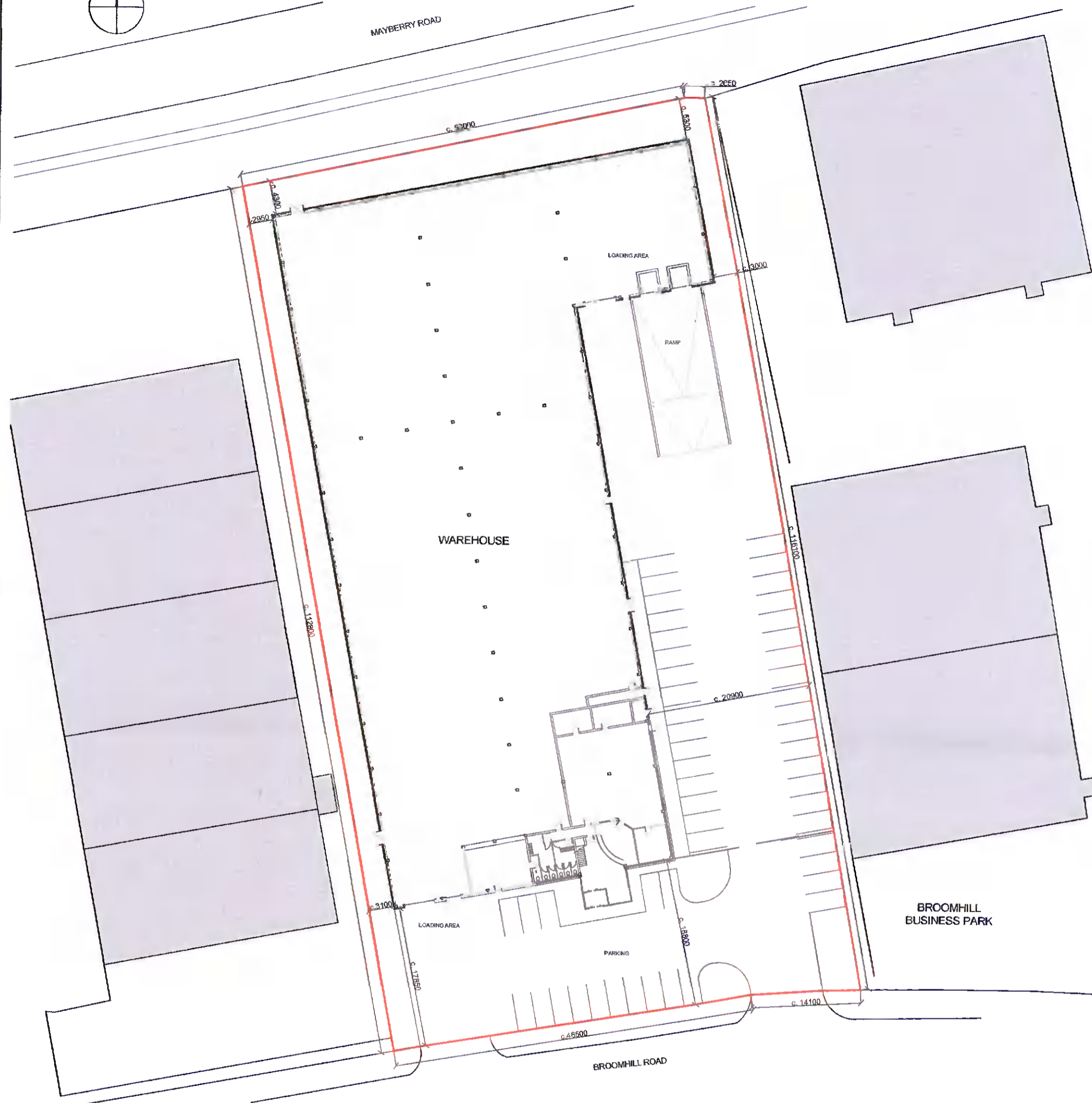

MAYBERRY ROAD



EXISTING SITE LAYOUT PLAN  
1:500



MAYBERRY ROAD

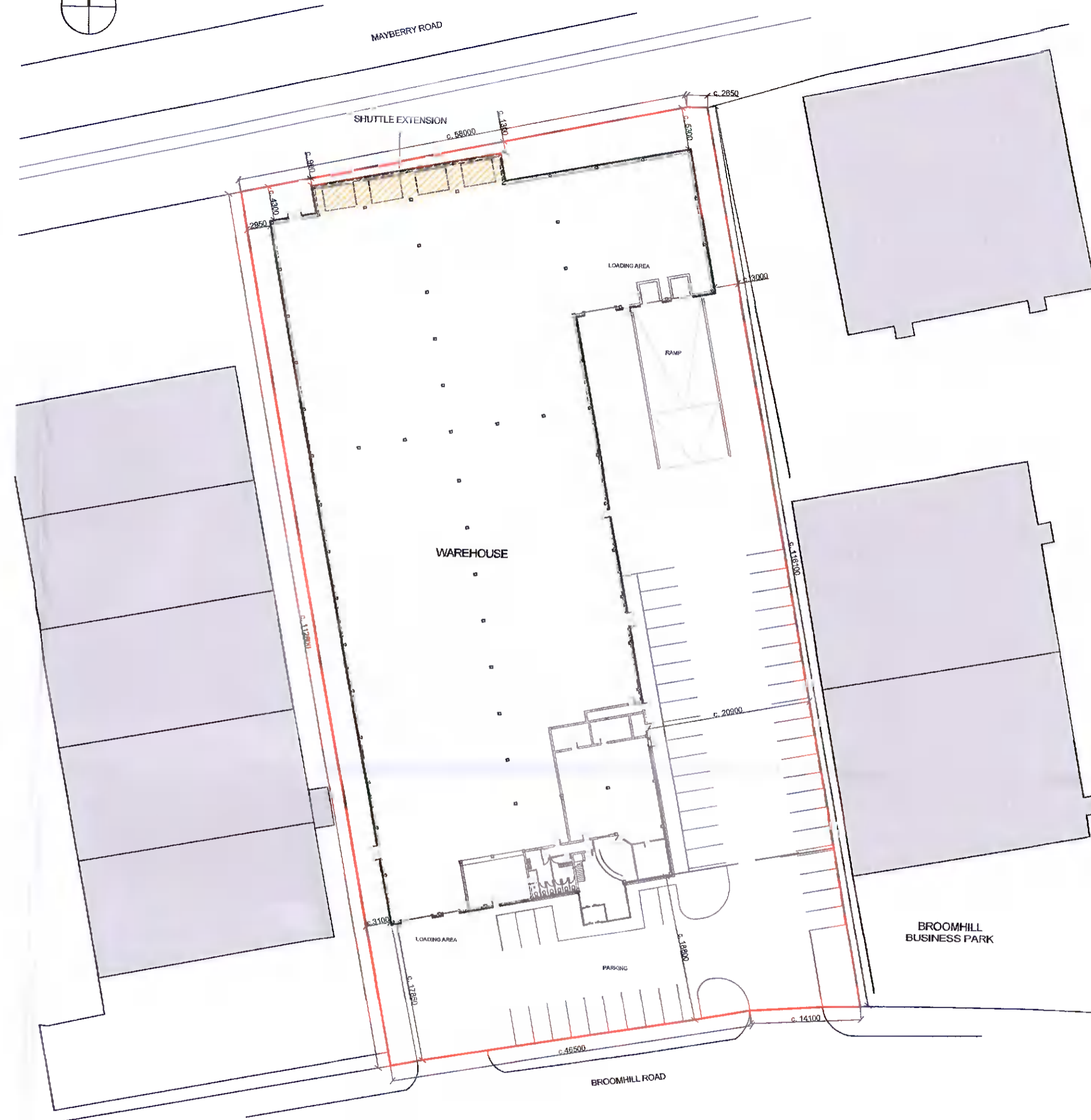

PROPOSED SITE LAYOUT PLAN  
1:500

**LEGEND**

APPLICANT SITE OUTLINED IN RED

PROPOSED EXTENSION SHOWN ORANGE



**FOR PLANNING**

REV	DESCRIPTION	DATE
<b>Integrated Development Services Ltd.</b>		
D5 Swords Enterprise Park, Feltrim Road, Swords, Co. Dublin		Ph: 01 8970972   Fax 01 8970973 Email: intdevs@outlook.com
<b>CLIENT</b> McHugh Components		
<b>PROJECT</b> Extension at Existing Warehouse, 89 Broomhill Road, Tallaght, Dublin 24.		
<b>DRAWING TITLE</b> Existing and Proposed Site Layout Plans		
<b>SCALE(S)</b> 1:500 @ A2	<b>DATE</b> 25/8/2021	<b>JOB NO.</b> 21-7-2
		<b>DWG. NO.</b> 21-7-2-P5
		<b>REV.</b>