

PROPOSED GROUND FLOOR PLAN
1:200

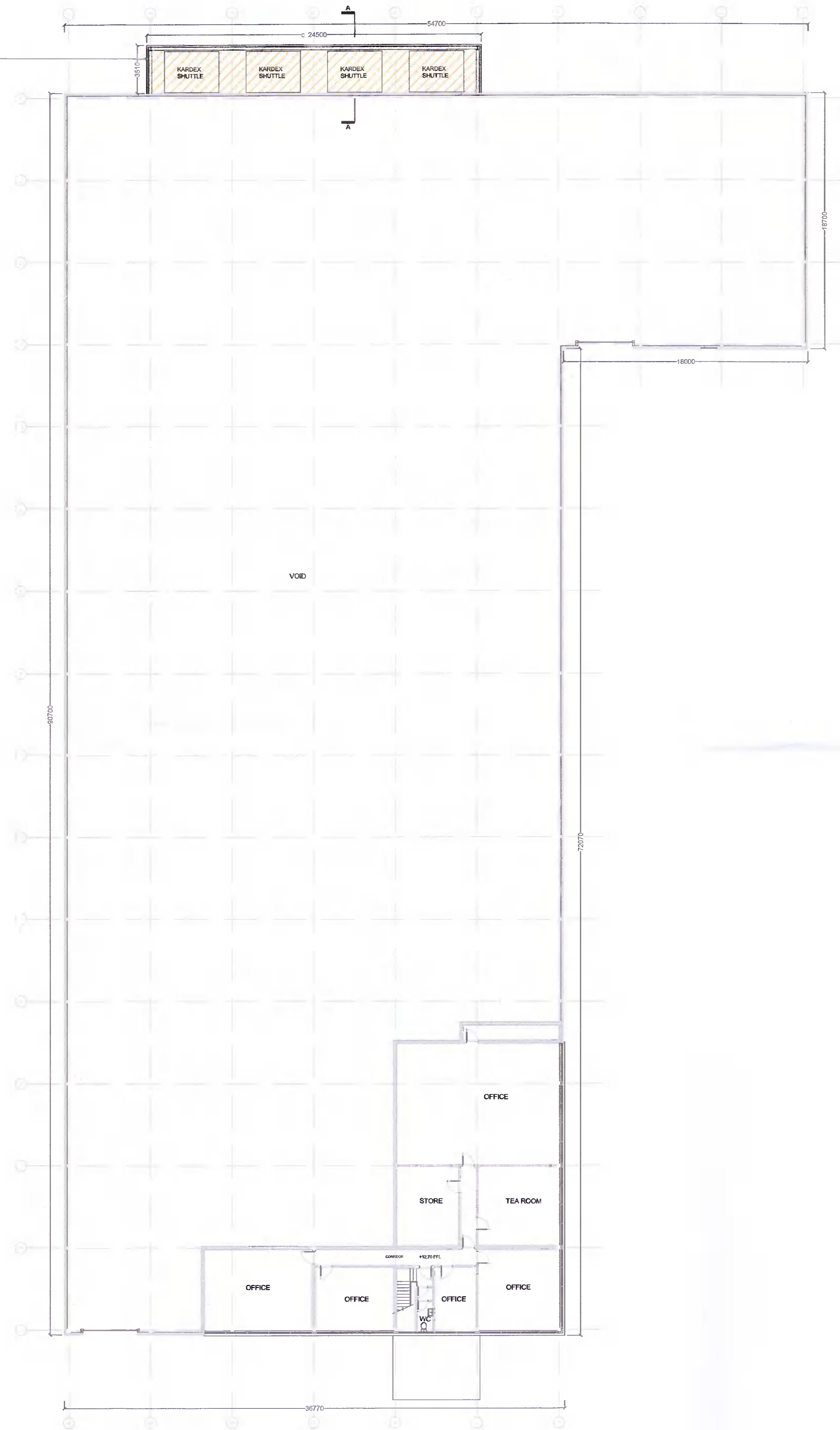

PROPOSED FIRST FLOOR PLAN
1:200

LEGEND
PROPOSED EXTENSION SHOWN ORANGE



FOR PLANNING

REV.	DESCRIPTION	DATE
Integrated Development Services Ltd.		
D5 Swords Enterprise Park, Feltrim Road, Swords, Co. Dublin		Ph: 01 8970972 Fax: 01 8970973 Email: intdevs@outlook.com
CLIENT McHugh Components		
PROJECT Extension at Existing Warehouse, 69 Broomhill Road, Talleght, Dublin 24.		
DRAWING TITLE Proposed Plans		
SCALE(S) 1:200 @ A1	DATE 24/08/2021	JOB NO. 21-7-2
		DWG. NO. 21-7-2-P3
		REV.