

DRAWING : PROPOSED DRAINAGE LAYOUT PLAN

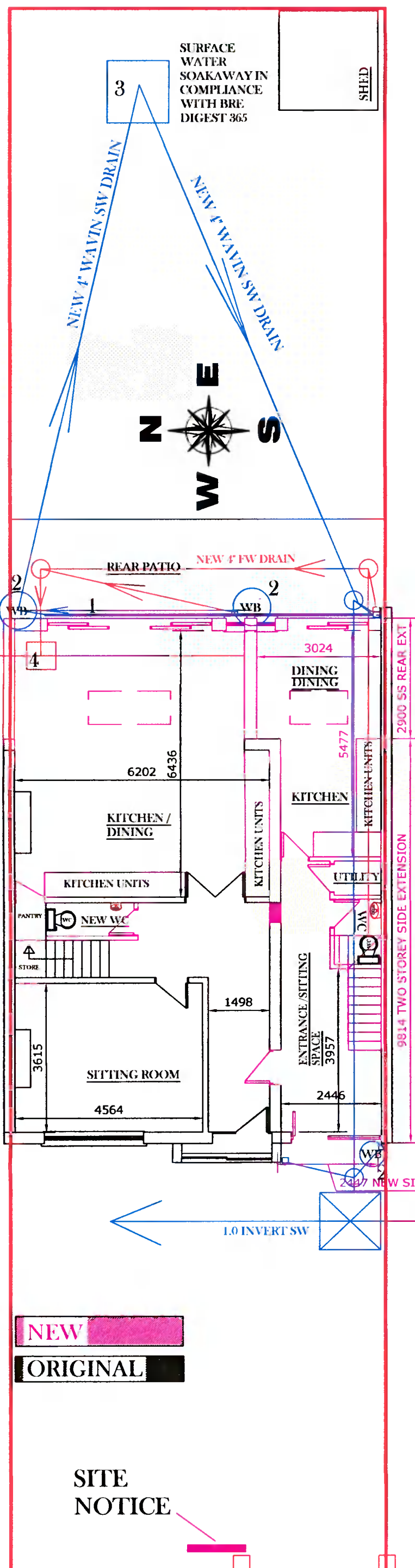

- 1: CONTINUOUS ACO DRAIN ACROSS REAR SINGLE STOREY EXTENSION
- 2: WATER BUT AT ALL NEW SURFACE WATER DOWNPIPE LOCATIONS
- 3: SURFACE WATER FROM NEW ROOFS RUN INTO SURFACE WATER SOAKAWAY IN COMPLIANCE WITH BRE DIGEST 365 IN ADVANCE OF RUNNING INTO MAIN SURFACE WATER DRAIN
- 4: SEALED INTERNAL MANHOLE COVER ON INTERNAL MAIN FOUL DRAIN

Blue –indicates
Surface water drain

Red –indicates Foul
water drain

Notes on drainage :

All surface water downpipes to perimeter of dwelling to discharge to waterbutt prior to discharging soakaway & main drain .

Any drains running under the building to be protected in rising walls by placing a concrete lintol in rising wall bridging pipe 100mm above the pipe , to prevent any damage to pipe by building settlement .

Any Pipework running under the building to be surrounded with leanmix concrete for full protection of pipework

Please note : any encroachment to immediate neighbours , caused by any works indicated on these drawings , to be agreed in writing by clients with immediate neighbours prior to works commencement .

Use of party walls with immediate neighbour to be agreed in writing by clients with immediate neighbour prior to works commencement

Drainage : Builder to take for familiarising himself with existing drains in site space , builder to take for inspection of existing drains on site and to repair any damage , where a drain is running through a new masonry wall a concrete head to be placed in wall 100mm above top of pipe to allow building settlement without damage to pipe . Allow for as much as possible separation of foul & surface water drains

NEW

ORIGINAL

ORIGINAL

NEW WORK

SITE NOTICE

Drawing :	Proposed Drainage Layout plan
Project :	1 Hillary Garvey intend to apply for full planning permission for 1: Demolition of following ; existing single storey garage , rear single storey extension , rear sheds , side chimney 2: Construction of a new two storey side and a new single storey rear extension , the new two storey side extension and part of the new rear single storey extension will contain a family flat unit with separate entrance to front at 52 cypress grove road , Dublin 6w ,D6W Y720
Prepared by :	BDCS Ltd , Lower Friarstown , Bohernabreena , Dublin 24 Ph : 087-2825326 Email :michael.finnan043@gmail.com
Date :	11-8-2021
Scale :	1:100
Drawing nr :	5
Please Note : These drawings are to be regarded as planning application drawings ,working drawings to be prepared in advance of works commencing on site , no works to commence until author is notified . Any site dimension discrepancy to be notified to Author immediately	