

PUBLIC ROADWAY

CYCLE-WAY

GRASS VERGE

CONCRETE FOOTPATH

Drawing:	Proposed Site Layout plan
Project:	I Hillary Garry intend to apply for full planning permission for 1: Demolition of following: existing single storey garage, rear single storey extension, rear sheds, side chimney 2; Construction of a new two storey side and a new single storey rear extension, the new two storey side extension and part of the new rear single storey extension will contain a family flat unit with separate entrance to front at 52 cypress grove road, Dublin 6w, D6W Y720
Prepared by:	BDCS Ltd, Lower Priarstown, Bockmahreana, Dublin 24 Ph: 087-2825396 Email: michael.finnan04@gmail.com
Date:	11-8-2021
Scale:	1:125
Drawing no:	6

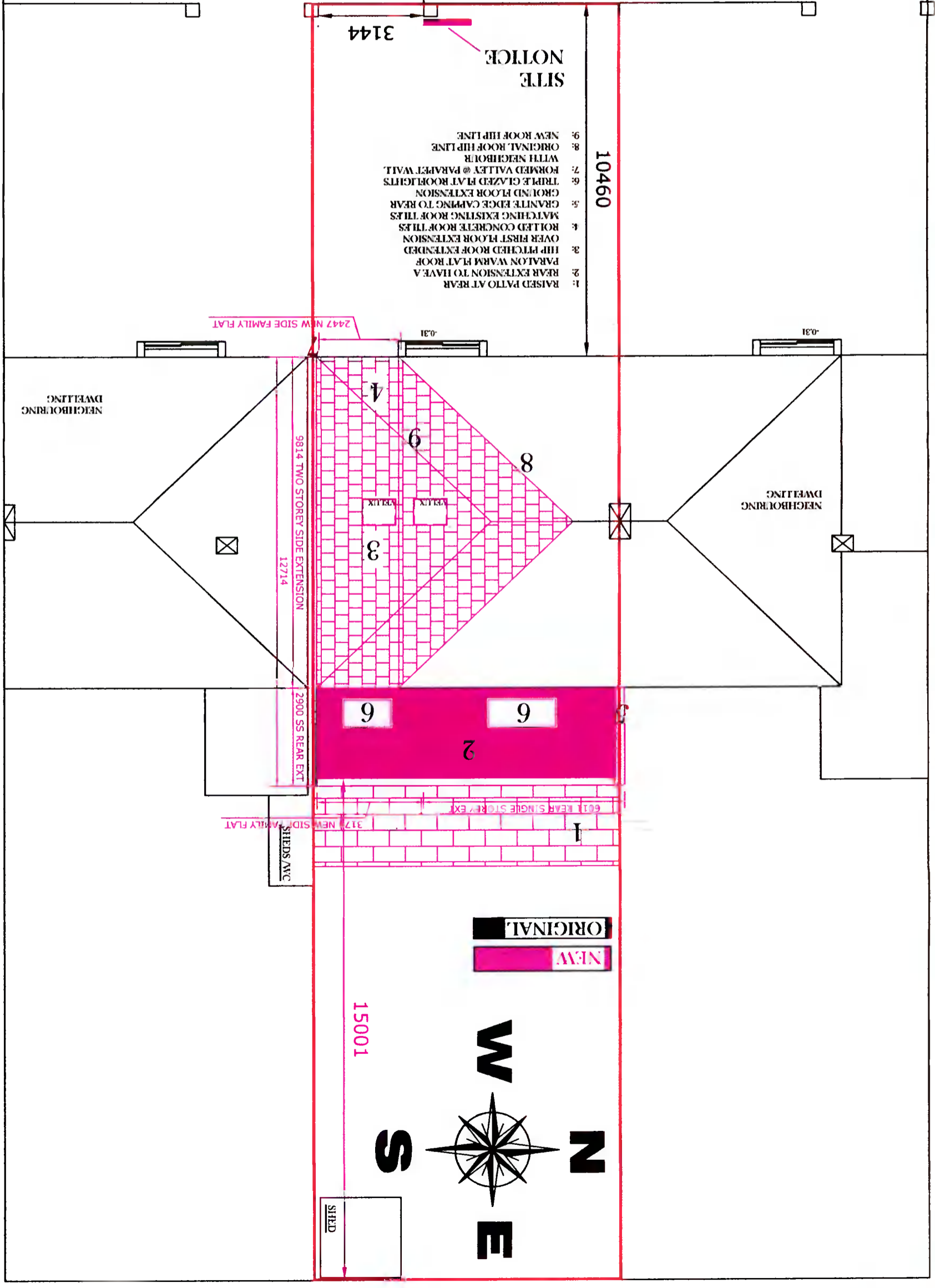

DRAWING : PROPOSED SITE PLAN