

CARPARK SPECIFICATION
 SMA 10 SURF 40/60 DES TO NRA SERIES 900 CL 5.1.2 - 40MM
 AC 20 DENSE BIN 40/60 DES TO NRA SERIES 900 CL 3.1.4 - 70MM
 CL 804 GRANULAR SUBBASE MATERIAL - 150MM
 6F2 CAPPING LAYER - 600MM (MIN)

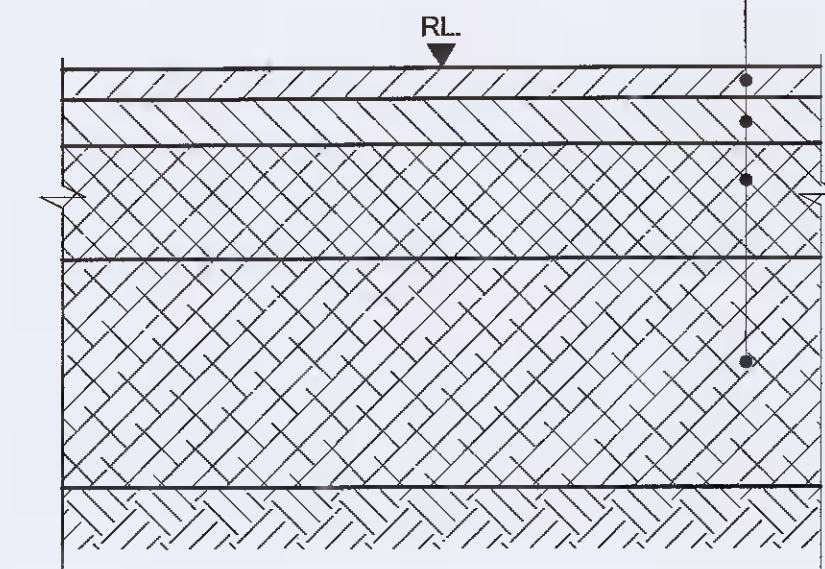

CARPARK CONSTRUCTION DETAIL
 Scale: 1:10

TYPICAL ROAD SPECIFICATION
 HRA 30/14F SURF 40/60 DES TO NRA SERIES 900 CL 4.1.1
 63 PSN WITH 20MM PPE-COATED CHIPPINGS TO CL4.2.4 - 40MM
 AC 20 DENSE BIN 40/60 DES TO NRA SERIES 900 CL 3.1.4 - 60MM
 AC 32 DENSE BASE 40/60 DES TO NRA SERIES 900 CL 3.1.1 - 130MM
 CL804 GRANULAR SUBBASE MATERIAL - 150MM
 6F2 CAPPING LAYER - 600MM (MIN)
 FILL BETWEEN EXISTING GROUND AND UNDERSIDE OF CAPPING TO BE IN ACCORDANCE WITH EARTHWORKS REQUIREMENTS

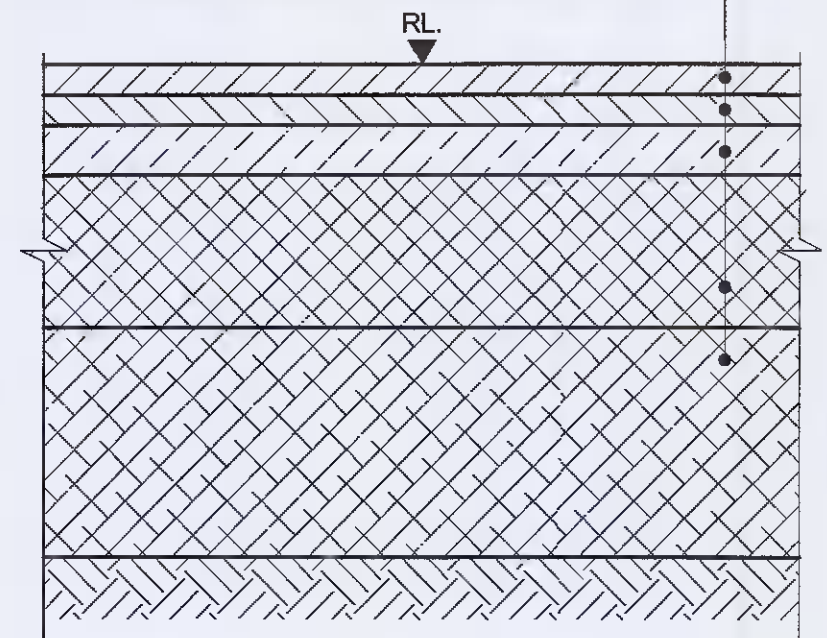

TYPICAL ROAD CONSTRUCTION
 Scale: 1:10

DELIVERY YARD CONCRETE SLAB SPECIFICATION
 200MM CONCRETE SLAB WITH A393 MESH T&B
 SEPARATION/SLIP MEMBRANE: 1200 GAUGE (300 MICRON)
 WITH 600MM TAPED LAPS AT ENDS AND EDGES
 GRANULAR SUBBASE MATERIAL TO SR21 ANNEX E - 200MM
 6N2 CAPPING LAYER - 600MM (MIN)
 MOVEMENT JOINTS AT MIN 7.5M CENTRES

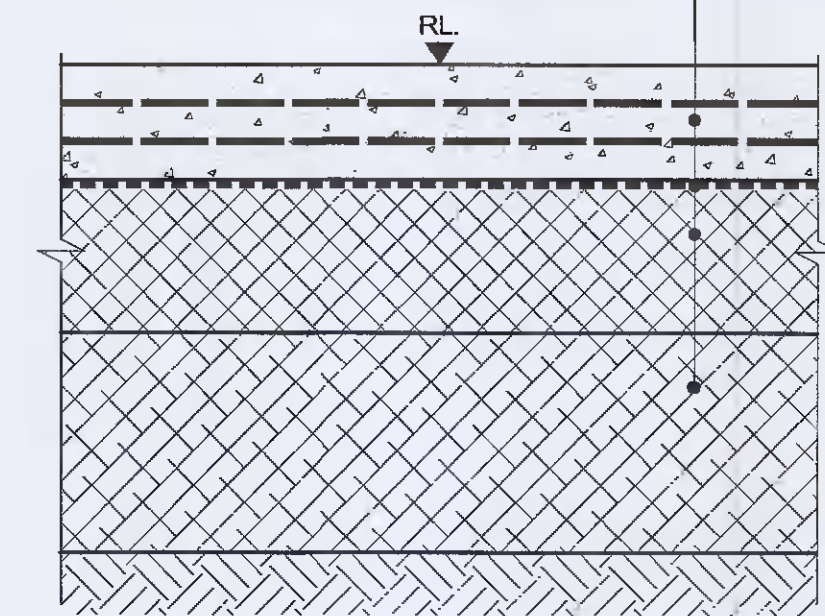

GENERATOR & LOADING DOCK YARD CONCRETE SLAB
 Scale: 1:10

NOTE
 ALTERNATE EXPANSION AND CONTRACTION JOINTS TO BE PROVIDED EVERY TO 6m LENGTH

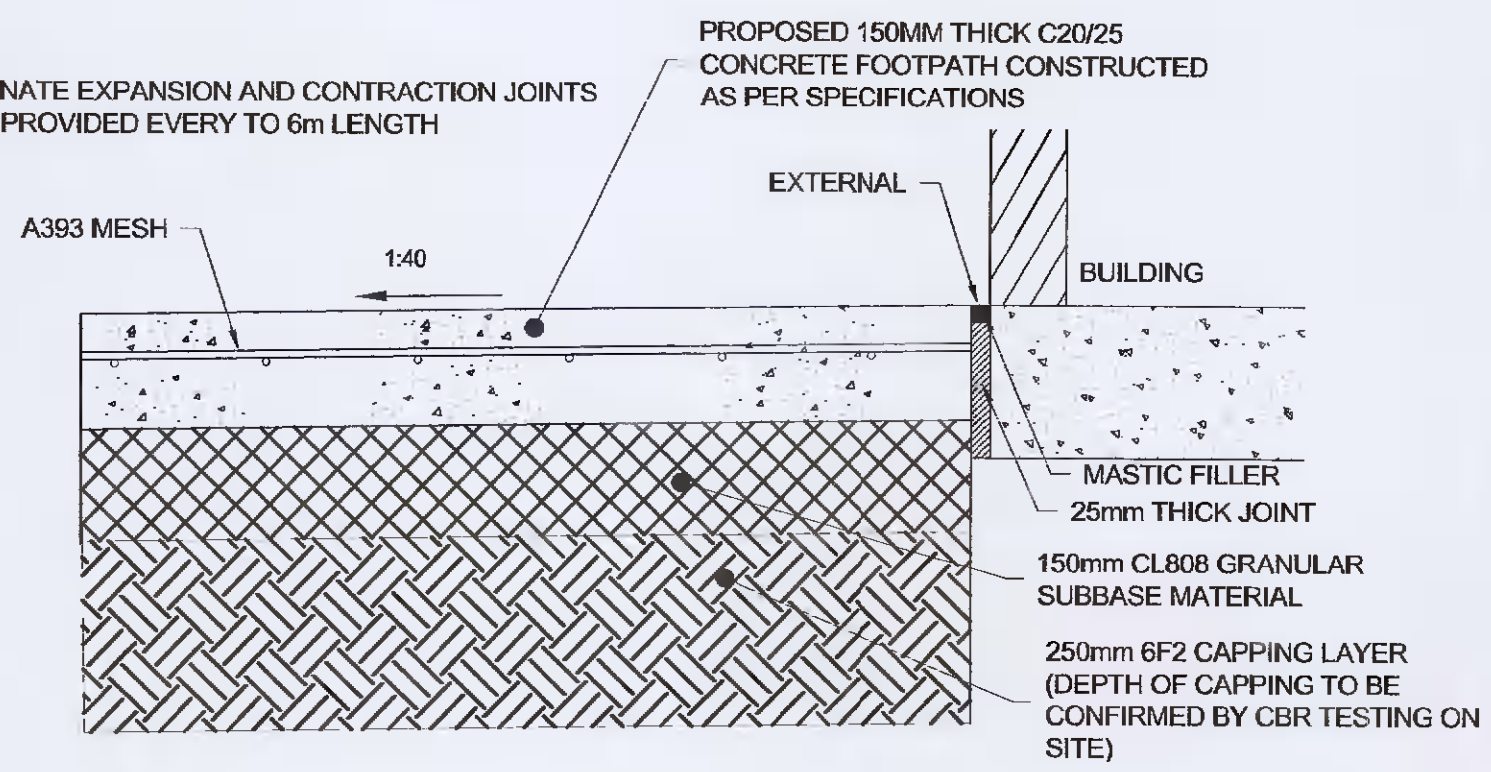

CONCRETE FOOTPATH
 Scale: 1:10

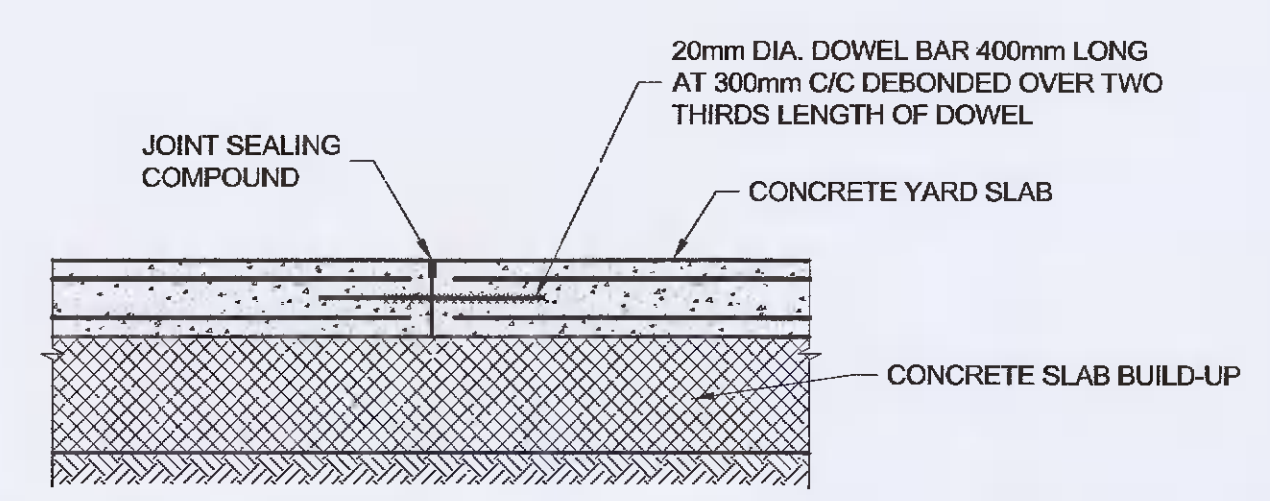

FORMED FREE MOVEMENT - CONTRACTION JOINT (CJ/DAY JOINT)
 Scale: 1:20

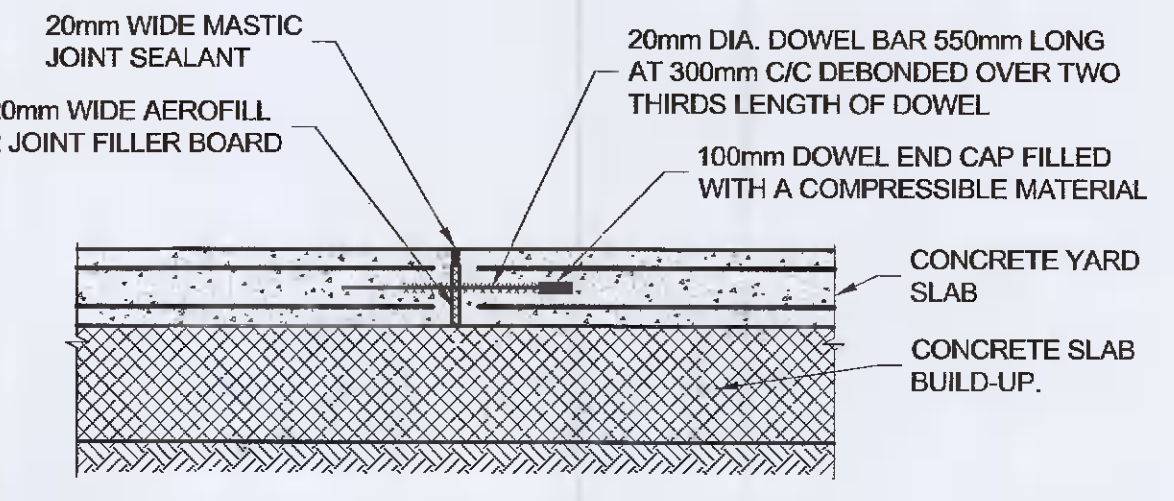

FORMED MOVEMENT JOINT - EXPANSION JOINT
 Scale: 1:20

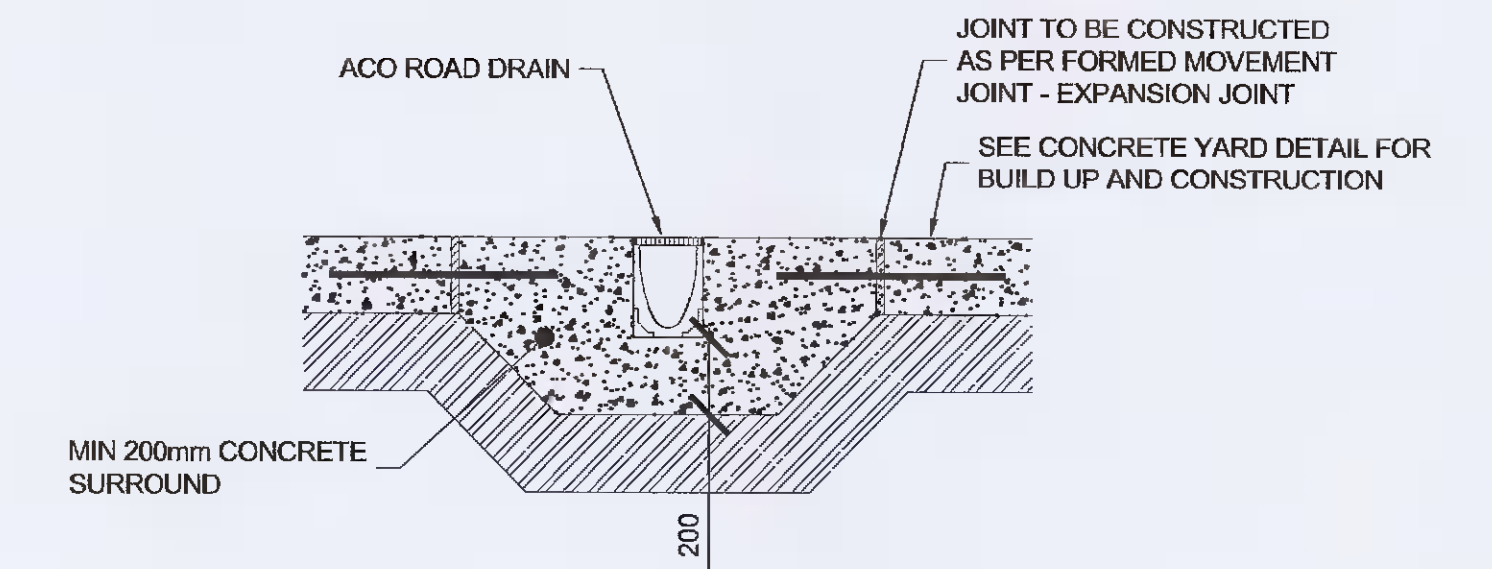

ACO ROADRAIN INSTALLATION DETAIL
 Scale: 1:20

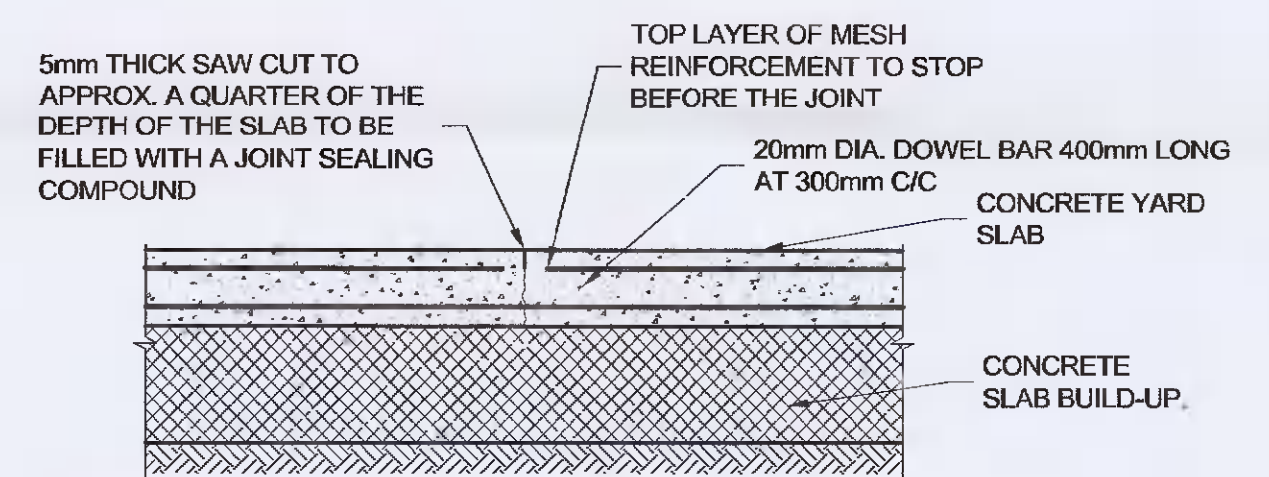

SAWN RESTRAINED MOVEMENT JOINT
 Scale: 1:20

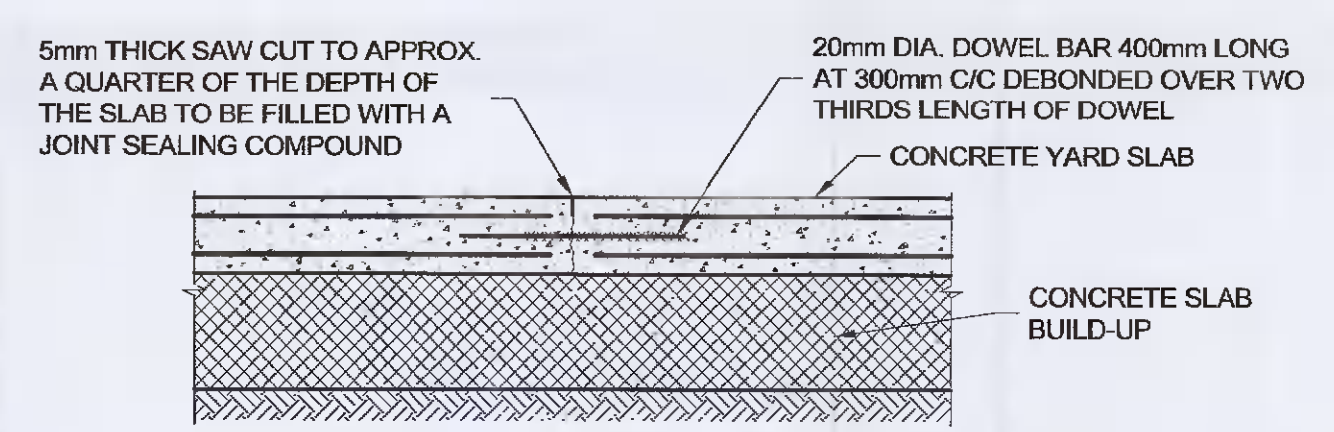

SAWN FREE MOVEMENT JOINT
 Scale: 1:20

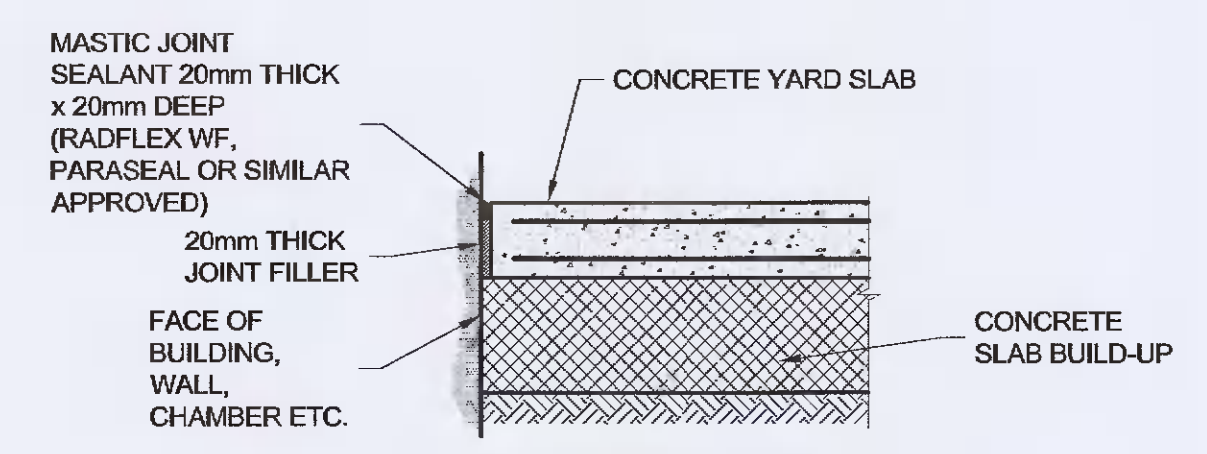

ISOLATION JOINT (IJ)
 Scale: 1:20

PERMEABLE PAVING (TOBERMORE HYDROPAVE) CONSTRUCTION DETAIL
 240X120X80MM THICK TOBERMORE HYDROPAVE BLOCK LAID IN HERRINGBONE PATTERN. MIN JOINT WIDTH = 6MM (AREA OF VOIDS MUST EXCEED 6% OF TOTAL PAVED SURFACE AREA)
 50MM THICKNESS OF GRADED 6.3-2.0MM GRIT TO BS EN 7533-13
 350MM 4/20MM COURSE GRADED AGGREGATED TO BS EN 7533-13
 2000 GAUGE POLYTHENE IMPERMEABLE MEMBRANE.
 600MM 6F2 CAPPING LAYER
 FILL BETWEEN EXISTING GROUND AND UNDERSIDE OF CAPPING TO BE IN ACCORDANCE WITH EARTHWORKS REQUIREMENTS

NOTE:
 REFER TO DUB14-15_C-C-S02 SERIES OF DRAWINGS FOR LOCATION OF PROPOSED HYDROPAVE SURFACE



MIN. 150mmØ PERFORATED PIPE TO EXTEND INTO THE SUB-BASE. OUTLET PIPE TO HAVE TOP HAT SEAL.

HYDROPAVE CONSTRUCTION DETAIL
 SCALE 1:20

<p>Client: Digital Netherlands VIII B.V. (Netherlands)</p>					<p>Project Title: INXN DUB15/16</p>		<p>Drawing Title: Standard Details Sheet 10 of 11</p>		<p>Scale at A1: As Shown</p>										
<p>ARUP</p> <p>Ang, 50 Ringsend Road Dublin, D04 T6X0 www.arup.ie Tel +353(0)1 233 4455 Fax +353(0)1 668 3166</p>					<p>Rev: 01</p>		<p>Rev: C01</p>		<p>Name: IE-DUBZZ-STE1-EO-ARP-DR-C-0121</p>										
<table border="1"> <tr> <th>Rev</th> <th>Date</th> <th>By</th> <th>Chkd</th> <th>Appd</th> </tr> <tr> <td>C01</td> <td>18/07/21</td> <td>DF</td> <td>CDS</td> <td>JMAC</td> </tr> </table> <p>Issued for Planning</p>	Rev	Date	By	Chkd	Appd	C01	18/07/21	DF	CDS	JMAC									
Rev	Date	By	Chkd	Appd															
C01	18/07/21	DF	CDS	JMAC															