

THIS DOCUMENT IS THE PROPERTY OF RSK | CONSULTANTS AND SHOULD NOT BE REPRODUCED OR TRANSMITTED IN ANY FORM OR BY ANY MEANS, ELECTRONIC OR MECHANICAL, INCLUDING PHOTOCOPYING, RECORDING, OR BY ANY INFORMATION STORAGE AND RETRIEVAL SYSTEM, WITHOUT THE WRITTEN PERMISSION OF RSK | CONSULTANTS. THE INFORMATION CONTAINED HEREIN IS CONFIDENTIAL AND IS NOT TO BE DISCLOSED TO ANY OTHER PARTY WITHOUT THE WRITTEN PERMISSION OF RSK | CONSULTANTS. RSK | CONSULTANTS ACCEPTS NO LIABILITY FOR ANY LOSS OR DAMAGE, INCLUDING CONSEQUENTIAL DAMAGES, ARISING FROM THE USE OF THIS DOCUMENT.

SUPPORTING BUILDINGS GFA SCHEDULE	
NAME	AREA
DISTRIBUTION GAS COMPOUND	27 m ²
HEAT RECOVERY BUILDING	27 m ²
HV CONTAINER	40 m ²
LV & CONTROL CONTAINER	21 m ²
MV SWITCHROOMS	644 m ²
PUMP ROOM	52 m ²
REFUSE	25 m ²
TRANSFORMERS	19 m ²
GRAND TOTAL	856 m²

DATA CENTRE BUILDINGS GFA SCHEDULE	
BUILDING	AREA
DUB15	16865 m ²
DUB16	16712 m ²
BUILDING TOTAL	33577 m²

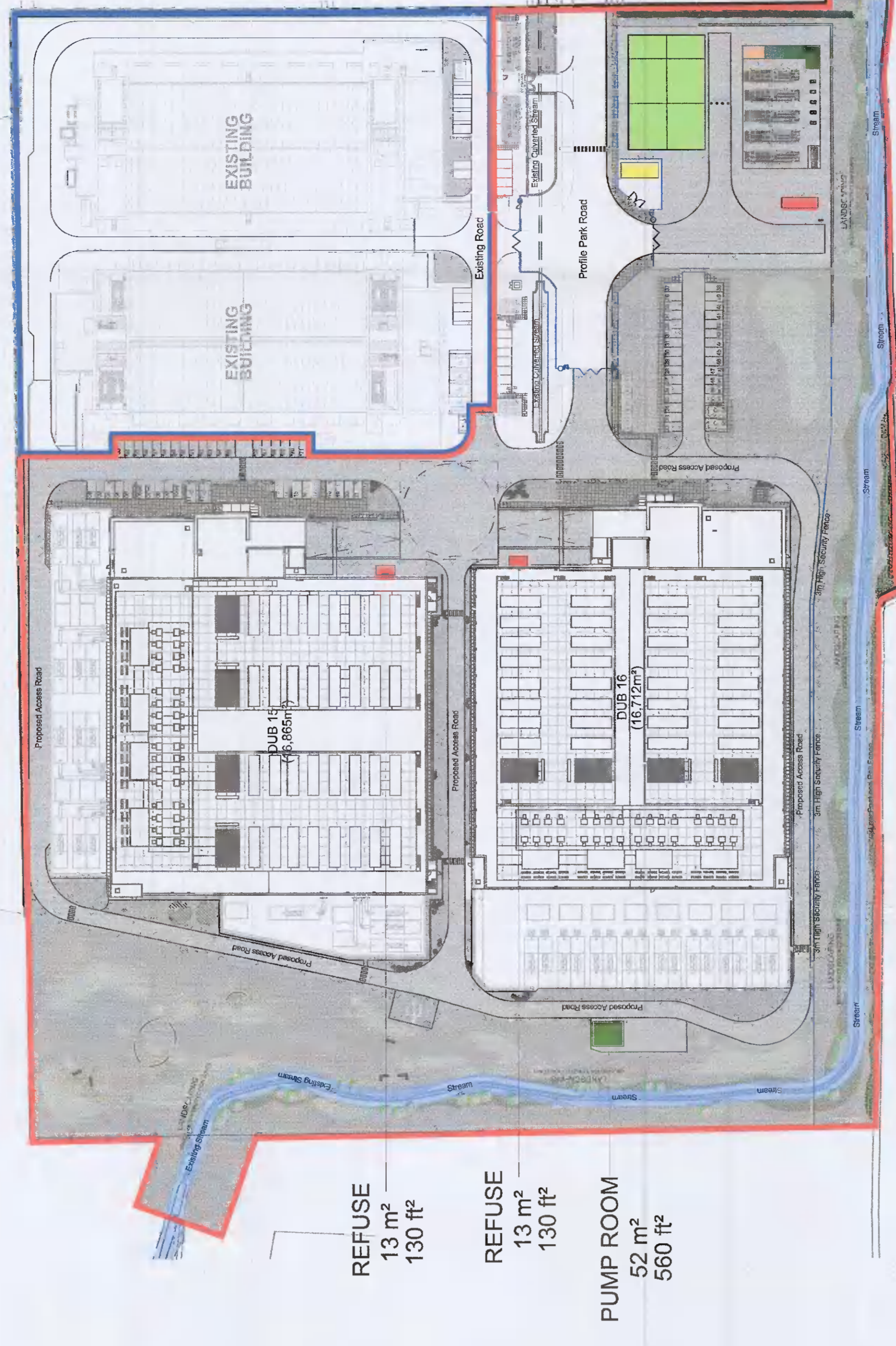
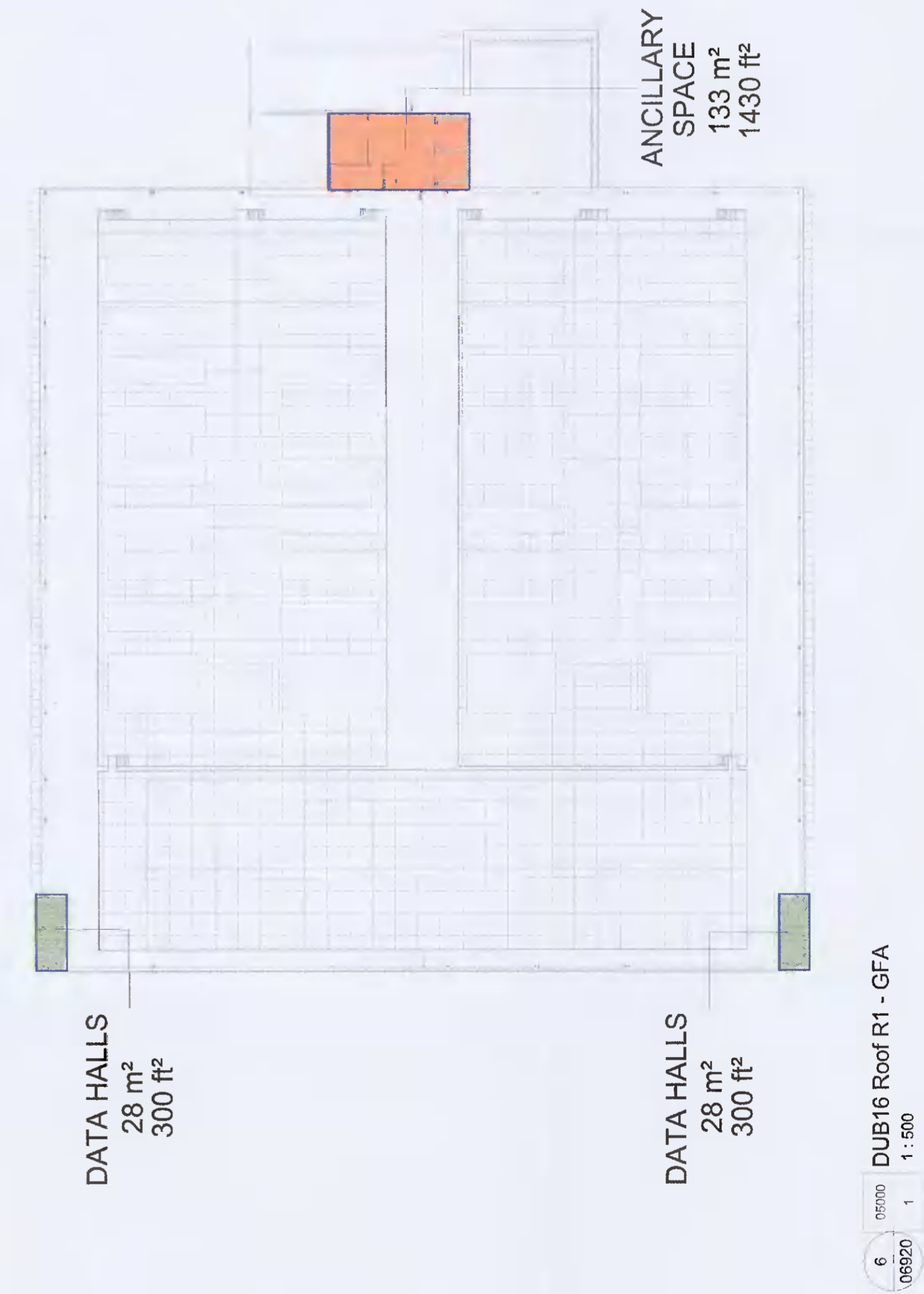
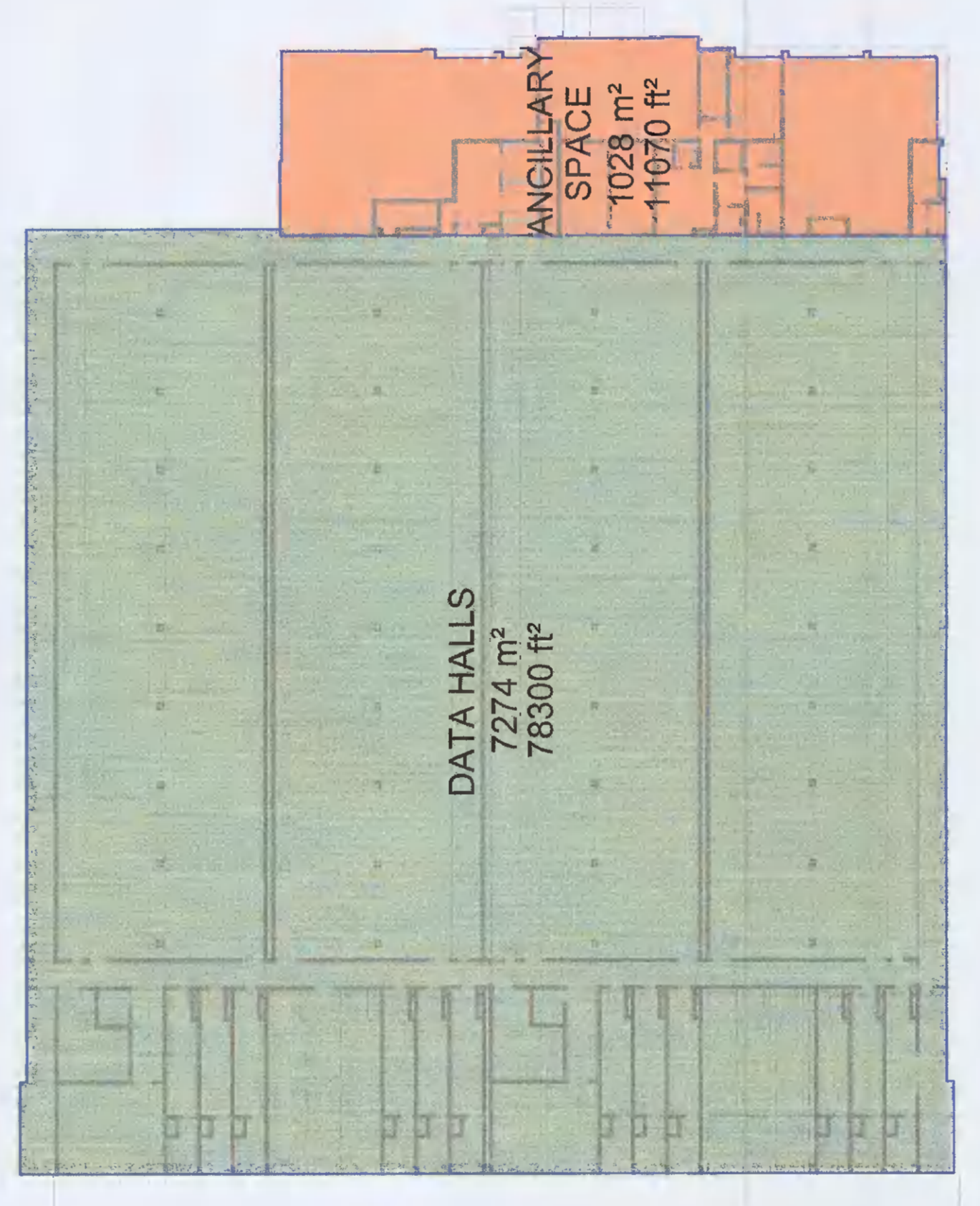
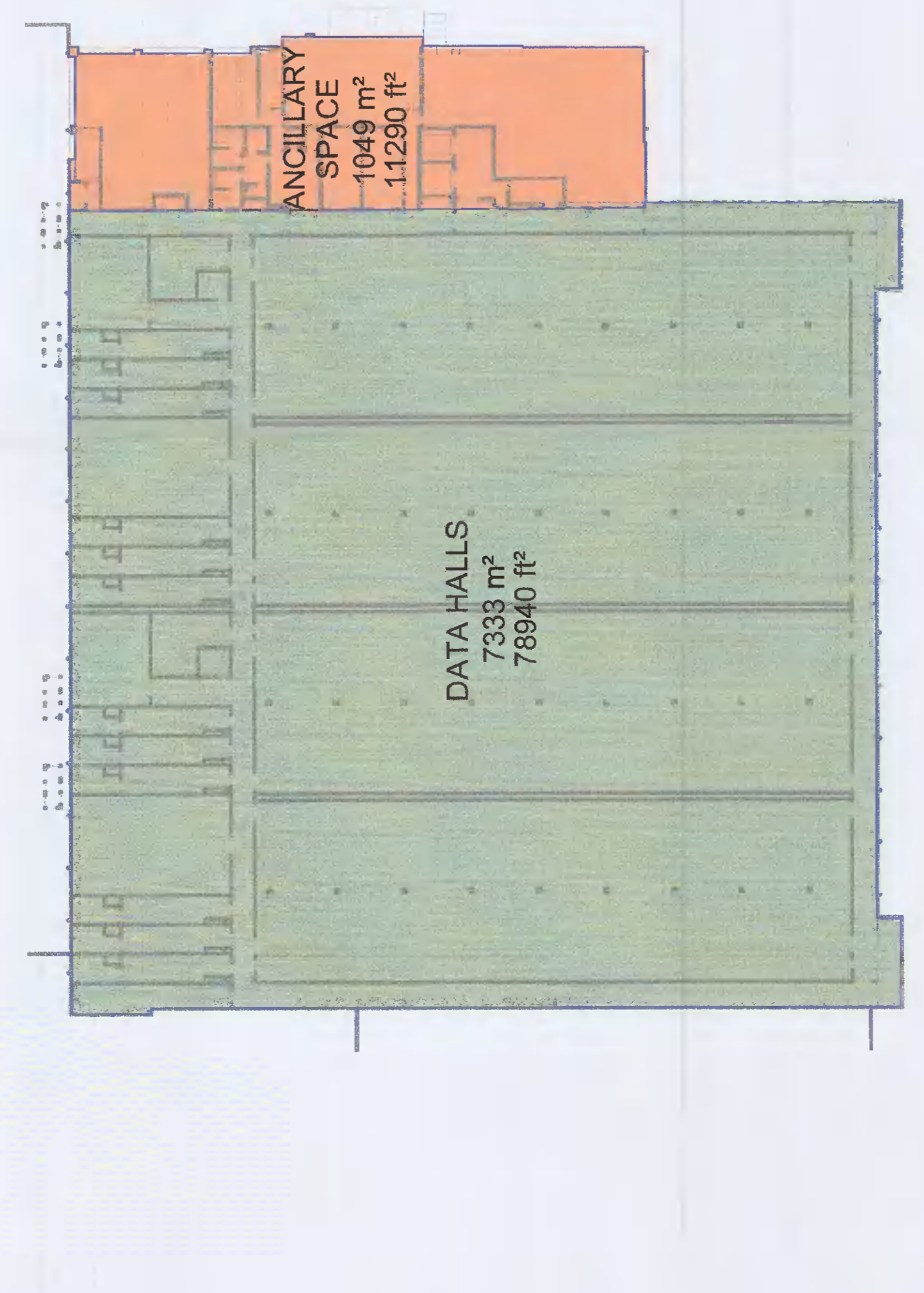
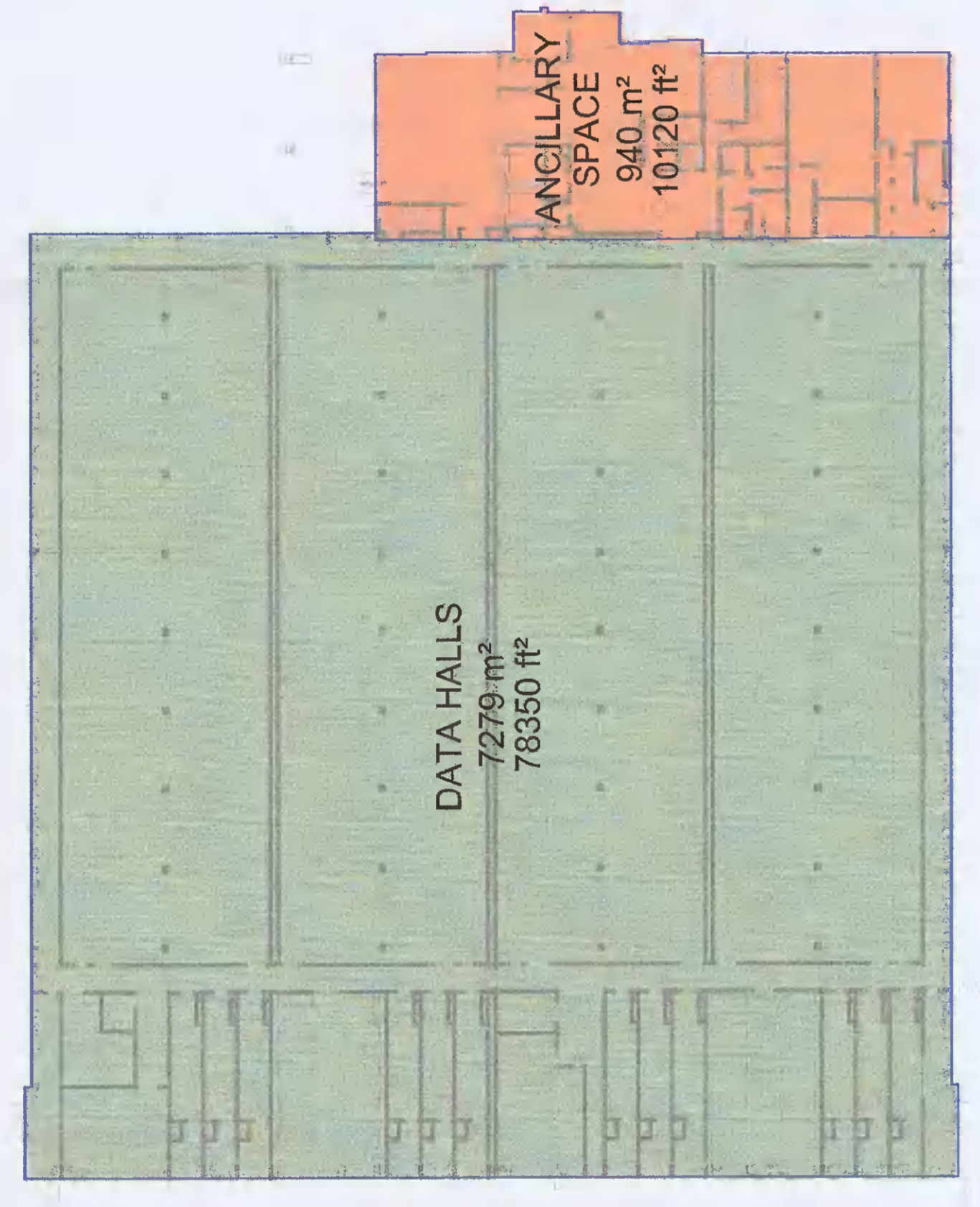
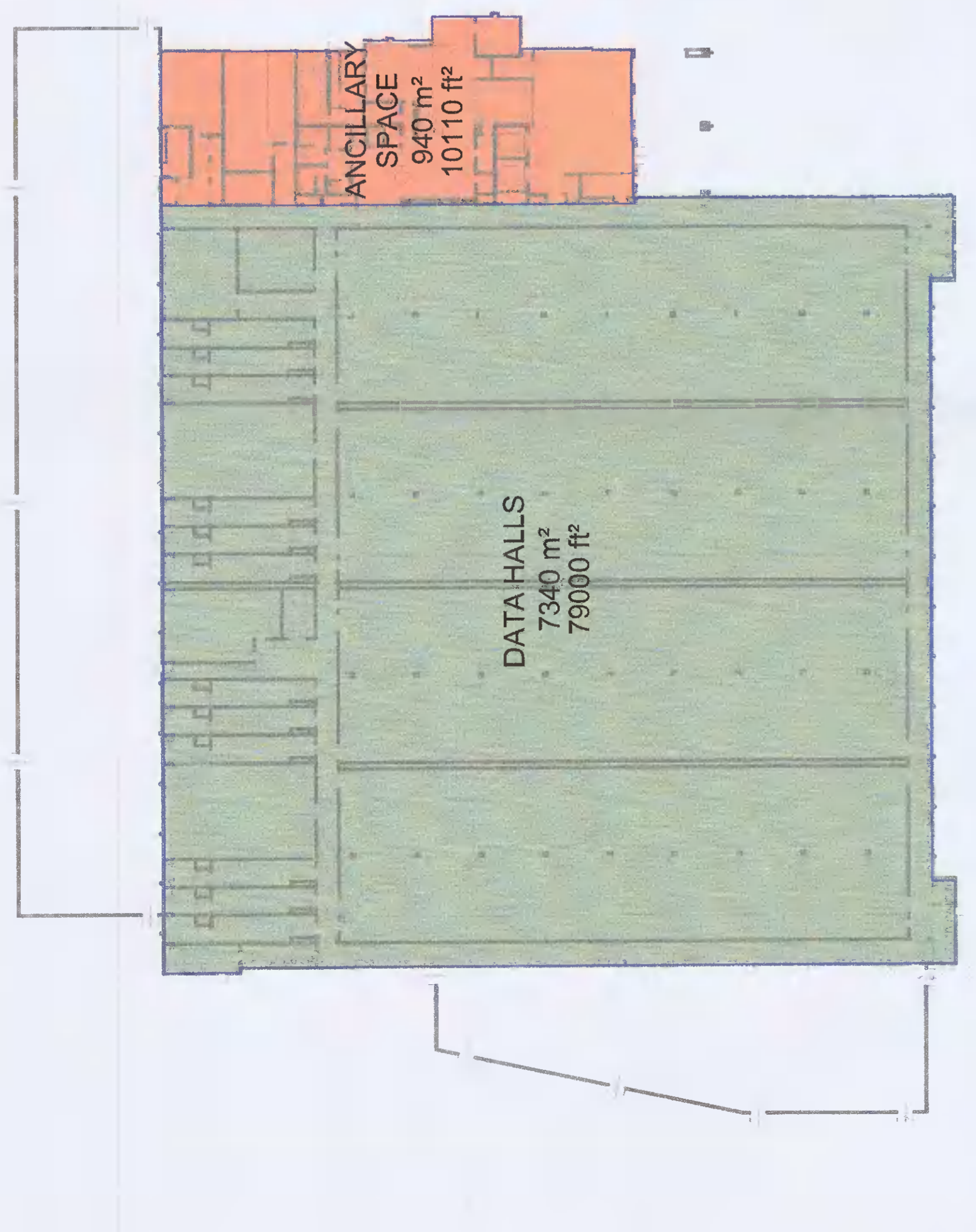

EC PLAN LEGEND

- HEAT RECOVERY BUILDING
- MV SWITCHROOMS
- LV & CONTROL CONTAINER
- TRANSFORMERS
- HV CONTAINERS

PLANNING

PROJECT: INOX DUB 15 & DUB16
ADDRESS: Profile Park, Nangor Road, Nangor, Dublin 15
CLIENT: CROSS FLOOR AREA PLANS

DATE: 02.07.2021
DRAWN: JAS
CHECKED: JAS
SCALE: 1:500

PROJECT NO: 202005
JOB NO: 202005
JOB NAME: INOX DUB 15 & DUB16
JOB DATE: 02.07.2021
JOB TIME: 10:00

RSKD
RISK MANAGEMENT
CONSULTANTS
100, 101, 102, 103, 104, 105, 106, 107, 108, 109, 110, 111, 112, 113, 114, 115, 116, 117, 118, 119, 120, 121, 122, 123, 124, 125, 126, 127, 128, 129, 130, 131, 132, 133, 134, 135, 136, 137, 138, 139, 140, 141, 142, 143, 144, 145, 146, 147, 148, 149, 150, 151, 152, 153, 154, 155, 156, 157, 158, 159, 160, 161, 162, 163, 164, 165, 166, 167, 168, 169, 170, 171, 172, 173, 174, 175, 176, 177, 178, 179, 180, 181, 182, 183, 184, 185, 186, 187, 188, 189, 190, 191, 192, 193, 194, 195, 196, 197, 198, 199, 200

8 00000 SITE - GIA
06920 1 1:1000

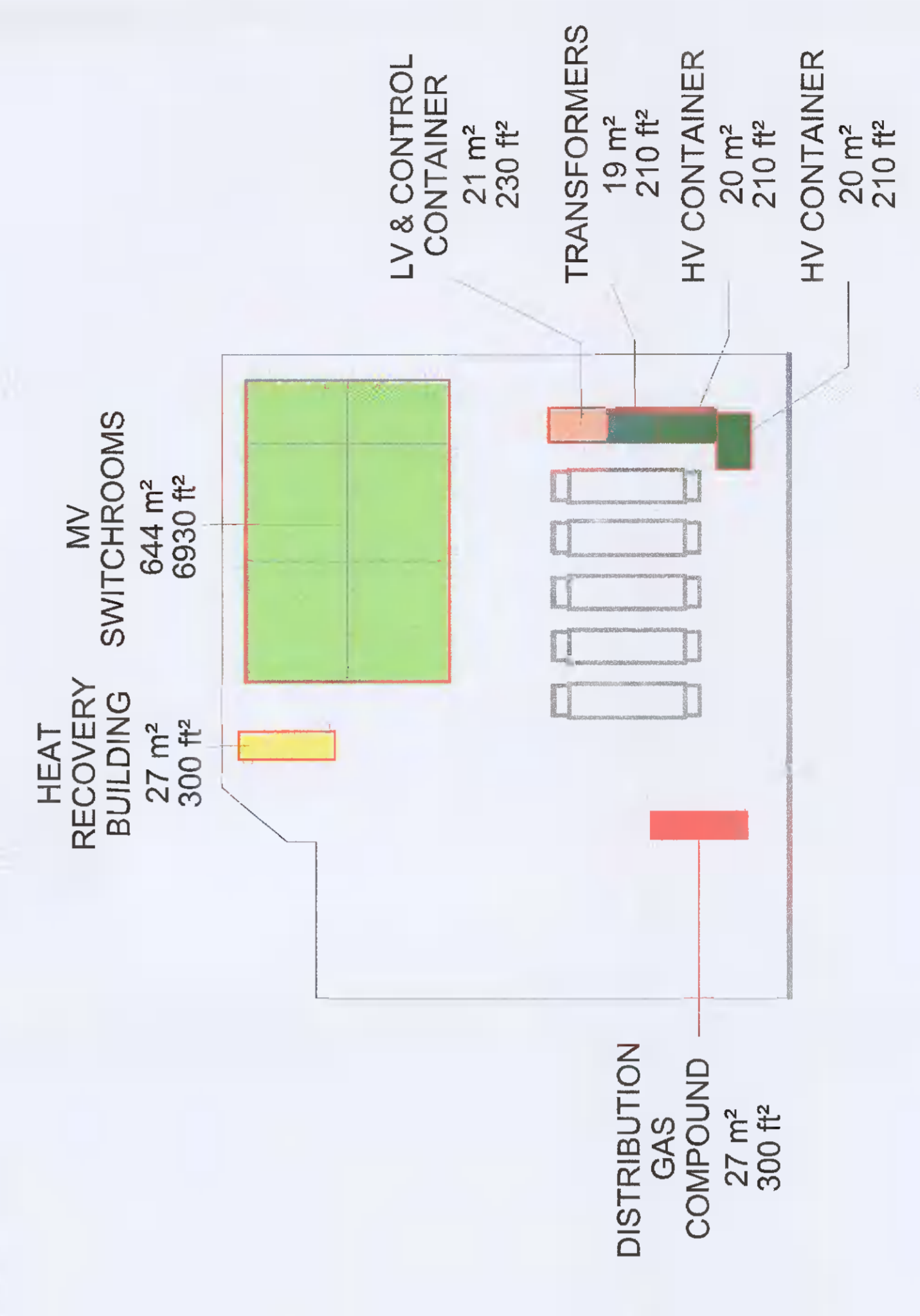

7 00000 ENERGY CENTRE LEVEL 00 - GIA
06920 8 1:500