

General Notes

All levels indicated are approximate relative levels and do not relate to Ordnance Datum unless stated. All levels must be checked on site.

All dimensions to be checked on site and the Architect notified of any discrepancies.

All works to be carried out in accordance with the current Building Regulations and with the requirements of the relevant Local Authority.

Structural openings, structural columns and beams to Engineers details.

Do NOT scale from drawing.

- Legend**
-  Fill denotes proposed structure
 -  Fill denotes existing structure
 -  Fill denotes the extent of alterations

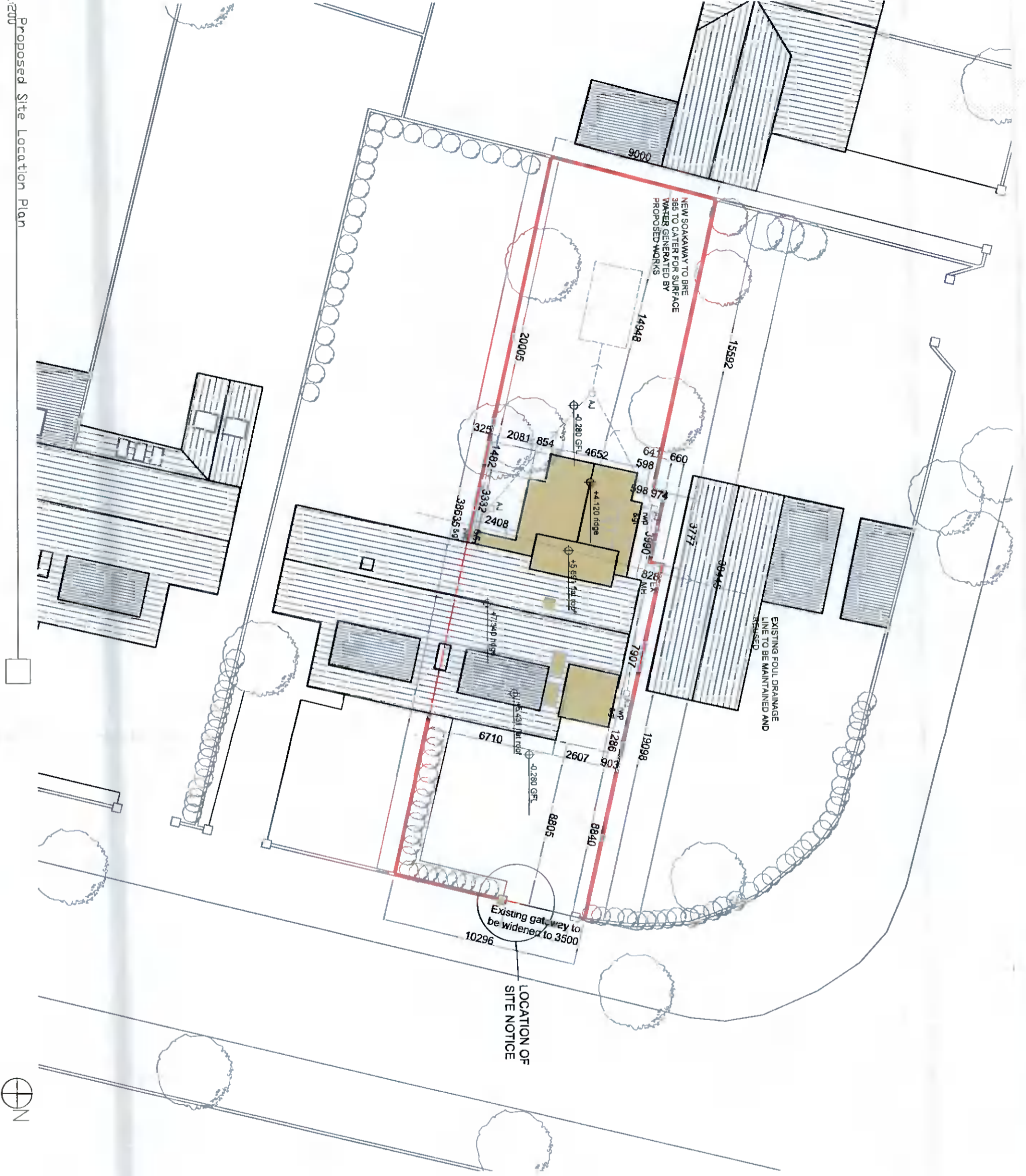

1:200 Proposed Site Location Plan



<p>BRENDAN BALFE ARCHITECTS</p> <p>Nugent Road, Churchtown, Dublin 14 t: 01 - 2982221 m: 086 - 8371066 brendanbalfearchitects@gmail.com www.brendanbalfearchitects.com</p>	
<p>Aoife and Colin Stoddart</p> <p>Project Address: 9 Orchardstown Villas, Rathfarnham, Dublin 14</p>	
<p>Planning Application Drawing</p>	
<p>Proposed Site Location Plan</p>	
<p>Date 30/06/2021</p>	<p>Drawing Number PP-05</p>
<p>Scale 1:200</p>	<p>Drawn By BB</p>