

General Notes:
 1. This is not an installation drawing and shows only the general arrangement of equipment. All dimensions are in millimetres (mm) unless noted otherwise. All levels are in metres (m) unless noted otherwise.
 2. Do not scale. Work to figured dimensions only.
 3. The drawings are based on the information provided in the building services documents and other relevant contract documents.
 4. Equipment selected shall be as specified in the given constraints and long lead equipment will be ordered as soon as possible.
 5. All services crossing the movement joints shall be installed to accommodate the movements as indicated on the drawings.
 6. All services crossing the movement joints shall be installed to accommodate the movements as indicated on the drawings.
 7. Installation drawings shall be submitted for approval.
 8. To handover for approval.

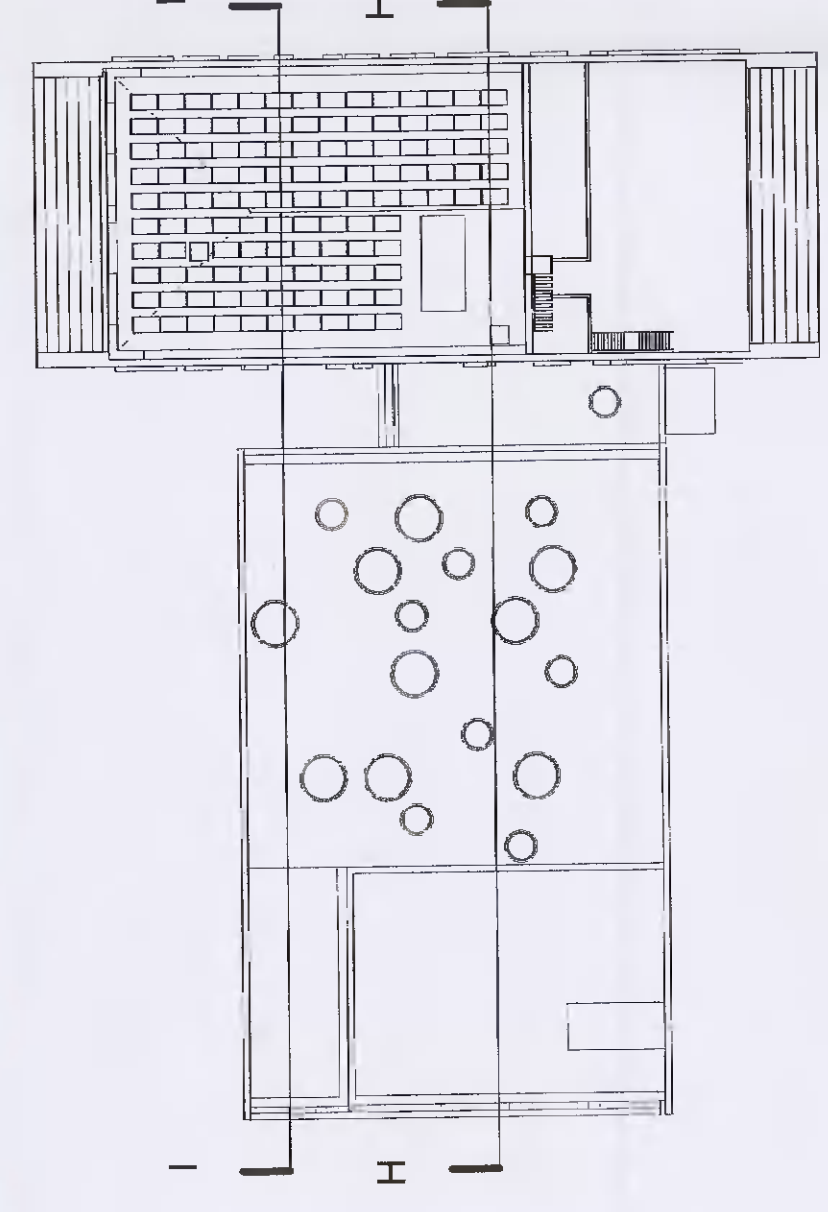

3 KEYPLAN
 1:500

