

APPENDIX I

LETTERS OF CONSENT

- 1 Letter & map in relation to lands in the ownership of the Council in a planning application to meet ongoing demands in the datacentre and cloud computing sector at Grange Castle Business Park.
- 2 Letter & map in relation lands in Council ownership in a planning application in respect to river landscape, maintenance & construction of a new access bridge in the Grange Castle Business Park.
- 3 Letter & map in relation to lands in the ownership of the Council in a planning application to provide temporary carpark to facilitate future development of Microsoft Operations Ireland Limited at Grange castle Business Park.

- I Letter & map in relation to lands in the ownership of the Council in a planning application to meet ongoing demands in the datacentre and cloud computing sector at Grange Castle Business Park.



Connecting You to

Economic, Enterprise & Tourism
Development Department

Ms Vicky Landy
Director
RKD Architects Ltd
59 Northumberland Rd
Ballsbridge
Dublin 4

Our Ref: GC 232

Date: 20 Oct 20

**WITHOUT PREJUDICE
SUBJECT TO CONTRACT/CONTRACT DENIED**

Proposed Grant of Consent to Microsoft Operations Ireland Limited to include lands in the ownership of the Council in a planning application to meet ongoing demands in the datacentre and cloud computing sector at Grange Castle Business Park

Dear Vicky

I refer to your request, on behalf of your client, Microsoft Operations Ireland Limited, for the consent of the Council to lodge a planning application in respect of lands named above.

I recommend that a Letter of Consent be issued to RKD Architects Ltd., to allow them to include lands outlined in red on attached Drawing No. 02_028D_9160 in a proposed application for the purposes outlined above.

Please note that this consent does not convey to RKD Architects Ltd., or their client, Microsoft Operations Ireland Limited, any interest whatsoever in the subject lands and is for the sole purpose of allowing a planning application to be made.

This consent is valid for a period of twelve months from date of this letter.

The consent is conditional on no development taking place until full planning permission has been granted and the Council is in a position to enter into an appropriate agreement with Microsoft Operations Ireland Limited, in respect of the lands.

Yours sincerely

Amanda Martin
Senior Staff Officer

Encl

- 2** Letter & map in relation lands in Council ownership in a planning application in respect to river landscape, maintenance & construction of a new access bridge in the Grange Castle Business Park.

Economic, Enterprise & Tourism Development Department

Ms. Vicky Landy,
RKD Architects Ltd.,
59 Northumberland Rd,
Ballsbridge,
Dublin 4.

Date: 16th October 2020

**WITHOUT PREJUDICE
SUBJECT TO CONTRACT/CONTRACT DENIED**

Proposed Grant of Consent to RKD Architects Ltd. on behalf of their client, Microsoft Ireland Operations Limited, to include lands in Council ownership in a planning application in respect to river landscape, maintenance & construction of a new access bridge in the Grange Castle Business Park.

Dear Vicky,

I refer to your request to include lands in Council ownership in a proposed planning application, in respect of lands named above.

I now wish to confirm that South Dublin County Council hereby grants its consent to include lands in the ownership/and or control of the Council in a planning application to carry out river landscape, maintenance & construction of a new access bridge to facilitate the provision of data centre and office building at Grange Castle Business Park. The subject lands are within the area in red, on attached Indicative Drawing No. A 1010.

The consent is conditional on no development taking place until full planning permission has been received and the Council is in a position to enter into an appropriate agreement with the Applicant in respect of the lands.

The consent does not convey to RKD Architects or their client, Microsoft Ireland Operations Limited, any interest whatsoever in the lands and is for the sole purpose of allowing a planning application to be made.

Yours sincerely,

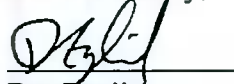

Des English,
Administrative Officer,
Economic, Enterprise & Tourism Development Department.South Dublin County
Council

denglish@sdublincoco.ie

Encls

All dimensions to be checked on site. Figured dimensions take preference over scaled dimensions. Any errors or discrepancies to be reported to the Architects. This drawing may not be edited or modified by the recipient.

A3

Copyright and ownership of this drawing is vested in RKD Architects. Where prior written consent is required for its use, reproduction or for publication to any third party. All rights reserved by the law of copyright and by international copyright conventions are reserved to RKD Architects and may be protected by court proceedings for damages and/or injunctions and costs. RKD Architects' Quality Management Systems are independently certified to ISO 9001:2015.

Notes

REV	DATE	CHK BY	DESCRIPTION
B	07/10/20	VL	HATCHED AREA EXPANDED
A	30/09/20	VL	BRIDGE LOCATION INCLUDED

LEGAL

STATUS
LEGAL

PROJECT
 DUB 14_15
 DATA CENTRES & ADMIN

PROJECT ADDRESS
 MS CAMPUS,
 GRANGE CASTLE

DWG TITLE
 SITE PLAN FOR SDCC
 CONSENT TO DEVELOP

DWG NO
 L-001

REV	PROJECT NO	SCALE
B	19244	1:2,500@A3

DATE	DWN	VL	CHK
02/07/20			

RKD

59 Northumberland Rd
 Ballsbridge Dublin 4
 D04 W9P99, Ireland

+353 1 668 1055
 mail@rkd.ie
 rkd.ie

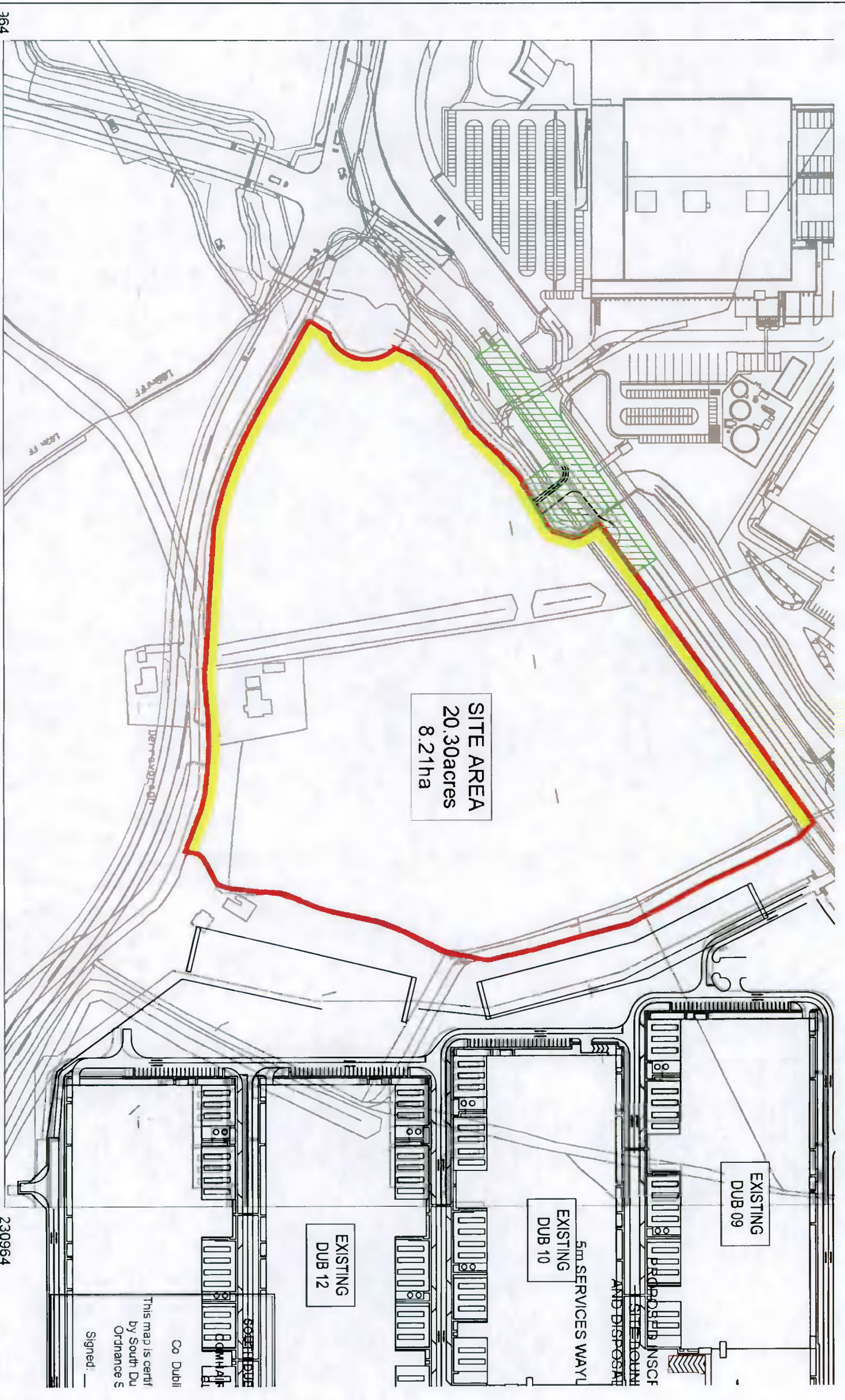

O.S SHEET Ref: 3325-B;

SDCC LANDS WHERE CONSENT IS SOUGHT BY MICROSOFT FOR CONSTRUCTION & FUTURE MAINTENANCE OF NEW ACCESS BRIDGE & ASSOCIATED ROADWORKS TO BE DEVELOPED AS PART OF PROPOSED DEVELOPMENT



364
 302821

303502
 230964

Co Dublin
 This map is certified by South Du Ordnance S
 Signed: _____