

ATTIC FLOOR PLAN (Unit 11: 25.30m², Unit 10: 31.10m²)

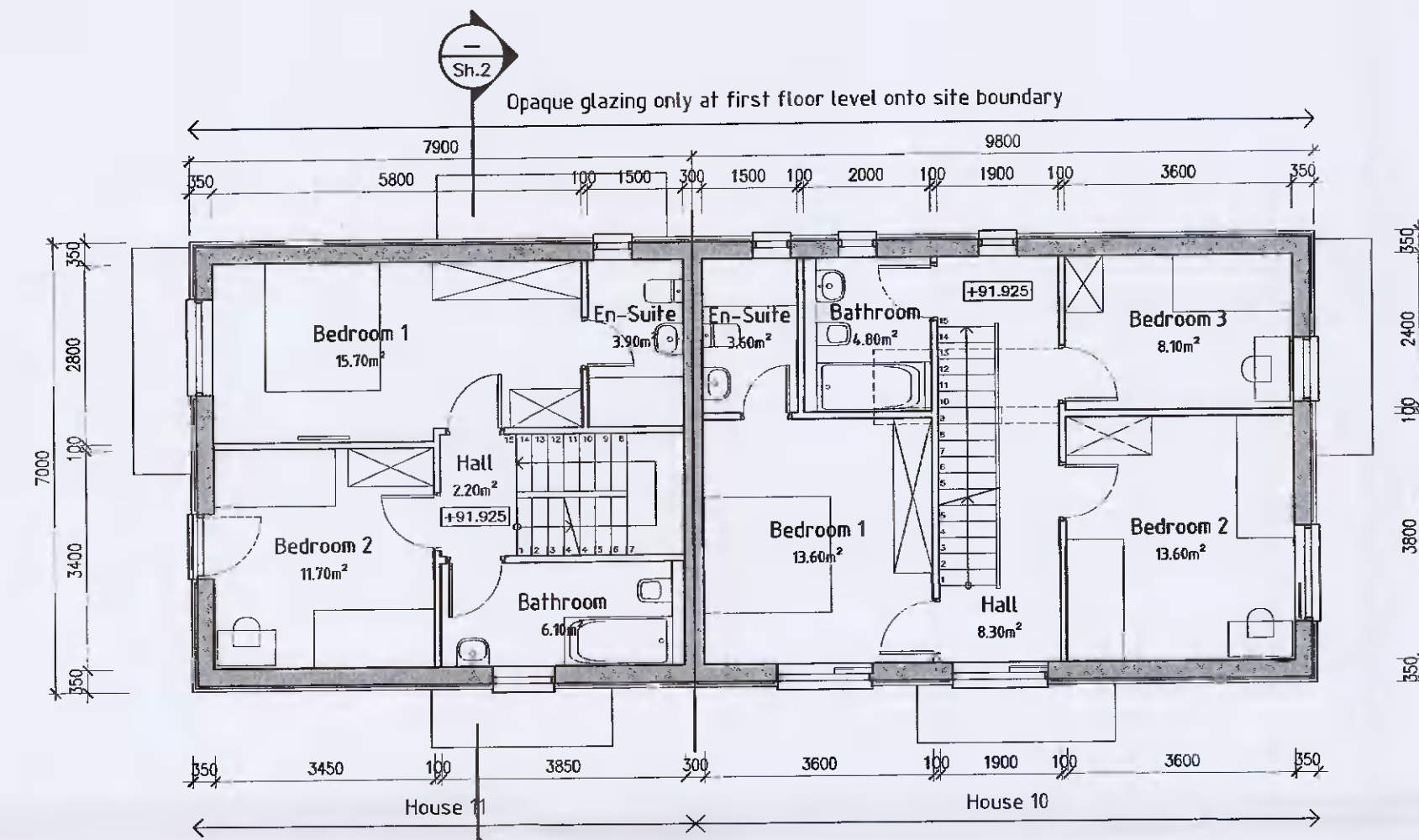

FIRST FLOOR PLAN (Unit 11: 46.60m², Unit 10: 58.60m²)

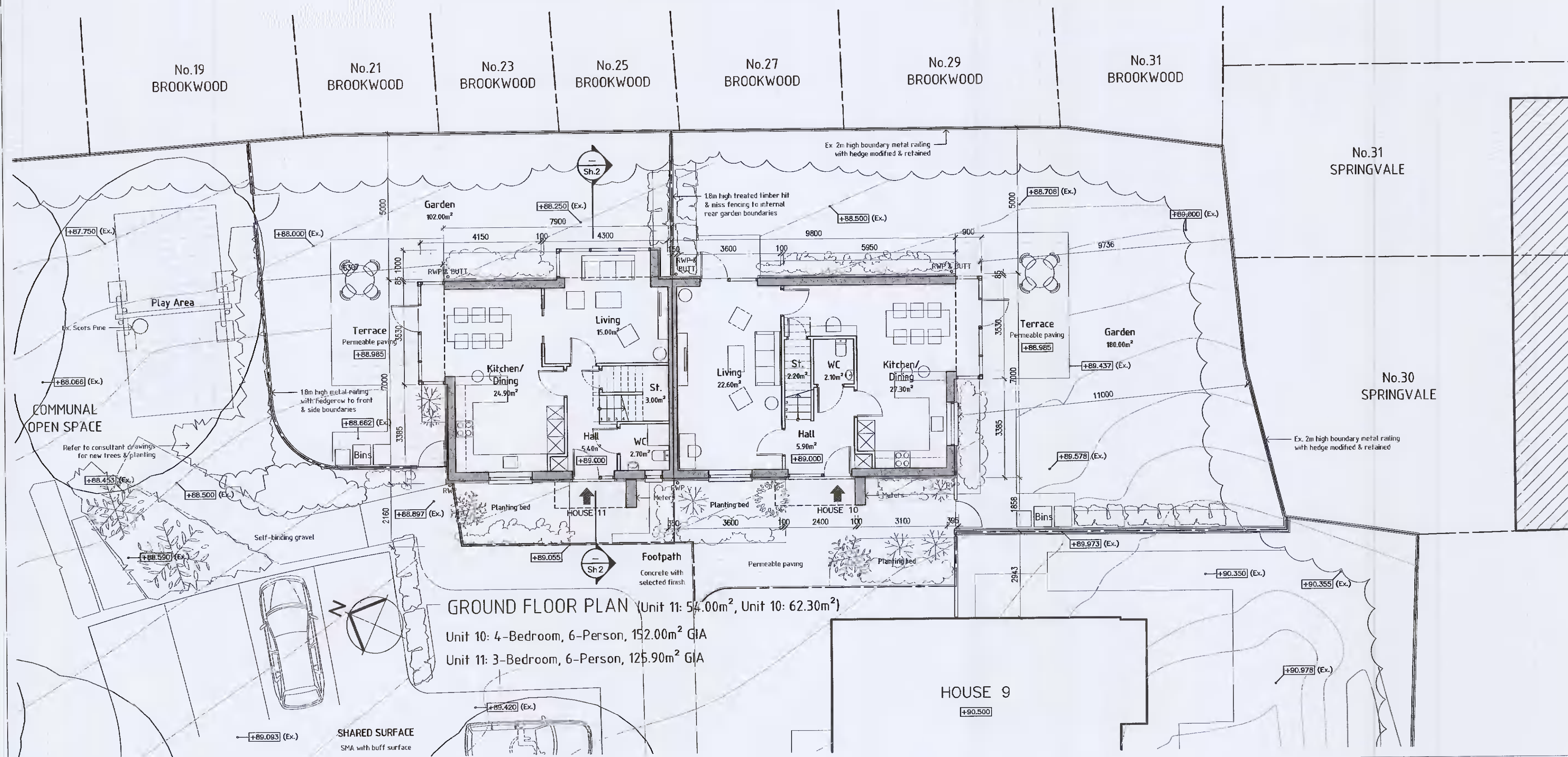

GROUND FLOOR PLAN (Unit 11: 54.00m², Unit 10: 62.30m²)

Unit 10: 4-Bedroom, 6-Person, 152.00m² GIA
 Unit 11: 3-Bedroom, 6-Person, 125.90m² GIA

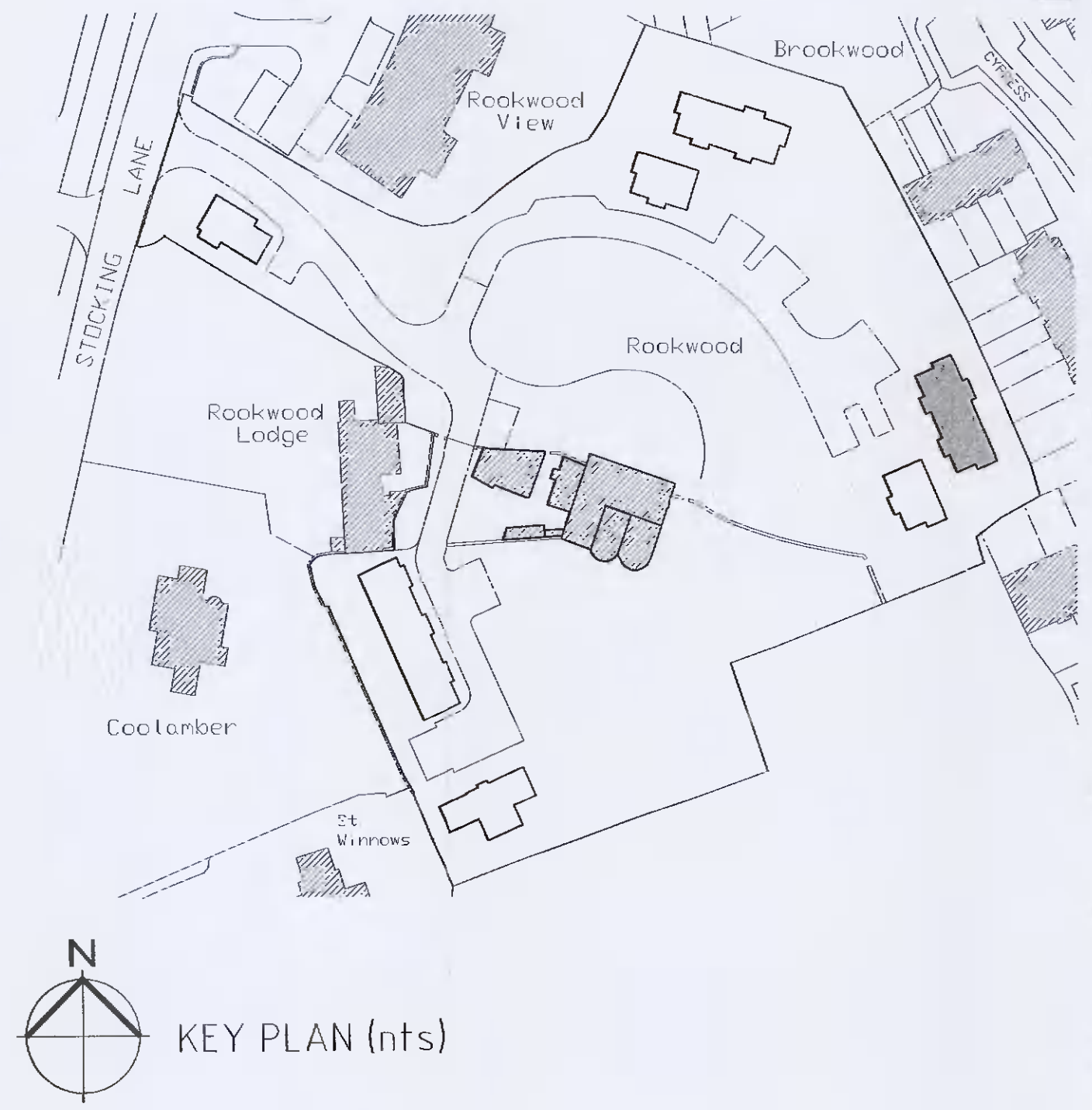

KEY PLAN (nts)

- NOTES:
1. This drawing is copyright and may only be reproduced with the architect's permission.
 2. Do not scale.
 3. Only written dimensions.
 4. Drawings to be read in conjunction with civil/structural engineer, landscape architect and other consultant drawings, details and specifications.

Rev.	Date:	Dn.	Details
------	-------	-----	---------

DRAWING PLOTTED ON:

Client:
 BRENDA WEIR

Fionnuala Rogerson Architects
 Ardona House Lower Churchtown Rd. Dublin 14
 Telephone: (01) 2984261
 E-mail: info@rogerson.ie



Project Title:
 Proposed Residential Development at Rookwood, Stocking Lane, Ballyboden, Dublin 16, D16 NSP3

Drawing Title:
 General Arrangement House Nos.10&11 (Woodland Houses) Ground, First & Attic Floor Plans

Drawing Status:
 PLANNING APPLICATION

Scales:
 1:100 @ A1

Date	Approved by:	Dn.	NC
June 2021			
Project No.	Drawing No.	Ch:	Rev.
1833	PA-014(1)		