

ATTIC FLOOR PLAN (31.10m²)

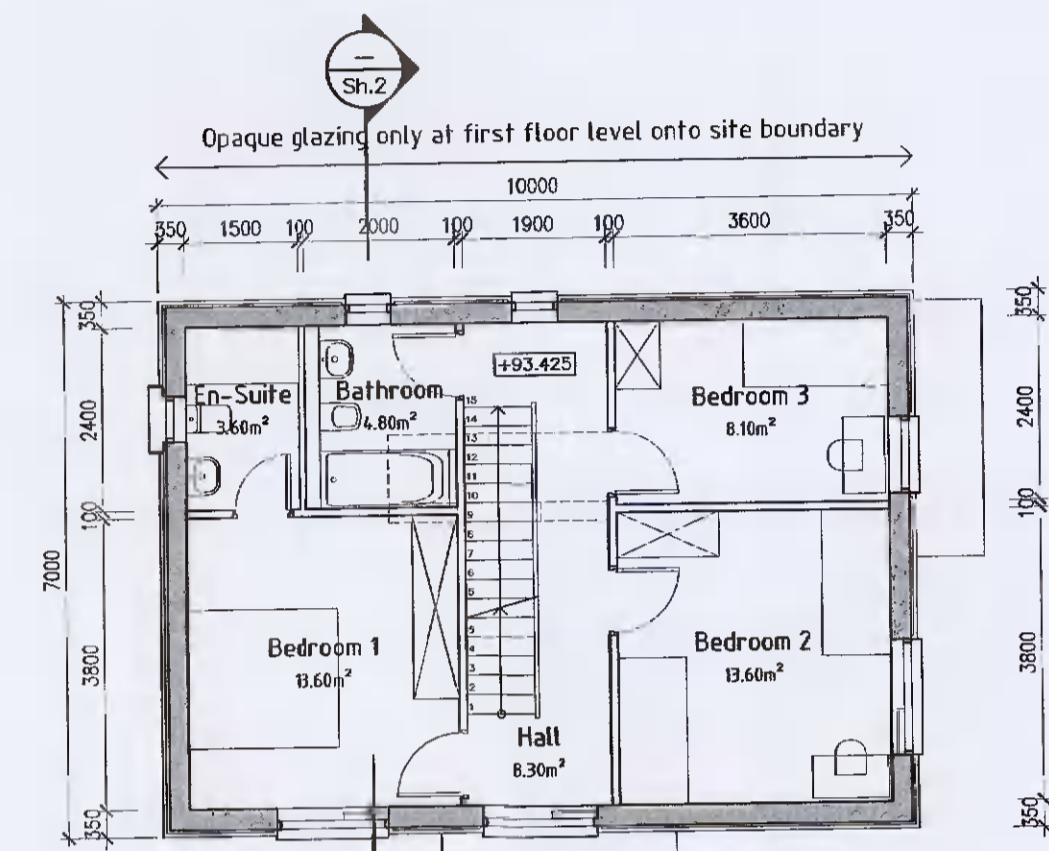

FIRST FLOOR PLAN (58.60m²)

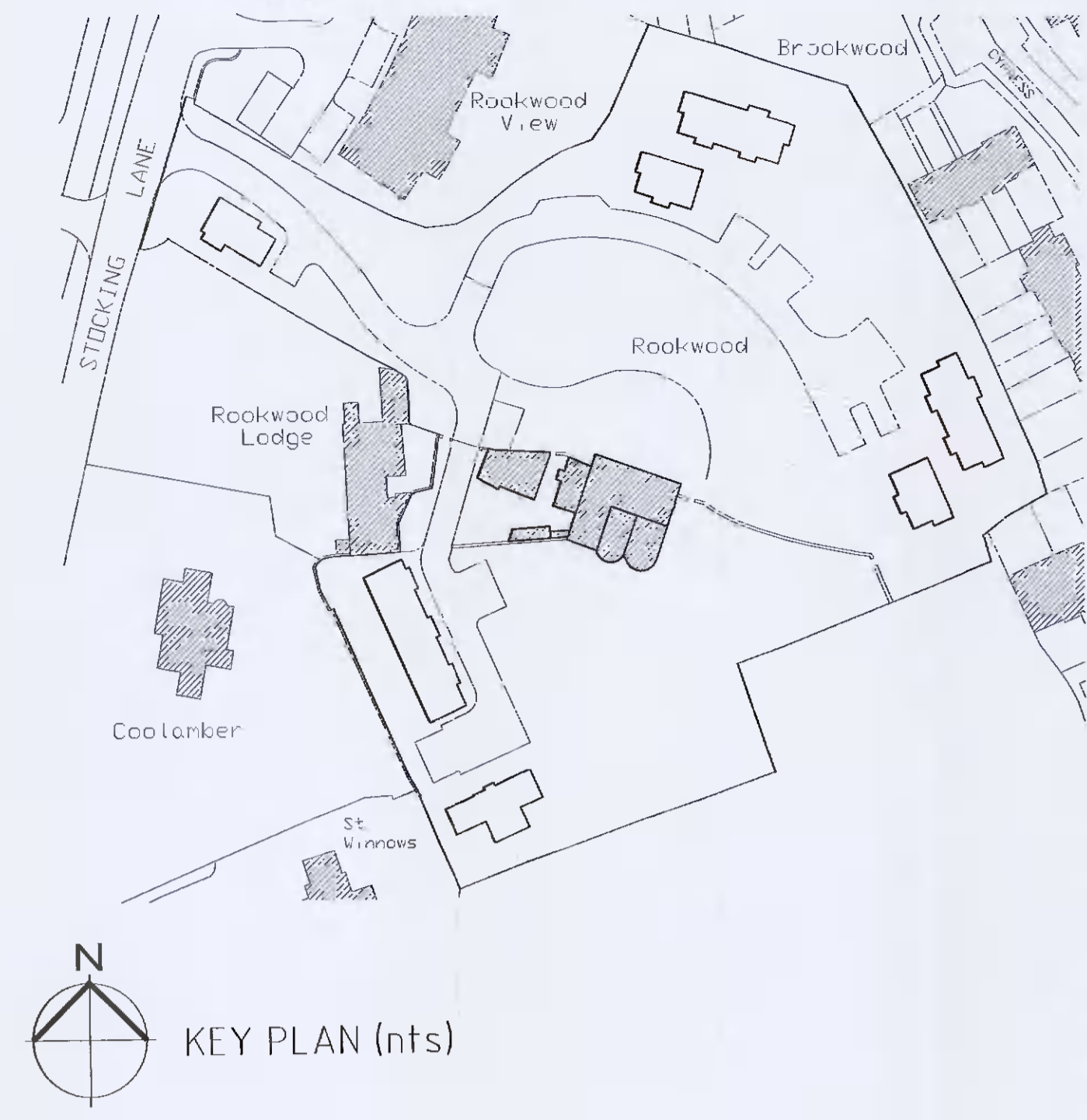

KEY PLAN (nts)

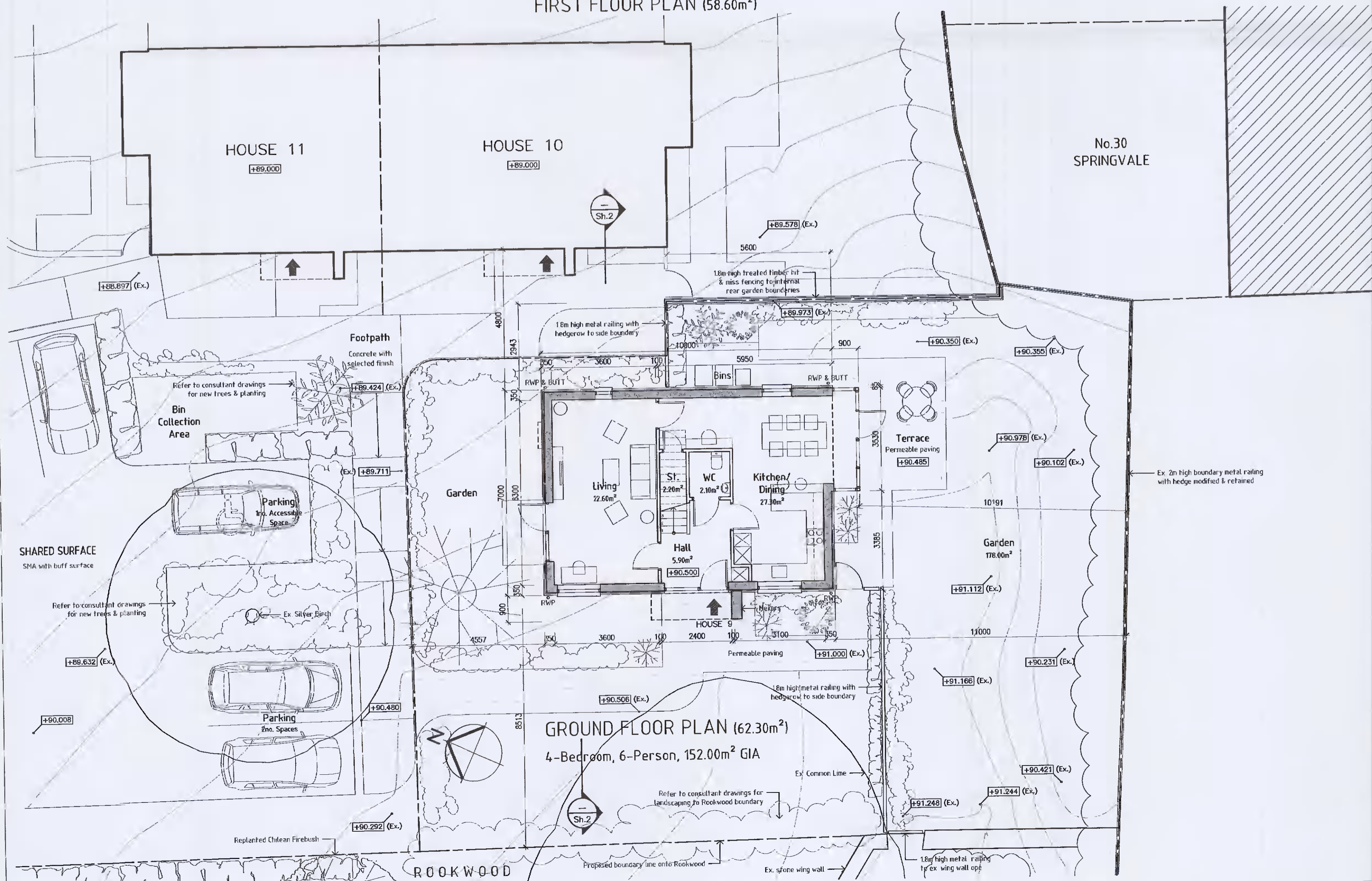

GROUND FLOOR PLAN (62.30m²)

4-Bedroom, 6-Person, 152.00m² GIA

- NOTES:
1. This drawing is copyright and may only be reproduced with the architect's permission.
 2. Do not scale.
 3. Only written dimensions.
 4. Drawings to be read in conjunction with civil/structural engineer, landscape architect and other consultant drawings, details and specifications.

Rev.	Date	Dn.	Details

DRAWING PLOTTED ON:

Client:
BRENDA WEIR

Fionnuala Rogerson Architects
Ardara House Lower Churchtown Rd. Dublin 14
Telephone: (01) 2984261
E-mail: info@rogerson.ie



Project Title:
Proposed Residential Development at Rookwood, Stocking Lane, Ballyboden, Dublin 16, D16 N5P3

Drawing Title:
General Arrangement House No.9 (Woodland House) Ground, First & Attic Floor Plans

Drawing Status:
PLANNING APPLICATION

Scales:
1:100 @ A1

Date	Approved by:	Dn.	NG
June 2021			

Project No.	Drawing No.	Ch:	Rev.
1833	PA-013(1)		