

ATTIC FLOOR PLAN (Unit 7: 31.10m², Unit 8: 25.30m²)

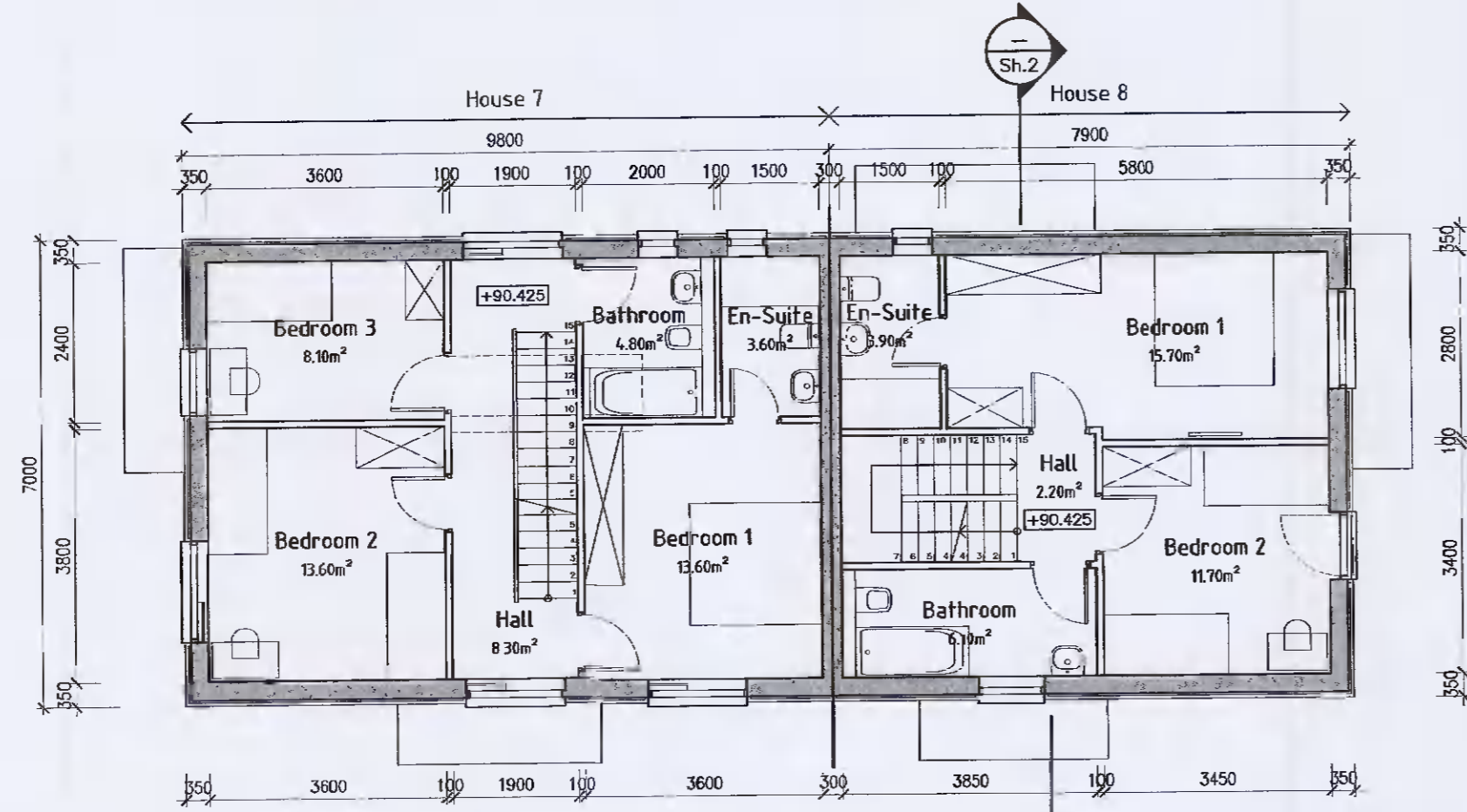

FIRST FLOOR PLAN (Unit 7: 58.60m², Unit 8: 46.60m²)

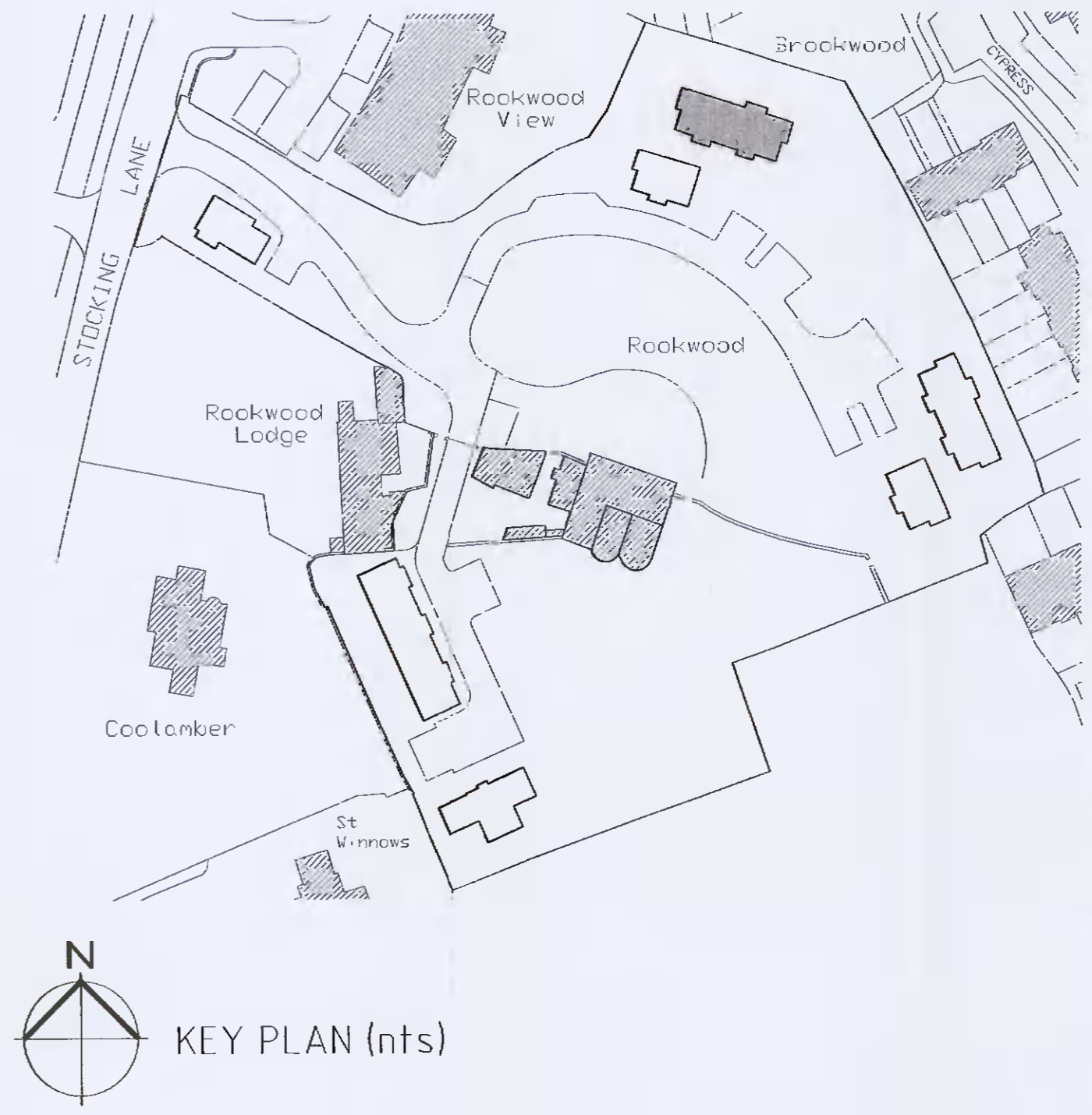

KEY PLAN (nts)

- NOTES:
1. This drawing is copyright and may only be reproduced with the architect's permission.
 2. Do not scale.
 3. Only written dimensions.
 4. Drawings to be read in conjunction with civil/structural engineer, landscape architect and other consultant drawings, details and specifications.

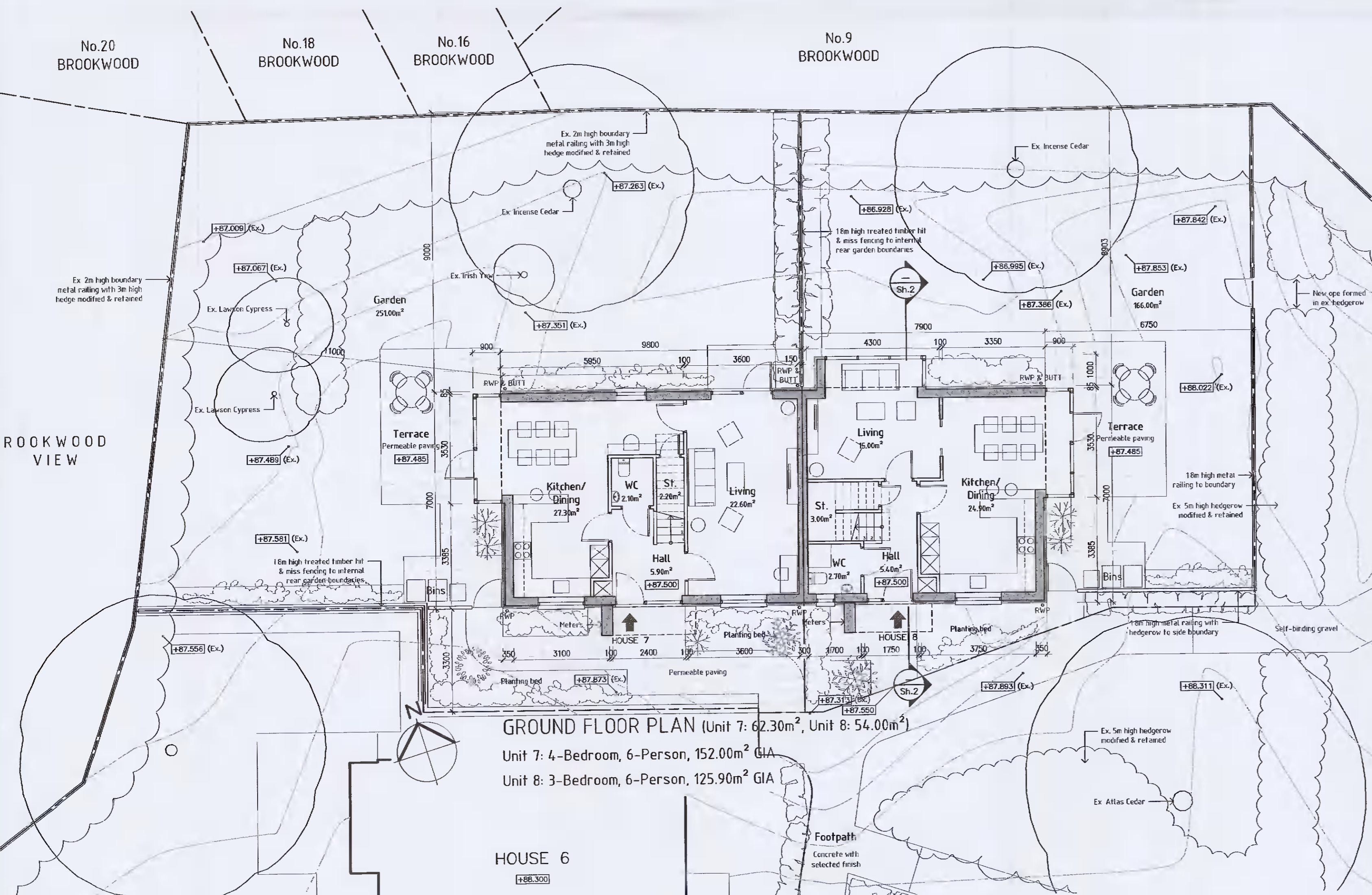

GROUND FLOOR PLAN (Unit 7: 62.30m², Unit 8: 54.00m²)

Unit 7: 4-Bedroom, 6-Person, 152.00m² GIA
 Unit 8: 3-Bedroom, 6-Person, 125.90m² GIA

Rev.	Date:	Dn.	Details
------	-------	-----	---------

DRAWING PLOTTED ON:
 Client:
BRENDA WEIR

Fionnuala Rogerson Architects
 Ardara House Lower Churchtown Rd. Dublin 14
 Telephone: (01) 2984261
 E-mail: info@rogerson.ie



Project Title:
Proposed Residential Development at Rookwood, Stocking Lane, Ballyboden, Dublin 16, D16 N5P3

Drawing Title:
General Arrangement House Nos.7&8 (Woodland Houses) Ground, First & Attic Floor Plans

Drawing Status:
PLANNING APPLICATION

Scales:
1:100 @ A1

Date	June 2021	Approved by:	Dn.	NC
Project No.	1833	Drawing No.	PA-012(1)	Rev.