

FIRST FLOOR PLAN (44.00m²)

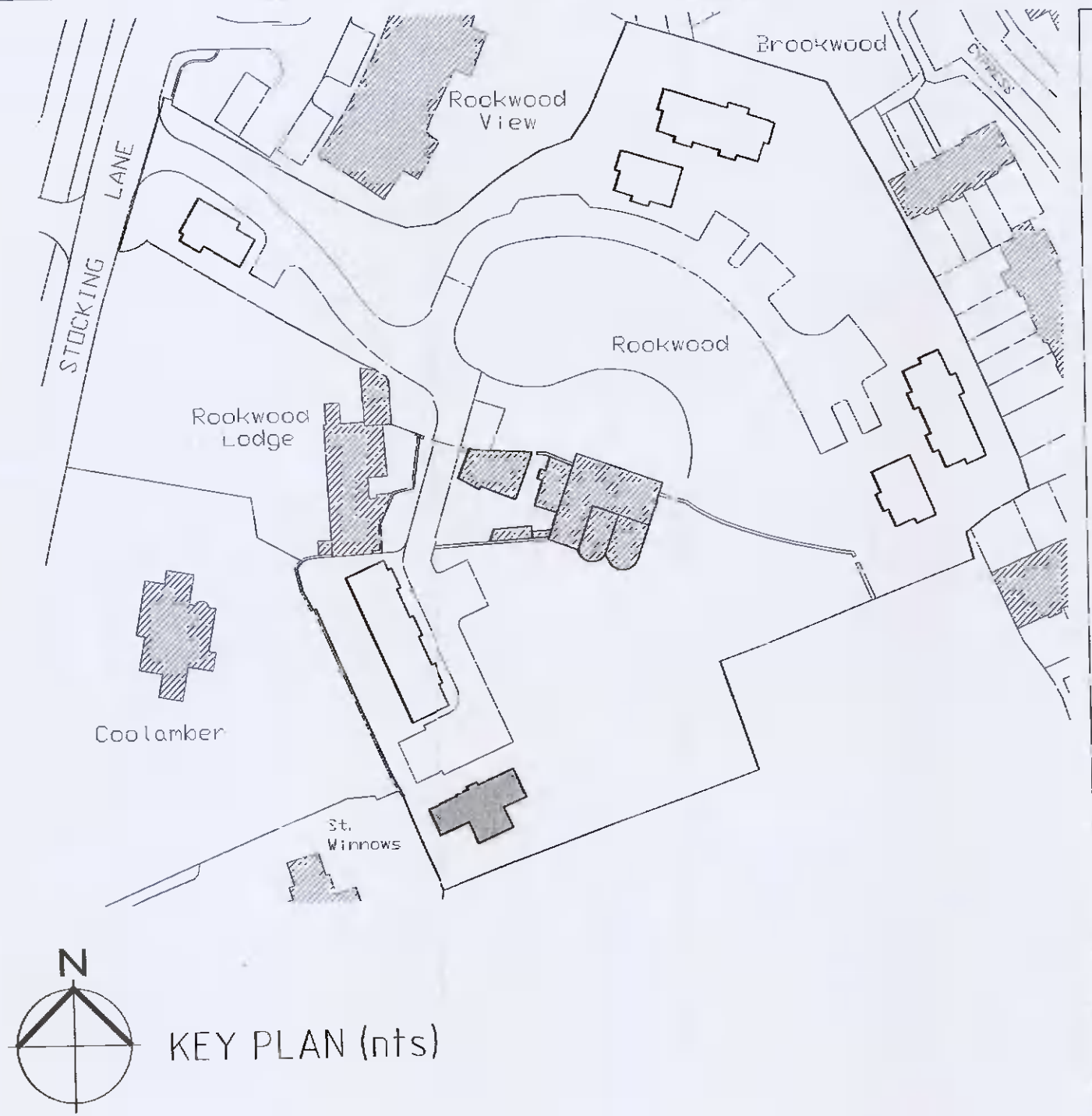

- NOTES:
1. This drawing is copyright and may only be reproduced with the architect's permission.
 2. Do not scale.
 3. Only written dimensions.
 4. Drawings to be read in conjunction with civil/structural engineer, landscape architect and other consultant drawings, details and specifications.

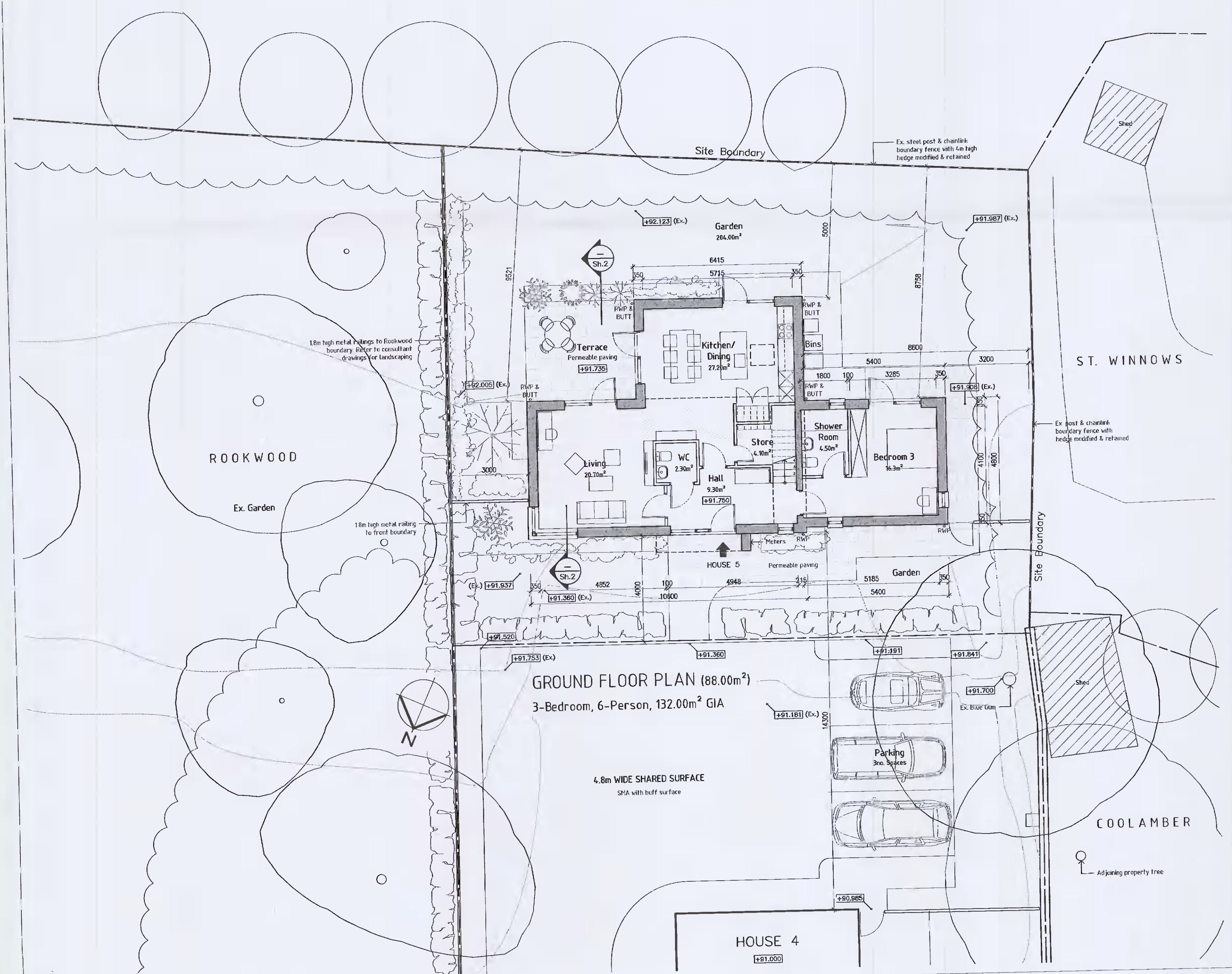

Rev.	Date	Dr.	Details
------	------	-----	---------

DRAWING PLOTTED ON:

Client:
BRENDA WEIR

Fionnuala Rogerson Architects
Ardona House Lower Churchtown Rd. Dublin 14
Telephone: (01) 2984261
E-mail: info@rogerson.ie

Project Title:
Proposed Residential Development at Rookwood, Stocking Lane, Ballyboden, Dublin 16, D16 N5P3

Drawing Title:
General Arrangement House No.5 (Mews House) Ground & First Floor Plans

Drawing Status:
PLANNING APPLICATION

Scales:
1:100 @ A1

Date June 2021	Approved by:	Dr.	NG
Project No. 1833	Drawing No. PA-010(1)	Ch:	Re: