

**General Notes:**

1. This drawing is to be read in conjunction with all relevant architects drawings, indicative survey drawings and mechanical & electrical specifications & schedules.
2. Electrical services to be co-ordinated with all other trades, and to be agreed on site prior to installation.
3. The containment installation shall be surface mounted galvanised trunking, tray, ladder and conduit as required.
4. All cabling shall be mechanically protected using this method from point to point with no breaks. Note requisite conduit runs are not noted on the drawing.
5. The contractor shall note that conduits are not shown.
6. The contractor shall include for supply, planning and co-ordination of the conduit installation.
7. Tray & trunking droppers headers & risers are not shown. The contractor shall include for all tray & trunking drops.
8. Main cable containment routes only, are shown. The contractor shall include for all additional branch (secondary) cable containment as necessary to complete the installation.
9. Access hatches to be provided every 6m in plasterboard ceilings and areas where removable ceilings are not present.
10. Final position of all mechanical equipment to be agreed with mechanical specialist prior to installation of cable containment.
11. Where systems & power cables cross over, they shall do so within cable trays/ baskets/ ladders and they shall at no point come in contact with each other.
12. A minimum of 150mm height shall be maintained between horizontal containment routes where they cross over.
13. All containment cut shall be sprayed with galvanised paint.
14. All containment unistrut supports shall be capped and fixed using unistrut bracketry, nuts and washers.
15. Containment shall be supported at a minimum of 1200mm centers on the horizontal and vertical planes.
16. All containment bends shall be factory manufactured. No homemade bends will be accepted.
17. LV trunking shall be installed with the lidding at the top or side, contractor to ensure sufficient space is provided to allow closing of lid fasteners.
18. All containment runs shall be connected to the earth network as indicated on the earthing schematic every 15-20m.
19. All cable entries from external shall be fully weather sealed with sealable cable entry devices (as roxtac transit sealing systems or equal and approved).
20. The complete installation shall satisfy ET101:2008, all relevant standards, contract drawings and specification requirements.

**Symbols Reference:**

TELECOM	Telecom Line
EIRCOM	Eircom Line
VIRGIN	Virgin Media Line
FO	Fibre Optic
CCTV	CCTV Routing
PUB LTG	Public Lighting
LV	ESB LV Line
ELV	ESB ELV Line
	Unidentified GPR
	Unidentified EM
	Electrical Cable
	Ducting
ESB	ESB Cable
WM	Water Mains
☒	Draw Pit

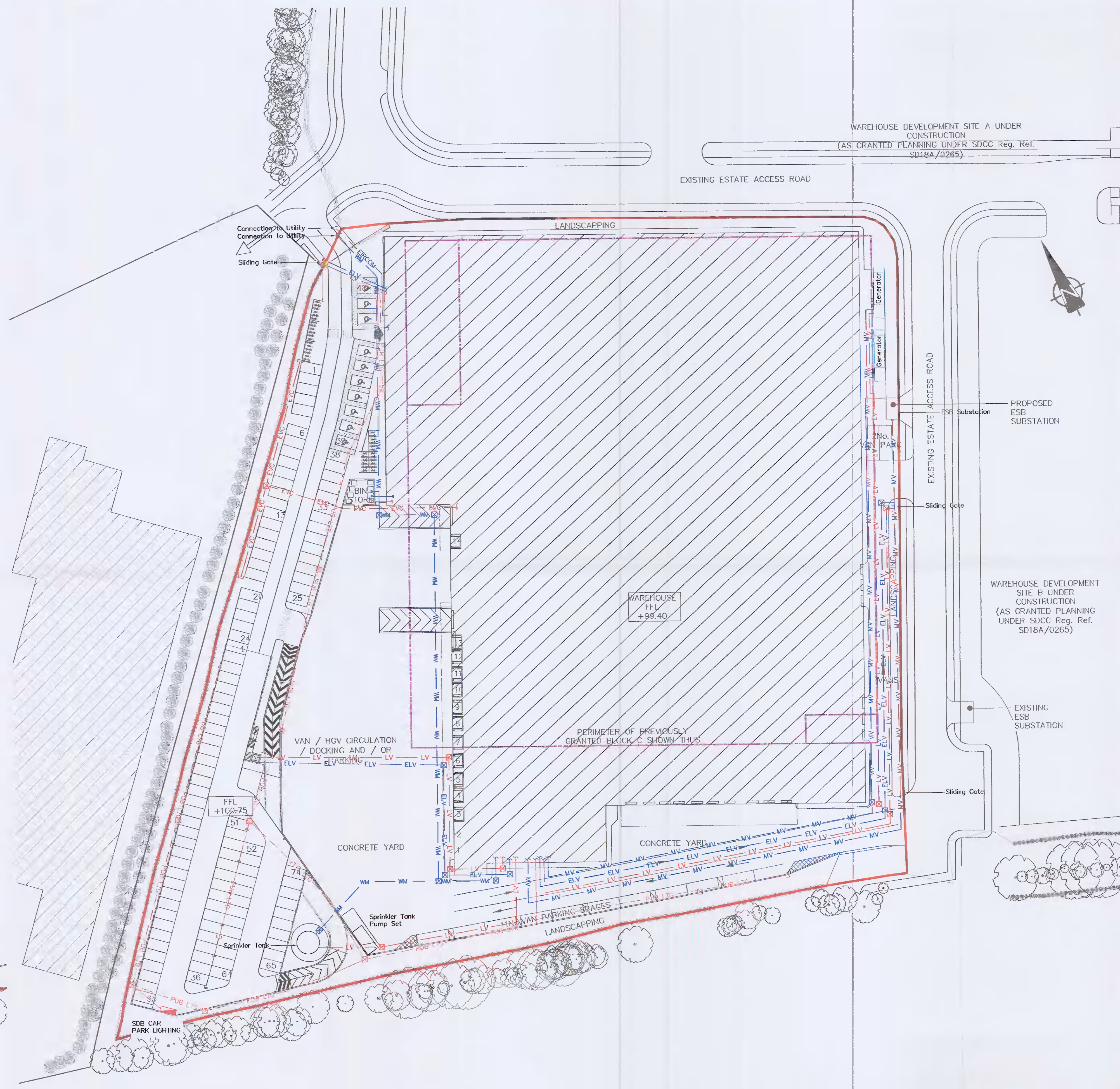

Upper Carpark Level

PO1	02.07.2021	ISSUED FOR PLANNING	KTP/D	CD
REV	DATE	AMENDMENT	DRN	CHK

**Issued for Information**

**axiseng**  
consulting engineers

Client: Jordanstown Properties Ltd  
 Architect: Jordanstown Properties Ltd  
 Project: Uniphar Warehouse Block C Mechanical & Electrical Site Services Layout  
 Drg. No: UWBC-AXE-XX-00-DR-ME-60101  
 Job No: 21025 Status: S2 Revision: P01  
 Scale: 1:500 @ A1

This drawing is the property of axiseng. Copyright is reserved by axiseng and the drawing shall not be copied, reproduced or otherwise used without the consent of axiseng.