

714309,
726497

714641,
726497

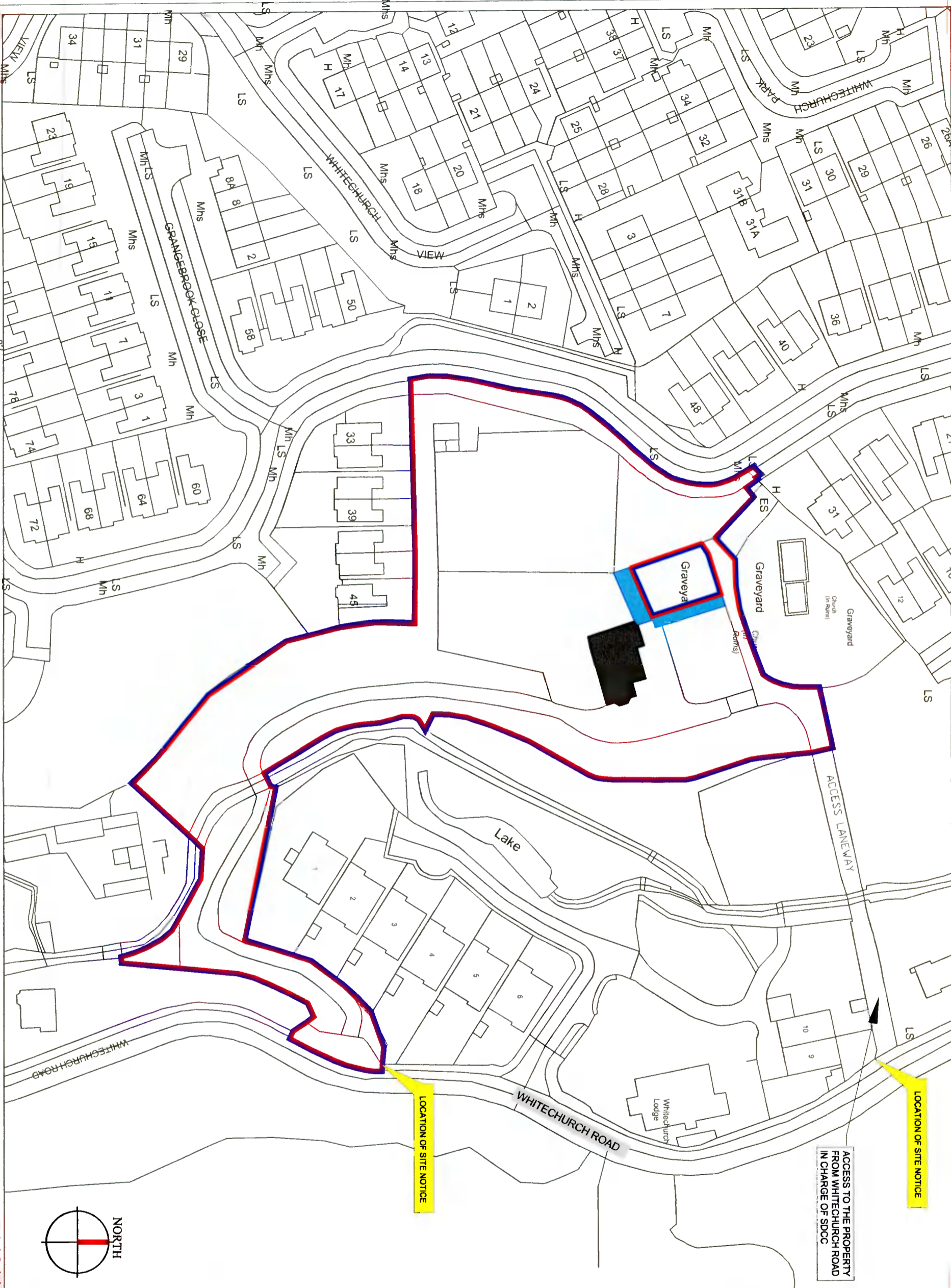

SITE AREA: c. 0.99 ha
SITE BOUNDARY - LAND IN WHICH APPLICANT HAS A LEGAL INTEREST (OUTLINED IN RED)

OWNERSHIP OF THE APPLICANT OUTLINED IN BLUE (c. 0.99 ha)

'PALMYRA' EXISTING HOUSE

EXISTING SHEDS

ACCESS TO THE PROPERTY FROM WHITECHURCH ROAD IN CHARGE OF SDCC

LOCATION OF SITE NOTICE

LOCATION OF SITE NOTICE

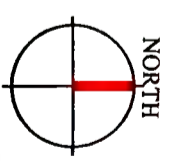

714309,
726251

714641,
726251

OS MAP REF: 3391-23, 3391-24
ITM CENTREPOINT COORDINATES
C: X,Y = 714475, 726374
SITE LOCATION PLAN & RED LINE BOUNDARIES BASED ON ORDINANCE SURVEY INFORMATION RECEIVED FROM CLIENT AND REPRODUCED UNDER OS LICENCE TERRY & O'FLANAGAN LTD. AR00108021

FOR PLANNING PURPOSES ONLY

TERRY & O'FLANAGAN LTD.
REGISTERED ARCHITECTS
Registered in Ireland No. 63303333
Tel: 01 4659491 Fax: 01 4659311 E-mail: info@t-o.com
511 Cappanagh, Summer Park, Oak Park, D11 1P9, Co. Wick

SITE LOCATION MAP
PALMYRA WHITECHURCH ROAD,
RATHFARNHAM, DUBLIN 16.
Client: ANNE JACKSON

Scale:	1:1000 (A3)	Date:	28 JUNE 2021
Project:	KP	Drawn by:	D1194-01

Contractors must verify all dimensions on site before commencing any work. No working dimensions to be scaled. Dimensions to be scaled only. The drawing and design is copyright and is the property of Terry & O'Flanagan Ltd.