

PROPOSED EAST ELEVATION 1-1
 BALL ALLEY HOUSE, LUCAN, CO. DUBLIN
 Scale: 1:200



PROPOSED WEST ELEVATION 2-2
 BALL ALLEY HOUSE, LUCAN, CO. DUBLIN
 Scale: 1:200



PROPOSED SOUTH ELEVATION 3-3
 BALL ALLEY HOUSE, LUCAN, CO. DUBLIN
 Scale: 1:200



PROPOSED NORTH ELEVATION 4-4
 BALL ALLEY HOUSE, LUCAN, CO. DUBLIN
 Scale: 1:200

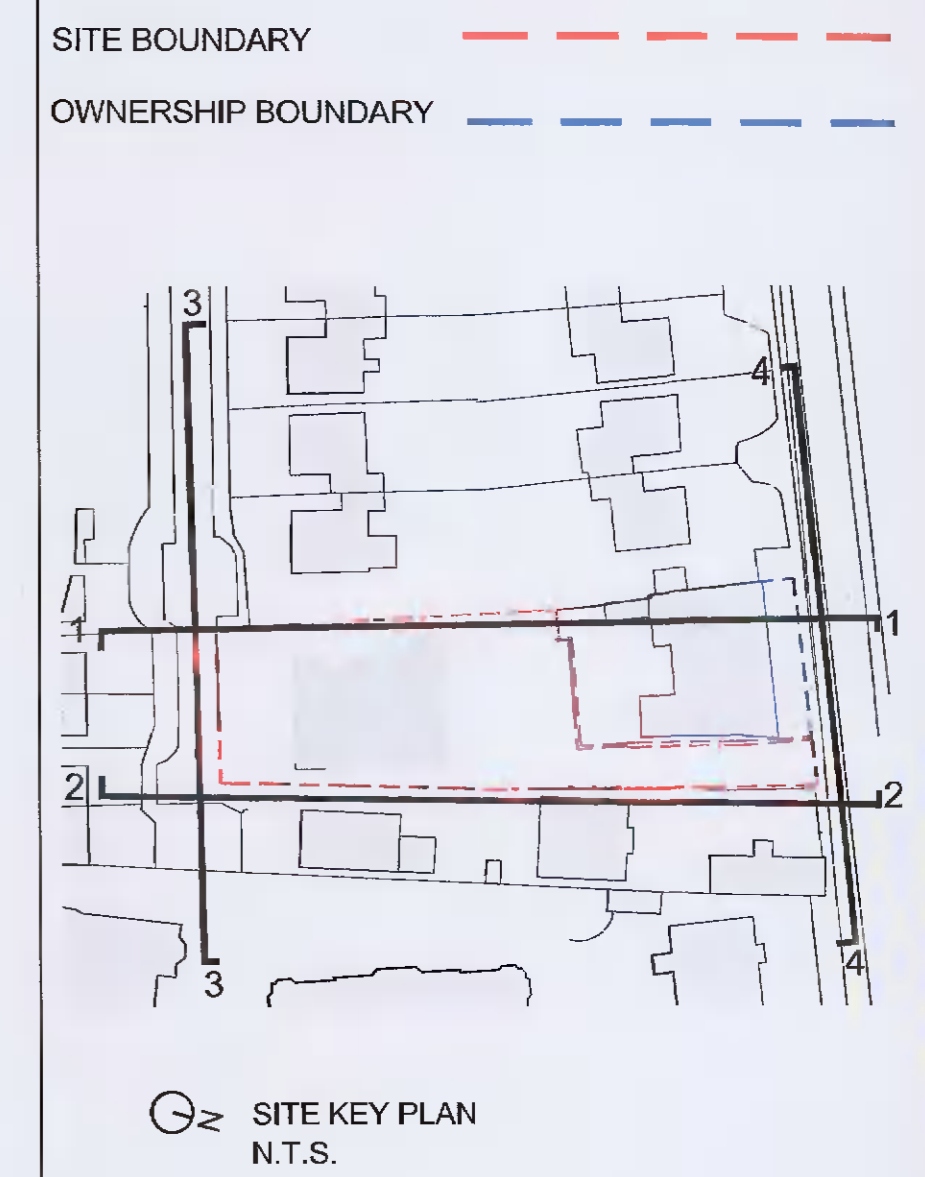

REV	DATE	DRN	NOTES

DO NOT SCALE FROM THIS DRAWING. USE FIGURED DIMENSIONS IN ALL CASES.
 VERIFY DIMENSIONS ON SITE AND REPORT ANY DISCREPANCIES TO THE ARCHITECT IMMEDIATELY.
 THIS DRAWING TO BE READ IN CONJUNCTION WITH THE ARCHITECT'S SPECIFICATION.
 THIS DRAWING IS COPYRIGHT AND MAY ONLY BE REPRODUCED WITH THE ARCHITECT'S PERMISSION.

CDP Architecture
 Designers - Planning - Interiors - Project Management

4, The Mall, Inch Street,
 Lucan Village, Co. Dublin,
 K78 V9R6
 T: 01 6214498
 E: info@cdparchitecture.ie
 W: www.cdp-architecture.com

PLANNING	
JOB	DATE
PROPOSED RESIDENTIAL DEVELOPMENT	JUNE 2021
BALL ALLEY HOUSE	
LUCAN, CO. DUBLIN	
CLIENT	DRN
GERRY TEAGUE	SA
DRAWING TITLE	SCALE
PROPOSED CONTEXTUAL ELEVATIONS	1:200@A1
EAST 1-1, WEST 2-2, SOUTH 3-3, NORTH 4-4	CHECKED
	PM
JOB NUMBER	DRAWING NUMBER
2020_062	3.1.303
	REVISION