

ELEVATION A

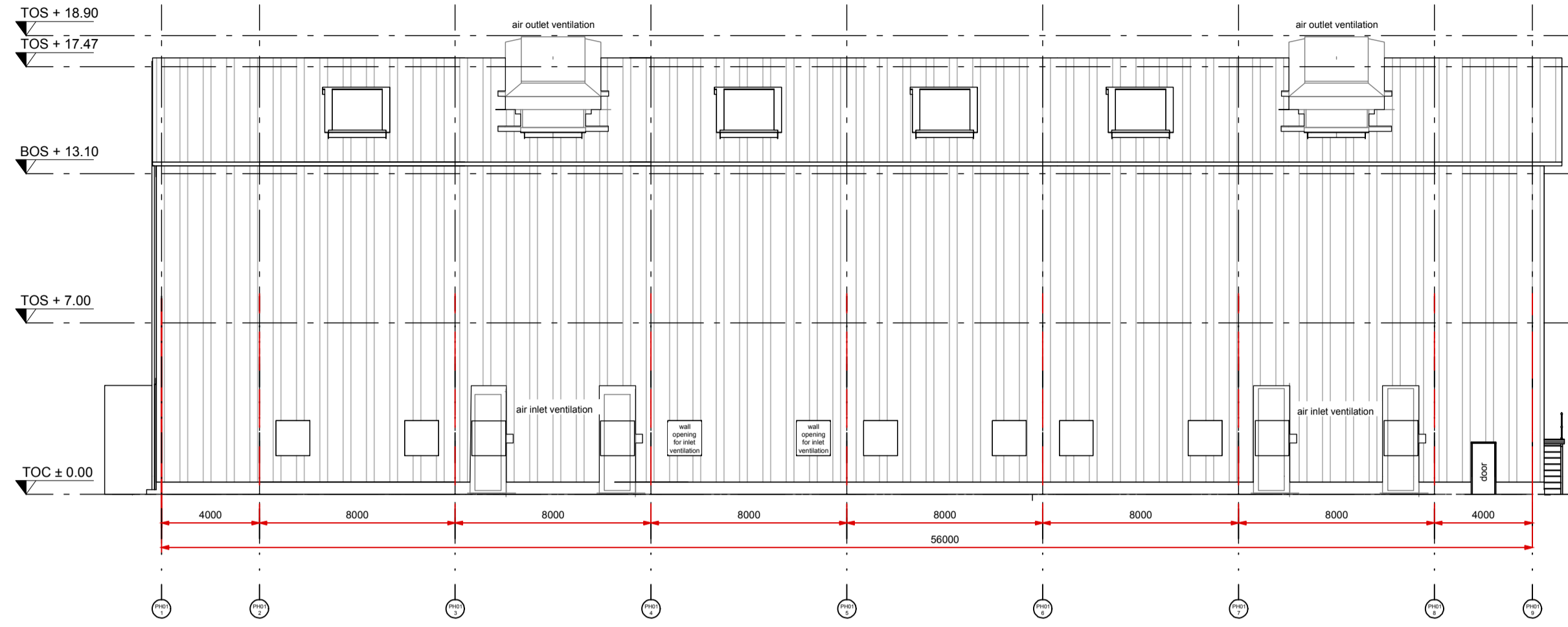

ELEVATION C

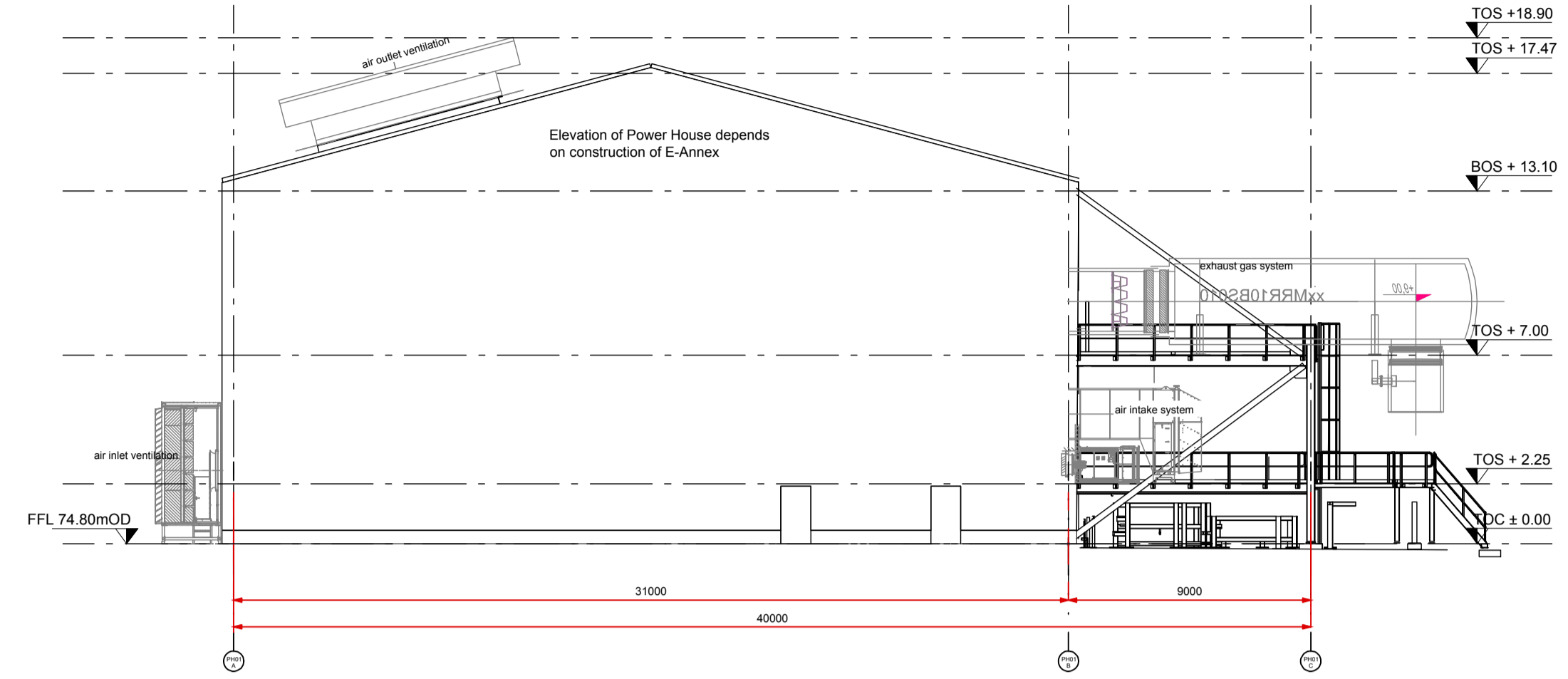

ELEVATION B

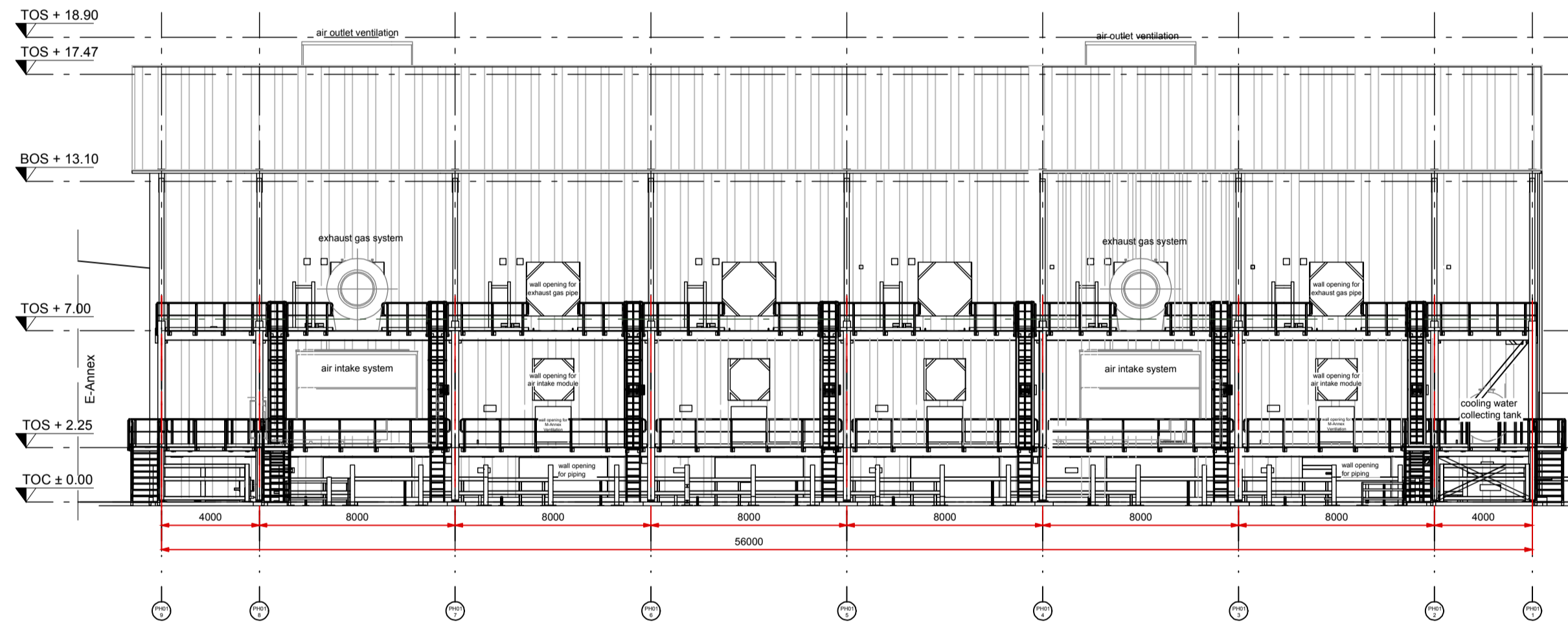

ELEVATION D

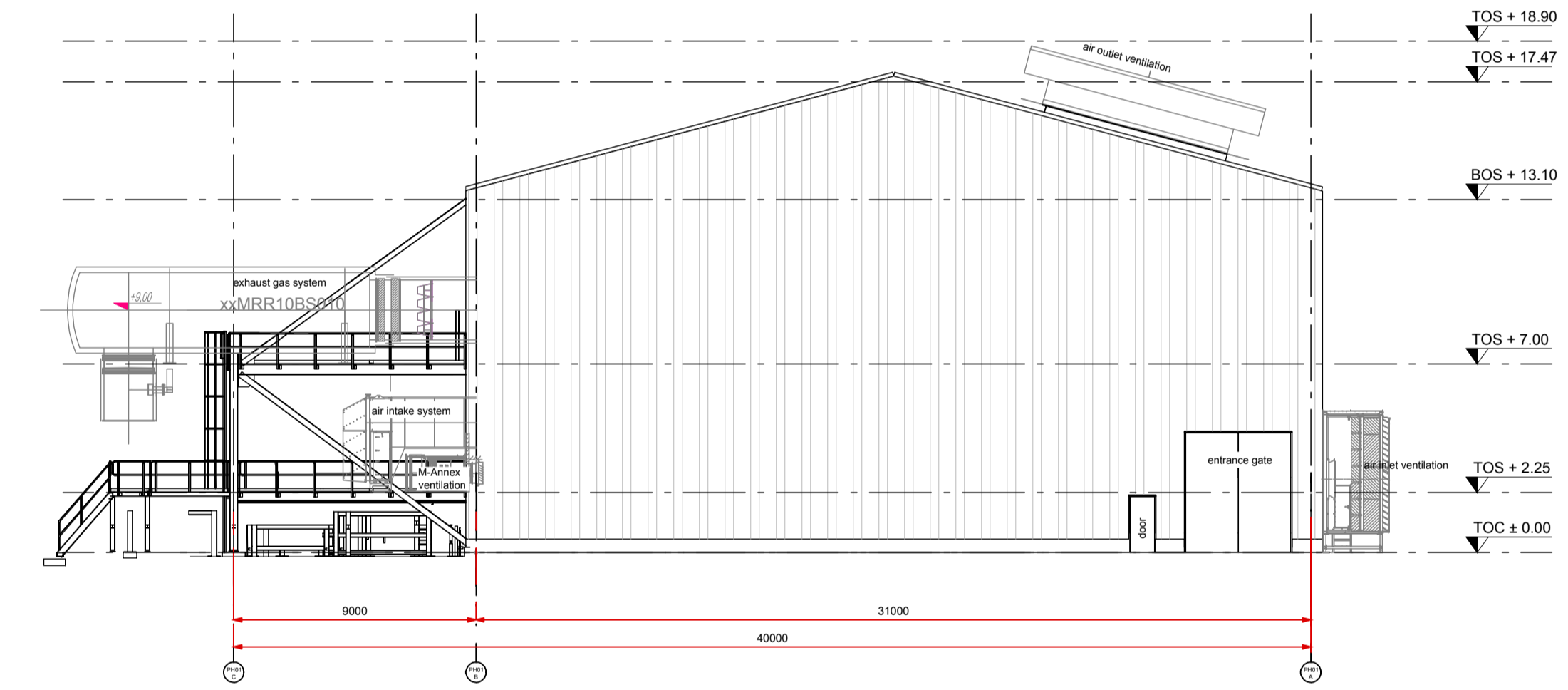

SECTION 1-1

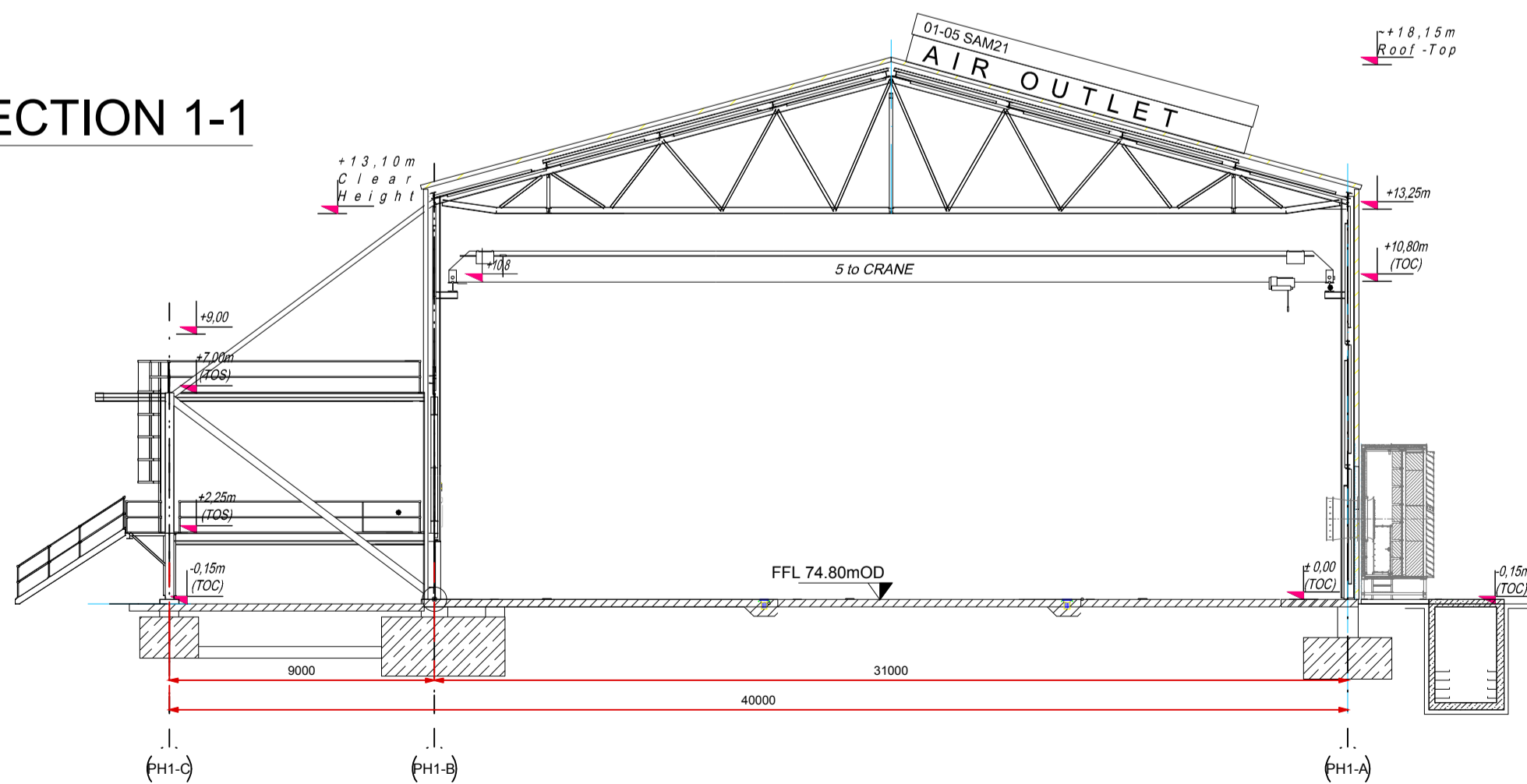

As agreed with South Dublin County Council in the pre-application consultation meeting the final finishes, including cladding materials and colour codes, will be agreed with the Council post planning through planning condition. Greener Ideas Limited will ensure only Council approved finishes are applied on site.

NOTES:

- FIGURED DIMENSIONS ONLY TO BE TAKEN FROM THIS DRAWING.
- ALL DRAWINGS TO BE CHECKED BY THE CONTRACTOR ON SITE
- ENGINEER/EMPLOYERS REPRESENTATIVE, AS APPROPRIATE, TO BE INFORMED BY THE CONTRACTOR OF ANY DISCREPANCIES BEFORE ANY WORK COMMENCES
- THE CONTRACTOR SHALL UNDERTAKE A THOROUGH CHECK FOR THE ACTUAL LOCATION OF ALL SERVICES/UTILITIES, ABOVE AND BELOW GROUND, BEFORE ANY WORK COMMENCES
- ALL LEVELS SHOWN RELATE TO ORDNANCE SURVEY DATUM AT MALIN HEAD

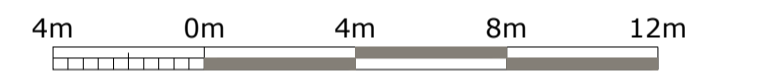

Rev	Date	Description	By	Chkd.
A	18.06.21	PLANNING ISSUE	MN	MMCC

Client:



Project:

PROFILE PARK
POWER PLANT

Title:

GAS ENGINE HALL
ELEVATIONS & SECTION

Scale @ A1: 1:200

Prepared by: M. Nolan Checked: M. McCarthy Date: June 2021

Project Director: S. Tinnelly

Drawing Status: Planning

TOBIN
CONSULTING ENGINEERS

Block 10-4, Blanchardstown Corporate Park,
Dublin 15, Ireland.
tel: +353-(0)1-8030406
fax: +353-(0)1-8030409
e-mail: dublin@tobin.ie
www.tobin.ie

TOBIN Consulting Engineers will not be liable for any use of this document for any purpose other than that for which it was originally prepared and approved. Except where specifically stated otherwise, the copyright in this document shall remain the property of TOBIN Consulting Engineers. All rights reserved. No part of this document may be reproduced or transmitted in any form and this document shall not be relied upon by any third party for any purpose.

Drawing No.: 11069-2041 Revision: A