

LEGEND - EXTENSIVE GREEN ROOF BUILD UP

- PRECULTIVATED SEDUM BLANKET
- EXTENSIVE ROOF GARDEN SOIL MIX 50mm
- VLF150 FILTRATION FLEECE 1.5mm THICK
- DE25 DRAINAGE & RESERVOIR LAYER 25mm
- VLU300 PROTECTIVE / RESERVOIR FLEECE 2.5mm
- 4mm UNOSINT ROOT RESISTANT CAP SHEET
- 4mm TOP/S BASE SHEET
- 100mm PARATORCH INSULATION BOARD
- 2mm VAPOBAR VAPOUR CONTROL LAYER

IMPORTANT NOTE:
THE COMBINED THICKNESS OF ALL THE ELEMENTS USED IN THE EXTENSIVE GREEN ROOF BUILD UP, FROM TOP OF DECKING TO TOP OF SOIL LAYER IS 215mm

SEDUM PLANTS WILL TYPICALLY REACH HEIGHTS OF 100-150mm

EXTENSIVE GREEN ROOF = 0.981 kN/m²
NO ACCESS

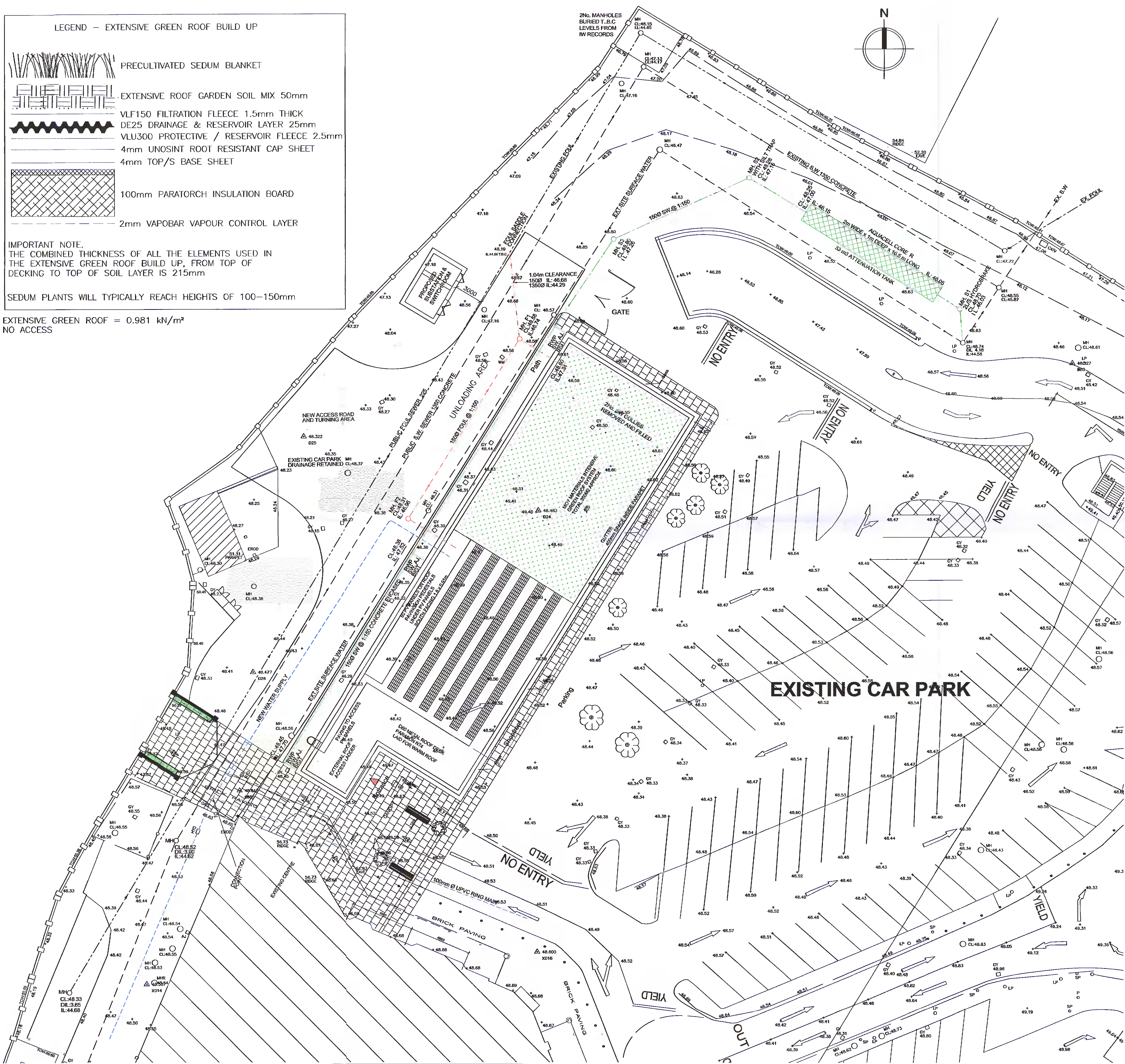

- DRAINAGE NOTES:**
- THE POSITION OF EXISTING SERVICES INsofar AS THEY ARE KNOWN TO THE ENGINEER AND AS SHOWN ON THIS DRAWING MAY NOT BE ACCURATE AND MERELY INDICATE THEIR PRESENCE IN THIS WORKING AREA. SERVICES OTHER THAN THOSE SHOWN MAY ALSO EXIST. THE CONTRACTOR SHALL BE FULLY RESPONSIBLE FOR LOCATING THE EXACT POSITION OF THESE AND ALL OTHER SERVICES ON THE SITE AND IN THE PUBLIC ROADS ADJACENT TO THE SITE, AND SHOULD ALSO CONTACT THE RESPECTIVE AUTHORITIES FOR THE MOST UP-TO-DATE INFORMATION BEFORE COMMENCING THE WORKS.
 - EXACT LOCATION AND INVERT LEVELS TO BE CONFIRMED ON SITE PRIOR TO CONSTRUCTION.
 - INTERNAL WATER SERVICE DETAILS TO M&E DRAWINGS
 - NEW ACO DRAINS TO DRAIN INTO PERMEABLE PAVING USING MIN. 1m LONG 100mm DIAMETER PERFORATED PIPE, UNLESS OTHERWISE STATED.
 - ALL EXISTING HARDSTANDING DRAINAGE TO BE MAINTAINED UNLESS NOTED OTHERWISE.

LEGEND:

- MH S16: NEW SURFACE WATER SEWER MANHOLE AND PIPE SHOWING FLOW DIRECTION
- EX SMH: EXISTING SURFACE WATER SEWER MANHOLE AND PIPE SHOWING FLOW DIRECTION
- MH F5: NEW FOUL SEWER MANHOLE AND PIPE SHOWING FLOW DIRECTION
- EX FMH: EXISTING FOUL SEWER MANHOLE AND PIPE SHOWING FLOW DIRECTION
- 100mm Ø CLASS C HOPE/MOPE WATERMAIN PE-80, SDR-11 OR SDR-17
- FH: FIRE HYDRANT ON WATERMAIN
- DAV: DOUBLE ACTING AIR-VALVE ON WATERMAIN
- SLV: SLUICE VALVE ON WATERMAIN
- PROPOSED 25mm (ØD) PE SERVICE CONNECTION WITH IRISH WATER APPROVED BOUNDARY BOX
- PIPE TO BE ABANDONED AND BLOCKED OFF
- IT: INTERCEPTOR TRAP
- IC: INSPECTION CHAMBER WITH SILT TRAP
- 2.0x4.0M: BELOW GROUND SURFACE WATER SOKAWAY FOR INDIVIDUAL HOUSE
- RG: SURFACE WATER ROAD GULLY AND 100mm Ø BRANCH PIPE

- NOTES:**
- ALL BRANCH DRAINS TO BE 100 Ø PIPES CONNECTING TO MAIN SEWER RUNS (Ø'S AS SHOWN)
 - TYPICAL MINIMUM FALLS TO FOUL PIPES:
 - 100 Ø PIPE AT 1:60
 - 150 Ø PIPE AT 1:100
 - 150 Ø PIPE AT 1:150 MIN 5 WCS
 - 225 Ø PIPE AT 1:170
 - TYPICAL MINIMUM FALLS TO SURFACE PIPES:
 - 100 Ø PIPE AT 1:100
 - 150 Ø PIPE AT 1:170
 - 225 Ø PIPE AT 1:170
 - NEW FOUL PIPES ØPVC 225Ø AREA CODE "UD", SN8
 - EXTERNAL FACE OF MANHOLES MIN. 500 FROM KERB LINE
 - EXTERNAL FACE OF SEWERS MIN 1000 FROM KERB LINE
 - REF SECTION 3.5.15 OF WASTEWATER CODE OF PRACTICE

D			
C			
B			
A			
REV.	DATE	AMENDMENT	DRAWN BY / CHK'D BY

FOR PLANNING

THE MCKENNA PEARCE PRACTICE

CONSULTING STRUCTURAL + CIVIL ENGINEERS
UNIT 30, SPRUCE AVENUE, STILLORGAN INDUSTRIAL PARK, STILLORGAN, CO. DUBLIN TEL: 01 2897260
Email: mki@mckennapearce.com Web: www.mckennapearce.com

DRAINAGE LAYOUT

PROJECT No.	DRAWING No.	REVISION	CHECKED BY
17097	CO1	-	-
PROJECT TITLE	ARCHITECT		
LUCAN SHOPPING CENTRE EXTENSION	JENNINGS DESIGN STUDIO		
DATE	DRAWN BY	COMPUTER REF.	SCALE / SIZE
02-06-21	JJ	-	1:200 / A1

© DATE AS PER ISSUE DATE. NO PART OF THIS DRAWING MAY BE REPRODUCED OR TRANSMITTED IN ANY FORM OR STORED IN ANY RETRIEVAL SYSTEM OR BY ANY MEANS WITHOUT THE WRITTEN PERMISSION OF THE CONSULTING ENGINEER AS COPYRIGHT HOLDER. EXCEPT AS AGREED FOR USE ON THE PROJECT FOR WHICH THE DRAWING WAS ORIGINALLY ISSUED.