

Jason Walsh
 Architectural & Engineering
 12 ARD MOR CRESCENT
 DUBLIN 24
 PHONE: 085 8070 432
 EMAIL: G.JL.SERVICES@GMAIL.COM

Proposed Two Storey Detached House At,
 67 Coolamber Park,
 Knocklyon,
 Dublin 16.

Deborah Soave

APPLICANT:

Proposed First Floor Plan

DRAWING TITLE:

JOB No: DS-21

DRAWING No: DS-21-03

REV: AI

SCALE: 1:50

INITIALS: JW

DATE: 04.01.21

REV	REVISION TITLE	DRN	CHD	DATE
PL1	Issued For Planning	JW	JW	Mar 2021

THIS DRAWING IS ISSUED FOR ADDITIONAL INFORMATION

AI Issued For Additional Information JW JW June 2021

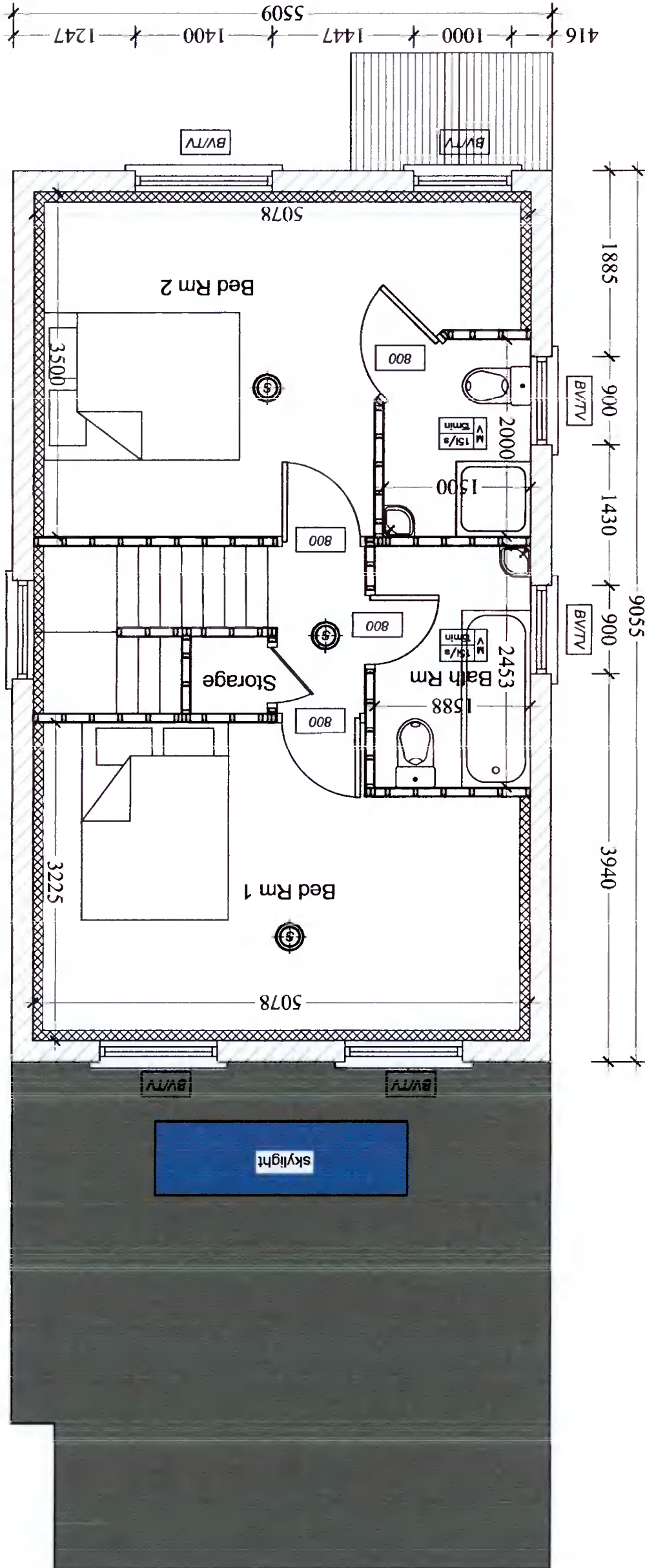

Note:
 All Dimensions are Block to Block

External Wall Construction
 22mm Sand & Cement Render Finish
 215mm Cavity Block
 100mm Kingspan Insulation Board or Equal
 Finished with 3mm Skim Coat
 Timber Stud Partition (All New Internal Walls)
 3mm Skim Coat Plaster Finish on
 12.5mm Gypsum Plaster Board on
 38x75mm Studs.
 Insulate Between Studs