

Mr Declan Heery,  
 432A Orwell Park Green,  
 Tempelogue,  
 Dublin 6,

21-25

1<sup>st</sup> June 2021

**Re:- Report on existing water main and foul sewer at 432A Orwell Park Green**

Dear Declan,

Following a review of the planning drawings for the proposed extension at the above address, I would recommend that the existing boundary wall be demolished to allow for a new foundation for the extension. The bottom of the new foundation should be 1050mm below the existing ground, so as not to induce any ground pressures on the existing water main and foul sewer as shown in Figure 1 below. The position of the existing services are shown on the architects plan below along with an extract from the drainage record maps. See Figure 2 and 3 below.

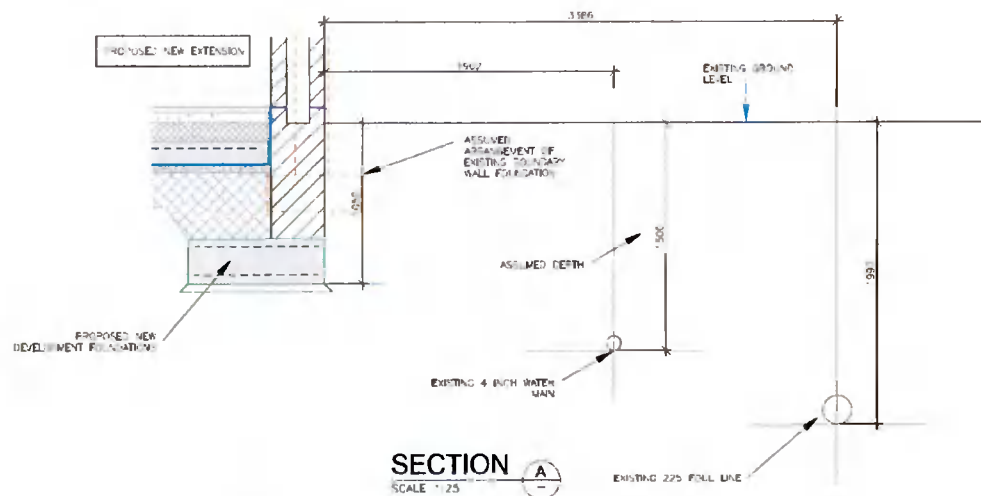

Figure 1:- Section through existing boundary wall showing levels for existing water main and foul sewer

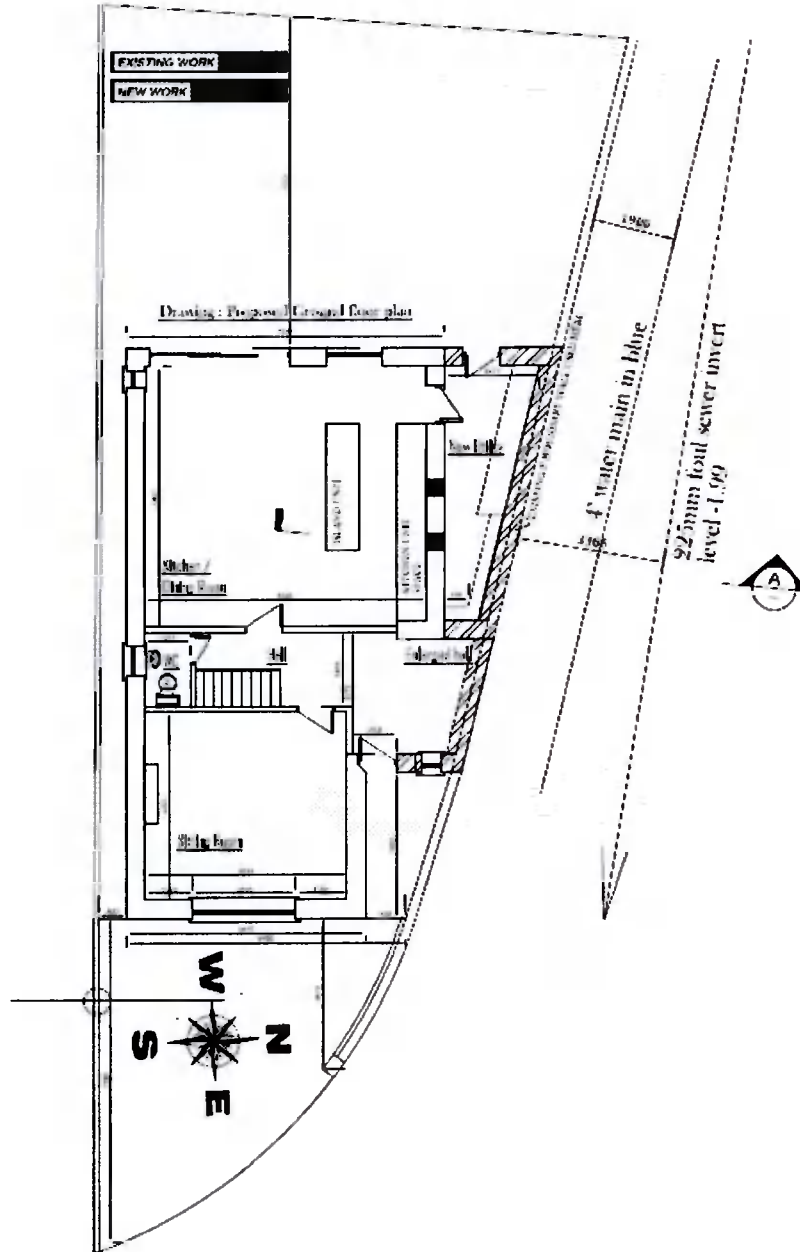

Figure 2:- Proposed plan showing existing watermain and foul sewer beyond boundary line

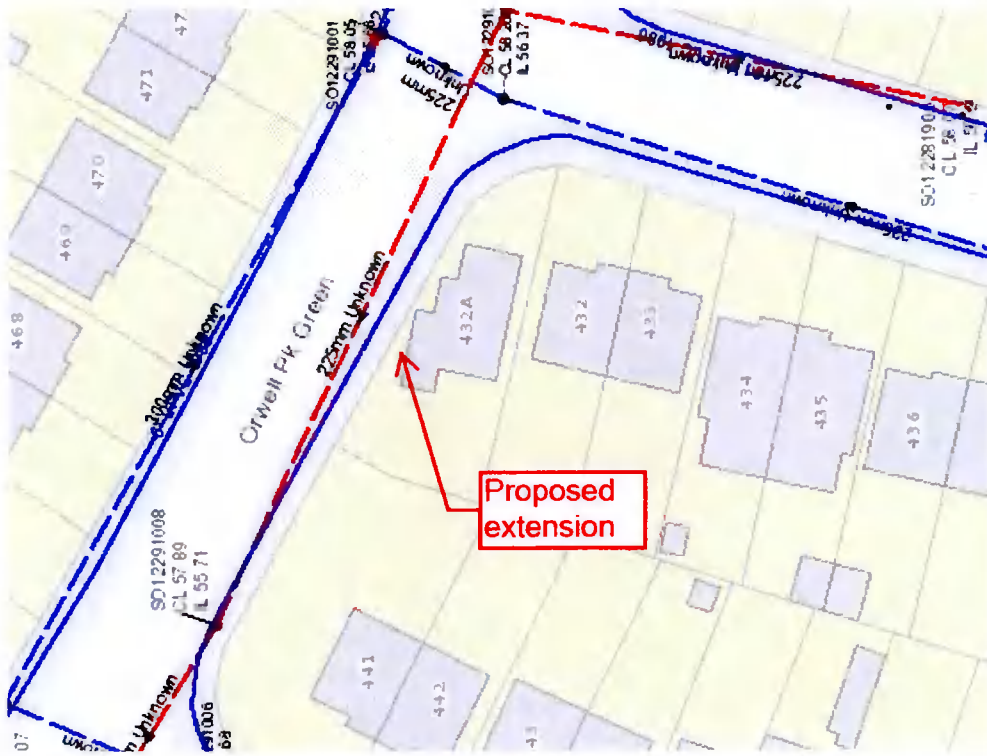

Figure 3:- Extract from drainage record maps

Should you have any queries regarding this, please do not hesitate to contact me.

Yours sincerely,

**Jonathan Lennon**  
BScEng DipStructEng DipProjMan CEng MStructE FIEI Euring DipEnvEng  
Chartered Engineer  
**L C E**

