

100  
0 10  
A1

DO NOT SCALE

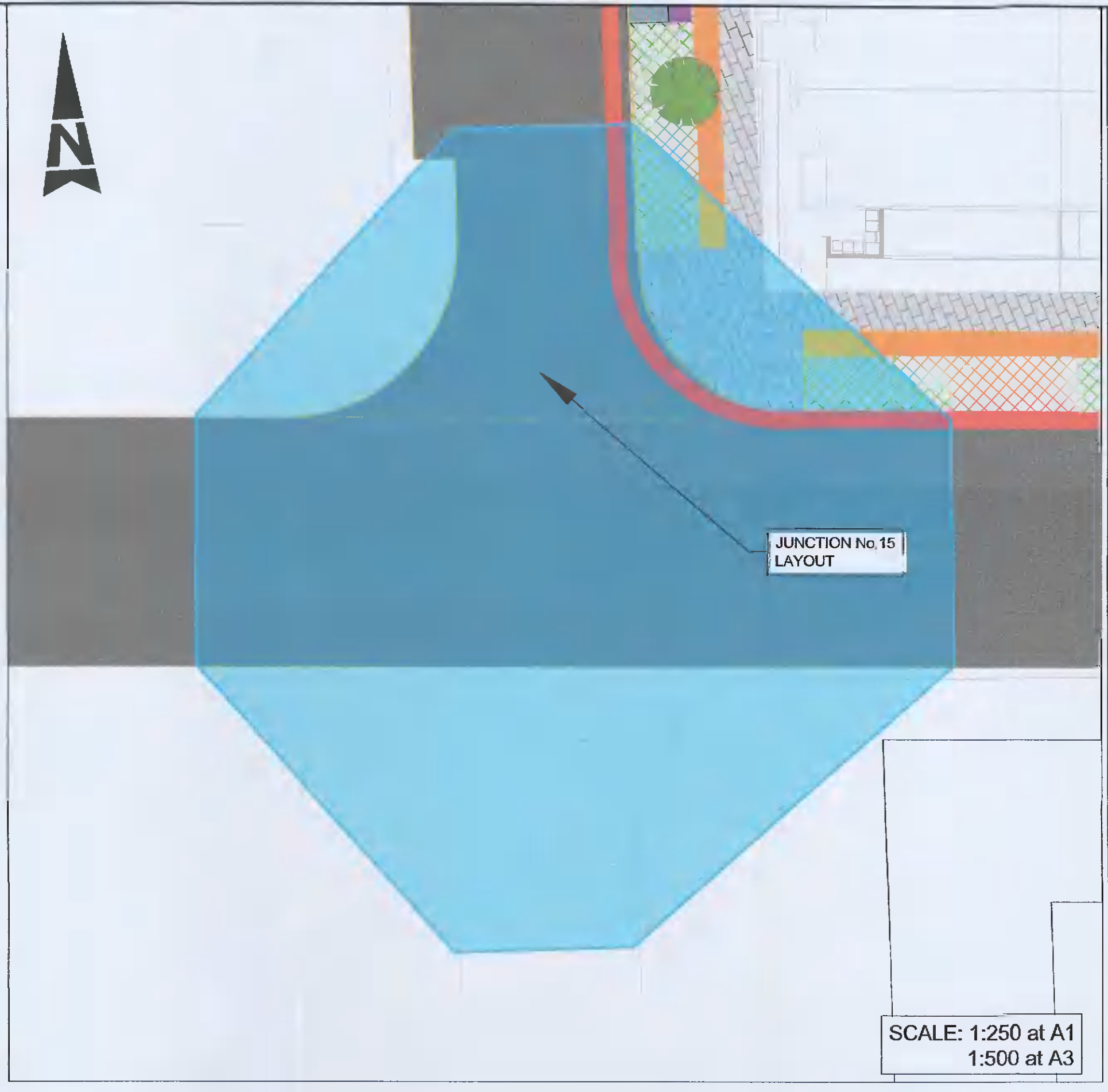

© ORDNANCE SURVEY IRELAND LICENSE No. AR 0082521.  
ORDNANCE SURVEY IRELAND & GOVERNMENT OF IRELAND

LEGEND:					
	SITE BOUNDARY		RAISED TABLE		CYCLE PATH BUFFER
	FOOTPATH		TACTILE PAVING (UNCONTROLLED)		HOMEZONE STREET
	GRASS VERGE		TACTILE PAVING (TRAMLINE)		PARKING BAY
	CYCLE PATH		DISABLED PARKING		E-PARKING
	CARRIAGEWAY				

Rev	Description	By	Date	Chk'd	Auth
-	PLANNING SUBMISSION REVIEW	AR	14.05.21	PF	KB
-	PLANNING SUBMISSION REVIEW	YC	11.02.21	JW	KB

**ATKINS**  
Member of the SNC-Lavalin Group

Atkins House, 160-165 Ainslie Business Park, Swords, Co. Dublin  
Tel (+353) 01 810 8000 Fax (+353) 01 810 8001

Unit 2B, 2200 Cork Airport Business Park, Cork  
Tel (+353) 021 429 0300 Fax (+353) 021 429 0360

1st Floor Technology House Parkmore Technology Park, Galway  
Tel (+353) 091 788 090 Fax (+353) 091 779 830

Client	QUINTAIN DEVELOPMENTS IRELAND LTD
Project	ADERRIG PHASE 2

Purpose	PLANNING
Title	JUNCTION VISIBILITY SHEET 3 OF 3
Original Scale	AS SHOWN
Design/Drawn	AR
Checked	PF
Authorised	KB
Date	14.05.21
Date	14.05.21
Date	14.05.21
Status	P
Drawing Number	5150924 / HTR / 06 / DR / 0109
Rev	-

File: 5150924\_HTR\_06\_DR\_0109.dwg  
Date: May 19, 2021 - 8:03pm  
Plotted by: Alwyn O'Sullivan