

**Mixed Use Development, Greenhills Road,
Tallaght, Dublin 24**

**Operational Waste Management Plan
202253-PUNCH-XX-XX-RP-C-0007**

May 2021

Table of Contents

Document Control.....	i
Table of Contents.....	ii
1 Operational Waste.....	3
2 Waste Control Strategy.....	4
2.1 Mitigation Measures.....	4
2.2 Location, Size and Scale of the Development.....	4
2.3 Estimated Waste Arisings.....	5
3 Waste Storage & Collection.....	7
3.1 Waste Storage.....	7
3.2 Waste Collection.....	7
4 Predicted Impacts of the Proposed Development.....	9

2 Waste Control Strategy

The management company will be responsible for the collection and disposal of all waste.

2 no. dedicated Waste Collection Areas (WCA) will be located externally at ground floor level, one to the north of the site for the residential waste storage and a second of the east of the site for the Café's commercial waste storage. Refer to TOT architectural layout drawings for details. The waste collection bins will be segregated at the Waste Storage Areas (WSA) and the Waste Collection areas into the following categories:

- General Waste
- Recycling material (e.g. glass, plastic, cardboard, paper)
- Organic (food) waste

Residents will transfer the refuse from each apartment to the dedicated WSA located at ground floor level adjacent the lift core of each of the apartment blocks. Waste and recycling bins from the dedicated WSA of each apartment block will be moved to their designated WCA by the site facilities manager. The Cafés WSA will be located within the Café unit.

Bins/containers will be clearly labelled, and colour coded to avoid cross contamination of the different waste streams. Signage will be posted above or on the bins to show exactly which wastes can be put in each.

It is also noted that the SDCC Recycling Centre is located 3.1km from the proposed development. This facility provides further opportunities for residents to dispose of recyclable materials.

2.1 Mitigation Measures

In order to minimise the disposal of waste material to landfill, the mantra of “reduce, reuse, recycle” will be promoted throughout the development. In addition, the following mitigation measures will be employed:

- Suitable waste materials will be stored in bins in designated, easily accessible locations.
- Waste leaving the site will be transported by suitable permitted contractors and taken to suitably permitted/licensed facilities.

Waste from the development will be segregated and stored in designated centralised WSA at ground floor level of each apartment block.

These mitigation measures will ensure the waste arising from the development is dealt with in compliance with the provisions of the Waste Management Act 1996 (as amended 2001), and associated Regulations, the Litter Act of 1997 and the Dublin Waste Management Plan (2005-2010), and achieve optimum levels of waste reduction, re-use and recycling.

2.2 Location, Size and Scale of the Development

The proposed residential development contains a total of 14 no. existing units, and 26 no. proposed units, consisting of a mixture of 3 bed, 2 bed, 1 bed, and studio accommodation.

A summary of the apartment types (studio, 1, 2 or 3 bed units) and the associated number of bedrooms is provided in Table 1 below.

A suitable division of these containers (general waste vs recyclables) will be developed by the operator to suit demand and to ensure that suitable arrangements are provided for communal waste containers for segregated waste.

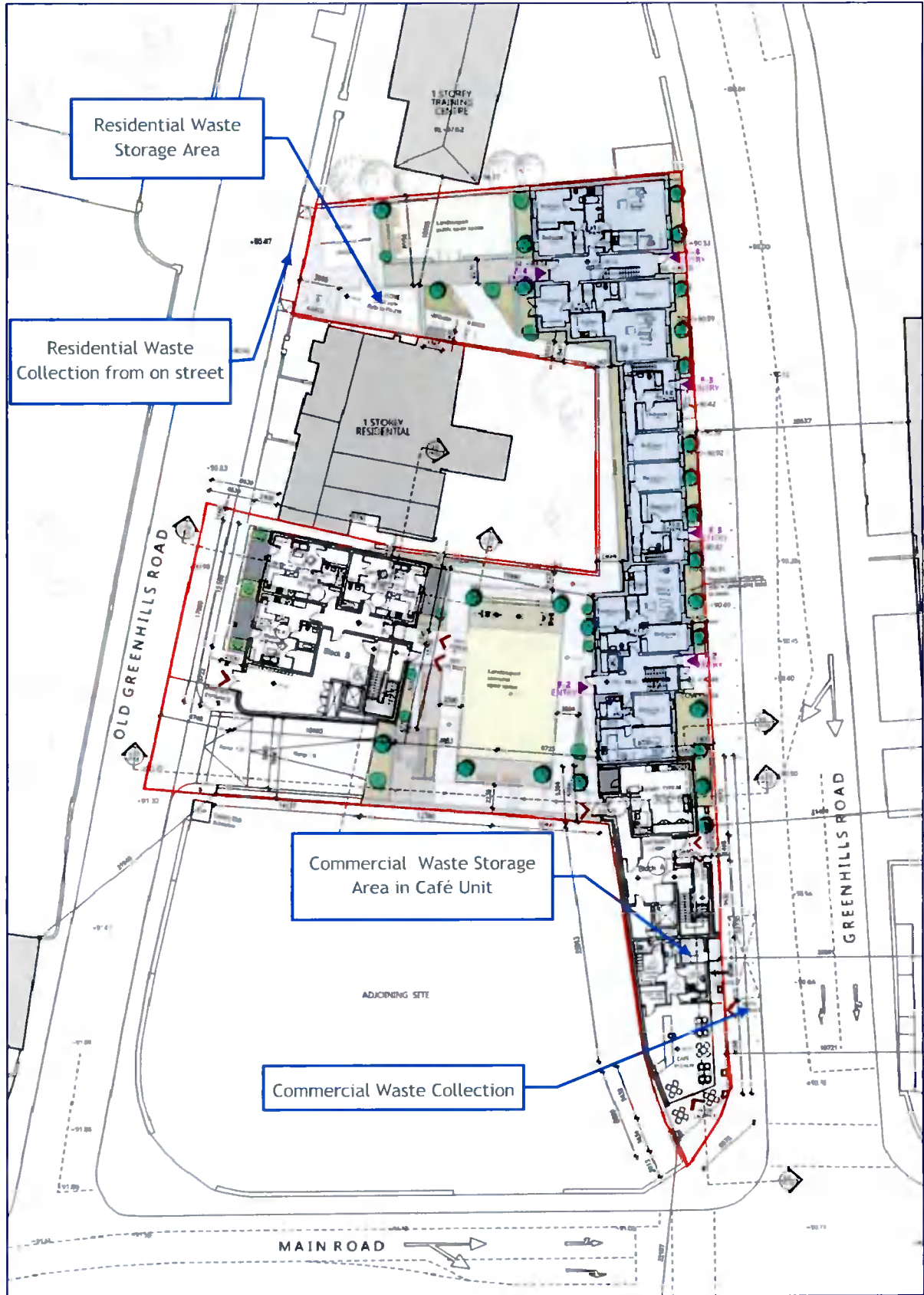

Figure 1 Waste Collection Area (WCA) location